

CERTIFICATE OF HIGHWAY MILEAGE

YEAR ENDING FEBRUARY 10, 2008

MAR 03 2008

Fill out form, make and file copy with the Town Clerk, and mail ORIGINAL, before February 20, 2008 to: Vermont Agency of Transportation, Policy and Planning Division, One National Life Drive, Montpelier, VT 05602

We, the Selectmen or Aldermen or Trustees of DOVER in WINDHAM County

on an oath state that the mileage of highways, according to Title 19, V.S.A, Sec #305, added 1985, is as follows:

MAR 13 2008 Vermont Agency of Transportation Policy & Planning Division

PART I - CHANGES TOTALS - Please fill in and calculate totals.

Table with 6 columns: Town Highways, Previous Mileage, Added Mileage, Subtracted Mileage, Total, Scenic Highways. Rows include Class 1, Class 1 Lane, Class 2, Class 3, State Highway, Class 4, Legal Trail, and Total.

* Mileage for Class 1 Lane, Class 4, and Legal Trail classifications is NOT included in total.

PART II - INFORMATION AND DESCRIPTION OF CHANGES SHOWN ABOVE.

- 1. NEW HIGHWAYS: Please attach Selectmen's "Certificate of Completion and Opening"
2. DISCONTINUED: Please attach SIGNED copy of proceedings (minutes of meeting)
3. RECLASSIFIED/REMEASURED: Please attach SIGNED copy of proceedings (minutes of meeting)
4. SCENIC HIGHWAYS: Please attach a copy of order designating/discontinuing Scenic Highways

IF THERE ARE NO CHANGES IN MILEAGE: Check box and sign below. [X]

PART III - SIGNATURES - PLEASE SIGN.

Selectmen/ Aldermen/ Trustees Signatures:

Handwritten signatures of town officials and date filed: 2/28/08

T/C/V Clerk Signature:

Please sign ORIGINAL and return it for Transportation signature.

AGENCY OF TRANSPORTATION APPROVAL: Signed copy will be returned to T/C/V Clerk.

APPROVED:

Representative, Agency of Transportation

DATE:

4/17/2008

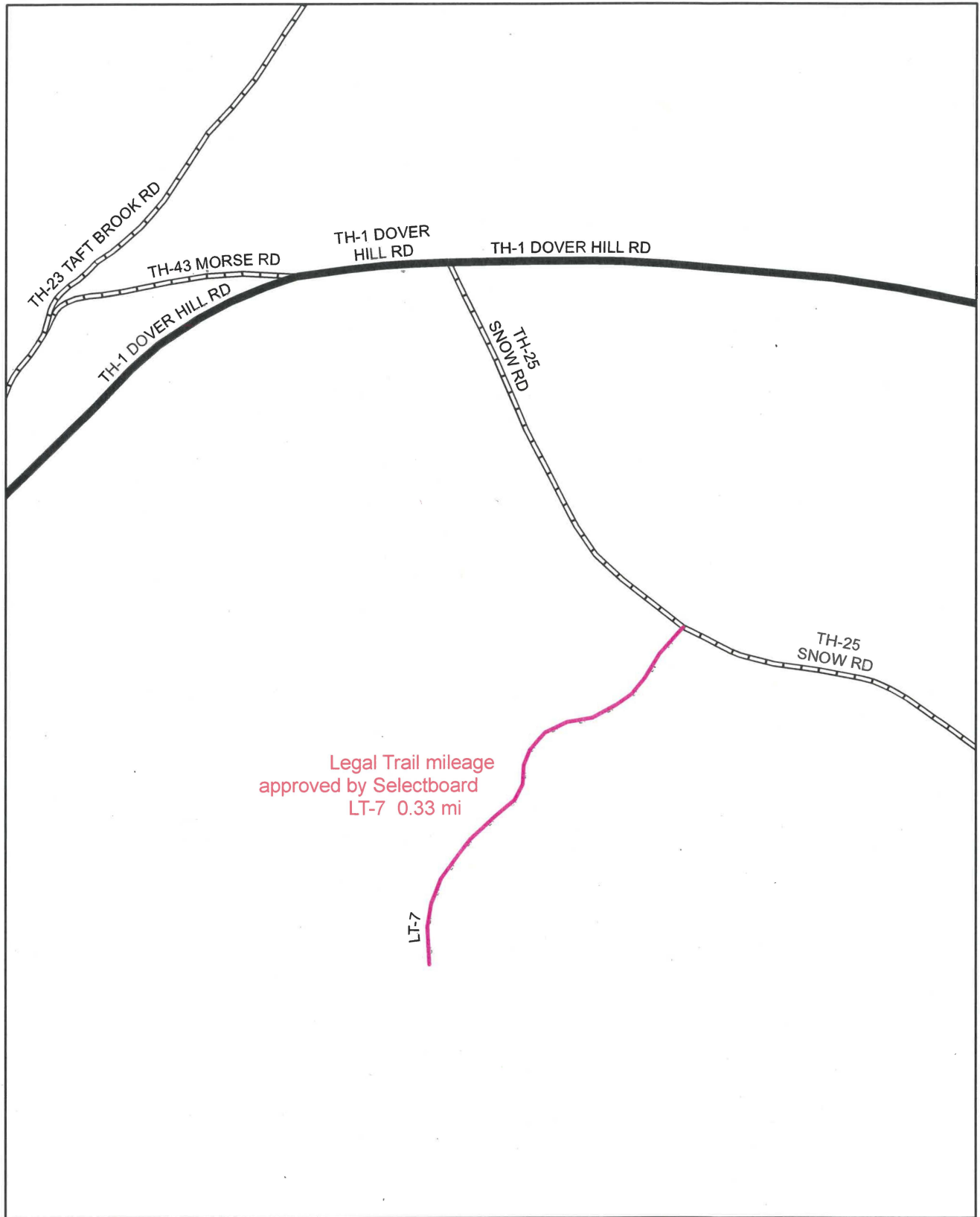

Mileage Certificate Change 2008 -- DOVER

Mapping Unit
Policy & Planning Division
Vermont Agency of Transportation -- March 2008



0 0.1 Miles



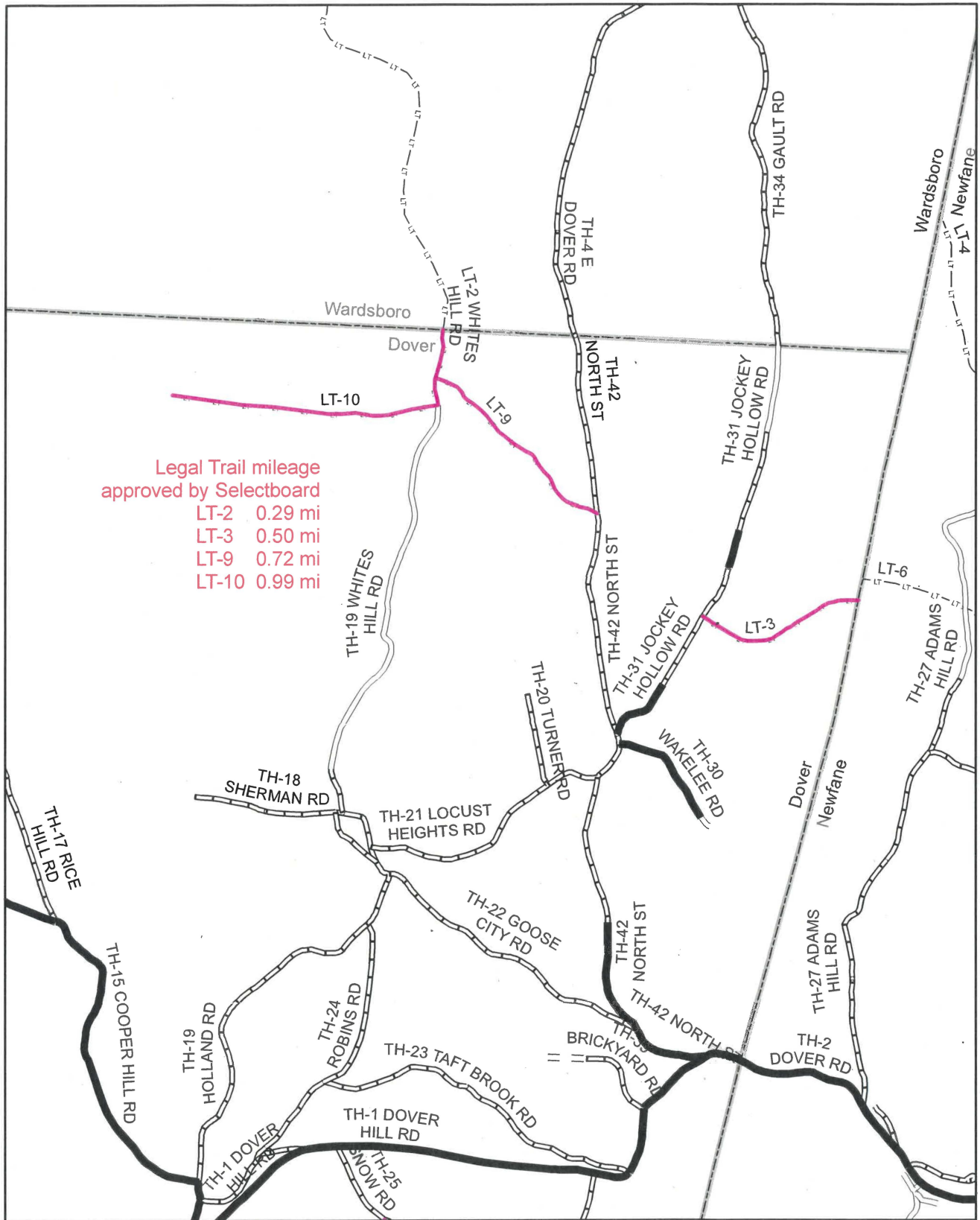

Legal Trail mileage
approved by Selectboard

LT-2	0.29 mi
LT-3	0.50 mi
LT-9	0.72 mi
LT-10	0.99 mi

Mileage Certificate Change 2008 -- DOVER

Mapping Unit
Policy & Planning Division
Vermont Agency of Transportation -- March 2008

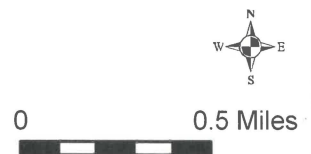

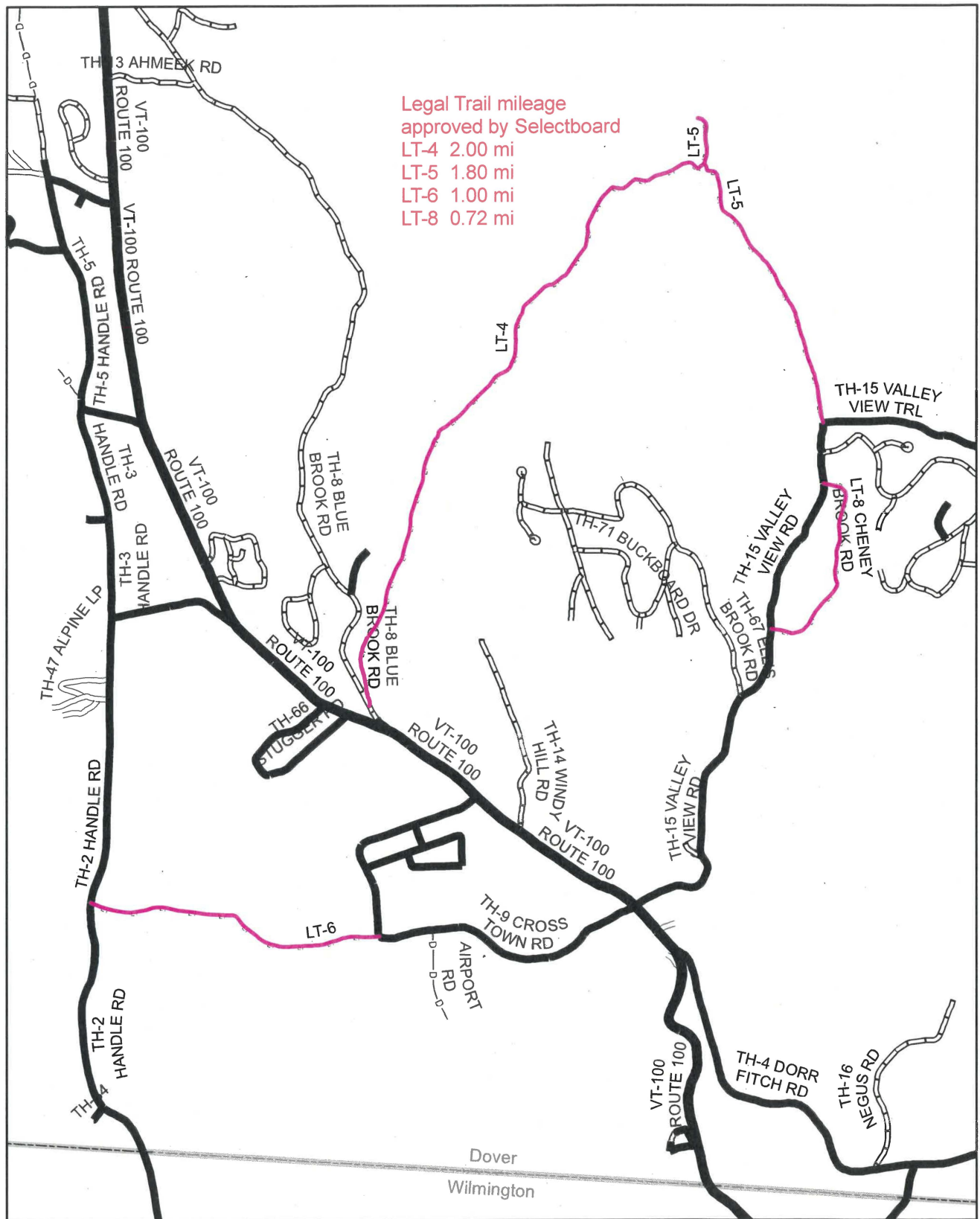

Mileage Certificate Change 2008 -- DOVER

Mapping Unit
 Policy & Planning Division
 Vermont Agency of Transportation -- March 2008

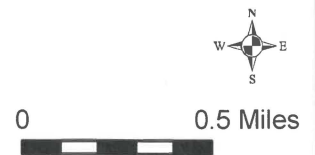

Town of Dover

P.O. Box 428
West Dover, VT 05356-0428
Tel. (802) 464-8000
Fax (802) 464-8721

Vermont
Agency of Transportation
MAR 13 2008
Policy & Planning Division

March 11, 2008

Ms. Sara Moulton
VAOT, Policy Planning Division
One National Life Drive
Montpelier, VT 05633

Re: Amended Certificate of Highway Mileage

Dear Sara:

I apologize about the inconsistency in the trail mileage reported on Dover's Certificate of Highway Mileage. I did not realize that you don't have documentation about the discontinuance of LT1. Also, upon review of the Certificate, I noticed error on my part, which I corrected.

Enclosed is documentation about the discontinuance of that trail segment.

If you need more information, please contact me at 464-8000.

Sincerely,

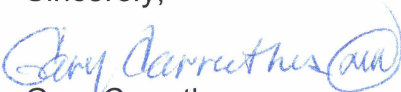

Gary Carruthers
Road Commissioner

TOWNS OF DOVER AND STRATTON, AND THE
UNORGANIZED TOWN OF SOMERSET, VERMONT

REPORT ON THE DISCONTINUANCE OF
A PORTION OF UPPER HANDLE ROAD AND HIGH ROAD

We, the Selectmen of the Towns of Dover and Stratton, Vermont, and the Supervisor of the unorganized Town of Somerset hereby report on our doings concerning the discontinuance of a portion of a public highway known as Upper Handle Road located within the Towns of Dover (Town Highway No. 6) and Stratton (Town Highway No. 21), and a public highway (pent road) located in the Towns of Dover, Stratton and the unorganized Town of Somerset, known as the "High Road." Pursuant to resolution adopted at a regular meeting of the Board of Selectmen of the Town of Stratton on the 27th day of November, 1989 and at a regular meeting of the Board of Selectmen of the Town of Dover on the 28th day of November, 1989, notices of the proposed discontinuance of Upper Handle Road and High Road were caused to be posted in the offices of the Town Clerks of the Towns of Dover and Stratton and published in the Brattleboro Reformer on December 13, 1989. Copies were also mailed to the following persons at the following addresses by Certified Mail, Return Receipt Requested:

Commissioner of Forests, Parks and Recreation
Montpelier, VT 05602

Dover Planning Commission
West Dover, VT 05356

Virginia and Robert Fisher
R. D. 4, Box 661
West Brattleboro, VT 05301

3.
Mr. and Mrs. John Hickey, Jr.
130 Eldin Road
Pocasset, MA 02559

Richard Ackerman
U. S. Forest Service
P. O. Box 519
Rutland, VT 05702

Mrs. Janet Greene
c/o Raymond P. Perra, Esquire
P. O. Box 558
Brattleboro, VT 05302

Ann E. Hickey
130 Elgin Road
Pocasset, MA 02559

George T. Gildea
58 Algonquin Road
Canton, MA 01021

Roger and Carol Slate
142 Southwest Street
Feeding Hills, MA 01030

James and Judith McDevitt
36 Colony Road
Lexington, MA 02173

John and Myrtle Tensen
109 Yantacaw Brook Road
Upper Montclair, NJ 07043

James L. and Jane C. Saulnier
17 Regina Drive
Chelmsford, MA 01824

Joyce C. and Andres Llana, Jr.
Box 372
West Dover, VT 05356

Lawrence Gibbons
161 Terrace Avenue
Riverside, RI 02975

In accordance with said notice, a copy of which is attached hereto, the Selectmen of the Towns of Dover and Stratton met at the site at 3:30 p.m. on the afternoon of Monday, January 8, 1990, to examine the premises. Present at that time were Dover

4.

Selectmen Linda Kersten, William Sargent, and Philip Bartlett; Administrative Assistant Doris Knechtel and Zoning Administrator Carol Cooper; and Stratton Selectmen Arne Lauren.

Thereafter, a hearing was held by the Selectmen of the Towns of Dover and Stratton and the Supervisor of the Town of Somerset at 7:00 p.m. on Tuesday, the 9th day of January, 1990, in the Dover Town Offices to consider the following:

1. The discontinuance of a portion of the public highway known as the Upper Handle Road located in the Towns of Dover and Stratton, Vermont.

2. The discontinuance of a public highway (pent road) located in the Towns of Dover and Stratton and the unorganized Town of Somerset, known as High Road.

Present at the hearing were Dover Selectmen Linda Kersten, William Sargent, Philip Bartlett, and Paul Mendelsohn; Administrative Assistant Doris Knechtel and Secretary Kelley Patrick; Stratton Selectmen Arne Lauren, Al Dupell and Diana Stigger; Stratton Town Attorney Robert Pu; Supervisor of the Town of Somerset Douglas Wilson; the following interested parties: Edward Griffith of the U.S. Forest Service; Kenneth V. Fisher, Jr., Virginia Fisher, Gary Carruthers, Ann Hickey, Janet Greene, Raymond Perra, Esquire, Chris Adams, Gilbert Boyd, Craig Wenk, Esquire and Mark Sprague; and Bonney Prince and Susan Johnson of the press.

Testimony was taken from Kenneth V. Fisher, Jr., Raymond Perra, Edward Griffith, Craig Wenk, Janet Greene, and Ann Hickey. Also read into the record were letters from John Redd

on behalf of Mount Snow and Mark Sprague on behalf of the Valley Stump Jumpers. The proceedings were electronically recorded.

In consideration of the testimony and official town records, the Boards and Supervisor make the following findings of fact, conclusions of law and order:

Findings of Fact

1. The landowners abutting the public highways being considered for discontinuance do not have any objections to their discontinuance.
2. Mount Snow would like the Green Mountain National Forest to be granted a twenty-foot (20') right-of-way for the entire length of the roads proposed for discontinuance.
3. The Valley Stump Jumpers would like to have access to the snowmobile trails in Somerset.
4. The Green Mountain National Forest would like a fifty-foot (50') right-of-way reserved for them to that portion of the road which leads from the junction of Route 100 and Stratton Town Highway No. 21 southwesterly for a distance of 508 feet to their existing sixty-six-foot (66') right-of-way which leads westerly over lands now owned by the Town of Stratton.
5. The northerly spur of the High Road leads through lands of Fisher and Bills to an unknown location. The other part of the High Road leads westerly through lands of Fisher to lands of Hickey located in the Towns of Stratton and unorganized Town of Somerset.

6.

Conclusions of Law

6. The Board of Selectmen has the authority to lay out, alter and discontinue highways, subject to the public good, necessity, and convenience.

7. When a highway is discontinued, the right-of-way may be continued at the same width by the Board of Selectmen by designating the right-of-way as a trail.

8. If a discontinued highway is not designated as a trail, the right-of-way shall belong to the owners of the adjoining lands. If it is located between the lands of two different owners, it shall be returned to the lots to which it originally belonged, if they can be determined; if not, it shall be equally divided between the owners of the lands on each side.

9. A trail is not considered as a highway and a town is not responsible for its maintenance.

10. All of the property owners potentially affected by the possible discontinuance of the Upper Handle Road and the High Road, with the exception of the Green Mountain National Forest, Fisher, and Hickey have access to their property from Route 100.

11. If a right-of-way of ingress and egress is reserved for the Green Mountain National Forest, Fisher, and Hickey over the Upper Handle Road and High Road, the public good, necessity, and convenience of the inhabitants of the Towns of Dover, Stratton and the unorganized Town of Stratton are best served by the discontinuance of the Upper Handle Road and High Road.

Order

THEREFORE, the following public highways:

1. A portion of Dover Town Highway No. 6, also known as the Upper Handle Road, which begins at the junction of Dover Town Highway No. 41, which is also known as the Greene Road, and runs northerly to the Dover-Stratton Town line for a distance of approximately eight-tenths (0.8) of a mile;
2. Stratton Town Highway No. 21 (the northerly end of Upper Handle Road) which runs southwesterly from Vermont Route 100 to the Stratton-Dover Town Line a distance of 0.38 miles;
3. A portion of the High Road which commences in the Town of Dover at a point on the above-described Upper Handle Road being discontinued which point is approximately 2500 feet from the intersection of Dover Town Highway No. 41 (the Greene Road) and the said Upper Handle Road (Town Highway No. 6); thence running in a northerly and westerly direction through lands of Greene and the Green Mountain National Forest in the Town of Dover and through lands of the Town of Stratton, Hickey, Gildea and Fisher in the Town of Stratton and Hickey and Gildea in the Town of Somerset. On lands of Fisher the said High Road pent road then splits and a section of said pent road leads northerly through lands of Fisher and the Green Mountain National Forest to

the old Somerset-Stratton Town Line. A second section of the said High Road pent road leads westerly through lands of Fisher to lands of Hickey and Gildea in the Town of Stratton and the unorganized Town of Somerset. Said highway consists, in total, of approximately 2.5 miles; are hereby DISCONTINUED and the existing highways are hereby set to the owners of the adjoining lands subject to a right-of-way of ingress and egress to each of the landowners abutting or adjoining the public highways being discontinued described as follows:

Commencing at the intersection of the Upper Handle Road (Dover Town Highway No. 6) and the Greene Road (Dover Town Highway No. 41) in the Town of Dover; thence leading northerly a distance of approximately 2500 feet along a portion of the Upper Handle Road being discontinued herein to the intersection of the Upper Handle Road and the High Road pent road described above; thence leading northerly and westerly a distance of approximately 1.7 miles along the above-described High Road pent road through lands of Greene, Green Mountain National Forest in the Town of Dover and through lands of the Town of Stratton, Hickey, Gildea and Fisher in the Town of Stratton to lands of Hickey and Gildea located in the Town of Somerset.

Said right-of-way is limited to twenty feet (20') in width together with appropriate and necessary slope and drainage rights and the right to repair and maintain said right-of-way for all affected landowners. Also reserving a fifty-foot (50')

right-of-way for ingress and egress to the Green Mountain National Forest which leads from the junction of Route 100 and Stratton Town Highway No. 21 southwesterly for a distance of 508 feet to the Green Mountain National Forest's existing sixty-six-foot (66') right-of-way which leads westerly over lands now owned by the Town of Stratton.

Dated at Dover, Vermont this 30th day of Jan., 1990.

TOWN OF DOVER

By Its Board of Selectmen

[Signature]
[Signature]
[Signature]
Philip E Bartlett

Dated at Stratton, Vermont, this 12th day of February, 1990.

TOWN OF STRATTON

By Its Board of Selectmen

[Signature]
[Signature]
[Signature]

Dated at Brattleboro, Vermont, this 13th day of February, 1990.

TOWN OF SOMERSET

By: [Signature]
Douglas U. Wilson, Supervisor

DOVER TOWN CLERK'S OFFICE
Received for record February 21st, A.D., 1990 at 8 o'clock and 20 minutes a.m.
Recorded in Volume 3, Pages 2-9 of the Dover Highway Records. Also Recorded
in Volume 114, Pages 200-207 of the Dover Land Records.
ATTEST: [Signature] Assistant Town Clerk

ORIGINAL ON FILE IN VAULT (PENT ROAD FILE)

LEGAL TRAIL NUMBER	LENGTH IN MILES
LT-6	1.00
LT-1	0.80
LT-4	2.00
LT-5	1.80
LT-8	0.72
LT-7	0.33
LT-3	0.50
LT-2	0.29
LT-9	0.72
LT-10	0.99

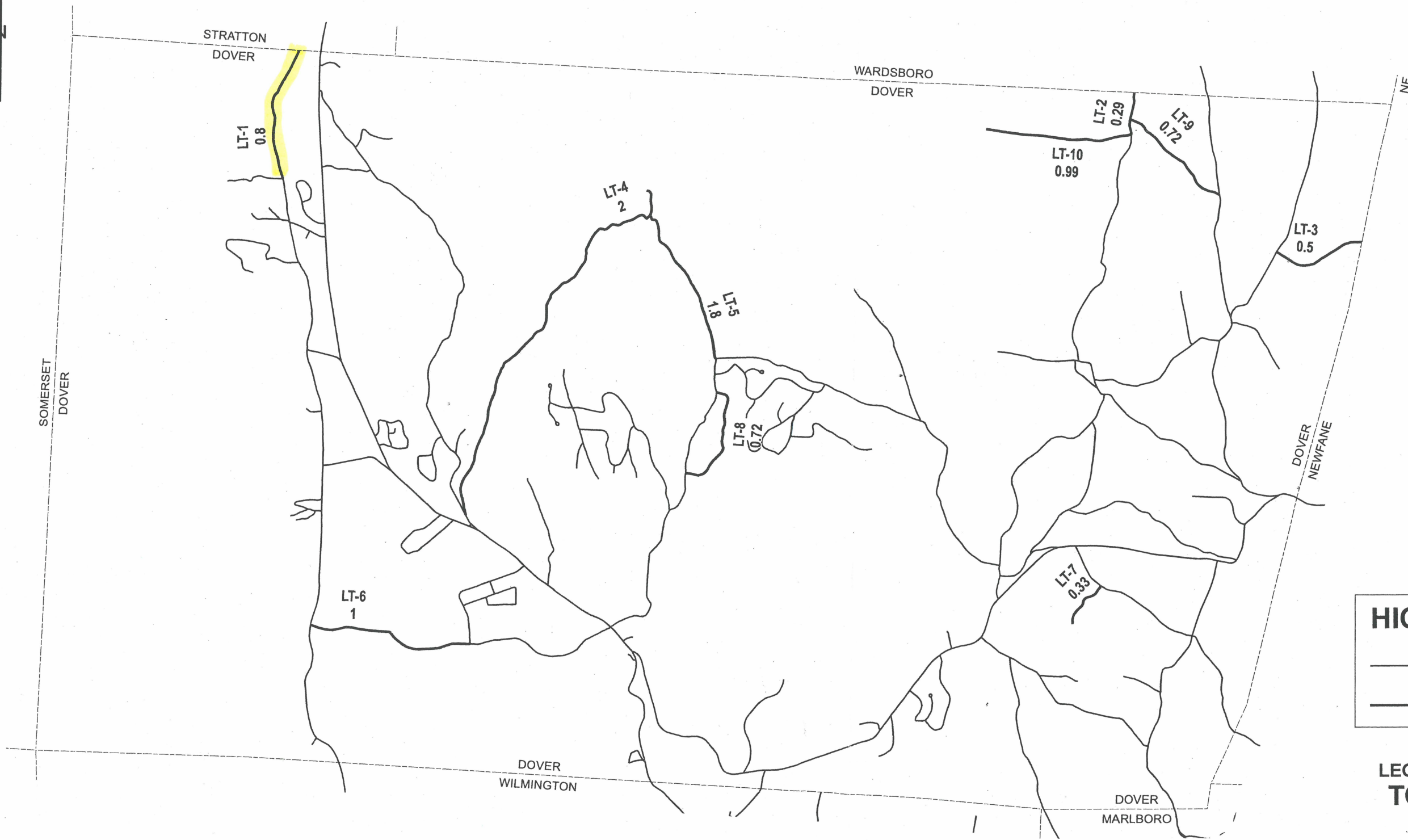

HIGHWAYS

— PUBLIC HIGHWAYS

— LEGAL TRAILS

**LEGAL TRAIL VERIFICATION
TOWN OF DOVER**

WINDHAM COUNTY

Map generated: January, 2007

SCALE: 1:43796

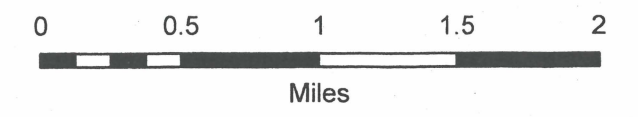

State of Vermont
Policy & Planning Division-Mapping Unit
1 National Life Drive
Montpelier, VT 05633-5001
<http://www.aot.state.vt.us>

Agency of Transportation

Telephone: 802-828-2109
Fax: 802-828-2334
Email: sara.moulton@state.vt.us

March 7, 2007

Chair, Selectboard
Dover, c/o Town Clerk
PO Box 527
West Dover, VT 05356

Dear Town Clerk and Selectboard:

Thank you for sending your 2008 Certificate of Highway Mileage. I need to follow up on the 8.14 miles of Legal Trail mileage that was entered on the certificate. Our records indicate that Dover has ten Legal Trails totaling 9.15 miles. I've enclosed a summary of our records and a copy of the Legal Trail Verification map.

It would be helpful if the town could provide clarification about the distribution of the mileage of the Legal Trails in Dover or documentation regarding the difference in mileage. In order to incorporate the possible changes as part of this year's certificate process, we need to receive the information by March 20, 2008.

If you have any questions, please call me at 802-828-2109 or send e-mail to sara.moulton@state.vt.us

Thank you.

Sincerely,



Sara Moulton
Mapping & GIS Specialist

CERTIFICATE OF HIGHWAY MILEAGE
YEAR ENDING FEBRUARY 10, 2008

MAR 03 2008

Fill out form, make and file copy with the Town Clerk, and mail ORIGINAL, before February 20, 2008 to: Vermont Agency of Transportation, Policy and Planning Division, One National Life Drive, Montpelier, VT 05633.

We, the Selectmen or Aldermen or Trustees of DOVER in WINDHAM County

on an oath state that the mileage of highways, according to Title 19, V.S.A, Sec #305, added 1985, is as follows:

PART I - CHANGES TOTALS - Please fill in and calculate totals.

Table with 6 columns: Town Highways, Previous Mileage, Added Mileage, Subtracted Mileage, Total, Scenic Highways. Rows include Class 1, Class 1 Lane, Class 2, Class 3, State Highway, Class 4, Legal Trail, and Total.

* Mileage for Class 1 Lane, Class 4, and Legal Trail classifications is NOT included in total.

PART II - INFORMATION AND DESCRIPTION OF CHANGES SHOWN ABOVE.

- 1. NEW HIGHWAYS: Please attach Selectmen's "Certificate of Completion and Opening"
2. DISCONTINUED: Please attach SIGNED copy of proceedings (minutes of meeting)
3. RECLASSIFIED/REMEASURED: Please attach SIGNED copy of proceedings (minutes of meeting)
4. SCENIC HIGHWAYS: Please attach a copy of order designating/discontinuing Scenic Highways

IF THERE ARE NO CHANGES IN MILEAGE: Check box and sign below. [X]

PART III - SIGNATURES - PLEASE SIGN.

Selectmen/ Aldermen/ Trustees Signatures:

Handwritten signatures of Marvin F. Merrill and Andrew M. Veer

T/C/V Clerk Signature:

Date Filed:

2/20/08

Please sign ORIGINAL and return it for Transportation signature.

AGENCY OF TRANSPORTATION APPROVAL: Signed copy will be returned to T/C/V Clerk.

APPROVED:

Representative, Agency of Transportation

DATE:

ACT 178 LEGAL TRAILS
 Policy and Planning Division - Mapping Unit

Legal Trail No.	Original Town Highway No.	Present Mileage	Remarks
LT-1	TH-6	0.80	0.80 CL4 to Legal Trail (1987)
LT-2	TH-19	0.29	0.29 CL4 to Legal Trail (1987)
LT-3	TH-61	0.50	0.50 CL4 to Legal Trail (1987)
LT-4	TH-62	2.00	2.00 CL4 to Legal Trail (1987)
LT-5	TH-63	1.80	1.80 CL4 to Legal Trail (1987)
LT-6	TH-64	1.00	1.00 CL4 to Legal Trail (1987)
LT-7	TH-37	0.33	0.33 CL4 to Legal Trail (1987)
LT-8	TH-74	0.72	0.72 CL3 to Legal Trail (2004)
LT-9	-	0.72	0.72 Pent Rd to Legal Trail (1991, recorded at VTrans 01/16/2007)
LT-10	-	0.99	0.99 Pent Rd to Legal Trail (1991, recorded at VTrans 01/16/2007)
		TOTAL 9.15	

State of Vermont
Agency of Transportation
Policy and Planning Division - Mapping Unit

1 National Life Drive, Drawer 33
Montpelier, VT 05633-5001
<http://www.aot.state.vt.us>

Telephone: 802-828-2109
Fax: 802-828-2334
Email: sara.moulton@state.vt.us

Chairperson, Board of Selectmen
Dover, c/o Town Clerk
PO Box 527
West Dover, VT 05356

January 2007

Below is a table summarizing the information on Legal Trails that is on file in the Mapping Unit. Act 178 of 2006 requires the measurement of trails be included on the sworn statement, the Mileage Certificate. To assist in this, we are providing a summary of the information we have on the trails that are shown on the Town Highway Maps, including mileage and former town highway number. The majority of trails were created by the reclassification of a town highway into a trail, thus the legal trail inherited an official measurement. The former town highway number is included in the FORMER_RTNAME column, and the former town highway mileage is in the AOTMILES column for each trail. VTrans has assigned a trail number, such as LT-1, to make the trails distinct. If the AOTMILES column is zero, the municipality will need to provide a mileage. The column ARCMILES contains the mileage as generated by the geometry of the trail, as digitized in the Geographic Information System (GIS). The mileages included in this table should be used as approximate mileages and the municipality should measure or verify the mileage of these trails.

A map showing the Legal Trail numbers and mileage has been included with this packet to further assist in this project. Any additional trails that exist should be added to the Mileage Certificate, as defined in the provided guidelines. Please feel free to contact us with any questions or comments regarding the above information, or the Mileage Certificates in general.

HIGHWAY / LEGAL TRAIL IDENTIFIER (RTNAME)	AOTMILES	ARCMILES	FORMER TOWN HIGHWAY NUMBER (FORMER_RTNAME)
LT-1	0.80	0.86	TH-6
LT-2	0.29	0.27	TH-19
LT-3	0.50	0.60	TH-61
LT-4	2.00	2.48	TH-62
LT-5	1.80	1.21	TH-63
LT-6	1.00	1.06	TH-64
LT-7	0.33	0.32	TH-37
LT-8	0.72	0.73	TH-74
LT-9	0.72	0.76	-
LT-10	0.99	0.94	-

If you have any questions, please call me at 802-828-2109 or send email to sara.moulton@state.vt.us

Thank you.

Sara Moulton
Sara Moulton
Mapping and GIS Specialist

LEGAL TRAIL NUMBER	LENGTH IN MILES
LT-6	1.00
LT-1	0.80
LT-4	2.00
LT-5	1.80
LT-8	0.72
LT-7	0.33
LT-3	0.50
LT-2	0.29
LT-9	0.72
LT-10	0.99

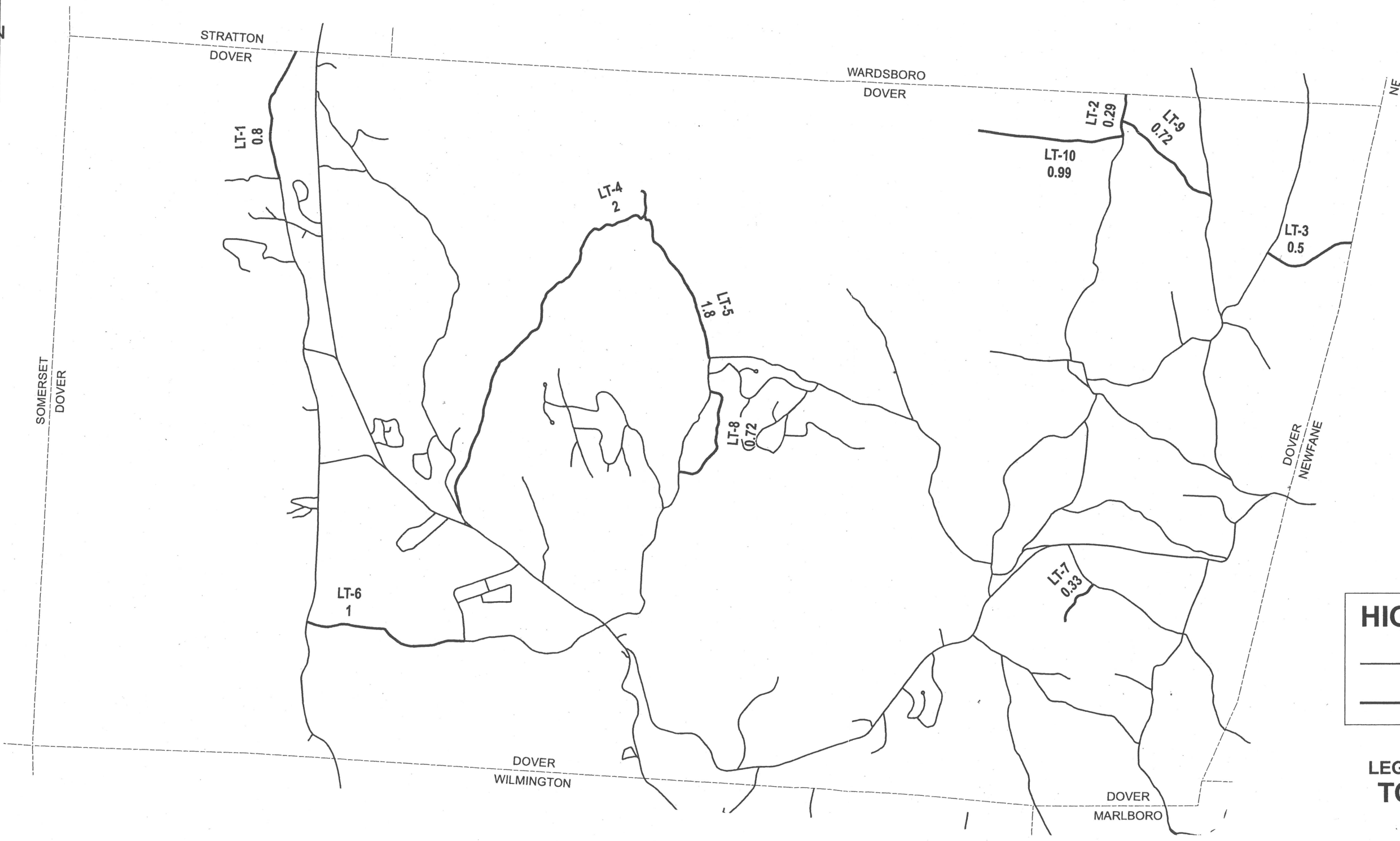

HIGHWAYS

— PUBLIC HIGHWAYS

— LEGAL TRAILS

**LEGAL TRAIL VERIFICATION
TOWN OF DOVER**

WINDHAM COUNTY

Map generated: January, 2007

SCALE: 1:43796

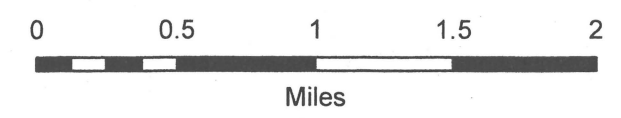

Moulton, Sara

From: Croft, Johnathan
Sent: Monday, March 10, 2008 2:41 PM
To: 'Jeff Nugent'
Cc: Moulton, Sara
Subject: RE: Dover town highway map error

Thanks, we will make the necessary surface updates.

Johnathan

-----Original Message-----

From: Jeff Nugent [mailto:jnugent@sover.net]
Sent: Monday, March 10, 2008 2:39 PM
To: Croft, Johnathan
Subject: Dover town highway map error

FIXED 14 Mar 2008

Hi Johnathan,

Working on the Dover town plan maps and noticed an error on the Dover Town Highway map. Valley View Road and Cooper Hill Road (TH 15/65) is totally paved, and I may have passed this on to your shop a couple years ago. But in one place it looks like the wrong arc got updated on the map. Apparently a section of TH 15 is a Class 4 town highway known as Valley View Trail, and this is unpaved. Valley View Road, paved, Class 3, follows TH 65 for a ways. This section is paved and should be marked as such on the map (it now shows as unpaved). The segment of TH 15 that's Class 4 (1.19 miles) is I don't know what--impassable or nearly so, but it shows as being paved. Hope that makes sense. Fairly obvious on the orthos. (I think what happened is all of TH 15 got updated as paved as it was assumed that all of TH 15 was Valley View Road). I never knew Valley View changed TH numbers in the middle.

For reference: <http://www.rpc.windham.vt.us/gis/roadname/dover.pdf>

Jeff

-
Jeff Nugent, GIS Planner
Windham Regional Commission
139 Main Street, Suite 505
Brattleboro, VT 05301
802-257-4547 x-111
www.rpc.windham.vt.us
jnugent@sover.net

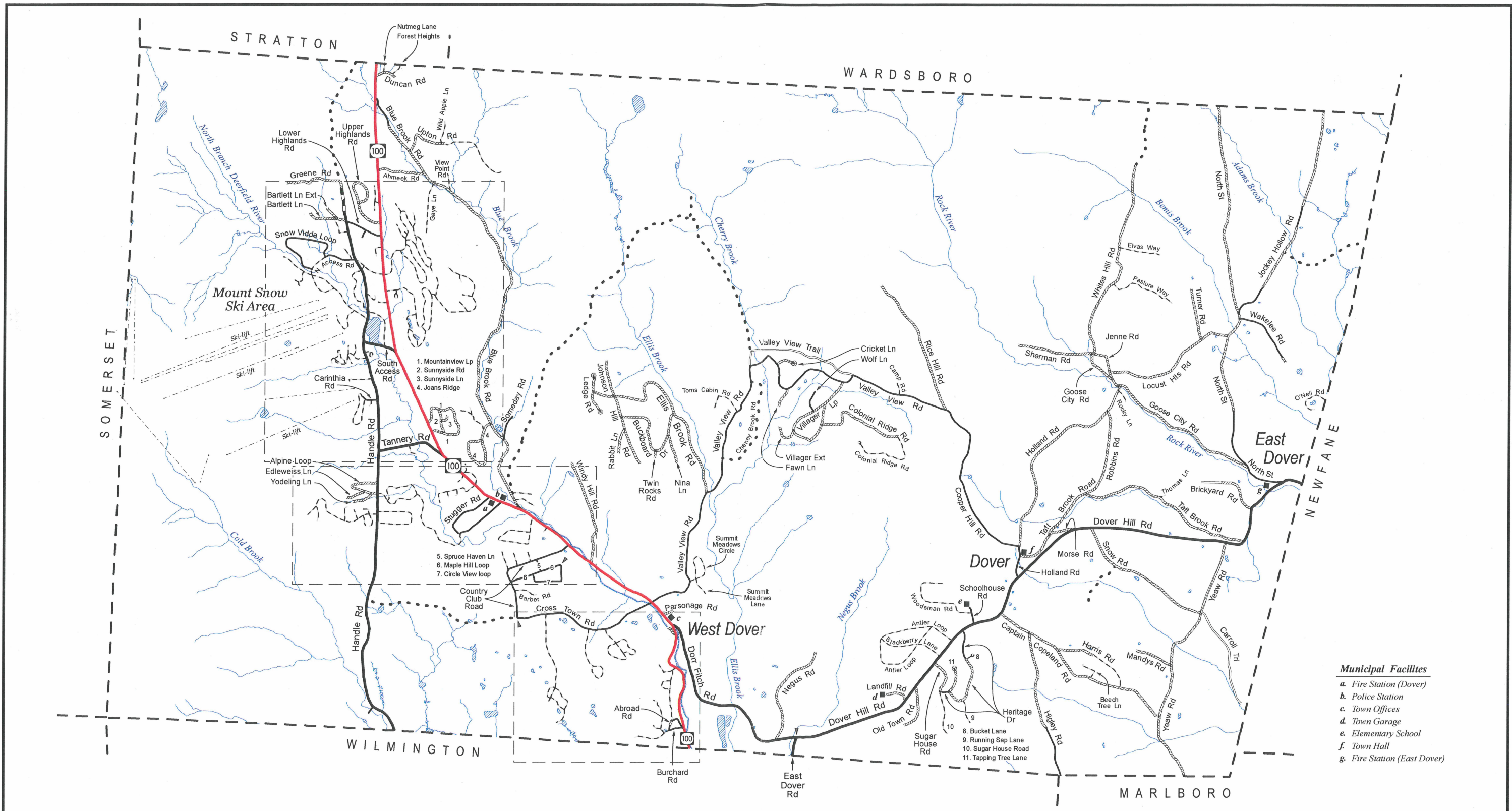

- Municipal Facilities**
- a. Fire Station (Dover)
 - b. Police Station
 - c. Town Offices
 - d. Town Garage
 - e. Elementary School
 - f. Town Hall
 - g. Fire Station (East Dover)

Road Map

Town of Dover, Vermont

January 2007

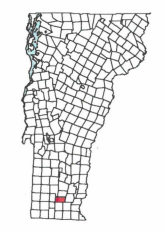
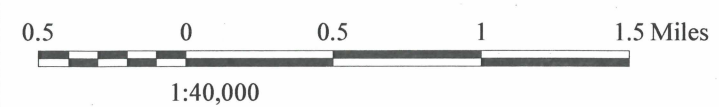

GIS
Vermont Geographic Information System

WINDHAM REGIONAL COMMISSION
139 Main St • Suite 505 • Brattleboro, VT 05301
(802) 257-4547 www.rpc.windham.vt.us

- State highway (paved)
- Class 2 town highway (paved)
- Class 2 town highway (unpaved)
- Class 3 town highway (paved)
- Class 3 town highway (unpaved)
- Class 4 town highway (unpaved)
- Legal Town Trail
- Private road/drive

Notes:

- The Town of Dover has not verified the information on this map.
- Class 4 town highways and legal town trails may be impassable to

Sources:

- Highway data are from Vt. Agency of Transportation sources (VGIS data layer RDSnnnn). Minor modifications to the data were made by Windham Regional Commission in 2006.
- Surface waters are from the Vermont Hydrography Dataset. The dataset was generated at a scale of 1:5000 and was developed using digital orthophotos, topographic maps, color infrared aerial photography and other ancillary data sources.