

CERTIFICATE OF HIGHWAY MILEAGE  
YEAR ENDING FEBRUARY 10, 2007

Vermont  
Agency of Transportation

Fill out form, make and file copy with the Town Clerk, and mail ORIGINAL, before February 20, ~~FEB 10~~ 2007  
Vermont Agency of Transportation, Policy and Planning Division, Drawer 33, Montpelier, VT 05633.

We, the Selectmen or Aldermen or Trustees of BRATTLEBORO in WINDHAM ~~County~~ Policy & Planning Division  
on an oath state that the mileage of highways, according to Title 19, V.S.A, Sec #305, added 1985, is as follows:

PART I - CHANGES TOTALS - Please fill in and calculate totals.

| Town Highways | Previous Mileage | Added Mileage | Subtracted Mileage | Total   | Scenic Highways |
|---------------|------------------|---------------|--------------------|---------|-----------------|
| Class 1       | 6.420            |               |                    | 6.420   | 0.000           |
| Class 1 Lane  | 0.503            |               |                    | 0.503   |                 |
| Class 2       | 13.900           |               |                    | 13.900  | 0.000           |
| Class 3       | 63.780           |               |                    | 63.780  | 0.000           |
| State Highway | 22.195           |               |                    | 22.195  | 0.000           |
| Class 4       | 7.800            |               | 0.33               | 7.47    | 0.000           |
| Legal Trail   | 0.000            |               |                    |         |                 |
| <b>Total</b>  | 106.295          |               | 0.33               | 106.295 | 0.000           |

\* Mileage for Class 1 Lane, Class 4, and Legal Trail classifications is NOT included in total.

PART II - INFORMATION AND DESCRIPTION OF CHANGES SHOWN ABOVE.

- NEW HIGHWAYS: Please attach Selectmen's "Certificate of Completion and Opening"
- DISCONTINUED: Please attach SIGNED copy of proceedings (minutes of meeting South end of Fisch Road TH #2 - class 4)
- RECLASSIFIED/REMEASURED: Please attach SIGNED copy of proceedings (minutes of meeting)
- SCENIC HIGHWAYS: Please attach a copy of order designating/discontinuing Scenic Highways

IF THERE ARE NO CHANGES IN MILEAGE: Check box and sign below. [ ]

PART III - SIGNATURES - PLEASE SIGN.

Selectmen/ Aldermen/ Trustees Signatures:

*Handwritten signatures of selectmen/aldermen/trustees*

T/C/V Clerk Signature: *Cornette L. Capp* Date Filed: \_\_\_\_\_

Please sign ORIGINAL and return it for Transportation signature.

AGENCY OF TRANSPORTATION APPROVAL: Signed copy will be returned to T/C/V Clerk.

APPROVED:

*Signature*  
Representative, Agency of Transportation

DATE:

*4/10/2007*

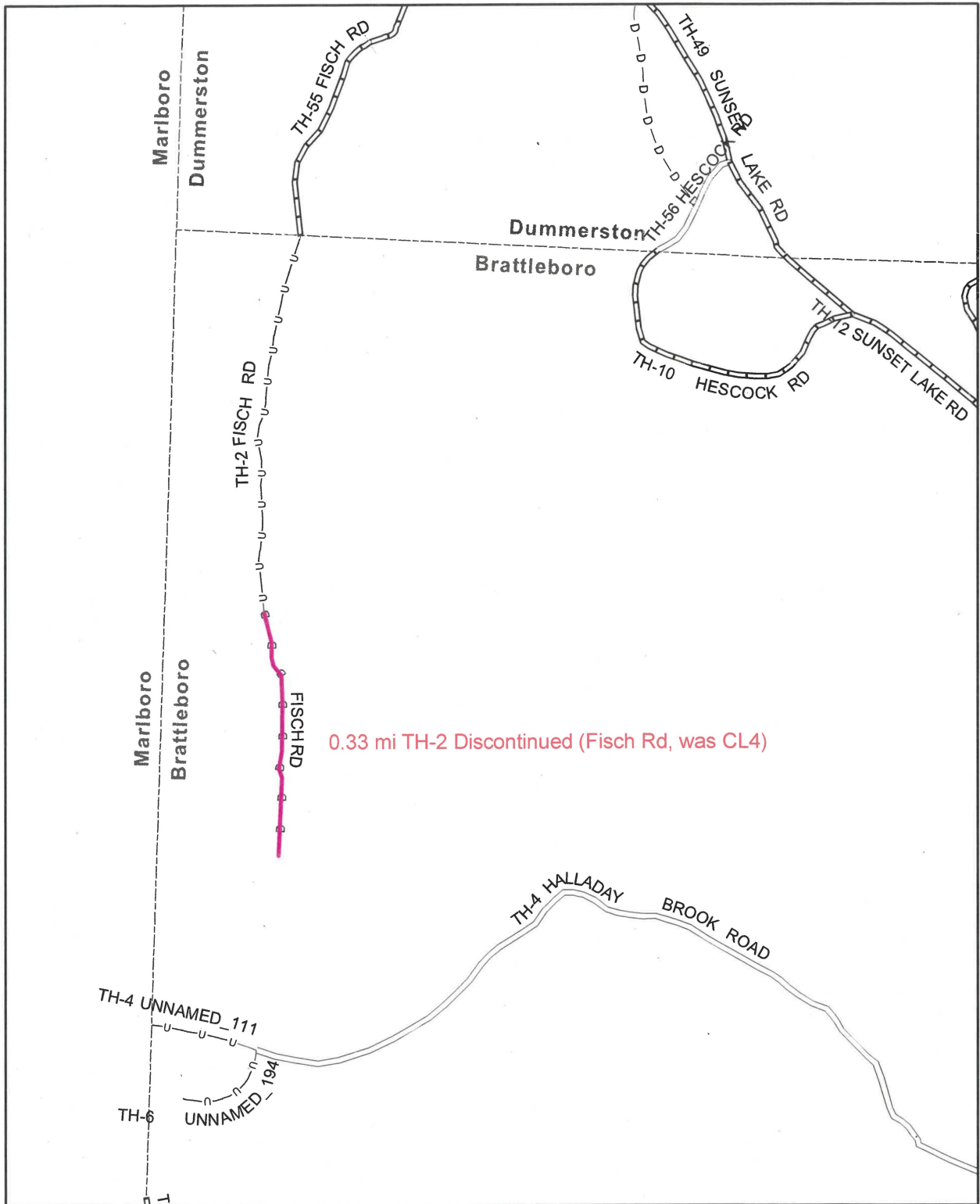

0.33 mi TH-2 Discontinued (Fisch Rd, was CL4)

**Mileage Certificate Change 2007 -- BRATTLEBORO**



Mapping Unit  
 Policy & Planning Division  
 Vermont Agency of Transportation -- February 2007



STATE OF VERMONT  
TOWN OF BRATTLEBORO

WHEREAS, at Brattleboro, Vermont, on the 5<sup>th</sup> day of September 2006, the Selectboard of the Town of Brattleboro, on their own Motion, did vote to propose that pursuant to Title 19 Vermont Statutes Annotated, Chapter 7, as amended, that the following public highways in the Town of Brattleboro be discontinued for public use:

- A) Being a portion of Fisch Road, Town Highway No. 2, a class 4 road also known as Thayer Road: From the beginning of the pent road (at the gate) leading to the premises of Muriel Wolf (tax map 05, parcel 9) southward to the terminus of Fisch Road.

WHEREFORE, the Selectboard did order and appoint that on the 17th day of October, 2006 at 4:00 p.m. they would meet at the Brattleboro Selectboard Meeting Room in Brattleboro, Vermont for the purpose of hearing all persons interested in said public highway and its discontinuance, and for the purpose of examining the premises affected thereby, and did give notice thereof to the statutory parties and to those set forth in Exhibit "A" attached hereto all being persons who own or are interested in the lands on which said proposed roads now lie or abutting on said roadways at their last known addresses; and did give notice thereof to the voters of the Town of Brattleboro by posting notices thereon on September 14, 2006 in the public places within the Town, and did

give notice to the voters of the Town of Brattleboro by causing a notice to be published in the Brattleboro Daily Reformer, a newspaper with a circulation in Brattleboro, Vermont on September 16, 2006 and did leave a copy of such notice with the Brattleboro Town Clerk

AND, afterwards, on October 17, 2006 all of the Selectboard did examine said premises, and did hold a public hearing on October 17, 2006 at 4:00 p.m. and at 6:15p.m. at the Brattleboro Selectboard Meeting Room at which time individuals appeared and gave testimony regarding said road.

AND, the Selectboard determined that the present status of the public highways is as follows:

1. That the section of road to be discontinued is a pent (gated) road which terminates within the surrounding land of Muriel Wolf and which serves no other lands or premises other than Wolf.

2. That the town has heretofore maintained the road only in the summer and has graded the road once per year.

3. That the road does not connect to any other public ways at its terminus within the Wolf premises and therefore does not provide recreational access to other town highways.

AND, after due discussion and deliberation with those in attendance and after review of the premises with the adjoining landowners, the Selectboard was of the opinion and did so vote that the necessity and convenience of the inhabitants and the

public good requires that the road be discontinued as a public road.

THEREFORE, it is ORDERED by the Selectboard that the roadway as above described be DISCONTINUED.

Dated at Brattleboro, Vermont this 17<sup>th</sup> day of ~~October~~<sup>October</sup>, 2006.

  
\_\_\_\_\_  
Stephen Steidle, Chairman

  
\_\_\_\_\_  
Richard Degray

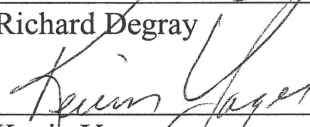
  
\_\_\_\_\_  
Kevin Yager

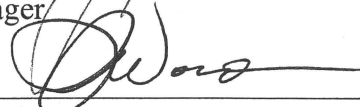
  
\_\_\_\_\_  
Greg Worden

  
\_\_\_\_\_  
Audrey Garfield

Selectboard, Town of Brattleboro

CERTIFICATE OF COMPLETION AND OPENING  
OF A HIGHWAY FOR PUBLIC TRAVEL

Annette L. Cappy, Town Clerk of the Town of Brattleboro, Vermont.

Pursuant to Title 19, V.S.A. Section 15, as amended 1989, this is to certify that the following described section of Class 4 Highway in the Town of Brattleboro was DISCONTINUED on October 17, 2006: PORTION OF FISCH ROAD (also known as THAYER ROAD).

DESCRIPTION OF RIGHT-OF-WAY: That entire portion of Fisch Road lying south of the gate marking the beginning of the pent road.

and SHOWN on the most recent General Highway Map of Brattleboro, but the Findings and Order of the Selectboard, dated <sup>October</sup> ~~October~~ 17, 2006, are filed in Volume/Book \_\_\_\_\_ on Page(s) \_\_\_\_\_ of the Highway Books/ Records of the Town of Brattleboro by the Town Clerk of Town of Brattleboro incorporated herein by reference and attested to therein by said Town Clerk.

DATED at Brattleboro, County of Windham and State of Vermont, this 17 day of October, A.D. 2006.

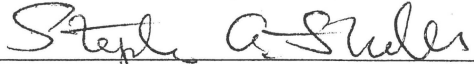
  
\_\_\_\_\_  
Stephen Steidle, Chairman

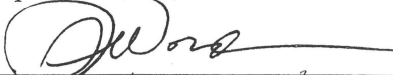
  
\_\_\_\_\_  
Greg Worden

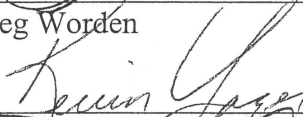
  
\_\_\_\_\_  
Kevin Yager

  
\_\_\_\_\_  
Richard DeGray

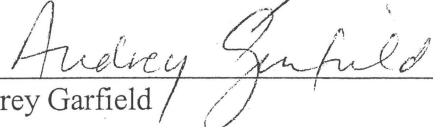
  
\_\_\_\_\_  
Audrey Garfield

Selectboard, Town of Brattleboro

Fisch Road--Discontinued Portion  
Certificate of Completion  
October 17, 2006

\_\_\_\_\_  
Jerry Remillard  
Town Manager of the Town of Brattleboro

BRATTLEBORO, VERMONT  
October 18, A.D. 2006

THE ABOVE IS A TRUE DESCRIPTION OF THE CLASS 4 HIGHWAY  
DISCONTINUED, RECORDED IN VOLUME/BOOK 2 ON PAGE(S) 142 OF  
THE TOWN RECORDS OF THE TOWN OF BRATTLEBORO ON THE 18 DAY  
OF October, 2006 AT 11:49 O'CLOCK, A M.

ATTEST: Annette L. Cappy  
Annette L. Cappy  
Town Clerk of Brattleboro, Vermont

\*Highway