

CERTIFICATE OF HIGHWAY MILEAGE

YEAR ENDING FEBRUARY 10, 2007

Vermont Agency of Transportation

Fill out form, make and file copy with the Town Clerk, and mail ORIGINAL, before February 20, 2007 Vermont Agency of Transportation, Policy and Planning Division, Drawer 33, Montpelier, VT 05633.

We, the Selectmen or Aldermen or Trustees of WORCESTER in WASHINGTON County

on an oath state that the mileage of highways, according to Title 19, V.S.A, Sec #305, added 1985, is as follows:

PART I - CHANGES TOTALS - Please fill in and calculate totals.

Table with 6 columns: Town Highways, Previous Mileage, Added Mileage, Subtracted Mileage, Total, Scenic Highways. Rows include Class 1, Class 1 Lane, Class 2, Class 3, State Highway, Class 4, Legal Trail, and Total.

* Mileage for Class 1 Lane, Class 4, and Legal Trail classifications is NOT included in total.

PART II - INFORMATION AND DESCRIPTION OF CHANGES SHOWN ABOVE.

- 1. NEW HIGHWAYS: Please attach Selectmen's "Certificate of Completion and Opening"
2. DISCONTINUED: Please attach SIGNED copy of proceedings (minutes of meeting)
3. RECLASSIFIED/REMEASURED: Please attach SIGNED copy of proceedings (minutes of meeting)
4. SCENIC HIGHWAYS: Please attach a copy of order designating/discontinuing Scenic Highways

IF THERE ARE NO CHANGES IN MILEAGE: Check box and sign below. []

PART III - SIGNATURES - PLEASE SIGN.

Selectmen/ Aldermen/ Trustees Signatures: Will H. Harris, Walt Babin, Roger R. Hill

T/C/V Clerk Signature: Carolyn J. Weese Date Filed: 2/6/07

Please sign ORIGINAL and return it for Transportation signature.

AGENCY OF TRANSPORTATION APPROVAL: Signed copy will be returned to T/C/V Clerk.

APPROVED: [Signature] DATE: 4/10/2007 Representative, Agency of Transportation

State of Vermont
Agency of Transportation
Policy and Planning Division - Mapping Unit

1 National Life Drive, Drawer 33
 Montpelier, VT 05633-5001
<http://www.aot.state.vt.us>

Telephone: 802-828-2109
 Fax: 802-828-2334
 Email: sara.moulton@state.vt.us

Chairperson, Board of Selectmen
 Worcester, c/o Town Clerk
 Drawer 161
 Worcester, VT 05682

January 2007

Below is a table summarizing the information on Legal Trails that is on file in the Mapping Unit. Act 178 of 2006 requires the measurement of trails be included on the sworn statement, the Mileage Certificate. To assist in this, we are providing a summary of the information we have on the trails that are shown on the Town Highway Maps, including mileage and former town highway number. The majority of trails were created by the reclassification of a town highway into a trail, thus the legal trail inherited an official measurement. The former town highway number is included in the FORMER_RTNAME column, and the former town highway mileage is in the AOTMILES column for each trail. VTrans has assigned a trail number, such as LT-1, to make the trails distinct. If the AOTMILES column is zero, the municipality will need to provide a mileage. The column ARCMILES contains the mileage as generated by the geometry of the trail, as digitized in the Geographic Information System (GIS). The mileages included in this table should be used as approximate mileages and the municipality should measure or verify the mileage of these trails.

A map showing the Legal Trail numbers and mileage has been included with this packet to further assist in this project. Any additional trails that exist should be added to the Mileage Certificate, as defined in the provided guidelines. Please feel free to contact us with any questions or comments regarding the above information, or the Mileage Certificates in general.

HIGHWAY / LEGAL TRAIL IDENTIFIER (RTNAME)	AOTMILES	ARCMILES	FORMER TOWN HIGHWAY NUMBER (FORMER_RTNAME)
LT-1	2.05	1.78	TH-7
LT-2	0.67	0.53	TH-8
LT-3	1.03	1.04	TH-18
LT-4	0.30	0.35	TH-22
LT-5	0.30	0.33	TH-23
LT-6	0.90	1.08	TH-24
LT-7	1.40	0.71	TH-37
LT-8	0.70	0.44	TH-38
LT-9	0.63	0.62	approx 1959
LT-10	0.20	0.20	TH-36
LT-11	0.08	0.08	TH-35
<i>Totals</i>	<i>8.26</i>	<i>7.16</i>	

If you have any questions, please call me at 802-828-2109 or send email to sara.moulton@state.vt.us

Thank you.

Sara Moulton
 Sara Moulton
 Mapping and GIS Specialist

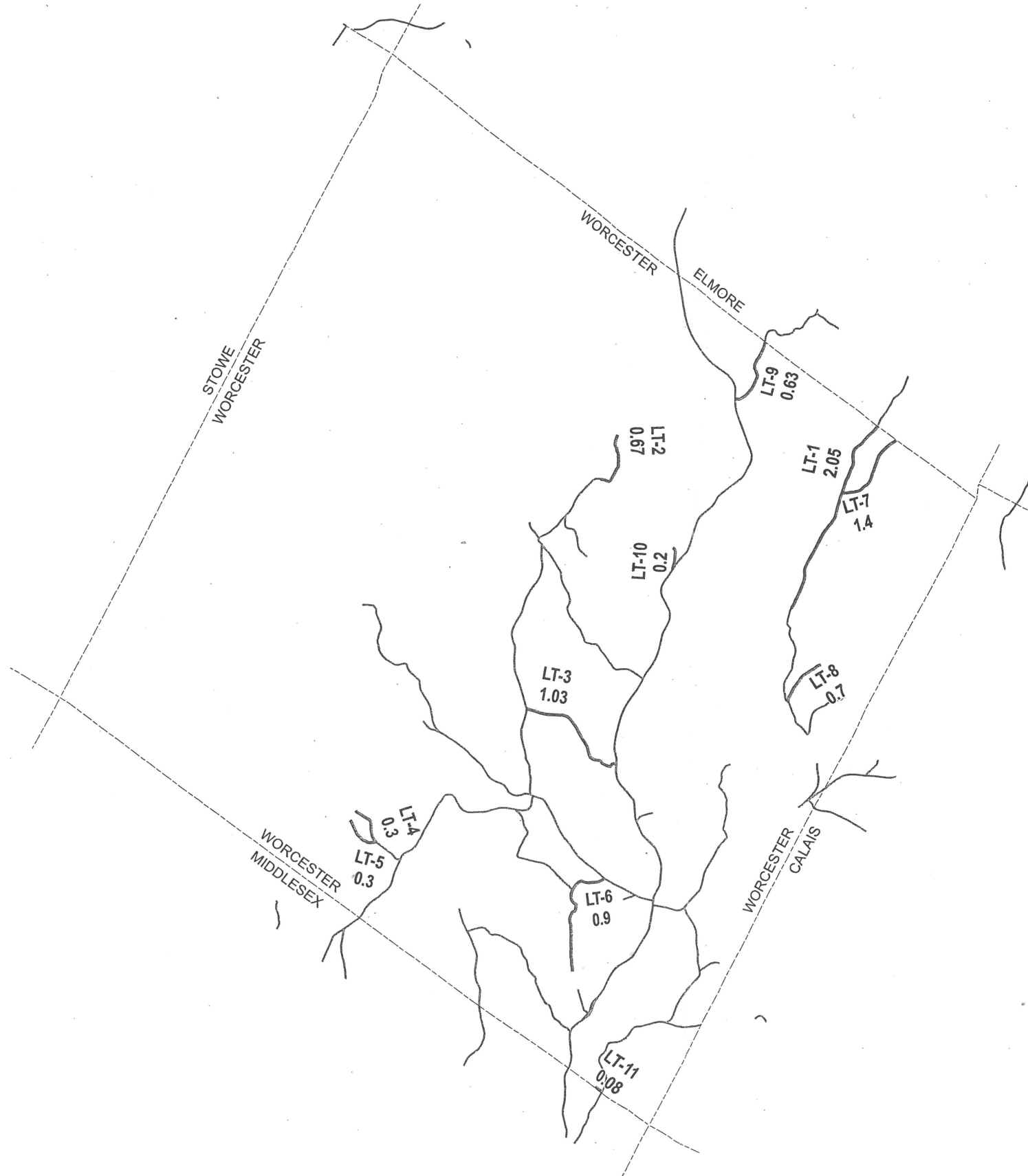

LEGAL TRAIL NUMBER	LENGTH IN MILES
LT-1	2.05
LT-10	0.2
LT-11	0.08
LT-7	1.40
LT-2	0.67
LT-9	0.63
LT-8	0.70
LT-3	1.03
LT-6	0.9
LT-5	0.3
LT-4	0.3

HIGHWAYS

— PUBLIC HIGHWAYS

— LEGAL TRAILS

**LEGAL TRAIL VERIFICATION
TOWN OF WORCESTER**

WASHINGTON COUNTY

Map generated: January, 2007

SCALE: 1:69500

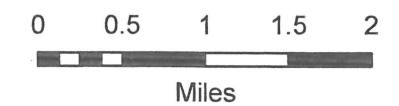

Miles