

District 9
 Certcode 1002-2

**CERTIFICATE OF HIGHWAY MILEAGE
 YEAR ENDING FEBRUARY 10, 2021**

Fill out form, make and file a copy with the Town Clerk, and submit the Mileage Certificate on or before February 20, 2021 to: Vermont Agency of Transportation, Division of Policy, Planning and Intermodal Development, Mapping Section through upload to the secure FTP site or if necessary via mail to: VTrans PPAID - Mapping Section, 2178 Airport Rd, Unit B, Berlin, VT 05641.

We, the members of the legislative body of ORLEANS VILLAGE in ORLEANS County on an oath state that the mileage of highways, according to Vermont Statutes Annotated, Title 19, Section 305, added 1985, is as follows:

PART I - CHANGES TOTALS - Please fill in and calculate totals.

Town Highways	Previous Mileage	Added Mileage	Subtracted Mileage	Total	Scenic Highways
Class 1	0.558		0.003	0.555	0.000
Class 2	1.638		0.042	1.596	0.000
Class 3	3.33				0.000
State Highway	1.758				0.000
Total	7.284		0.045	7.239	0.000
* Class 1 Lane	0.000				
* Class 4	0.32				0.000
* Legal Trail	0.00				

* Mileage for Class 1 Lane, Class 4, and Legal Trail classifications are NOT included in total.

PART II - INFORMATION AND DESCRIPTION OF CHANGES SHOWN ABOVE.

1. NEW HIGHWAYS: Please attach Selectmen's "Certificate of Completion and Opening".

2. DISCONTINUED: Please attach SIGNED copy of proceedings (minutes of meeting).

3. RECLASSIFIED/REMEASURED: Please attach SIGNED copy of proceedings (minutes of meeting).

- 0.003 mi CL1 TH-1 (VT-58) new alignment of B10
- 0.042 mi CL2 TH-2 (Memorial Square / Maple St) realignment

4. SCENIC HIGHWAYS: Please attach a copy of order designating/discontinuing Scenic Highways.

IF THERE ARE NO CHANGES IN MILEAGE: Place an X in the box and sign below.

PART III - SIGNATURES - PLEASE SIGN.

Signatures of Selectmen/ Aldermen/ Trustees:

Signature of T/C/V Clerk:

Date Filed: 1/25/2021

Please sign ORIGINAL and return it for Transportation signature.

AGENCY OF TRANSPORTATION APPROVAL: Signed copy will be returned to T/C/V Clerk.

APPROVED:

Representative, Agency of Transportation

DATE:

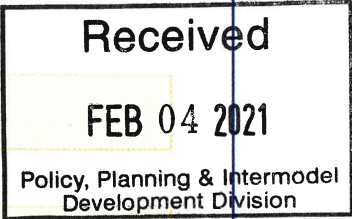

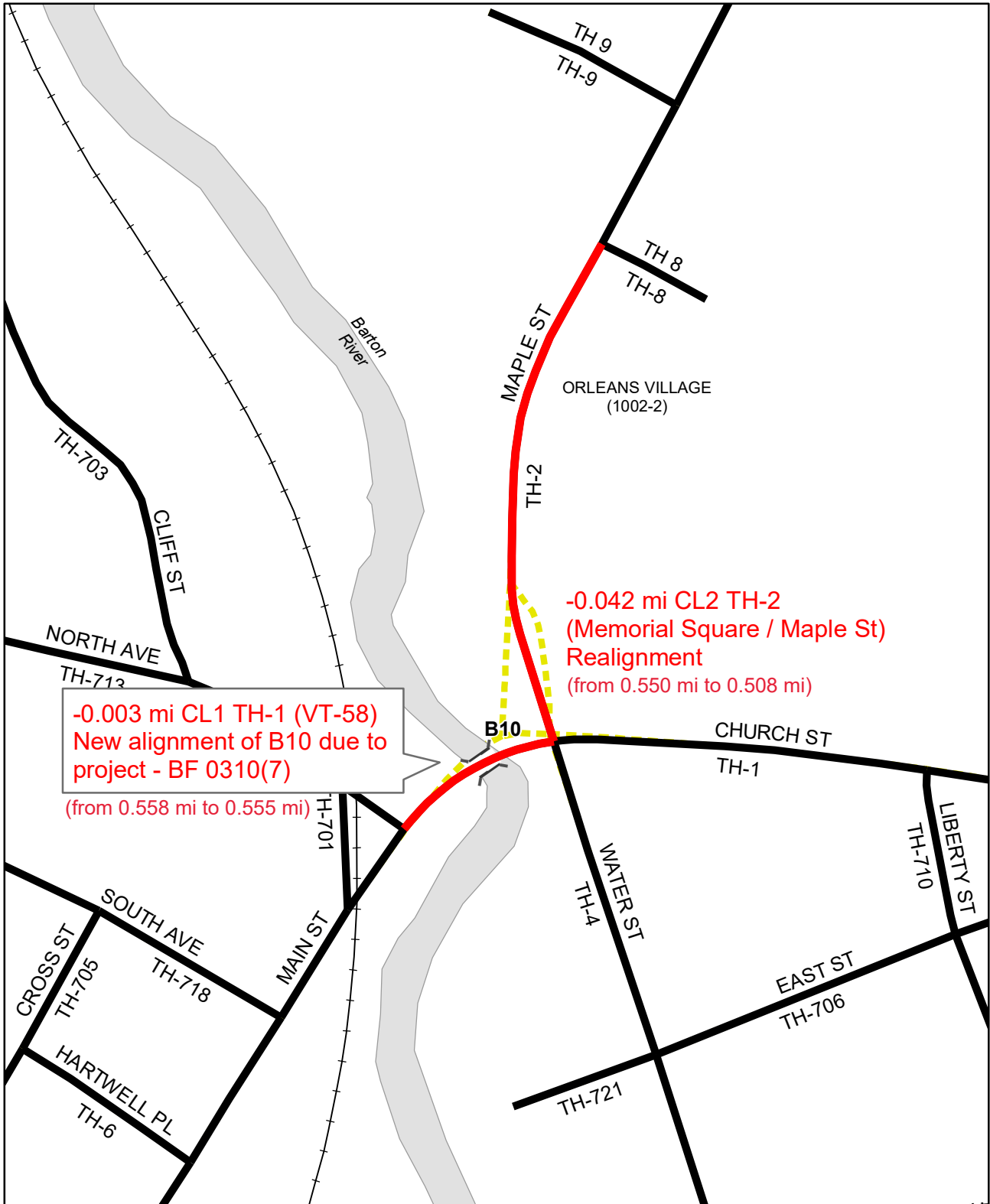

-0.003 mi CL1 TH-1 (VT-58)
 New alignment of B10 due to project - BF 0310(7)
 (from 0.558 mi to 0.555 mi)

-0.042 mi CL2 TH-2
 (Memorial Square / Maple St)
 Realignment
 (from 0.550 mi to 0.508 mi)

Mileage Certificate Changes 2021
ORLEANS VILLAGE
 (CTUA: 1002-2)

Mapping Section
 Division of Policy and Planning
 Vermont Agency of Transportation -- February 5, 2021

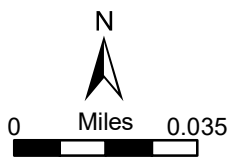

Moulton, Sara

From: Croft, Johnathan
Sent: Wednesday, January 20, 2021 3:30 PM
To: orloffice@villageforleansvt.org
Cc: AOT - Mileage Certificates; Alley, Kerry; Moulton, Sara
Subject: RE: Orleans Village Certificate of Mileage 2021

Good afternoon Marilyn,

I wanted to reach out and provide some clarification on the mileage changes Orleans. The changes are related to the new bridge (B10) on TH-1 (Main Street) in Orleans. There was a typo on the pre-loading of the mileage certificate and the notation should have read as follows:

-0.003 mi CL1 TH-1 (VT-58) new alignment of B10

-0.042 mi CL2 TH-2 (Memorial Square / Maple St) realignment

The change in mileage for class 1 TH-1 (Main Street / VT-58) is a reduction of 0.003 miles, so the ending total for 2021 should be 0.555 miles of class 1 town highway. For the class 2 town highway mileage, there was the realignment of TH-2 and the removal of Memorial Square, with prompted the reduction of 0.042 miles of class 2 town highway. The highlighted areas in the map below are where the highways were realigned or removed to reduce the class 1 and class 2 mileage.

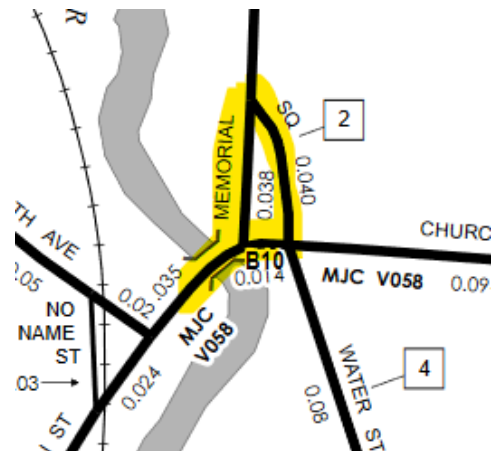

Since these mileage changes are based on a project, which includes much of the notice, public hearings, acquisition of right of way, survey and recording of documents in the town office, we are not seeking additional documentation from the Village on this changes in mileage.

For the certificate, the changes in mileage can be noted as follows:

Town Highways Mileage	Total	Previous Mileage Scenic Highways	Added Mileage	Subtracted		
Class 1		0.558	0.000	0.003	0.555	0.000
Class 2		1.638	0.000	0.042	1.596	0.000
Total		7.284	0.000	0.045	7.239	0.000

There would be no changes in class 3, state highway, class 4 or legal trail mileage.

Please let me know if this makes sense or if you need additional guidance regarding these changes and submission of the Mileage Certificate to the Mapping Section.

Johnathan

Johnathan Croft | Mapping Section Chief
Vermont Agency of Transportation
219 North Main Street | Barre, VT 05641 - Physical Address
2178 Airport Rd, Unit B | Berlin, VT 05641 - Mailing Address
802-828-2600 | johnathan.croft@vermont.gov



From: Village of Orleans <orloffice@villageoforleansvt.org>
Sent: Wednesday, January 20, 2021 11:18 AM
To: AOT - Mileage Certificates <AOT.MileageCertificates@vermont.gov>
Subject: Orleans Village Certificate of Mileage 2021

EXTERNAL SENDER: Do not open attachments or click on links unless you recognize and trust the sender.

Good Morning,

District 9 Certcode 1002-2

Our Certificate of Highway Mileage 2021 has information In Part II, #3.

This must have been entered by the State of Vermont after our bridge project.

We are not sure on how to proceed with this Certificate?

Do we need to subtract these amounts from our Class 1 totals before submitting?

Also would the minutes that are required be that the Trustees agree on the change from the State?

Thank you,

Marilyn

Marilyn Prue
Office Manager
Village of Orleans
One Memorial Square
Orleans, VT 05860
802-754-8584
orloffice@villageoforleansvt.org
mprue@villageoforleansvt.org

STATE OF VERMONT AGENCY OF TRANSPORTATION



PROPOSED IMPROVEMENT BRIDGE PROJECT

TOWN OF BARTON, ORLEANS VILLAGE
COUNTY OF ORLEANS

ROUTE NO : VT RT 58, MAJOR COLLECTOR BRIDGE NO : 10

PROJECT LOCATION : CENTER OF ORLEANS VILLAGE, AT THE
INTERSECTION OF VT ROUTE 58 (TH-1), MAPLE ST,
AND WATER ST. OVER THE BARTON RIVER.

PROJECT DESCRIPTION : COMPLETE REPLACEMENT OF BRIDGE AND
ABUTMENTS AS WELL AS BRIDGE AND
INTERSECTION REALIGNMENT.

LENGTH OF STRUCTURE : 58.94 FEET.
LENGTH OF ROADWAY : 116.02 FEET.
LENGTH OF PROJECT : 174.96 FEET.

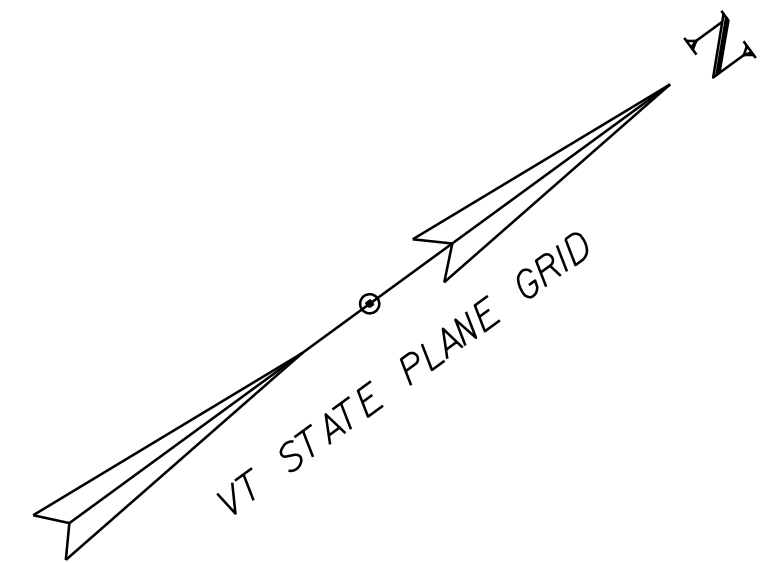
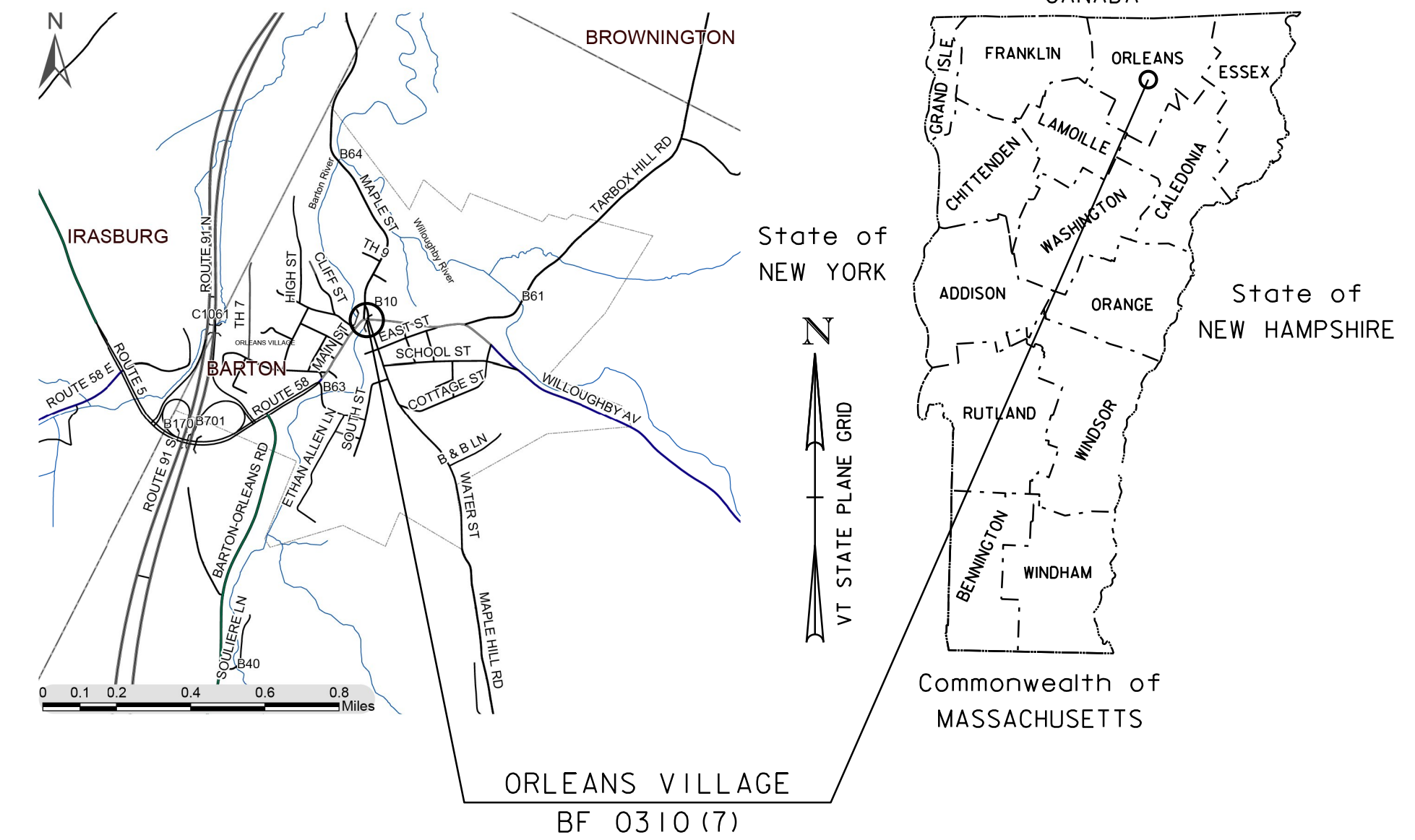
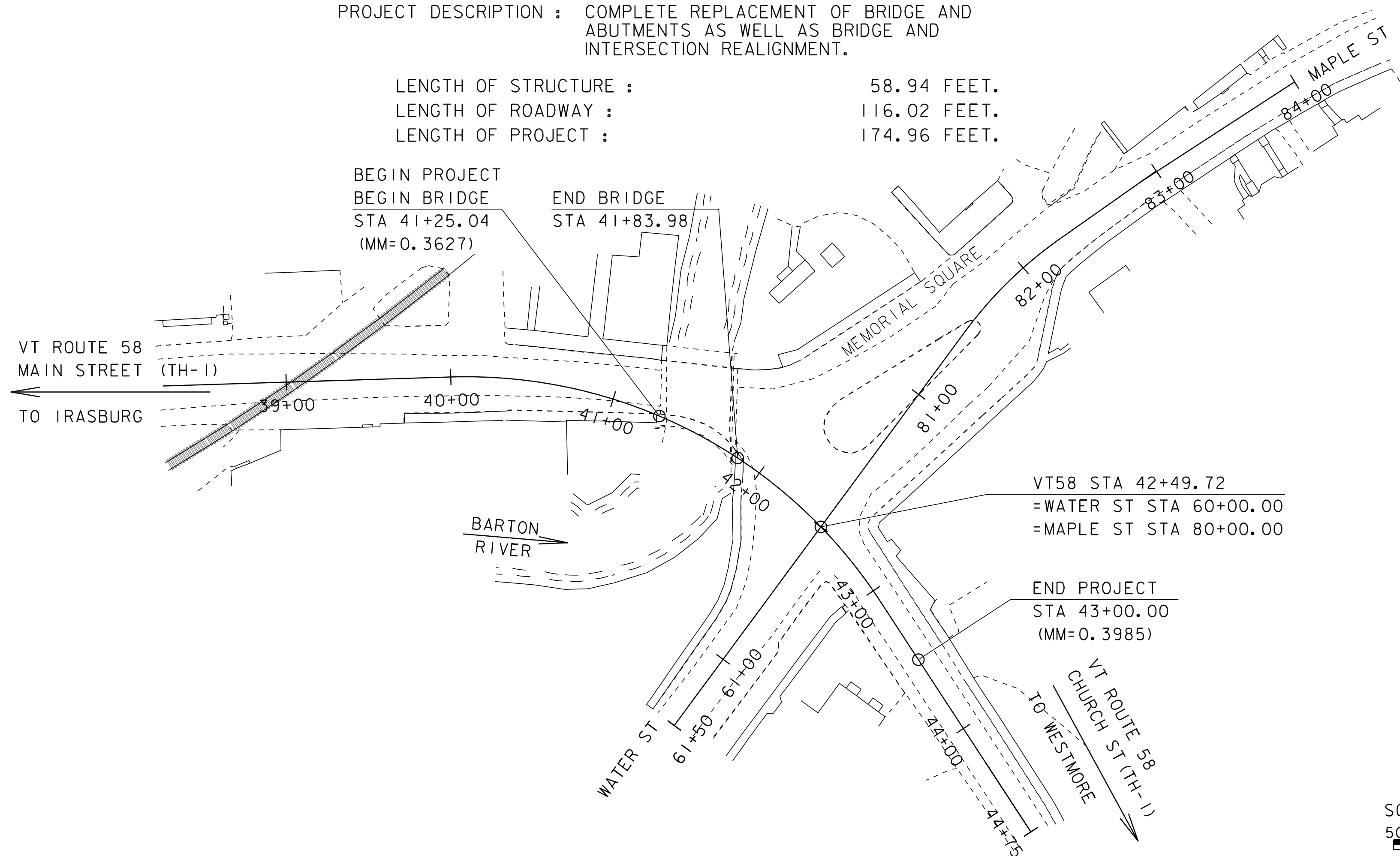

CONSTRUCTION IS TO BE CARRIED ON IN ACCORDANCE WITH THESE PLANS AND THE STANDARD SPECIFICATIONS FOR CONSTRUCTION DATED 2011, AS APPROVED BY THE FEDERAL HIGHWAY ADMINISTRATION ON JULY 20, 2011 FOR USE ON THIS PROJECT, INCLUDING ALL SUBSEQUENT REVISIONS AND SUCH REVISED SPECIFICATIONS AND SPECIAL PROVISIONS AS ARE INCORPORATED IN THESE PLANS.

QUALITY ASSURANCE PROGRAM : LEVEL 2	
SURVEYED BY :	VAOT - R. GILMAN
SURVEYED DATE :	01-26-2010
DATUM	
VERTICAL	NAVD88
HORIZONTAL	NAD83 (2007)

CHIEF ENGINEER	
APPROVED	<i>Wayne Symonds, PE</i> DATE Nov 09, 2018
PROJECT MANAGER : CAROLYN CARLSON, P.E.	
PROJECT NAME :	ORLEANS VILLAGE
PROJECT NUMBER :	BF 0310 (7)
SHEET 1 OF 72 SHEETS	

SCALE 1" = 50' - 0"
50 0 50

INDEX OF SHEETS

FINAL HYDRAULIC REPORT

PLAN SHEETS

1	TITLE SHEET
2	PRELIMINARY INFORMATION SHEET
3 - 4	TYPICAL SECTIONS 1-2
5 - 6	PROJECT NOTES 1-2
7 - 9	QUANTITY SHEET 1-3
10	BRIDGE QUANTITY SHEET
11	CONVENTIONAL SYMBOLOLOGY LEGEND SHEET
12	TIE SHEET
13 - 14	LAYOUT SHEET 1-2
15	VT58 (TH-1) PROFILE
16	RIVER ST & MAPLE ST PROFILES
17	TRAFFIC CONTROL ISLAND REMOVAL
18 - 19	TRAFFIC CONTROL PHASE 1-2
20	BRIDGE PHASING TYP & TRAF CTRL SIGNS
21	REGIONAL DETOUR
22	DETOUR EXIT DETAILS
23	DRAINAGE PROFILES
24	UTILITIES RELOCATION
25	UTILITIES WATER AND SEWER
26	UTILITY DETAILS
27	LIGHTING PLAN
28	LIGHTING & UTILITY DETAILS
29	SIGNS & PAVEMENT MARKINGS
30	TRAFFIC SIGN SUMMARY SHEET
31	BORING INFORMATION SHEET
32 - 34	BORING LOG SHEET 1-3
35	PLAN & ELEVATION
36	DECK REINFORCING
37	FRAMING PLAN
38	SUBSTRUCTURE DETAILS
39	LEVELING PLATE & OTHER DETAILS
40	FIXED BEARINGS DETAILS SHEET
41	APPROACH SLAB DETAILS
42	ABUTMENT #1
43	ABUTMENT #1 RAIL DETAILS
44	ABUTMENT #2
45	ABUTMENT #2 FOOTING PLAN & WINGWALL #4
46	WINGWALL #2
47	WINGWALL #3
48	REINFORCING STEEL SCHEDULE
49	BRIDGE RAIL LEFT DETAIL SHEET
50	BRIDGE RAIL RIGHT DETAIL SHEET
51 - 55	VT58 CROSS SECTIONS 1-5
56	MATERIAL TRANSITIONS
57 - 58	MAPLE ST CROSS SECTIONS 1-2
59 - 60	WATER ST CROSS SECTIONS 1-2
61 - 63	CHANNEL CROSS SECTIONS 1-3
64	EPSC NARRATIVE
65	EPSC EXISTING CONDITIONS
66	EPSC CONSTRUCTION CONDITIONS
67	EPSC FINAL CONDITIONS
68 - 69	EPSC DETAILS 1-2
70	R.O.W. DETAIL SHEET #1
71 - 72	R.O.W. LAYOUT SHEET 1 - 2

REFERENCE SHEETS

1 - 6	REFERENCE SHEETS (RECORD PLANS)
-------	---------------------------------

STRUCTURES & HSD DETAIL SHEETS

SD-501.00	CONCRETE DETAILS AND NOTES	02-09-2012
SD-502.00	CONCRETE DETAILS AND NOTES	10-10-2012
SD-516.10	BRIDGE JOINT ASPHALTIC PLUG	08-29-2011
SD-601.00	STRUCTURAL STEEL DETAILS AND NOTES	06-04-2010
SD-602.00	STRUCTURAL STEEL PLATE GIRDER DETAILS AND NOTES	05-02-2011
HSD-400.01	SAFETY EDGE DETAILS	01-05-2018

STANDARDS LIST

C-10	CURBING	02-11-2008
E-121	STANDARD SIGN PLACEMENT - CONVENTIONAL ROAD	08-08-1995
E-191	PAVEMENT MARKING DETAILS	02-01-1999
E-193	PAVEMENT MARKING DETAILS	08-18-1995
G-1D	STEEL BEAM GUARDRAIL DETAILS (END TERMINAL, ANCHOR, MEDIAN)	03-10-2017
G-19	GENERIC GRADING PLANS FOR GUARDRAIL END TERMINALS	11-15-2002
T-1	TRAFFIC CONTROL GENERAL NOTES	04-25-2016
T-2	TRAFFIC SIGN GENERAL NOTES	04-25-2016
T-10	CONVENTIONAL ROADS CONSTRUCTION APPROACH SIGNING	08-06-2012
T-11	CONSTRUCTION APPROACH SIGNING DIVIDED HIGHWAY ONE LANE CLOSED	08-06-2012
T-13	TRAFFIC CONTROL DIVIDED HIGHWAY ONE LANE CLOSED	08-06-2012
T-28	CONSTRUCTION SIGN DETAILS	08-06-2012
T-29	CONSTRUCTION SIGN DETAILS	08-06-2012
T-30	CONSTRUCTION SIGN DETAILS	08-06-2012
T-31	CONSTRUCTION SIGN DETAILS	08-06-2012
T-35	CONSTRUCTION ZONE LONGITUDINAL DROP-OFFS	08-06-2012
T-36	CONSTRUCTION ZONE LONGITUDINAL DROP-OFFS FOR PAVING	08-06-2012
T-40	DELINEATORS AND MILEPOSTS	01-02-2013
T-42	BRIDGE NUMBER PLAQUE	04-09-2014
T-44	MILEMARKER DETAILS STATE AND TOWN HIGHWAYS	04-09-2014
T-45	SQUARE TUBE SIGN POST AND ANCHOR	01-02-2013
T-56	STANDARD SIGN PLACEMENT	10-26-2015

HYDROLOGIC DATA

Date: May 2018

DRAINAGE AREA : 77.8 sq. mi.
 CHARACTER OF TERRAIN : Rural and urban settings, woods and fields
 STREAM CHARACTERISTICS : Sinuous and alluvial
 NATURE OF STREAMBED : Gravel and cobbles

PEAK FLOW DATA - ANNUAL EXCEEDANCE PROBABILITY (AEP)

43% =	2,700 cfs*	2% =	6,900 cfs
10% =	5,100 cfs	1% =	7,900 cfs
4% =	6,200 cfs	0.2% =	10,400 cfs

DATE OF FLOOD OF RECORD : Unknown
 ESTIMATED DISCHARGE : Unknown
 WATER SURFACE ELEV. : Unknown
 NATURAL STREAM VELOCITY : @ 2% AEP Unknown
 ICE CONDITIONS : Moderate
 DEBRIS : Light
 DOES THE STREAM REACH MAXIMUM HIGHWATER ELEV. RAPIDLY? No
 IS ORDINARY RISE RAPID? No
 IS STAGE AFFECTED BY UPSTREAM OR DOWNSTREAM CONDITIONS? No
 IF YES, DESCRIBE:

WATERSHED STORAGE: 4% HEADWATERS:
 UNIFORM: X
 IMMEDIATELY ABOVE SITE:

EXISTING STRUCTURE INFORMATION

STRUCTURE TYPE: Concrete T-Beam
 YEAR BUILT: 1933, Reconstructed in 1948
 CLEAR SPAN(NORMAL TO STREAM): 41.1'
 VERTICAL CLEARANCE ABOVE STREAMBED: 13'
 WATERWAY OF FULL OPENING: 500 sq. ft.
 DISPOSITION OF STRUCTURE: Remove and replace
 TYPE OF MATERIAL UNDER SUBSTRUCTURE: See borings

WATER SURFACE ELEVATIONS AT:

43% AEP =	731.6'	VELOCITY =	10.2 fps **
10% AEP =	735.5'	"	14.0 fps
4% AEP =	737.1'	"	15.3 fps
2% AEP =	738.1'	"	16.0 fps
1% AEP =	739.2'	"	16.8 fps

LONG TERM STREAMBED CHANGES: None noted

IS THE ROADWAY OVERTOPPED BELOW 1% AEP: No
 FREQUENCY:
 RELIEF ELEVATION: 740.1'
 DISCHARGE OVER ROAD @ 1% AEP:

UPSTREAM STRUCTURE

TOWN: Orleans Village DISTANCE: 1450'
 HIGHWAY #: TH 716 - Railroad Avenue STRUCTURE #: 63
 CLEAR SPAN: 77' CLEAR HEIGHT:
 YEAR BUILT: 1958 FULL WATERWAY:
 STRUCTURE TYPE: Rolled Beam

DOWNSTREAM STRUCTURE

TOWN: Orleans Village DISTANCE: 2500'
 HIGHWAY #: TH 2 - Maple Street STRUCTURE #: 64
 CLEAR SPAN: 65' CLEAR HEIGHT:
 YEAR BUILT: 1983 FULL WATERWAY:
 STRUCTURE TYPE: Rolled Beam

LRFR LOAD RATING FACTORS

LOADING LEVELS	TRUCK						
	H-20	HL-93	3S2	6 AXLE	3A STR.	4A STR.	5A SEM
TONNAGE	20	36	36	66	30	34.5	38
INVENTORY	2.04	1.12					
POSTING							
OPERATING	2.65	1.46	2.44	1.47	1.91	1.72	2
COMMENTS:							

PROPOSED STRUCTURE

STRUCTURE TYPE: Single Span Steel Beam
 CLEAR SPAN(NORMAL TO STREAM): 43'
 VERTICAL CLEARANCE ABOVE STREAMBED: 14.3'
 WATERWAY OF FULL OPENING: 565 sq. ft.

WATER SURFACE ELEVATIONS AT:

43% AEP =	731.3'	VELOCITY=	9.0 fps **
10% AEP =	735.0'	"	12.3 fps
4% AEP =	736.6'	"	13.5 fps
2% AEP =	737.6'	"	14.1 fps
1% AEP =	739.0'	"	15.0 fps

IS THE ROADWAY OVERTOPPED BELOW 1% AEP: No
 FREQUENCY:
 RELIEF ELEVATION: 739.9'
 DISCHARGE OVER ROAD @ 1% AEP:

BRIDGE LOW CHORD ELEVATION: 736.7' (downstream)
 FREEBOARD: @ 2% AEP = -0.9'

SCOUR: Foundations should be 6' below streambed or built to be freestanding to 6' below streambed.
 REQUIRED CHANNEL PROTECTION: Stone Fill, Type IV

PERMIT INFORMATION

AVERAGE DAILY FLOW: - DEPTH OR ELEVATION:
 ORDINARY LOW WATER: -
 ORDINARY HIGH WATER: -

TEMPORARY BRIDGE REQUIREMENTS

STRUCTURE TYPE: -
 CLEAR SPAN (NORMAL TO STREAM): -
 VERTICAL CLEARANCE ABOVE STREAMBED: -
 WATERWAY AREA OF FULL OPENING: -

ADDITIONAL INFORMATION

* flows were derived based on an area relationship with the FEMA Flood Insurance Study.
 ** velocities correspond to the bridge down (outlet) cross section.

TRAFFIC MAINTENANCE NOTES

1. MAINTAIN ONE-WAY TRAFFIC ON THE EXISTING STRUCTURE.
2. INSTALL AND MAINTAIN TRAFFIC SIGNALS.
3. INSTALL SIDEWALKS ON THE LEFT SIDE OF THE BRIDGE

DESIGN VALUES

1. DESIGN LIVE LOAD	HL-93
2. FUTURE PAVEMENT	dp: ---
3. DESIGN SPAN	L: 55.34 FT
4. MIN. MID-SPAN POS. CAMBER @ RELEASE (PRESTRESSED UNITS)	Δ: ---
5. PRESTRESSING STRAND	fy: ---
6. PRESTRESSED CONCRETE STRENGTH	f'c: ---
7. PRESTRESSED CONCRETE RELEASE STRENGTH	f'ci: ---
8. CONCRETE, HIGH PERFORMANCE CLASS AA	f'c: ---
9. CONCRETE, HIGH PERFORMANCE CLASS PCD	f'c: 4.0 KSI
10. CONCRETE, HIGH PERFORMANCE CLASS PCS	f'c: 3.5 KSI
11. CONCRETE, CLASS C	f'c: ---
12. REINFORCING STEEL	fy: 60 KSI
13. STRUCTURAL STEEL AASHTO M270 GALVANIZED	fy: 60 KSI
14. NOMINAL BEARING RESISTANCE OF SOIL	qn: 4.0 KSF
15. SOIL BEARING RESISTANCE FACTOR (REFER TO AASHTO LRFD)	φ: 0.45
16. NOMINAL BEARING RESISTANCE OF ROCK	qn: 60.0 KSF
17. ROCK BEARING RESISTANCE FACTOR (REFER TO AASHTO LRFD)	φ: 0.45
18. PILE RESISTANCE FACTOR	φ: 0.70
19. LATERAL PILE DEFLECTION	Δ: 0.70 INCH
20. BASIC WIND SPEED	V3s: ---
21. MINIMUM GROUND SNOW LOAD	pg: ---
22. SEISMIC DATA	PGA: --- Ss: --- S1: ---
23. NOMINAL AXIAL PILE RESISTANCE	222 KIPS
24. PILE YIELD STRENGTH	50 KSI
25. PILE SIZE	HP 10x57
26. ESTIMATED PILE LENGTH	15 FT

PROJECT NAME: ORLEANS VILLAGE
 PROJECT NUMBER: BF 0310(7)

FILE NAME: s13j084PI Sheet Builder.xls PLOT DATE: 16/2018
 PROJECT LEADER: C. CARLSON DRAWN BY: R. PELLETT
 DESIGNED BY: D. PETERSON CHECKED BY: D. PETERSON
PRELIMINARY INFORMATION SHEET SHEET 2 OF 72

TRAFFIC DATA

AS BUILT "REBAR" DETAIL

YEAR	ADT	DHV	% D	% T	20 year ESAL for flexible pavement from 2016 to 2036 : 5144490	AS BUILT "REBAR" DETAIL		
						LEVEL I	LEVEL II	LEVEL III
2016	4600	520	59	2	40 year ESAL for flexible pavement from 2016 to 2056 : 10288970	TYPE:	TYPE:	TYPE:
2036	4900	550	59	3	Design Speed : 30 mph	GRADE:	GRADE:	GRADE:

REMOVAL AND DISPOSAL OF GUARDRAIL
VT58 STA 41+54.9 - VT58 41+72.2 LT

REMOVAL OF EXISTING FENCE
VT58 STA 40+87.6 - 41+32.5 RT
VT58 STA 41+85.7 - 42+14.6 RT

BOX BEAM GUARDRAIL
VT58 STA 41+70.5 - 41+94.8 LT
VT58 STA 41+02.7 - 41+33.3 RT
VT58 STA 41+98.7 - 42+28.5 RT

SPECIAL PROVISION (BRIDGE RAILING,
GALVANIZED METAL BALUSTER RAILING/
CONCRETE PARAPET COMBINATION)
VT58 STA 41+16.3 - 41+71.0 LT
VT58 STA 41+33.3 - 41+98.7 RT
VT58 STA 41+16.3 - 41+17.0 LT (SIM)

REMOVAL OF EXISTING ROAD AND
SIDEWALK TO BE PAID FOR UNDER
ITEM 203.28 "EXCAVATION OF
SURFACES AND PAVEMENTS"

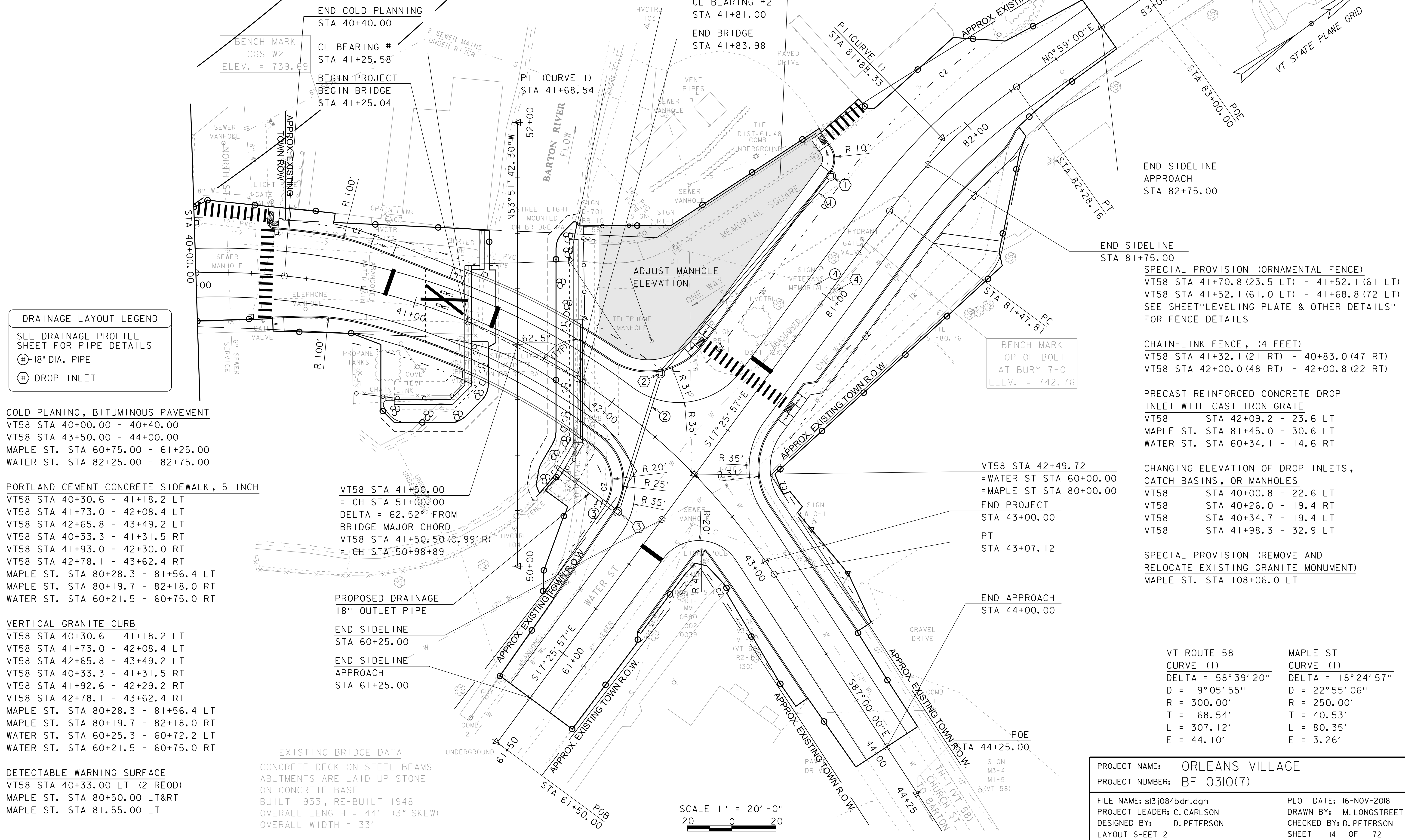

DRAINAGE LAYOUT LEGEND

SEE DRAINAGE PROFILE SHEET FOR PIPE DETAILS

⊕ 18" DIA. PIPE

⊕ DROP INLET

COLD PLANING, BITUMINOUS PAVEMENT
VT58 STA 40+00.00 - 40+40.00
VT58 STA 43+50.00 - 44+00.00
MAPLE ST. STA 60+75.00 - 61+25.00
WATER ST. STA 82+25.00 - 82+75.00

PORTLAND CEMENT CONCRETE SIDEWALK, 5 INCH
VT58 STA 40+30.6 - 41+18.2 LT
VT58 STA 41+73.0 - 42+08.4 LT
VT58 STA 42+65.8 - 43+49.2 LT
VT58 STA 40+33.3 - 41+31.5 RT
VT58 STA 41+93.0 - 42+30.0 RT
VT58 STA 42+78.1 - 43+62.4 RT
MAPLE ST. STA 80+28.3 - 81+56.4 LT
MAPLE ST. STA 80+19.7 - 82+18.0 RT
WATER ST. STA 60+21.5 - 60+75.0 RT

VERTICAL GRANITE CURB
VT58 STA 40+30.6 - 41+18.2 LT
VT58 STA 41+73.0 - 42+08.4 LT
VT58 STA 42+65.8 - 43+49.2 LT
VT58 STA 40+33.3 - 41+31.5 RT
VT58 STA 41+92.6 - 42+29.2 RT
VT58 STA 42+78.1 - 43+62.4 RT
MAPLE ST. STA 80+28.3 - 81+56.4 LT
MAPLE ST. STA 80+19.7 - 82+18.0 RT
WATER ST. STA 60+25.3 - 60+72.2 LT
WATER ST. STA 60+21.5 - 60+75.0 RT

DETECTABLE WARNING SURFACE
VT58 STA 40+33.00 LT (2 REOD)
MAPLE ST. STA 80+50.00 LT&RT
MAPLE ST. STA 81.55.00 LT

PROPOSED DRAINAGE
18" OUTLET PIPE

END SIDELINE
STA 60+25.00

END SIDELINE
APPROACH
STA 61+25.00

EXISTING BRIDGE DATA
CONCRETE DECK ON STEEL BEAMS
ABUTMENTS ARE LAID UP STONE
ON CONCRETE BASE
BUILT 1933, RE-BUILT 1948
OVERALL LENGTH = 44' (3° SKEW)
OVERALL WIDTH = 33'

VT58 STA 41+50.00
= CH STA 51+00.00
DELTA = 62.52° FROM
BRIDGE MAJOR CHORD
VT58 STA 41+50.50 (0.99' R)
= CH STA 50+98+89

VT58 STA 42+49.72
= WATER ST STA 60+00.00
= MAPLE ST STA 80+00.00

END PROJECT
STA 43+00.00

PT
STA 43+07.12

END APPROACH
STA 44+00.00

SPECIAL PROVISION (ORNAMENTAL FENCE)
VT58 STA 41+70.8 (23.5 LT) - 41+52.1 (61 LT)
VT58 STA 41+52.1 (61.0 LT) - 41+68.8 (72 LT)
SEE SHEET "LEVELING PLATE & OTHER DETAILS"
FOR FENCE DETAILS

CHAIN-LINK FENCE, (4 FEET)
VT58 STA 41+32.1 (21 RT) - 40+83.0 (47 RT)
VT58 STA 42+00.0 (48 RT) - 42+00.8 (22 RT)

PRECAST REINFORCED CONCRETE DROP INLET WITH CAST IRON GRATE
VT58 STA 42+09.2 - 23.6 LT
MAPLE ST. STA 81+45.0 - 30.6 LT
WATER ST. STA 60+34.1 - 14.6 RT

CHANGING ELEVATION OF DROP INLETS, CATCH BASINS, OR MANHOLES
VT58 STA 40+00.8 - 22.6 LT
VT58 STA 40+26.0 - 19.4 RT
VT58 STA 40+34.7 - 19.4 LT
VT58 STA 41+98.3 - 32.9 LT

SPECIAL PROVISION (REMOVE AND RELOCATE EXISTING GRANITE MONUMENT)
MAPLE ST. STA 108+06.0 LT

VT ROUTE 58 CURVE (1)	MAPLE ST CURVE (1)
DELTA = 58° 39' 20"	DELTA = 18° 24' 57"
D = 19° 05' 55"	D = 22° 55' 06"
R = 300.00'	R = 250.00'
T = 168.54'	T = 40.53'
L = 307.12'	L = 80.35'
E = 44.10'	E = 3.26'

PROJECT NAME: ORLEANS VILLAGE	FILE NAME: s13j084bdr.dgn	PLOT DATE: 16-NOV-2018
PROJECT NUMBER: BF 0310(7)	PROJECT LEADER: C. CARLSON	DRAWN BY: M. LONGSTREET
	DESIGNED BY: D. PETERSON	CHECKED BY: D. PETERSON
	LAYOUT SHEET 2	SHEET 14 OF 72

SCALE 1" = 20' - 0"
20 0 20

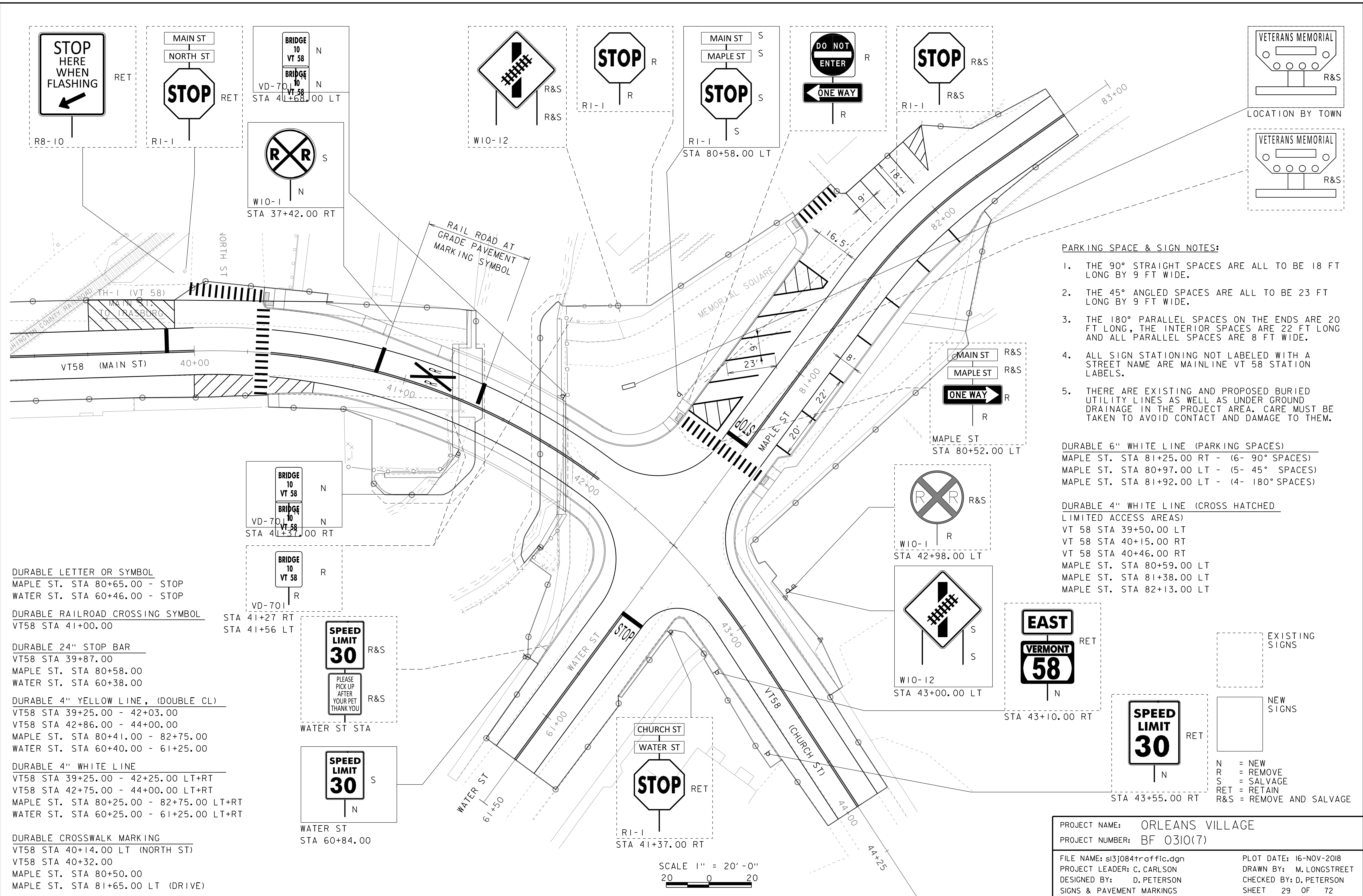

- PARKING SPACE & SIGN NOTES:**
1. THE 90° STRAIGHT SPACES ARE ALL TO BE 18 FT LONG BY 9 FT WIDE.
 2. THE 45° ANGLED SPACES ARE ALL TO BE 23 FT LONG BY 9 FT WIDE.
 3. THE 180° PARALLEL SPACES ON THE ENDS ARE 20 FT LONG, THE INTERIOR SPACES ARE 22 FT LONG AND ALL PARALLEL SPACES ARE 8 FT WIDE.
 4. ALL SIGN STATIONING NOT LABELED WITH A STREET NAME ARE MAINLINE VT 58 STATION LABELS.
 5. THERE ARE EXISTING AND PROPOSED BURIED UTILITY LINES AS WELL AS UNDER GROUND DRAINAGE IN THE PROJECT AREA. CARE MUST BE TAKEN TO AVOID CONTACT AND DAMAGE TO THEM.

DURABLE 6" WHITE LINE (PARKING SPACES)
 MAPLE ST. STA 81+25.00 RT - (6- 90° SPACES)
 MAPLE ST. STA 80+97.00 LT - (5- 45° SPACES)
 MAPLE ST. STA 81+92.00 LT - (4- 180° SPACES)

DURABLE 4" WHITE LINE (CROSS HATCHED LIMITED ACCESS AREAS)
 VT 58 STA 39+50.00 LT
 VT 58 STA 40+15.00 RT
 VT 58 STA 40+46.00 RT
 MAPLE ST. STA 80+59.00 LT
 MAPLE ST. STA 81+38.00 LT
 MAPLE ST. STA 82+13.00 LT

- DURABLE LETTER OR SYMBOL**
 MAPLE ST. STA 80+65.00 - STOP
 WATER ST. STA 60+46.00 - STOP
- DURABLE RAILROAD CROSSING SYMBOL**
 VT58 STA 41+00.00
- DURABLE 24" STOP BAR**
 VT58 STA 39+87.00
 MAPLE ST. STA 80+58.00
 WATER ST. STA 60+38.00
- DURABLE 4" YELLOW LINE, (DOUBLE CL)**
 VT58 STA 39+25.00 - 42+03.00
 VT58 STA 42+86.00 - 44+00.00
 MAPLE ST. STA 80+41.00 - 82+75.00
 WATER ST. STA 60+40.00 - 61+25.00
- DURABLE 4" WHITE LINE**
 VT58 STA 39+25.00 - 42+25.00 LT+RT
 VT58 STA 42+75.00 - 44+00.00 LT+RT
 MAPLE ST. STA 80+25.00 - 82+75.00 LT+RT
 WATER ST. STA 60+25.00 - 61+25.00 LT+RT
- DURABLE CROSSWALK MARKING**
 VT58 STA 40+14.00 LT (NORTH ST)
 VT58 STA 40+32.00
 MAPLE ST. STA 80+50.00
 MAPLE ST. STA 81+65.00 LT (DRIVE)

EXISTING SIGNS

NEW SIGNS

N = NEW
 R = REMOVE
 S = SALVAGE
 RET = RETAIN
 R&S = REMOVE AND SALVAGE

PROJECT NAME:	ORLEANS VILLAGE
PROJECT NUMBER:	BF 0310(7)
FILE NAME:	s13j084traffic.dgn
PROJECT LEADER:	C. CARLSON
DESIGNED BY:	D. PETERSON
SIGNS & PAVEMENT MARKINGS	
PLOT DATE:	16-NOV-2018
DRAWN BY:	M. LONGSTREET
CHECKED BY:	D. PETERSON
SHEET	29 OF 72

SCALE 1" = 20'-0"
 20 0 20