

Certcode 1016-0

YEAR ENDING FEBRUARY 10, 2025

Fill out form, make and file a copy with the Town Clerk, and submit the Mileage Certificate on or before February 20, 2024 to: Vermont Agency of Transportation, Division of Policy, Planning and Intermodal Development, Mapping Section via email to: aot.mileagecertificates@vermont.gov or if necessary via mail to: VTrans PPAID - Mapping Section, 219 North Main Street, Barre VT 05641.

We, the members of the legislative body of NEWPORT TOWN in ORLEANS County on an oath state that the mileage of highways, according to Vermont Statutes Annotated, Title 19, Section 305, added 1985, is as follows:

PART I - CHANGES TOTALS - Please fill in and calculate totals.

Town Highways	Previous Mileage	Added Mileage	Subtracted Mileage	Total	Scenic Highways
Class 1	0.000			-	0.000
Class 2	11.750			11.750	0.000
Class 3	33.43	0.69	0.03	34.09	0.000
State Highway	10.253			10.253	0.000
Total	55.433			56.093	0.000
* Class 1 Lane	0.000			-	
* Class 4	11.50		0.68	10.82	0.000
* Legal Trail	0.00			-	

* Mileage for Class 1 Lane, Class 4, and Legal Trail classifications are NOT included in total.

PART II - INFORMATION AND DESCRIPTION OF CHANGES SHOWN ABOVE.

1. NEW HIGHWAYS: Please attach Selectmen's "Certificate of Completion and Opening".

Changes to TH-25 and TH-26 added and "No Changes" box unchecked by K.Alley (VTrans) as per attached email correspondence dated 2/6/2025.

2. DISCONTINUED: Please attach SIGNED copy of proceedings (minutes of meeting).

3. RECLASSIFIED/REMEASURED: Please attach SIGNED copy of proceedings (minutes of meeting).

0.38 mi CL4/NUTS TH-25 (Clark Mountain Rd) no longer NUTS (now fully CL3)
-0.03 mi CL3 TH-25 (Clark Mountain Rd) remeasure

0.30 mi CL4/NUTS TH-26 (Clark Mountain Rd) no longer NUTS (now fully CL3)
+0.01 mi CL3 TH-26 (Clark Mountain Rd) remeasured

4. SCENIC HIGHWAYS: Please attach a copy of order designating/discontinuing Scenic Highways.

IF THERE ARE NO CHANGES RECORDED THIS YEAR: Place an X in the box and sign below.

PART III - SIGNATURES - PLEASE SIGN.

Signatures of Selectmen/ Aldermen/ Trustees:



Signature of T/C/V Clerk: 

Date Filed: 1-15-25

Please sign ORIGINAL and return it for Transportation signature.

AGENCY OF TRANSPORTATION APPROVAL: Signed copy will be returned to T/C/V Clerk.

APPROVED:

DocuSigned by:

John H. ...
8B1F350F309C4C9...

Representative, Agency of Transportation

DATE: 5/15/2025

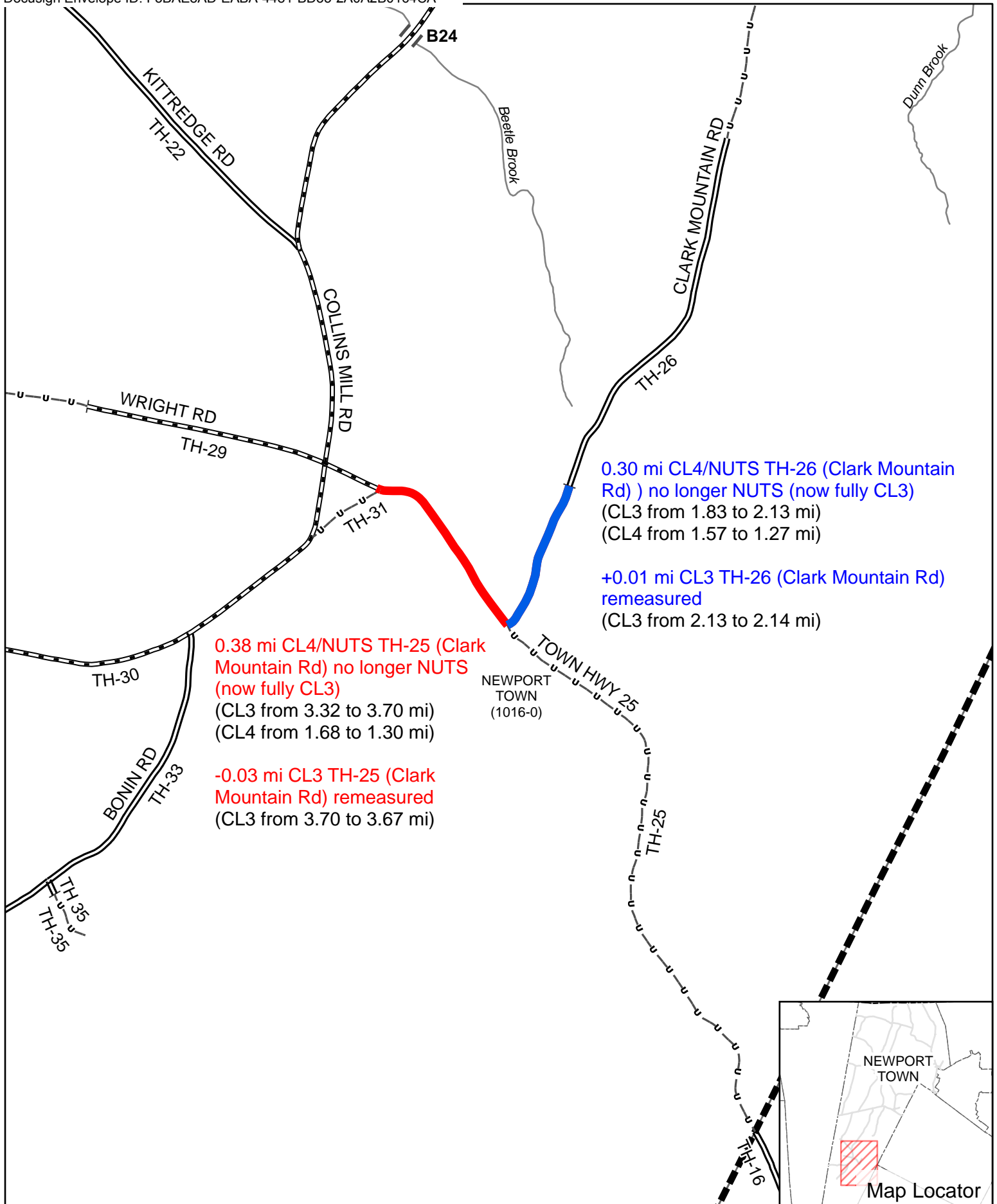

Mileage Certificate Changes 2025 NEWPORT TOWN

(CTUA:1016-0)
(CERTCODE:1016-0)

Alley, Kerry

From: Denise Daigle Denise Daigle <nctownclerk@comcast.net>
Sent: Thursday, February 6, 2025 12:09 PM
To: Alley, Kerry
Subject: RE: Which parts of Newport Town's Clark Mountain Rd have winter maintenance?

EXTERNAL SENDER: Do not open attachments or click on links unless you recognize and trust the sender.

Yes please could you make the correction? Thanks so much Denise

Denise Daigle

Town of Newport Clerk and Treasurer

PO Box 85

Newport Center, VT 05857

802-334-6442

On 02/06/2025 11:22 AM EST Alley, Kerry <kerry.alley@vermont.gov> wrote:

Good morning Denise,

Thank you for passing the information about Clark Mountain Rd along to me! Because it is now being maintained through to 834 Clark Mountain Road (where it becomes truly class 4), the Not Up To Standard (NUTS) designation can be removed from the 0.38 mi segment that I highlighted in the Town Highway Map excerpt below:

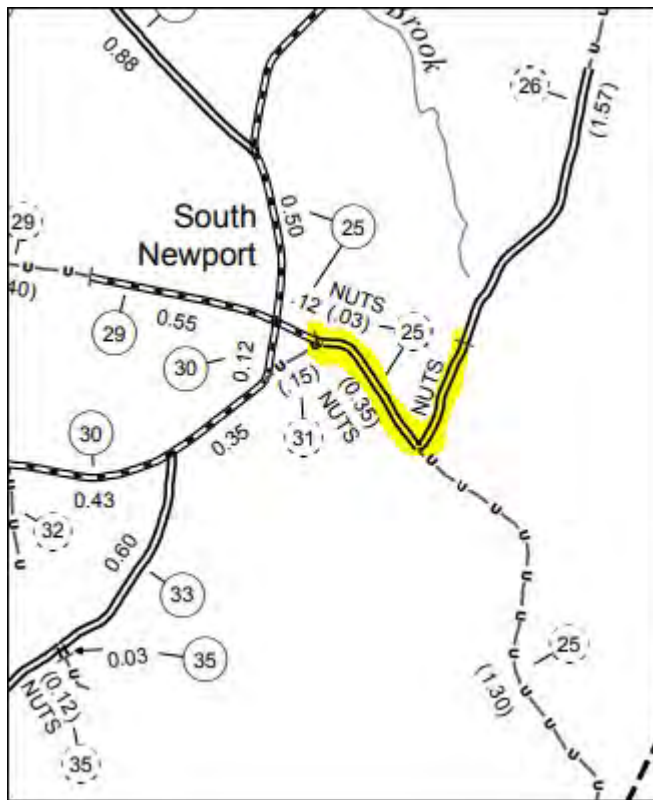

Removing the NUTS designation does not require any additional documentation because that segment was already legally class 3, and its mileage was only being included in the class 4 mileage total because of the NUTS designation (which due to the field inventory from 1984 indicating that it wasn't being maintained to class 3 standards at that time).

Therefore, if the Selectboard says it is ok, I will add the following changes to Newport Town's 2025 Mileage Certificate:

TH-25

0.38 mi CL4/NUTS TH-25 (Clark Mountain Rd) no longer NUTS (now fully CL3)

-0.03 mi CL3 TH-25 (Collins Mill Rd and Clark Mountain Rd) remeasured

(That basically means that we are removing the NUTS designation from 0.38 mi of TH-25, but then we also need to remeasure the total class 3 portion of TH-25 because our mapping software suggests that it has 3.64 mi instead of 3.70 mi)

TH-26

0.30 mi CL4/NUTS TH-26 (Clark Mountain Rd)) no longer NUTS (now fully CL3)

+0.01 mi CL3 TH-25 (Clark Mountain Rd) remeasured

(That basically means that we are removing the NUTS designation from 0.30 mi of TH-26, but we also need to remeasure the total class 3 portion of TH-26 because our mapping software suggests that it has 0.31 mi instead of 0.30 mi)

Therefore, in total, the class 3 mileage total will increase by 0.66 mi, and the class 4 mileage will decrease by 0.67 mi. If the Selectboard agrees to this, I will add these changes to the Certificate, add an initialed explanatory note to the certificate, and attach our correspondence regarding this adjustment to the Certificate before having it signed by the Agency and returned to the Town.

Feel free to reach out to me if anyone has questions about this, and thanks for your help keeping our data as current and accurate as possible!

Kerry

Policy, Planning & Research Bureau – Mapping Section

Policy, Planning & Intermodal Development Division

Vermont Agency of Transportation

219 North Main Street | Barre, VT 05641

802-917-2621 (cell) | Kerry.Alley@vermont.gov

<http://vtrans.vermont.gov/planning/maps>

From: Denise Daigle Denise Daigle <nctownclerk@comcast.net>
Sent: Wednesday, January 8, 2025 1:33 PM
To: Alley, Kerry <Kerry.Alley@vermont.gov>
Subject: RE: Which parts of Newport Town's Clark Mountain Rd have winter maintenance?

EXTERNAL SENDER: Do not open attachments or click on links unless you recognize and trust the sender.

We go to 834 Clark Mountain Road so up to 834 is a class 3 road

Denise Daigle

Town of Newport Clerk and Treasurer

PO Box 85

Newport Center, VT 05857

802-334-6442

On 01/07/2025 11:52 AM EST Alley, Kerry <kerry.alley@vermont.gov> wrote:

Thank you, Denise!

Maybe this clarification will help:

I'm interested In knowing if Clark Mountain Rd is maintained to class 3 standards up to the driveway of 686 Clark Mountain Rd (which is about 0.30 mi past the sharp left turn on Clark Mountain Rd). I've also attached an image that highlights in pink the portion of Clark Mountain Rd that is currently NUTS, with areal imagery and home addresses also shown for reference.

We only need to confirm that there is class 3 maintenance to restore the mileage of the NUTS sections to Newport's class 3 mileage totals, but if any of the class 4 portion of TH-26 (i.e. past the drive mentioned above) is also being maintained to class 3 standards, then it would be good for the Town to consider reclassifying it from class 4 to class 3.

If the road foreman needs further clarification, then it might be easiest if I spoke with him directly (by phone or email)

Thanks again for your help!

Kerry

From: Denise Daigle Denise Daigle <nctownclerk@comcast.net>
Sent: Tuesday, January 7, 2025 8:36 AM
To: Alley, Kerry <Kerry.Alley@vermont.gov>
Subject: Re: Which parts of Newport Town's Clark Mountain Rd have winter maintenance?

EXTERNAL SENDER: Do not open attachments or click on links unless you recognize and trust the sender.

I checked with our road foreman and he said we do maintain what is in yellow, we think. Without a mileage designation it is very hard to tell. He would like to know how many miles the yellow section is before he says it is class 3 with 100% certainty. Thanks Denise

Denise Daigle

Town of Newport Clerk and Treasurer

PO Box 85

Newport Center, VT 05857

802-334-6442

On 01/02/2025 3:12 PM EST Alley, Kerry
<kerry.alley@vermont.gov> wrote:

Happy New Year Denise,

I will be sending out Newport Town's 2025 Certificate of Highway Mileage at some point in the next few days, and I wanted to check with the Town to find out if portions of Clark Mountain Rd (the parts of TH-25 and TH-26 that are highlighted yellow in the map excerpt below) are now being maintained to class 3 standards. Note that to be considered class 3, the roads must also have winter maintenance. If this is the case, then we can remove the "Not Up To Standards" (NUTS) designation so that the mileage of these segments will again be included in Newport's class 3 mileage totals. Could you or another Town Official look into this and let us know? If the NUTS designation should indeed be removed, I can send you instructions of what to write on the Certificate to make sure this happens.

Thank you very much for your help keeping the Newport Town Highway Map as current and accurate as possible!

Kerry

<http://vtrans.vermont.gov/planning/maps>

