

District 9
Certcode 1004-0

**CERTIFICATE OF HIGHWAY MILEAGE
YEAR ENDING FEBRUARY 10, 2020**

Fill out form, make and file copy with the Town Clerk, and mail ORIGINAL, before February 20, 2020 to:
Vermont Agency of Transportation, Division of Policy, Planning and Intermodal Development, Mapping Section
219 N. Main Street, Barre, VT 05641.

We, the members of the legislative body of CHARLESTON in ORLEANS County
on an oath state that the mileage of highways, according to Vermont Statutes Annotated, Title 19, Section 305,
added 1985, is as follows:

PART I - CHANGES TOTALS - Please fill in and calculate totals.

Town Highways	Previous Mileage	Added Mileage	Subtracted Mileage	Total	Scenic Highways
Class 1	0.000				0.000
Class 2	10.150				0.000
Class 3	30.36				0.000
State Highway	13.910				0.000
Total	54.420				0.000
* Class 1 Lane	0.000				
* Class 4	8.51		0.63	7.88	0.000
* Legal Trail	6.33	0.63		6.96	

S.M.

* Mileage for Class 1 Lane, Class 4, and Legal Trail classifications are NOT included in total.

PART II - INFORMATION AND DESCRIPTION OF CHANGES SHOWN ABOVE.

- NEW HIGHWAYS:** Please attach Selectmen's "Certificate of Completion and Opening".
- DISCONTINUED:** Please attach SIGNED copy of proceedings (minutes of meeting).
- RECLASSIFIED/REMEASURED:** Please attach SIGNED copy of proceedings (minutes of meeting).
0.63 mi CL4 TH-19 (Batchelder Rd) reclassified as LT-5
- SCENIC HIGHWAYS:** Please attach a copy of order designating/discontinuing Scenic Highways.

Received
JAN 30 2020
Policy, Planning & Intermodal
Development Division

IF THERE ARE NO CHANGES IN MILEAGE: Check box and sign below. []

PART III - SIGNATURES - PLEASE SIGN.

Selectmen/ Aldermen/ Trustees Signatures:

Pete Morkonts
Larry J. Gray

T/C/V Clerk Signature:

Terry L. Gray

Date Filed:

1-27-2020

Please sign ORIGINAL and return it for Transportation signature.

AGENCY OF TRANSPORTATION APPROVAL: Signed copy will be returned to T/C/V Clerk.

APPROVED:

E-SIGNED by Johnathan Croft
on 2020-07-09 12:53:42 EDT
Representative, Agency of Transportation

DATE: July 09, 2020

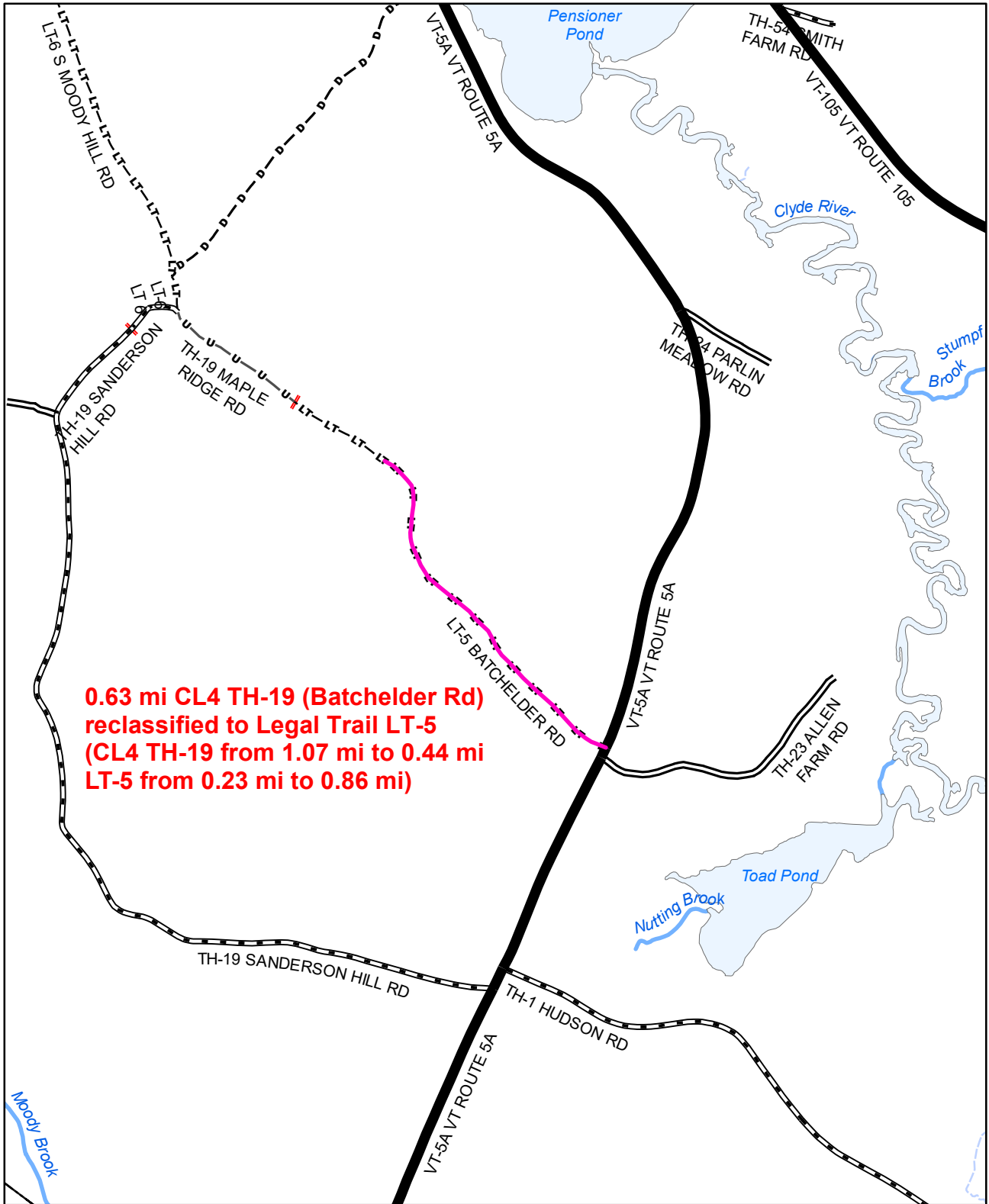

Mileage Certificate Change 2020

CHARLESTON

(CERTCODE: 1004-0)

Mapping Section
 Division of Policy, Planning and Intermodal Development
 Vermont Agency of Transportation -- February 24, 2020

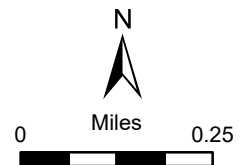

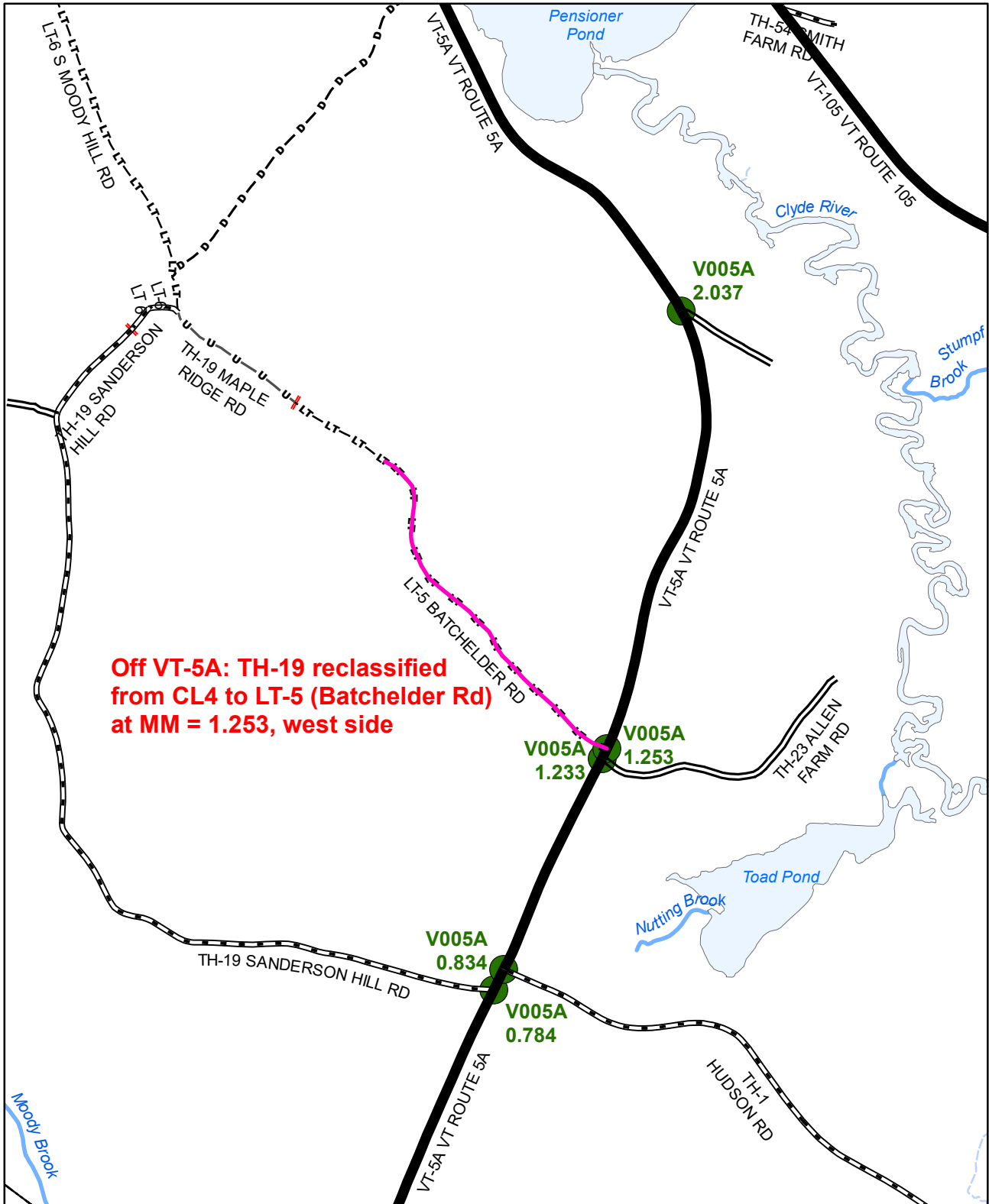

Mileage Certificate Change 2020

CHARLESTON

(CERTCODE: 1004-0)

Mapping Section
 Division of Policy, Planning and Intermodal Development
 Vermont Agency of Transportation -- February 24, 2020

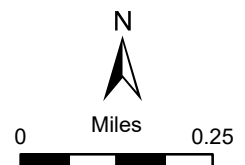

Town of Charleston

5063 Vt. Rte. 105
W Charleston VT 05872
Phone No: (802) 895-2814
Fax No: (802) 895-2714
townofcharlestonvt@comcast.net
www.charlestonvt.org

November 26, 2019

Jonathan Croft
VTrans Mapping Section
Div. of Policy, Planning and Intermodal Development
1 National Life Drive
Montpelier, VT 05633-5001

Dear Jonathan:

Please find enclosed a decision order regarding a section of Charleston Town Highway #19, which was recently reclassified from Class 4 highway to Legal Trail. Changes are indicated on the enclosed Charleston highway map and mileage table.

Please contact me if you have any questions about this. Thank you.

Best Regards,

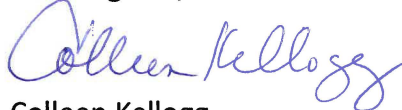

Colleen Kellogg
Asst Town Clerk & Treasurer



COPY

**Order and Report
of Selectboard, Town of Charleston**

Re: Batchelder Road, November 2019

Pursuant to V.S.A. Title 19, a public hearing was held on November 14, 2019 at 6:00 pm at the Charleston Town Clerk's office with regard to taking action as described below to reclassify the following town highway located entirely within the Town of Charleston:

Reclassify the .63 mile Class 4 section of Town Highway 19, which begins at VT Route 5A, from a Class 4 highway to a Legal Trail. This section of TH19 is known as Batchelder Road.

Resolved that if the Selectboard determines that the public good, safety, necessity and convenience of the inhabitants for the Town of Charleston requires that said highway be downgraded, this action will be so ordered.

Prior notice as required by law was duly provided by certified mail to all adjoining landowners and interested parties on October 15, 2019:

- Deborah Lussier Trust (adjoining landowner)
- Jackson Allen (adjoining landowner)

Notice was hand-delivered to the Charleston Planning Commission on the same day. Also on October 15th, notice was further provided by posting at the Charleston Town Clerk, East and West Charleston Post Offices, Scampy's Deli, and Charlestonvt.org, and notice was published in the Chronicle, the newspaper of record, in the October 23, 2019 edition.

Selectboard Chair Glenn Peterson opened the November 14th hearing by stating that the reclassification had been requested by all adjoining landowners on this section of the road.

There were no residents, property owners or other members of the public in attendance. The only testimony was a letter from adjoining landowner Jackson Allen in support of the proposal. The Selectboard agreed to take up the matter at their regular business meeting that night at 7:00 pm, and the matter was on the publicly-noticed Selectboard Meeting Agenda. Members of the Selectboard conducted a site visit on October 15, 2019, pursuant to statute.

At the November 14th Selectboard meeting, a motion was made by Mr. Young to reclassify the .63 mile section to a legal trail thereby restricting motorized vehicle access to abutting landowners only, seconded by Mr. Peterson and unanimously approved. The Selectboard offers the following reasons for their decision:

Regarding the proposal to reclassify the Class 4 section of Batchelder Road to a Legal Trail, and the public hearing held earlier that evening on the matter, board members have heard no objections. It is the judgement of the Selectboard that the necessity and convenience of current and future landowners abutting this road advise that the town maintain a right-of-way to ensure access to affected properties. A legal trail would maintain this right-of-way.

It is also the judgement of the Selectboard that the two adjoining landowners have endured excessive damage and vandalism to the road and roadsides, mostly due to ATV use, and reclassification to a legal trail would address this ongoing problem by permitting only adjoining landowners to use motorized vehicles on the road—a restriction set by state statute on legal trails. Further, reclassification to a legal trail lessens maintenance obligations on a road used by only two landowners, an important consideration for taxpayers. The board does not feel that reclassification presents an inconvenience to current landowners or the public.

It is therefore the decision of the Town of Charleston Selectboard that the 0.63 miles of TH #19 known as Batchelder Rd, beginning at VT Route 5A, shall be reclassified to a legal trail, and added to Legal Trail #5. As a result, the length of LT #5 increases from 0.23 miles to 0.86 miles. Correspondingly, the Class 4 portion of TH #19 reduces from 1.07 miles to 0.44 miles.

Dated at Charleston in the County of Orleans and State of Vermont, this 14 th day of NOVEMBER 2019.

Selectboard of Charleston



Glenn Peterson, Chair



Peter Moskovites

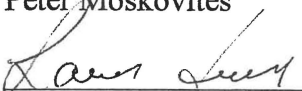

Larry Young

Pursuant to Title 19, V.S.A., section 740, you may appeal this decision to the Superior Court of the county in which the property is situated in accordance with Rule 74 of the Vermont Rules of the Civil Procedure. Said appeal is commenced by filing a notice of appeal with the Town Clerk within 30 days of the day this decision was mailed to you by the Town Clerk. [Insert Date]

COPY

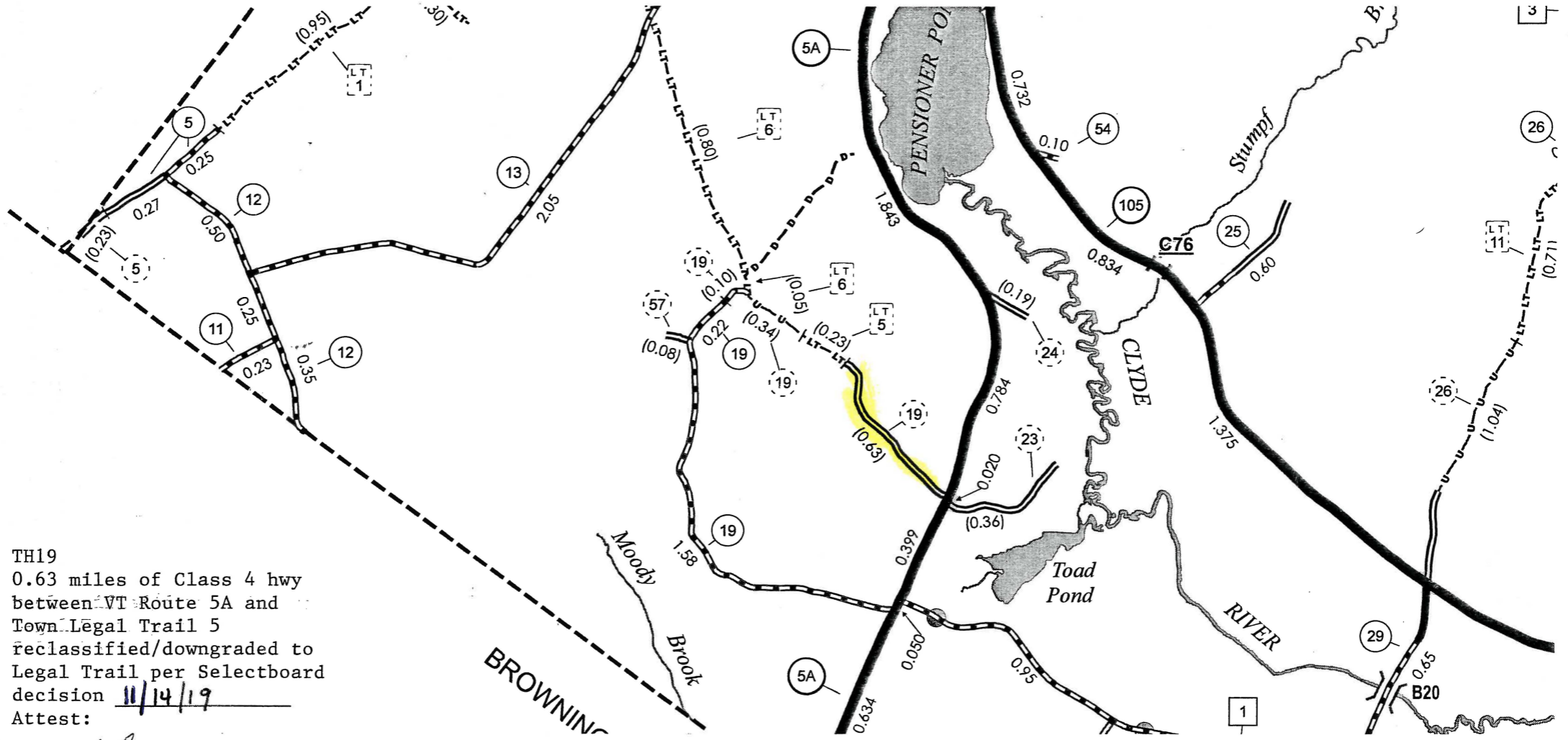

TH19
0.63 miles of Class 4 hwy
between VT Route 5A and
Town Legal Trail 5
reclassified/downgraded to
Legal Trail per Selectboard
decision 11/14/19
Attest:

He Acton
Chair, Charleston Selectboard

COPY

TOWN HWY. No.	LENGTH IN MILES	
	CLASS 3	CLASS 4
3	0.80	
5	2.12	(0.87)
6	1.05	
7	0.26	
8	0.10	
9	0.20	
10	0.20	
11	0.23	
12	1.10	
13	3.10	
16	1.80	
17	1.10	
19	1.80	(1.07)
23		(0.36)
24		(0.19)
25	0.60	
26	0.04	(1.04)
27	1.20	
28		(1.80)
29	0.65	
30	0.73	
31		(0.15)
32		(0.80)
33	2.23	
34	0.60	
35	0.19	
36		(0.95)
38	1.15	
39	2.05	
40	0.15	
41	0.84	(0.25)
42	0.46	(0.54)
43	2.75	
44	0.60	
45	0.77	
46		(0.35)
47	0.10	
48	0.09	
51	0.15	
52	0.90	
54	0.10	
56	0.07	
57		(0.08)
59	0.08	
TOTAL	30.36	8.45

TH 19
(0.44)
CL 4

LEGAL TRAIL No.	LENGTH IN MILES
	LEGAL TRAIL
1	(0.95)
2	(0.30)
3	(1.00)
4	(0.28)
5	(0.23)
6	(0.85)
7	(0.61)
8	(0.30)
9	(0.25)
10	(0.70)
11	(0.71)
12	(0.15)
TOTAL	6.33

LT 5
NOW
0.86

TOWN HWY. No.	LENGTH IN MILES "NOT UP TO STANDARD"
5	(0.06)
TOTAL	0.06

* The sections of the town highways listed above are legally Class 3, but have been deemed "Not Up To Standard" and are functionally Class 4 Town Highways

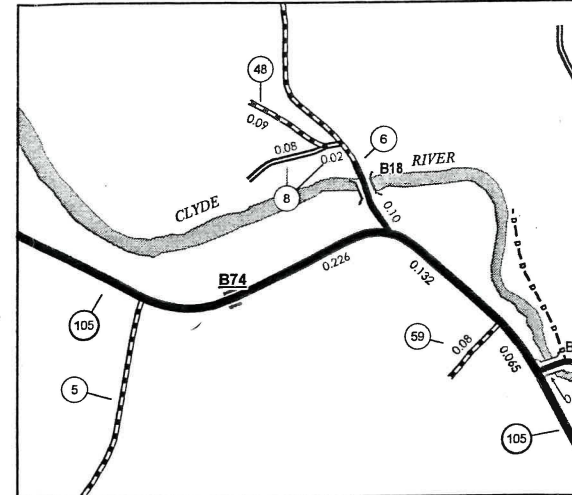
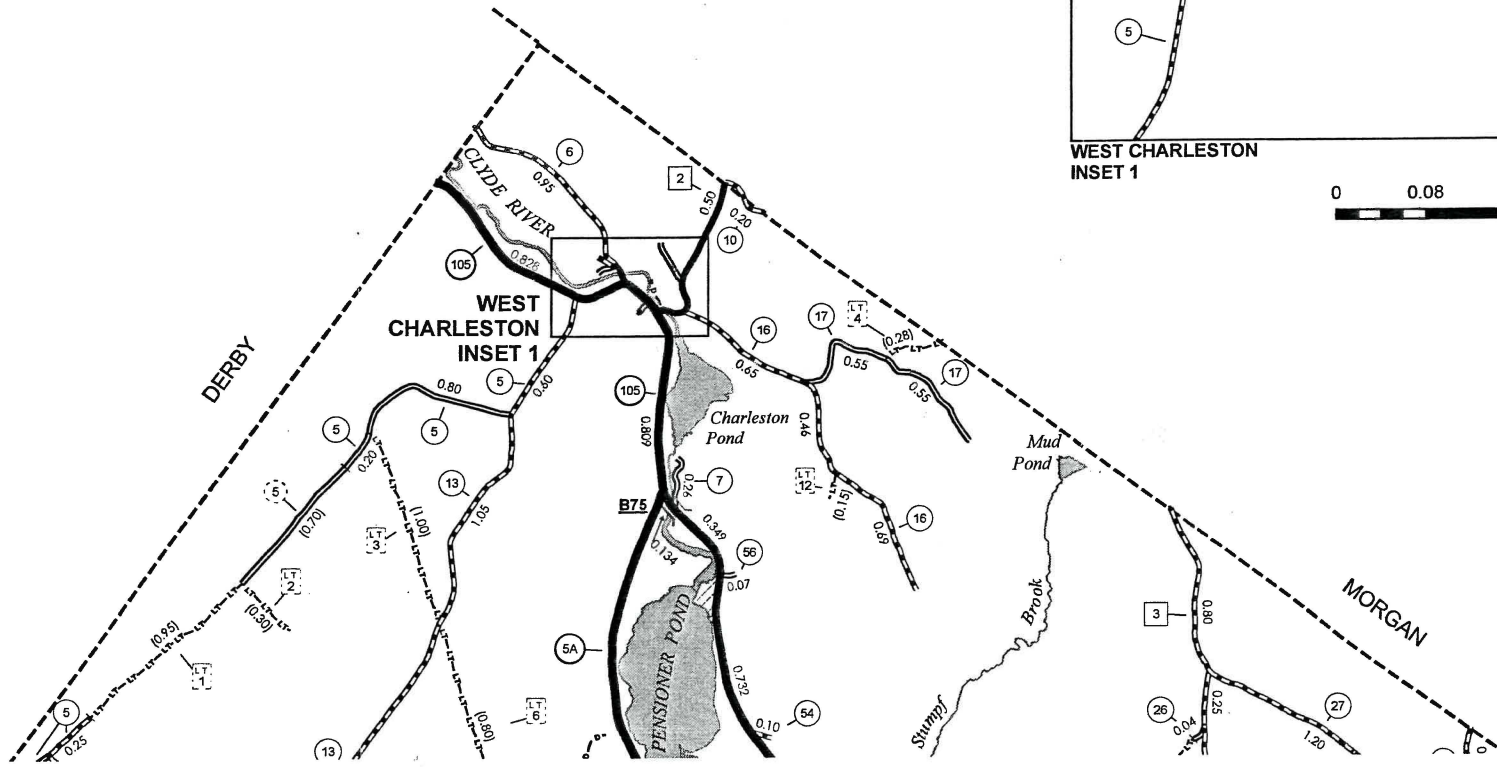

WEST CHARLESTON INSET 1

0 0.08 0.16 Miles

268,000

264,000