

CERTIFICATE OF HIGHWAY MILEAGE

YEAR ENDING FEBRUARY 10, 2008

Fill out form, make and file copy with the Town Clerk, and mail ORIGINAL, before February 20, 2008 to: Vermont Agency of Transportation, Policy and Planning Division, One National Life Drive, Montpelier, VT 05633.

We, the Selectmen or Aldermen or Trustees of GLASTENBURY (UNORG) in BENNINGTON County on an oath state that the mileage of highways, according to Title 19, V.S.A, Sec #305, added 1985, is as follows:

PART I - CHANGES TOTALS - Please fill in and calculate totals.

Table with 6 columns: Town Highways, Previous Mileage, Added Mileage, Subtracted Mileage, Total, Scenic Highways. Rows include Class 1, Class 1 Lane, Class 2, Class 3, State Highway, Class 4, Legal Trail, and Total.

* Mileage for Class 1 Lane, Class 4, and Legal Trail classifications is NOT included in total.

PART II - INFORMATION AND DESCRIPTION OF CHANGES SHOWN ABOVE.

- 1. NEW HIGHWAYS: Please attach Selectmen's "Certificate of Completion and Opening"
2. DISCONTINUED: Please attach SIGNED copy of proceedings (minutes of meeting)
3. RECLASSIFIED/REMEASURED: Please attach SIGNED copy of proceedings (minutes of meeting)
4. SCENIC HIGHWAYS: Please attach a copy of order designating/discontinuing Scenic Highways

IF THERE ARE NO CHANGES IN MILEAGE: Check box and sign below. []

PART III - SIGNATURES - PLEASE SIGN.

Selectmen/ Aldermen/ Trustees Signatures: _____

T/C/V Clerk Signature: _____ Date Filed: _____

Please sign ORIGINAL and return it for Transportation signature.

AGENCY OF TRANSPORTATION APPROVAL: Signed copy will be returned to T/C/V Clerk.

APPROVED: [Signature] DATE: 1/15/08
Representative, Agency of Transportation

Moulton, Sara

From: Blanchard, Nelson
Sent: Wednesday, September 26, 2007 8:58 AM
To: Croft, Johnathan
Cc: Moulton, Sara; Gammell, Wayne
Subject: RE: Reclassification of Class 4 to Class 3 Town Highways in **Glastenbury**

Yes, the roads are in a condition to be maintained as Class 3 highways. The District performs the winter maintenance on both TH-1 and TH-2 all winter and they are kept passable. We also perform the summer maintenance. Mr. Harrington is requesting that all of TH-1 and TH-2 be reclassified to Class 3 and Wayne and I agree with his request.

*Nelson E. Blanchard
District #1 Technician
359 Bowen Road
Bennington, VT 05201
(802)447-6924
Email: nelson.blanchard@state.vt.us*

-----Original Message-----

From: Croft, Johnathan
Sent: Tuesday, September 25, 2007 1:01 PM
To: Gammell, Wayne; Blanchard, Nelson
Cc: Moulton, Sara
Subject: Reclassification of Class 4 to Class 3 Town Highways in Glastenbury

Wayne & Nelson,

I received a request for town highway reclassification from Rickey Harrington, Supervisor for Glastenbury. Based on statute, the Secretary has the authority to act as the Selectboard in the reclassification process. The statute is noted below:

CHAPTER 1. STATE HIGHWAY LAW - § 7. Secretary; powers and duties

(i) The secretary shall assume the powers and duties of a selectboard in highway matters in unorganized towns and gores pursuant to section 16 of this title.

Before I contact Rickey Harrington, I have some questions. Are the roads in a condition to be maintained as Class 3? Are you doing any winter maintenance and keeping the roads passable in the winter? What roads are requested to be upgraded, all of TH-1 and TH-2, or parts? Any info that you can provide would be helpful.

Thanks,

Johnathan Croft
VTrans Mapping Unit
(802) 828-2600

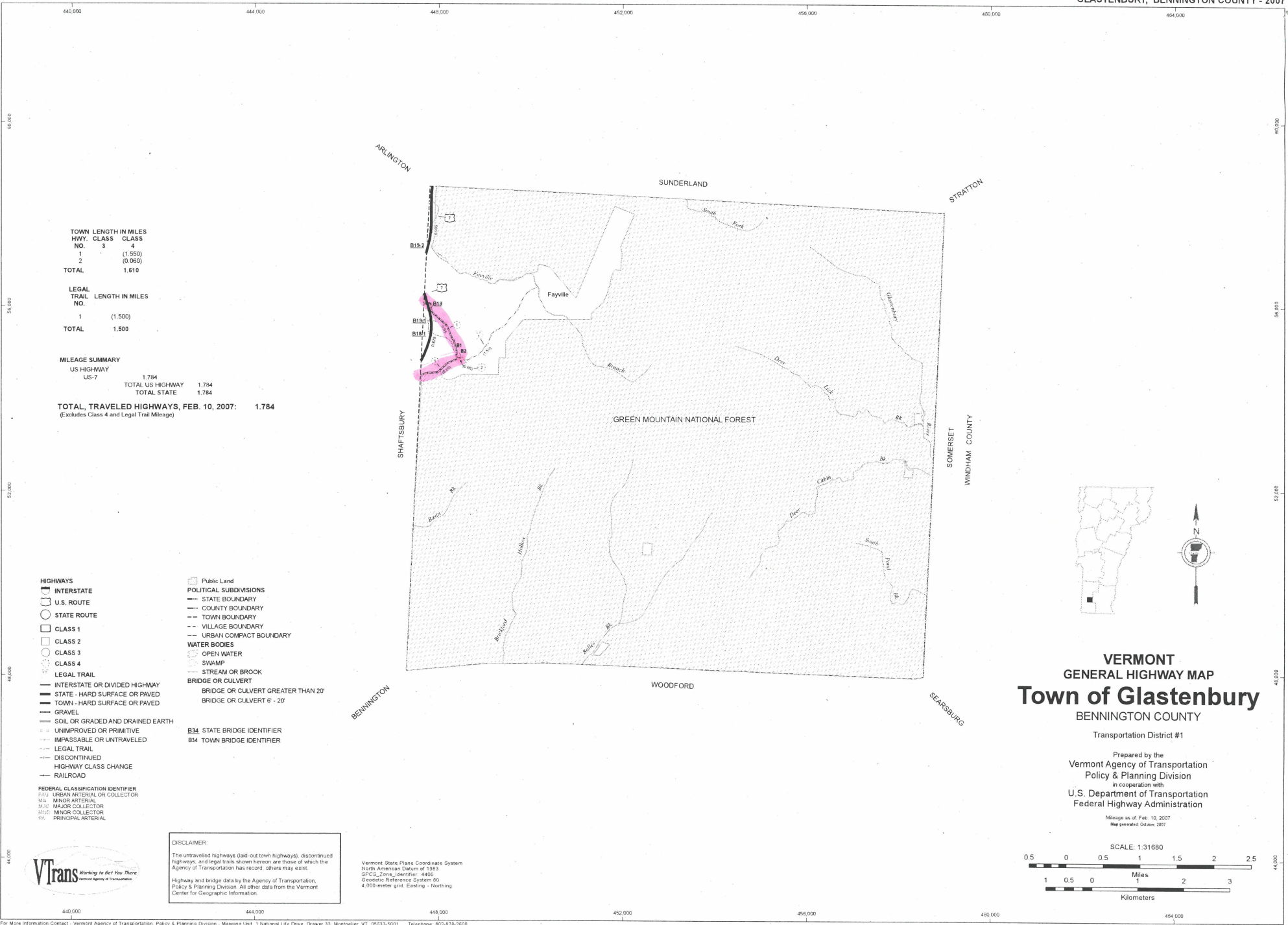

TOWN LENGTH IN MILES

HWY. NO.	CLASS 3	CLASS 4
1		(1.550)
2		(0.060)
TOTAL		1.610

LEGAL TRAIL LENGTH IN MILES

TRAIL NO.	LENGTH
1	(1.500)
TOTAL	1.500

MILEAGE SUMMARY

US HIGHWAY	US-7	1.784	TOTAL US HIGHWAY	1.784
TOTAL STATE			1.784	

TOTAL, TRAVELED HIGHWAYS, FEB. 10, 2007: 1.784
 (Excludes Class 4 and Legal Trail Mileage)

- HIGHWAYS**
- INTERSTATE
 - U.S. ROUTE
 - STATE ROUTE
 - CLASS 1
 - CLASS 2
 - CLASS 3
 - CLASS 4
 - LEGAL TRAIL
 - INTERSTATE OR DIVIDED HIGHWAY
 - STATE - HARD SURFACE OR PAVED
 - TOWN - HARD SURFACE OR PAVED
 - GRAVEL
 - SOIL OR GRADED AND DRAINED EARTH
 - UNIMPROVED OR PRIMITIVE
 - IMPASSABLE OR UNTRAVELED
 - LEGAL TRAIL
 - DISCONTINUED
 - HIGHWAY CLASS CHANGE
 - RAILROAD
- FEDERAL CLASSIFICATION IDENTIFIER**
- UA URBAN ARTERIAL OR COLLECTOR
 - MA MINOR ARTERIAL
 - MC MAJOR COLLECTOR
 - MI MINOR COLLECTOR
 - PR PRINCIPAL ARTERIAL
- POLITICAL SUBDIVISIONS**
- STATE BOUNDARY
 - COUNTY BOUNDARY
 - TOWN BOUNDARY
 - VILLAGE BOUNDARY
 - URBAN COMPACT BOUNDARY
- WATER BODIES**
- OPEN WATER
 - SWAMP
 - STREAM OR BROOK
 - BRIDGE OR CULVERT
 - BRIDGE OR CULVERT GREATER THAN 20'
 - BRIDGE OR CULVERT 6' - 20'
- B34 STATE BRIDGE IDENTIFIER**
B34 TOWN BRIDGE IDENTIFIER

DISCLAIMER:
 The untraveled highways (laid-out town highways), discontinued highways, and legal trails shown hereon are those of which the Agency of Transportation has record; others may exist.
 Highway and bridge data by the Agency of Transportation, Policy & Planning Division. All other data from the Vermont Center for Geographic Information.

Vermont State Plane Coordinate System
 North American Datum of 1983
 SPCS_Zone_Identifier: 4400
 Geoidetic Reference System 50
 4,000-meter grid. Easting - Northing

VERMONT
GENERAL HIGHWAY MAP
Town of Glazenbury
 BENNINGTON COUNTY

Transportation District #1

Prepared by the
 Vermont Agency of Transportation
 Policy & Planning Division
 in cooperation with
 U.S. Department of Transportation
 Federal Highway Administration

Message as of Feb. 10, 2007
 Map generated October, 2007

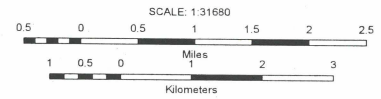

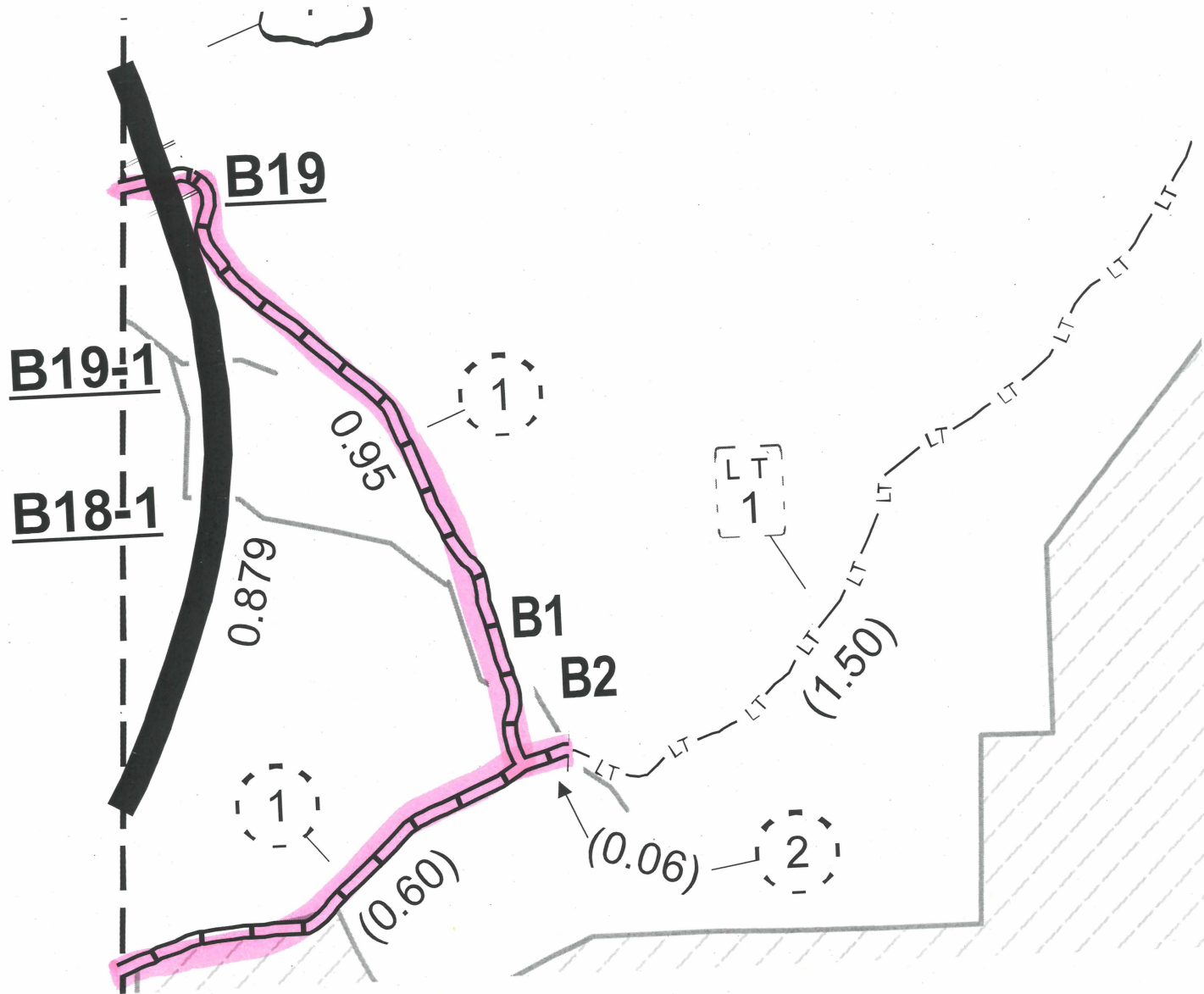

Glastenbury 16 Nov 2007

TOWN OF GLASTENBURY

Vermont
Agency of Transportation

SEP 19 2007

Glastenbury, Vermont

Policy & Planning Division

September 6, 2007

State of Vermont
Agency of Transportation
District One
359 Bowen Road
Bennington, Vermont 05201



Attention: Wayne Gammell

Dear Sir ,

By means of this letter , I am requesting on behalf of the unorganized town of Glastenbury that the agency upgrade our town road from class 4 to class 3. My belief is that this shouldn't require much if any road updates and considering the increase of traffic in the last several years it seems that the upgrade in class makes perfect sense.

I am aware that by making our road a class 3 road that this will allow us to receive some highway aid and the possibility of grants.

Please let me know if and when this update might happen.

Just for the record I would like to let you to know that I have been very satisfied with your agency . Grading, mowing, ditching, and plowing has been better than any time noted in the past. Nelson has been prompt, respectful, and professional in all matters. The plow operators are respectful and considerate.

Thank-you again!

Sincerely,

Rickey L. Harrington----Supervisor of Glastenbury
1-802-447-2954

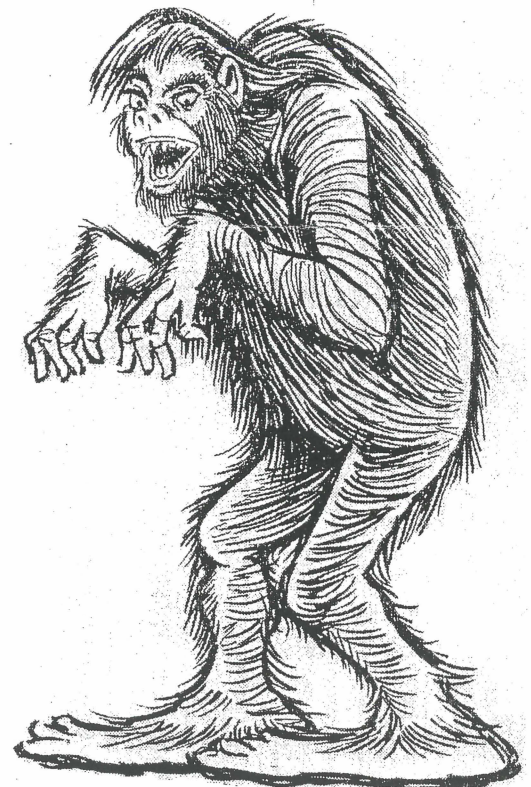

Home of Bigfoot