

CERTIFICATE OF HIGHWAY MILEAGE
YEAR ENDING FEBRUARY 10, 2015

Fill out form, make and file copy with the Town Clerk, and mail ORIGINAL, before February 20, 2015 to:
Vermont Agency of Transportation, Division of Policy, Planning and Intermodal Development,
One National Life Drive, Montpelier, VT 05633.

We, the members of the legislative body of SHOREHAM in ADDISON County
on an oath state that the mileage of highways, according to Vermont Statutes Annotated, Title 19, Section 305,
added 1985, is as follows:

PART I - CHANGES TOTALS - Please fill in and calculate totals.

Town Highways	Previous Mileage	Added Mileage	Subtracted Mileage	Total	Scenic Highways
Class 1	0.000				0.000
Class 2	11.900				0.000
Class 3	50.35				0.000
State Highway	16.319				0.000
Total	78.569				0.000
* Class 1 Lane	0.000				
* Class 4	6.00				0.000
* Legal Trail	0.00				
* Unidentified Corridor	0.00				

* Mileage for Class 1 Lane, Class 4, Legal Trail, and Unidentified Corridor classifications are NOT included in total.

PART II - INFORMATION AND DESCRIPTION OF CHANGES SHOWN ABOVE.

1. NEW HIGHWAYS: Please attach Selectmen's "Certificate of Completion and Opening".
2. DISCONTINUED: Please attach SIGNED copy of proceedings (minutes of meeting).
3. RECLASSIFIED/REMEASURED: Please attach SIGNED copy of proceedings (minutes of meeting).
4. SCENIC HIGHWAYS: Please attach a copy of order designating/discontinuing Scenic Highways.

IF THERE ARE NO CHANGES IN MILEAGE: Check box and sign below.

PART III - SIGNATURES - PLEASE SIGN.

Selectmen/ Aldermen/ Trustees Signatures:

Joseph C Wood

T/C/V Clerk Signature:

Julie Dutton

Date Filed:

1/15/15

Please sign ORIGINAL and return it for Transportation signature.

AGENCY OF TRANSPORTATION APPROVAL:

Signed copy will be returned to T/C/V Clerk.

APPROVED:

Jonathan Croft
Representative, Agency of Transportation

DATE:

1/20/2015



State of Vermont
Division of Policy, Planning and Intermodal Development - Mapping Section

1 National Life Drive
Montpelier, VT 05633-5001
<http://vtrans.vermont.gov>

Telephone: 802-828-2109
Fax: 802-828-2334
Email: sara.moulton@state.vt.us

Agency of Transportation

December 22, 2014

Mr. Paul Saenger
Selectboard Chair
Shoreham, c/o Town Clerk
297 Main St
Shoreham, VT 05770

Dear Mr. Saenger:

It has been brought to our attention that a portion of Class 3 Town Highway 57 (TH-57), known as Bates Road in the Town of Shoreham is not currently meeting the standard for a class 3 town highway and is signed as "Not Maintained During Winter." The standard for class 3 is defined in 19 V.S.A. § 302(3)(B) as:

"...The minimum standards for class 3 highways are a highway negotiable under normal conditions all seasons of the year by a standard manufactured pleasure car. This would include but not be limited to sufficient surface and base, adequate drainage, and sufficient width capable to provide winter maintenance..."

This portion of TH-57 is referenced as class 3 on the current 2014 General Highway Map of Shoreham, produced by the Agency of Transportation (VTrans) Mapping Section. This classification is based on information and changes supplied to VTrans by the Town on the Certificates of Highway Mileage. The portion of highway is currently listed as 0.25 miles of class 3 and is located off VT-74 .

A copy of an excerpt of General Highway Map is enclosed with the highway highlighted.

As a result, this 0.25 mile section of class 3 of TH-57 has been deemed "Not Up To Standard" and will be moved into the class 4 classification on the 2015 Mileage Certificate, which will remove State Aid funding for this section of town highway. If TH-57 is still legally class 3, the class 3 classification will remain, but the section functions as a class 4 since it is not maintained during the winter.

Please let me know if you have any questions.

Sincerely,

A handwritten signature in cursive script that reads "Sara Moulton".

Sara Moulton
Mapping & GIS Specialist

Enclosures

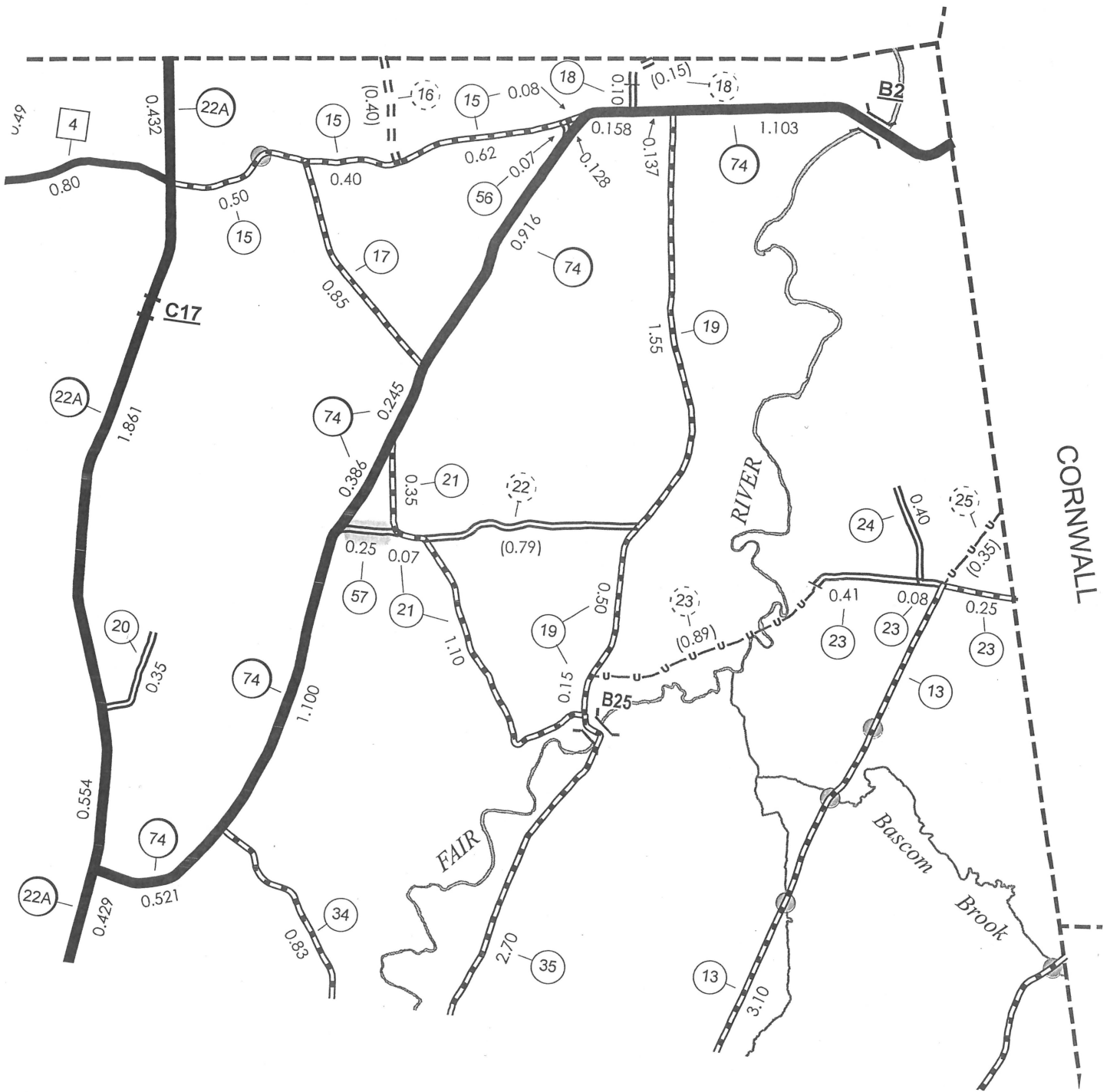

Shoreham 2014 Town Highway Map Excerpt

Alley, Kerry

Shoreham
0118

From: Moulton, Sara
Sent: Tuesday, December 02, 2014 8:51 AM
To: Trunzo, Michael
Cc: Alley, Kerry; Croft, Johnathan
Subject: RE: Shoreham VT-74/Bates Rd (mp 6.823)
Attachments: Shoreham_TH57.pdf

Has anyone followed up on this? Does this need to be field checked?

Sara

From: Croft, Johnathan
Sent: Tuesday, December 17, 2013 9:39 AM
To: Kelly, Joe
Cc: Moulton, Sara; Smith, Gary S.; Alley, Kerry; Trunzo, Michael
Subject: RE: Shoreham VT-74/Bates Rd (mp 6.823)

Good morning Joe,

We will add this highway for review and see if it is "Not Up To Standard" and is not being maintained in the winter, and if so, we can pull their state aid for the section. We can drop it into a class 4 category, but it would still legally be class 3 with no state aid funds.

This will take a bit of time to sort out on our end.

Johnathan

From: Kelly, Joe
Sent: Tuesday, December 17, 2013 9:28 AM
To: Croft, Johnathan
Subject: Shoreham VT-74/Bates Rd (mp 6.823)

Good Tuesday morning Johnathan –

A few years ago I noticed that the town of Shoreham had installed a "not maintained during winter" sign at the intersection of Bates Rd. and VT-74. We have closed the centerline pavement marking. The road is currently a Class 3 town highway. Is there a mechanism to down-grade it to a Class IV since it is not maintained year-round? It appears to be used as a driveway for the only residence (#128).

J.

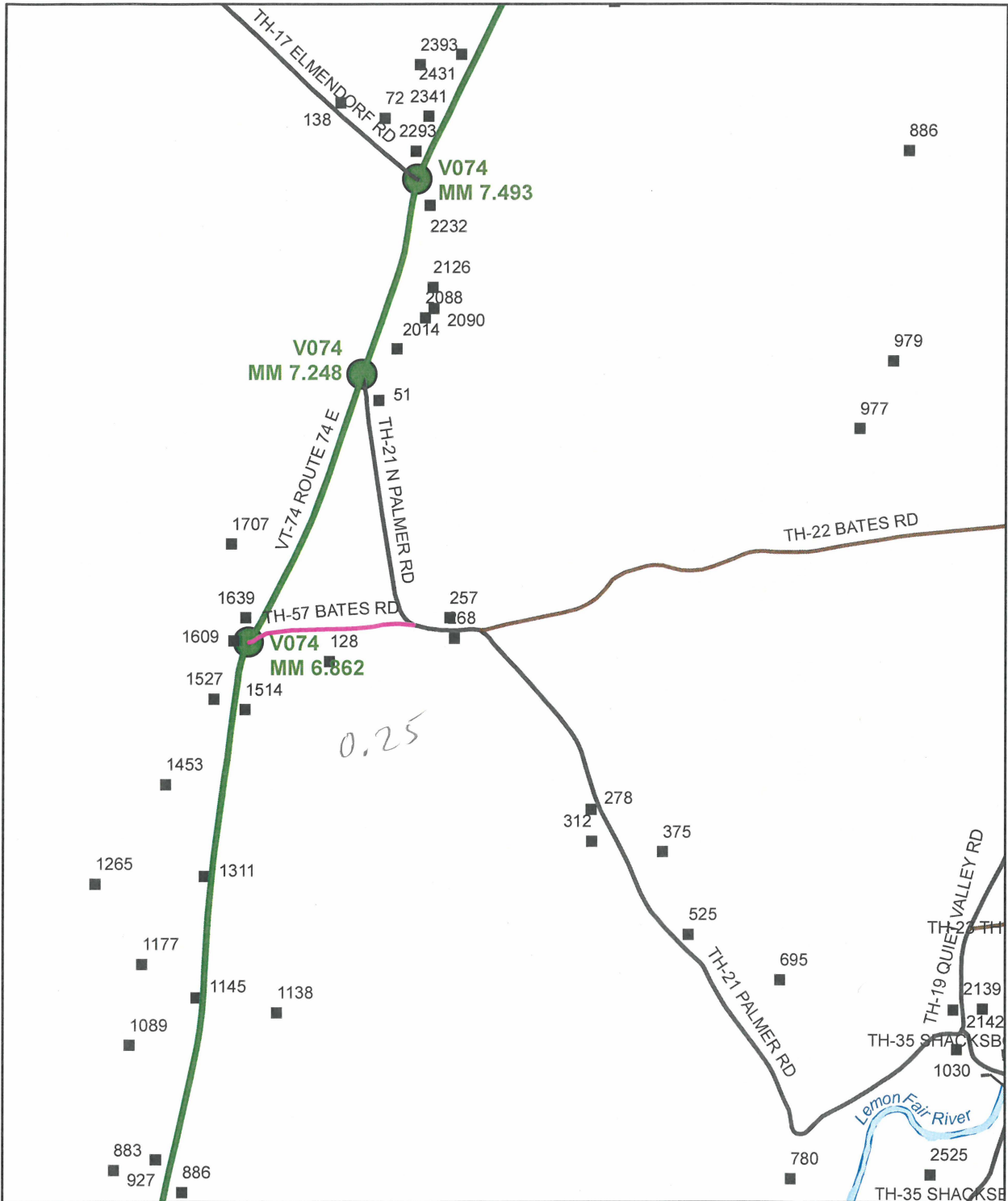

**Question about TH-57 Bates Rd
SHOREHAM**

Mapping Unit
 Division of Policy and Planning
 Vermont Agency of Transportation - December 2014

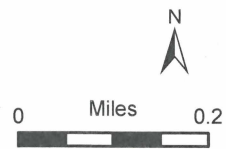

Alley, Kerry

From: Croft, Johnathan
Sent: Tuesday, December 17, 2013 9:37 AM
To: Kelly, Joe
Cc: Moulton, Sara; Smith, Gary S.; Alley, Kerry
Subject: RE: Shoreham VT-74/TH-53

Good morning Joe,

Yes, there is a process that can be taken by the Selectboard or a petition from a voter in town to have a town highway reclassified, altered or discontinued. There could also be a recommendation from the Agency to the town to alter a highway, but it is completely in the Selectboard purview on what action is taken. The Selectboard needs to assess the public good in their decision making process.

Johnathan Croft
VTrans Mapping Unit
(802) 828-2600

From: Kelly, Joe
Sent: Tuesday, December 17, 2013 8:16 AM
To: Croft, Johnathan
Subject: Shoreham VT-74/TH-53

Good Tuesday morning Johnathan –

There is a short Class 3 town highway (TH-53) that intersects VT-74 at two locations between mp 5.0 and 5.1. It does not have a street name and none of the buildings have 911 addresses for TH-53. Instead they all have Main St. addresses (VT-74). Is there a mechanism to down-grade this TH to a driveway?

J.