

**CERTIFICATE OF HIGHWAY MILEAGE
YEAR ENDING FEBRUARY 10, 2010**

Fill out form, make and file copy with the Town Clerk, and mail ORIGINAL, before February 20, 2010 to:
Vermont Agency of Transportation, Division of Planning, Outreach and Community Affairs, One National Life
Drive, Montpelier, VT 05633.

We, the members of the legislative body of **SHOREHAM** in **ADDISON** County
on an oath state that the mileage of highways, according to Vermont Statutes Annotated, Title 19, Section 305,
added 1985, is as follows:

PART I - CHANGES TOTALS - Please fill in and calculate totals.

Town Highways	Previous Mileage	Added Mileage	Subtracted Mileage	Total	Scenic Highways
Class 1	0.000				0.000
Class 1 Lane	0.000				
Class 2	11.500	+ 0.40		11.9	0.000
Class 3	50.78	- 0.4	0.40	50.38	0.000
State Highway	16.319			16.319	0.000
Class 4	6.00			6.00	0.000
Legal Trail	0.00				
Total	78.599			78.599	0.000

* Mileage for Class 1 Lane, Class 4, and Legal Trail classifications is NOT included in total.

PART II - INFORMATION AND DESCRIPTION OF CHANGES SHOWN ABOVE.

- NEW HIGHWAYS:** Please attach Selectmen's "Certificate of Completion and Opening".
- DISCONTINUED:** Please attach SIGNED copy of proceedings (minutes of meeting).
- RECLASSIFIED/REMEASURED:** Please attach SIGNED copy of proceedings (minutes of meeting).
Class 2 Transfer - 0.40 mi CL3 TH-5 to CL2 TH-5
- SCENIC HIGHWAYS:** Please attach a copy of order designating/discontinuing Scenic Highways.

IF THERE ARE NO CHANGES IN MILEAGE: Check box and sign below. []

PART III - SIGNATURES - PLEASE SIGN.

Selectmen/ Aldermen/ Trustees Signatures:

[Handwritten signatures: Robert M. Warren, Sarah M. Shackleton, and others]

T/C/V Clerk Signature:

[Handwritten signature: Bob Doney]

Date Filed:

January 13, 2010

Please sign ORIGINAL and return it for Transportation signature.

AGENCY OF TRANSPORTATION APPROVAL:

Signed copy will be returned to T/C/V Clerk.

APPROVED:

[Handwritten signature]
Representative, Agency of Transportation

DATE:

5/19/2010

Received

VT Agency of Transportation

JAN 15 2010

Planning Outreach and
Community Affairs Division

STATE OF VERMONT
AGENCY OF TRANSPORTATION
PLANNING OUTREACH AND COMMUNITY AFFAIRS DIVISION

VERMONT DEPARTMENT OF TRANSPORTATION
PLANNING OUTREACH AND COMMUNITY AFFAIRS DIVISION
100 WATER STREET, SUITE 200
MONTPELIER, VERMONT 05602
PHONE: 802-241-2345
WWW.VT.AGOT.VT.GOV

STATE OF VERMONT
AGENCY OF TRANSPORTATION
PLANNING OUTREACH AND COMMUNITY AFFAIRS DIVISION

100 WATER STREET, SUITE 200
MONTPELIER, VERMONT 05602

PHONE: 802-241-2345
WWW.VT.AGOT.VT.GOV

Moulton, Sara

From: Moulton, Sara
Sent: Tuesday, January 05, 2010 10:31 AM
To: 'Shoreham Town Clerk'
Subject: Shoreham 2010 Certificate of Highway Mileage
Attachments: Shoreham_cert.pdf

I mailed out the 2010 Certificates yesterday and wonder if I might have missed including information regarding the Class 2 transfer. Attached is a version which contains notation about the transfer. If the version I mailed yesterday did not include it, please feel free to use the attached version instead, or you may add the note to the one you receive through the mail. The mileage needs to be noted in Part I too.

Please let me know if you have any questions.

Sara Moulton
Mapping & GIS Specialist, Mapping Unit
Division of Planning, Outreach and Community Affairs
Vermont Agency of Transportation (VTrans)
Tel: 802-828-2109

**CERTIFICATE OF HIGHWAY MILEAGE
YEAR ENDING FEBRUARY 10, 2010**

Fill out form, make and file copy with the Town Clerk, and mail ORIGINAL, before February 20, 2010 to:
Vermont Agency of Transportation, Division of Planning, Outreach and Community Affairs, One National Life
Drive, Montpelier, VT 05633.

We, the members of the legislative body of **SHOREHAM** in **ADDISON** County
on an oath state that the mileage of highways, according to Vermont Statutes Annotated, Title 19, Section 305,
added 1985, is as follows:

PART I - CHANGES TOTALS - Please fill in and calculate totals.

Town Highways	Previous Mileage	Added Mileage	Subtracted Mileage	Total	Scenic Highways
Class 1	0.000				0.000
Class 1 Lane	0.000				
Class 2	11.500				0.000
Class 3	50.78				0.000
State Highway	16.319				0.000
Class 4	6.00				0.000
Legal Trail	0.00				
Total	78.599				0.000

* Mileage for Class 1 Lane, Class 4, and Legal Trail classifications is NOT included in total.

PART II - INFORMATION AND DESCRIPTION OF CHANGES SHOWN ABOVE.

1. **NEW HIGHWAYS:** Please attach Selectmen's "Certificate of Completion and Opening".
2. **DISCONTINUED:** Please attach SIGNED copy of proceedings (minutes of meeting).
3. **RECLASSIFIED/REMEASURED:** Please attach SIGNED copy of proceedings (minutes of meeting).
4. **SCENIC HIGHWAYS:** Please attach a copy of order designating/discontinuing Scenic Highways.

IF THERE ARE NO CHANGES IN MILEAGE: Check box and sign below. []

PART III - SIGNATURES - PLEASE SIGN.

Selectmen/ Aldermen/ Trustees Signatures: _____

T/C/V Clerk Signature: _____ Date Filed: _____

Please sign ORIGINAL and return it for Transportation signature.

AGENCY OF TRANSPORTATION APPROVAL: Signed copy will be returned to T/C/V Clerk.

APPROVED: _____ **DATE:** _____
 Representative, Agency of Transportation

Class 2 Transfer - 0.40 Miles of TH-5

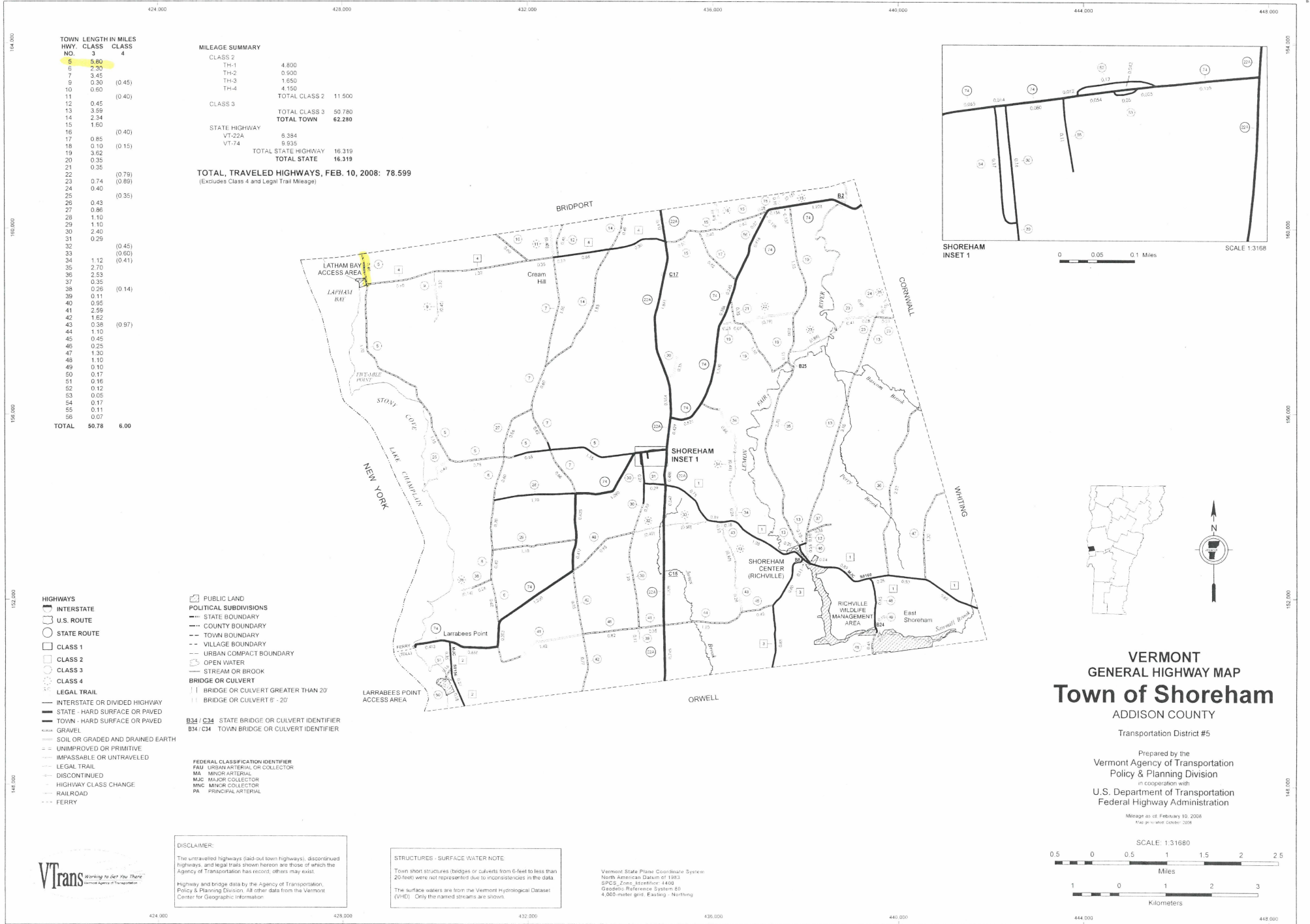

TOWN NO.	LENGTH IN MILES	CLASS 3	CLASS 4
5	5.80		
6	2.30		
7	3.45		
9	0.30	(0.45)	
10	0.60		
11		(0.40)	
12	0.45		
13	3.59		
14	2.34		
15	1.50		
16		(0.40)	
17	0.85		
18	0.10	(0.15)	
19	3.62		
20	0.35		
21	0.35		
22		(0.79)	
23	0.74	(0.89)	
24	0.40		
25		(0.35)	
26	0.43		
27	0.86		
28	1.10		
29	1.10		
30	2.40		
31	0.25		
32		(0.45)	
33		(0.60)	
34	1.12	(0.41)	
35	2.70		
36	2.53		
37	0.35		
38	0.26	(0.14)	
39	0.11		
40	0.95		
41	2.59		
42	1.62	(0.97)	
43	0.38		
44	1.10		
45	0.45		
46	0.25		
47	1.30		
48	1.10		
49	0.10		
50	0.17		
51	0.16		
52	0.12		
53	0.05		
54	0.17		
55	0.11		
56	0.07		
TOTAL	50.78	6.00	

MILEAGE SUMMARY

CLASS	NO.	LENGTH
CLASS 2	TH-1	4.800
	TH-2	0.500
	TH-3	1.650
	TH-4	4.150
TOTAL CLASS 2		11.500
CLASS 3		
TOTAL CLASS 3		50.780
TOTAL TOWN		62.280
STATE HIGHWAY		
VT-22A		6.384
VT-74		6.935
TOTAL STATE HIGHWAY		16.319
TOTAL STATE		16.319

TOTAL, TRAVELED HIGHWAYS, FEB. 10, 2008: 78.599
(Excludes Class 4 and Legal Trail Mileage)

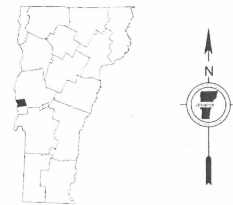
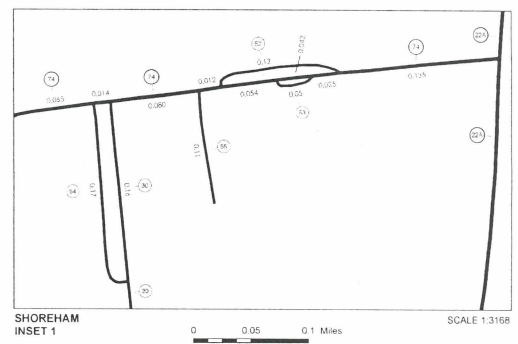

VERMONT GENERAL HIGHWAY MAP Town of Shoreham ADDISON COUNTY

Transportation District #5

Prepared by the
Vermont Agency of Transportation
Policy & Planning Division
in cooperation with
U.S. Department of Transportation
Federal Highway Administration

Mileage as of February 10, 2008
Map prepared October 2008

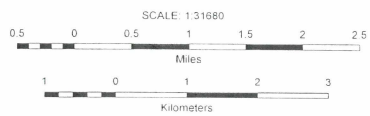

DISCLAIMER:
The untraveled highways (solid town highways), discontinued highways, and legal trails shown hereon are those of which the Agency of Transportation has record; others may exist.
Highway and bridge data by the Agency of Transportation, Policy & Planning Division. All other data from the Vermont Center for Geographic Information.

STRUCTURES - SURFACE WATER NOTE
Town short structures (bridges or culverts from 6-feet to less than 20-feet) were not represented due to inconsistencies in the data.
The surface waters are from the Vermont Hydrological Dataset (VHD). Only the drained streams are shown.

Vermont State Plane Coordinate System
North American Datum of 1983
SPCS Zone, Zone 18 North
Geoidetic Reference System 80
4,000-meter grid, Easting - Northing

PROGRAM DEVELOPMENT DIVISION

TO: Distribution List

FROM: Mary C. Spicer, Highway Research Manager

DATE: December 21, 2009

SUBJECT: Class 3 to class 2 Town Highway Transfer Requests

The following Town highways that were submitted to this Agency for review and analysis for transfer from Class 3 to Class 2 town highway designation have been approved by the Secretary of Transportation. The results are listed below.

DTAs should contact the towns they represent and let them know the outcome. Please see attached copies of letters.

<u>Town</u>	<u>Town Highway#</u>	<u>Mileage</u>	<u>Qualify for Transfer</u>
Woodstock	18	1.20	Yes
Bridgewater	3	5.69	Yes
Shoreham	5	0.40	Yes
Bridport	3	4.08	Yes
Bridport	35	1.80	Yes
Putney	42	0.70	No
Wilmington	40	1.54	No

} Entered in
THDATA
12/21/09
S.Moulton

cc: DTA 1, Nelson Blanchard
 DTA 4, Tammy Ellis
 DTA 5, Gil Newbury
 Regional Planning Coordinator, Susan Clark
 Johnathan Croft, Mapping
 PDD Business Manager
 Highway Research Files

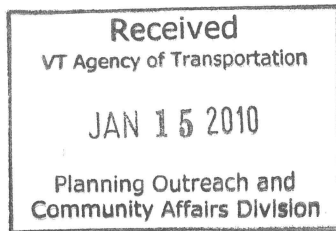

Approved: November 25, 2009

**Selectboard Meeting
November 11, 2009
7:00–8:45 p.m.**

Present: Paul Saenger, Karen Shackett, Bob Warren, Marthe Fisher,
Amy Douglas, Barb Kivlin, Jason Paquette
Guests: Glenn Symon, Scott Stanley, Bob Fisher, Jeremiah Parker, Terry McKnight,
Natasha Causton, Wilson & Sue MacIntire

Paul called the meeting to order at 7:00p.m.

AGENDA:

Announcements: See agenda hand-out

(1) Public Concerns: None

(2) Minutes: Bob MOVED, Marthe SECONDED, that the **Minutes of October 28th** be accepted.
Motion passed.

(3) Senior Housing Project: Jeremiah and Terry McKnight presented their concept for a Senior/fixed income housing complex which Jeremiah plans for a portion of his Village property adjacent to Greenwood Village. The proposal calls for construction of several one-story rental duplexes, with units available configured with 1, 2, or 3-bedroom. Units include parking for 2 vehicles, ADA accessibility. A 2-bedroom unit would be roughly 1200 sq ft. Terry, representing Addison County Community Trust, explained the ACCT's role in owning/managing the property and ensuring the perpetual affordability of the units. Lengthy discussion included Board's concerns regarding priority of Shoreham seniors in the selection process; the effect on the Grand List; the provision of various social/health services to the duplexes' residents (e.g. visiting health care providers); the Town's responsibilities regarding the grant monies should the project fail (block grant made to Town, Town loans to ACCT, when repayment begins, Town retains 50%, 50% repaid to State); amount of monthly rentals and financial assistance to ensure affordability. A set of Jeremiah's drawings left with the Board

(4) Roads: [Jason] The generator conduit has been installed, the wires need to be pulled.

- The reclassification of the stretch of Lake Street between Lapham Bay Road and the Bridport line, to Class 2, requires a letter of consent to be signed by December 3, a hearing, and a site visit. As Bridport has yet to sign their own letter of intent, both towns could sign a joint letter. Karen so MOVED, Marthe SECONDED, *motion passed*, Board signed joint Letter-of-Intent.

- Holmes Lane—Board signed State's *Application for Authority to Erect Street Name Sign* for Holmes Lane

- Town Office continues to receive complaints regarding the increased ferry traffic through the Village

- Winter prep continues on Town equipment, supplies

- Before moving on, the Selectboard presented Jason with a "Roads Scholar plaque, noting he is likely the only "roads" scholar in Shoreham. The plaque comes from Vermont Local Roads in

recognition of achievement of a certain level of accomplishment and education credits received from VLR workshops and educational opportunities. Board commended Jason on his high marks, and expressed pride and appreciation of his initiative in taking a number of ancillary courses purely for his pursuit of knowledge (ie: no credit benefits). Congratulations, Jason!

(4) **Buildings:** [Karen] Amy noted that the Town of Randolph has offered up their temporary vault, which they had used for storage during construction of their new Town Office. Amy requested the Board's permission to follow up, confirm that the unit meets State requirements, and possibly put a "hold" on the unit. Our records storage needs are at a critical point, and unit will be useful when we begin whatever Town Office construction is decided upon. Board agreed she should proceed, and put a "hold" on the unit if it suits.

(5) **Emergency Management:** (Robin) No report

(6) **Levi Morton Marker**—Town has received an offer from someone who has volunteered to put in a cement pad and reinstall the Levi Morton marker. Board passed the offer along to the Historical Society.

(7) **Tour de Farms 2010**—Scheduled for September 19, 2010. Barb and Karen finalizing town policies proposal for such events, or for use of the Green by groups; they want to check with other towns hosting similar events to see what papers they require.

(8) **Selectboard Orders**—reviewed and signed.

(10) **Other Business**—

- **VCRD**—School has been reserved for the December 1 meeting, 6 to 9 pm.
- **School Board Report**—(Natasha) The School Board felt that they should have more of a presence at the Selectboard meetings, and will attempt to do so henceforth. Natasha reported that 90% of the elementary students received the N1H1 vaccination; no sign yet of H1N1 in the school; 70% receive hot lunches; the School Board is planning a community Thank You lunch in December, details to be forthcoming; work is beginning on the school budget.
Amy asked if both Boards want the issue of voting the school budget by Australian ballot to be on the Town Warning. Natasha will query the School Board and report back.
- **Annual Insurance Review**—Board reviewed policies on buildings. No changes to be made

Adjournment: Meeting adjourned at 8:45 PM.

Respectfully submitted,
Robin Conway
Minute Taker

Signed: Marthe Fisher
Marthe Fisher Secretary
Town of Shoreham Selectboard

State of Vermont
Department of Forests, Parks and Recreation
103 South Main Street, 10 South
Waterbury, VT 05671-0601
www.vtfpr.org

[fax] 802-244-1481
[tdd] 800-253-0191

Agency of Natural Resources

802.241.3693
ANR Lands Division

April 16, 2010

Town of Bridport Selectboard
c/o Valerie Bourgeois, Town Clerk
P O Box 27
Bridport, Vermont 05734

Town of Shoreham Selectboard
c/o Amy Douglas, Town Clerk
297 Main Street
Shoreham, Vermont 05770

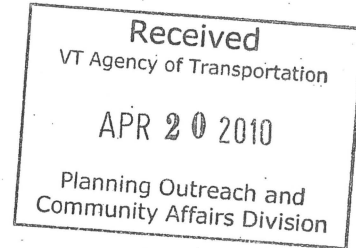

Dear Board Members:

We are in receipt of the notice pursuant to the requirements of Title 19 V.S.A. that you propose to reclassify a portion of Lake Street to a Class 2 Town Highway in the Towns of Bridport and Shoreham. The Department of Forests, Parks & Recreation has reviewed the proposal and finds that this will not affect any existing trail corridors and therefore, has no objection to the proposed reclassification.

This Department will not be represented at your meeting on April 27, 2010 but we ask that this letter and attachments be entered into the proceedings. We also request that local trail organizations such as snowmobile clubs be notified of the proposed reclassification.

Thank you for contacting us on this matter. We always appreciate the opportunity to comment on these important recreation resources.

Sincerely yours,

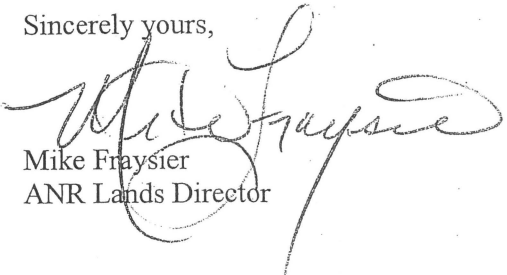

Mike Fraysier
ANR Lands Director

Enclosures

Cc: Trails Coordinator, VAST; FPR District Trails Coordinator, Gary Sawyer; Planning Office, AOT



FORESTRY
CENTENNIAL
CELEBRATION