

CERTIFICATE OF HIGHWAY MILEAGE

YEAR ENDING FEBRUARY 10, 2001

Fill out form, make and file copy with the Town Clerk, and mail ORIGINAL, before February 20, 2001 to: VT Agency of Transportation, Technical Services Division, Drawer 33, Montpelier, VT 05633.

We, the Selectman or Trustee or Alderman of PANTON in ADDISON County on an oath state that the mileage of highways, according to Title 19, V.S.A, Sec #305, added 1985, is as follows

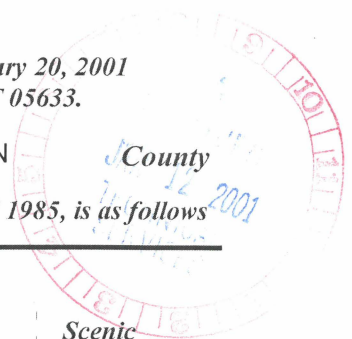

PART I - CHANGES TOTALS - Please fill in and calculate totals.

Table with 6 columns: Town Highways, Previous Mileage, Added Mileage, Substracted Mileage, Total, Scenic Highways. Rows include Class 1, Class 1 Lane, Class 2, Class 3, State Highway, Class 4, and Total. Handwritten values in blue ink are present.

* Class 1 Lane Mileage and Class 4 is NOT included in total.

PART II - INFORMATION AND DESCRIPTION OF CHANGES SHOWN ABOVE.

- 1. NEW HIGHWAYS: Please attach Selectman's "Certificate of Completion and Opening".
2. DISCONTINUED: Please attach SIGNED copy of proceedings (minutes of meeting).
3. RECLASSIFIED/REMEASURED: Please attach SIGNED copy of proceedings (minutes of meeting).
4. SCENIC HIGHWAYS: Please attach a copy of order designating/discontinuing Scenic Highways.

IF THERE ARE NO CHANGES IN MILEAGE: Check box and sign below. [checked]

PART III - SIGNATURES - PLEASE SIGN.

Selectman/ Alderman/ Trustees Signatures

Handwritten signatures of Barbara Fleming and George Johnson, dated 01-08-01.

Clerk Signagture:

Handwritten signature of Susan Farney.

Date Filed:

Handwritten date 1-8-01.

Please sign ORIGINAL and return it for Transportation signature.

AGENCY OF TRANSPORTATION APPROVAL:

Signed copy will be returned to T/C/Y Clerk.

APPROVED:

Handwritten signature of John H. Ken, Representative, Agency of Transportation.

DATE:

Handwritten date 22 JAN 01.