

TOWN HWY. No.	LENGTH IN MILES CLASS 3	LENGTH IN MILES CLASS 4	TOWN HWY. No.	LENGTH IN MILES CLASS 3	LENGTH IN MILES CLASS 4
2	3.32		39	1.19	(0.53)
4	1.21	(0.17)	40	0.42	
6	0.90		41	0.52	
7	1.49	(0.21)	42	0.93	
8	0.88		43	0.37	
9	1.08		44	0.20	
10	0.45		45		(1.12)
11		(0.10)	46	0.64	
12	0.34		47	0.14	
13		(0.15)	48	0.06	
14	0.06		49	0.10	
15	2.71		50	0.05	
16	0.71		51	0.05	
17	0.16		52	0.24	
18	0.24		53	0.16	
19	1.34		54	0.08	
20	0.27		55	0.10	
21	0.40		56	0.04	
22	0.28		58		(0.27)
23	0.13		59		(0.40)
24	0.40		60		(0.43)
25	0.50	(0.19)	63	0.23	
26	0.47	(0.43)	64	0.46	
27	2.36		65	0.38	
28	3.73		66	0.47	
29		(1.40)	67		(0.04)
30		(0.85)	68		
31	2.10		69	0.71	
32		(0.20)	70	0.10	
33	1.87		71	0.64	
34	0.23		72	0.10	
35	0.61		73	0.33	
36		(0.44)	75	0.40	
37	1.64		TOTAL	39.16	6.93

TOWN HWY. No.	LENGTH IN MILES "NOT UP TO STANDARD"
28	(0.25)
31	(0.19)
69	(0.10)
TOTAL	0.54

* The sections of the town highways listed above are legally Class 3, but have been deemed "Not Up To Standard" and are functionally Class 4 Town Highways

LEGAL TRAIL No.	LENGTH IN MILES LEGAL TRAIL
1	(0.73)
2	(0.90)
3	(1.37)
4	(1.10)
5	(1.75)
6	(0.23)
7	(0.57)
TOTAL	6.65

MILEAGE SUMMARY		
CLASS 2		
TH-1	4,100	
TH-2	5,860	
TH-3	2,280	
TOTAL CLASS 2		12,240
CLASS 3		
TOTAL CLASS 3		39.16
TOTAL TOWN		51,400
STATE HIGHWAY		
VT-73	8,782	
VT-100	8,353	
TOTAL STATE HIGHWAY		17,135
TOTAL STATE		17,135

TOTAL, TRAVELED HIGHWAYS, FEB. 10, 2024: 68,535
(Excludes Class 4 and Legal Trail Mileage)

DISCLAIMER:
The untraveled highways (laid-out town highways), discontinued highways, and legal trails hereon are those of which the Agency of Transportation has record; others may exist.

Highway and bridge data by the Agency of Transportation. Town short structures drawn from the VT/CULVERTS (formerly VOBCT) online database. All other data from the Vermont Open Geodata Portal. Only named streams shown.

Vermont State Plane Coordinate System
North American Datum of 1983
SPCS_Zone_Identifier: 4400
Geodetic Reference System 80
4,000-meter grid, Easting - Northing

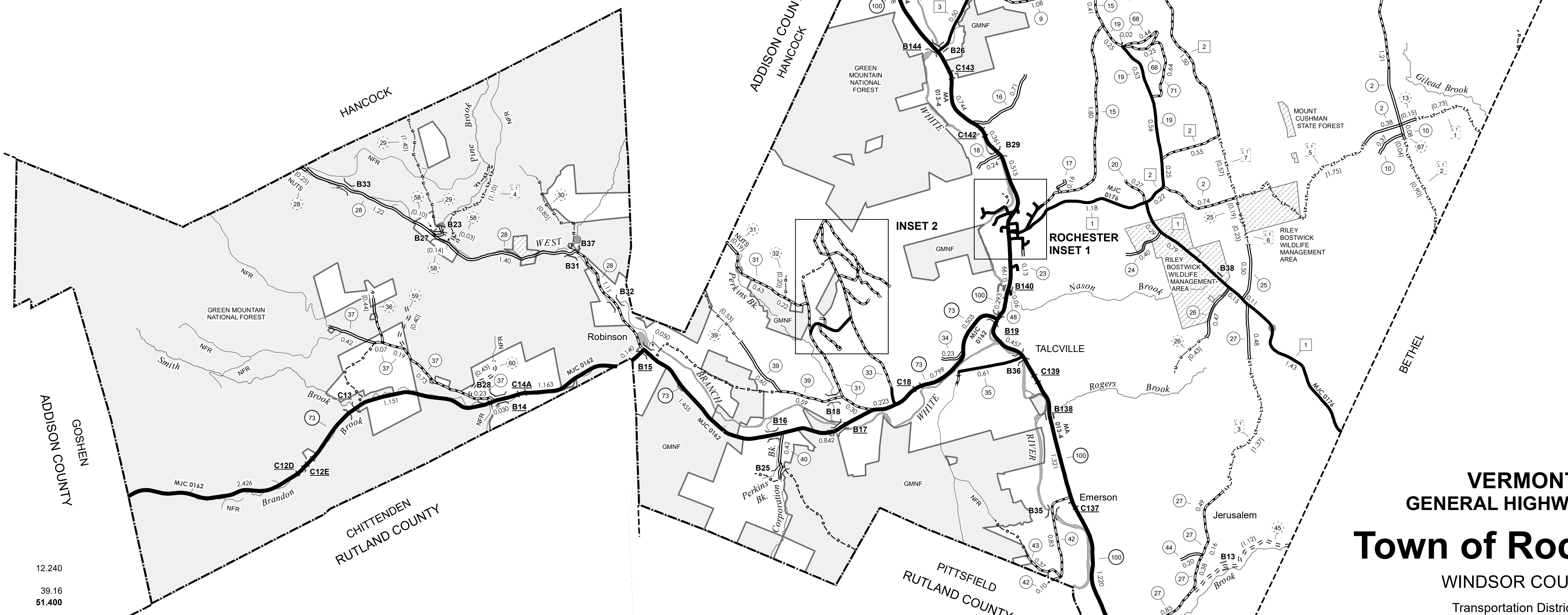
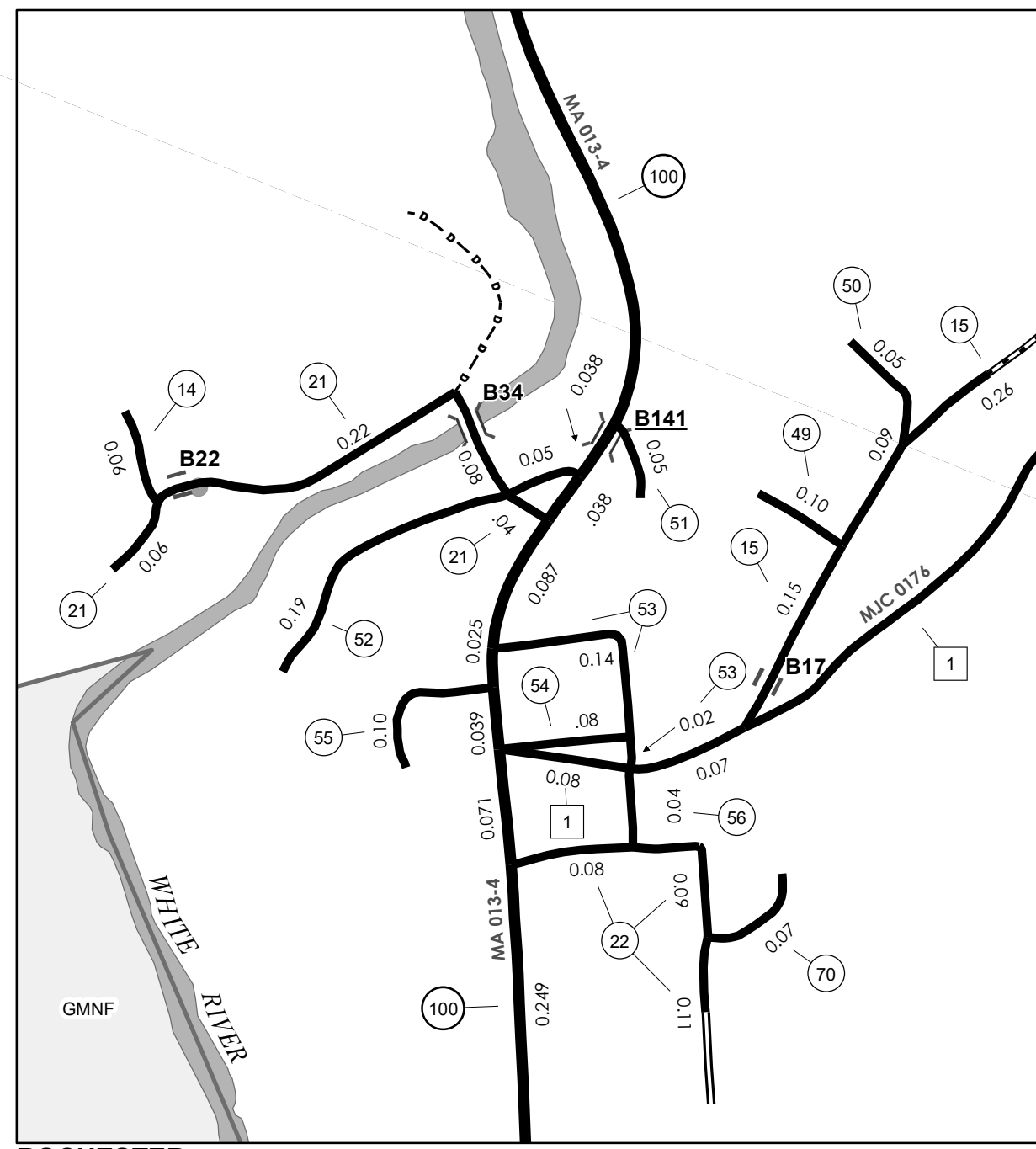
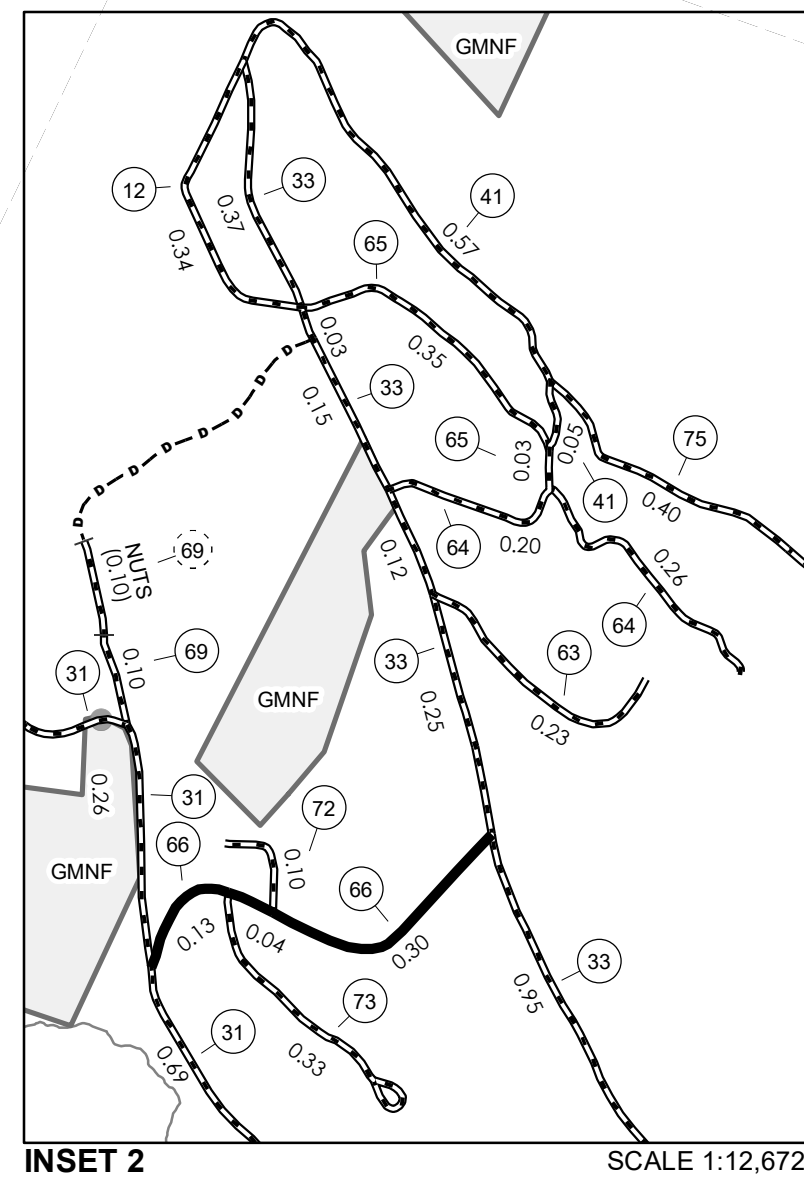

VERMONT GENERAL HIGHWAY MAP
Town of Rochester
WINDSOR COUNTY
Transportation District #4
Prepared by the
Vermont Agency of Transportation
Division of Policy, Planning and Intermodal Development
in cooperation with
U.S. Department of Transportation
Federal Highway Administration

