

CERTIFICATE OF HIGHWAY MILEAGE

FOR YEAR ENDING FEBRUARY 10, 1969

Fill out in triplicate and file with your Town Clerk on or before February 10, 1969

(Note sections of Vermont Statutes Annotated on reverse side of this sheet)

We, the Selectmen of the town of Poultney, on oath state that we have carefully measured all the traveled highways in this town and find that the total mileage of traveled highways according to Title 19, V.S.A. §§ 15, amended 1961, Act No. 28, not including pent roads and trails, in this town for the year ending February 10, 1969, is as follows:

	MILEAGE IN TOWN (Outside of villages Incorporated for highways)			MILEAGE IN VILLAGE (Incorporated for highways)			Total All Systems
	POULTNEY						
	Town Highways	State Aid Highways	State Highways	Town Highways	State Aid Highways	State Highways	
PREVIOUS MILEAGE as shown March 15, 1968	45.13	11.134	11.910				68.174
HIGHWAYS ADDED Since March 15, 1968, ac- cording to statute. Explain under paragraph 1 below.	0.64						
SUB-TOTAL							
HIGHWAYS SUBTRACTED Since March 15, 1968. Those becoming untraveled, discon- tinued, legal trails or pent roads. Explain under para- graphs 2 and 3 below.							
TOTAL TRAVELED HIGHWAYS Feb. 10, 1969.	45.77	11.134	11.910				68.814

1. We hereby certify that the following new highways, as substantiated by the attached "Selectmen's Certificate of Completion", have been added since March 15, 1968:

.....

.....

2. We hereby certify that the following highways have been discontinued, or changed to trails or pent roads according to statute, since March 15, 1968, as substantiated by the attached copy of the proceedings:

.....

.....

3. We hereby certify that the following roads have become untraveled since March 15, 1968:

.....

.....

SELECTMEN:

Gaylord L. Fish
Ervin B. Berry
S. N. Olson
Matthew J. Rannon

At Poultney

In the county of Rutland

the 13 day of January, 1969 personally appeared Gaylord L. Fish,

Ervin B. Berry, S. N. Olson and Matthew J. Rannon

Selectmen of Town of Poultney

and made oath to the truth of the foregoing affidavit by them subscribed.

Before me,

Priacilla B. Hadley
Town Clerk
(Write official title, as Notary Public)

(Town Clerk should fill out following and mail one white and one yellow copy to the Commissioner of Highways, Montpelier, Vermont, on or before March 15th.)

I, Priacilla B. Hadley, Clerk of the Town of Poultney

hereby certify that the foregoing is a true copy of record of the certificates of the Selectmen of Town of Poultney relating to highway mileage, filed and recorded at this office.

Attest

Priacilla B. Hadley
Town Clerk

STATE OF VERMONT
DEPARTMENT OF HIGHWAYS
MONTPELIER
05502

January 15, 1969

Mrs. Priscilla B. Hadley, Town Clerk
Town of Poultney
Poultney, Vermont 05764

Dear Mrs. Hadley:

I am herewith returning one (1) copy of the Highway
Mileage Certificate for the Town and Village of Poultney.

These copies are for your records and should be
retained in your files.

Sincerely yours,

R. J. Nichols
Highway Planning Engineer

By: James E. Bishop
Administrative Assistant

RJN/JKB/ajh
Enc.

178.32



STATE OF VERMONT
DEPARTMENT OF HIGHWAYS

MONTPELIER

SEVERAL MEN BY THE NAME OF PRINCEPS, That is, W. PRINCEPS

January 2, 1969

Principal office
in the Town of ... County of ...

Board of Selectmen
Town of Foulton
Foulton, Vermont
05794

Attention of Chairman

Gentlemen:

I am herewith transmitting the Highway Mileage Certificates for your town for the year ending February 15, 1969.

Please note that we have added 0.64 mile to your town highway mileage. This is to include the additions which you requested in 1968 but which were not received in time for inclusion.

Will you also enter any other changes in town highway mileage which were processed in accordance with the statutes during the past year.

Please return the signed Certificates prior to March 15, 1969.

Sincerely yours,

R. J. Nicholls
Highway Planning Engineer

RJN/JMB/dl
Enc.

Parcel One

Commencing at an iron pin in the southerly line of the "town highway" (depicted on said Survey Map to Route #30)

178

KNOW ALL MEN BY THESE PRESENTS, That IT, NORTHEAST DEVELOPERS, INC., a Vermont corporation with principal office and place of business in the Town of Wells, in the County of Rutland and State of Vermont, hereinafter called Grantor, in the consideration of One Dollar and other good and valuable considerations paid to its full satisfaction by the TOWN OF POULTNEY, a municipal corporation located in the County of Rutland and State of Vermont, hereinafter called Grantee, by these presents, do freely GIVE, GRANT, SELL, CONVEY AND CONFIRM unto the said Grantee, the TOWN OF POULTNEY, and its heirs and assigns forever, a certain piece of land in the Town of Poultney, in the County of Rutland and State of Vermont, described as follows, viz:

Being portions of the premises conveyed by deed of John Holmes Andrus to Northeast Developers, Inc., dated February 19, 1962 and recorded in said Poultney Public Land Records on February 23, 1962 in Book 53 at Page 554. Reference is also made to deed of Slate Incorporated to John Holmes Andrus, dated August 21, 1961, and recorded in said records on August 26, 1961 in Book 53 at Page 448.

Reference is made to a Survey Map prepared by Young & Hemenway, Engineers, carrying the legend "Revised Survey Map #1 - Northeast Developers, Inc. - Stonehenge Terraces - Poultney, Vermont - Scale: 1 in. = 60 ft. - Dated: Aug. 1962, revision Aug. 1965, revision Sept. 1965 and revision Dec. 1967 - Young & Hemenway, Engr's., Rutland, Vermont", a copy of which Survey Map is filed in said Poultney Public Land Records.

Reference is also made to a deed to Northeast Developers, Inc. from J. Malcolm Williams and Esther W. Williams, dated January 4, 1968, which deed is to be recorded in said Poultney Public Land Records.

The courses and distances hereinafter set forth are taken from said Survey Map which shall be controlling for all purposes whatsoever.

The premises hereby conveyed are particularly described as follows:

Parcel One

Commencing at an iron pin in the southerly line of the "town highway" (depicted on said Survey Map and leading to Route #30) which beginning point is twenty feet (20') N 76° E of an iron pin marking the southwesterly terminal of said "town Highway", THENCE S 31° 50' W three hundred ninety-seven feet (397') to an iron pin marking the southeasterly corner of lands of R. Goodrich (which point also marks the northeasterly corner of Lot #1 now

CERTIFICATE OF HIGHWAY MILEAGE

or formerly owned by Clair Senecal); thence S 69° 10' E fifty feet (50') to an iron pin marking the northwesterly corner of Lot #12; thence N 31° 50' E four hundred thirty-six feet (436') to an iron pin in the aforesaid southerly line of the "town highway"; thence S 76° W along the said southerly line sixty-nine and seven-tenths feet (69.7) to the place of beginning.

Parcel Two

Commencing at an iron pin marking the southwesterly corner of Parcel One (which point marks the southeasterly corner of lands depicted on said Survey Map as R. Goodrich), which point also marks the northeasterly corner of lands depicted on said Survey Map as Clair Senecal Lot #1, THENCE S 19° 20' W along the easterly lines of lots one, seven, eight, nine, ten and eleven, three hundred forty feet (340') to an iron pin; thence thirty-one and six-tenths feet (31.6') S 37° 45' W along the rest of the easterly boundary of Lot #11 to an iron pin marking the southeasterly corner of Lot #11; thence two hundred thirty-one and five-tenths feet (231.5') N 70° 40' W along the southerly line of Lot #11 to an iron pin marking the southwesterly corner of Lot #11; thence three hundred nineteen and twenty-five hundredths feet (319.25') N 39° 20' E along the westerly lines of lots eleven, ten, nine, eight and seven to an iron pin in the southerly line of the Clair Senecal Lot #1; thence thirty-five and one-tenth feet (35.1') N 70° 40' W along the southerly line of said Senecal Lot to an iron pin marking the northerly corner of Lot #2; thence two hundred seventy-five feet (275') S 39° 20' W along the easterly line of Lots two, three, four, five and six to an iron pin marking the southeasterly corner of Lot #6; thence continuing S 39° 20' W ninety-eight feet (98') $\frac{1}{2}$ to an iron pin; thence seventy-seven feet (77') S 70° 40' E to an iron pin marking the northwesterly corner of a lot marked "Harmon"; thence one hundred ten feet (110') S 57° 40' E along the Harmon lot line to a point marking an incorner; thence sixty-six feet (66') S 44° 25' E to an iron pin; thence S 68° E one hundred sixteen feet (116') $\frac{1}{2}$ to an iron pin; thence N 19° 20' E ninety-one feet (91') $\frac{1}{2}$ to an iron pin marking the southwesterly corner of Lot # 15; thence N 19° 20' E along the westerly lines of Lots fifteen, fourteen, thirteen and twelve, four hundred feet (400') to an iron pin marking the northwesterly corner of Lot #12 (which point also marks the southeasterly corner of Parcel One mentioned above); thence N 69° 10' W and along the southerly line of Parcel One fifty feet (50') $\frac{1}{2}$ to the point of beginning.

1077.67' Zounds

Parcel Three

Commencing at an iron pin marking an incorner in Lot #19A (which point is N 36° 35' E and eighty feet (80') distant from the southwesterly corner of Lot #19A which is the "Phelan Lot", so-called), THENCE N 69° 35' E eighty-four feet (84') to an iron pin; thence S 74° 40' E one hundred eleven and nine-tenths feet (111.9') to an iron pin marking the northeasterly corner of Lot 19A; thence S 23° 20' W one hundred thirty-four and three-tenths feet (134.3') to the southeasterly corner of Lot 19A; thence S 23° 20' W three hundred sixty-three and seven-tenths feet (363.7') to an iron pin in an old wall and fence which point is in the

2,133.0' Hills

CERTIFICATE OF HIGHWAY MILEAGE

the northerly boundary of Anderson; thence N 72° E \pm thirty-three and two-tenths feet (33.2') to an iron pin marking the southwesterly corner of Lot #27; thence N 23° 20' E four hundred ninety-five feet (495') along the westerly line of lots of 27, 26, 25, 24 and 23 to an iron pin marking the northwesterly corner of Lot #23; thence S 66° 40' E and along the northerly line of Lot #23 one hundred sixty-five feet (165') to an iron pin marking the northeasterly corner of Lot #23; thence S 23° 20' W four hundred eighty-one feet (481') \pm along the easterly line of lots 23, 24, 25, 26 and 27 to an iron pin in the aforesaid northerly line of Anderson; thence S 72° E \pm along the northerly line of lands of Anderson thirty-three and two-tenths feet (33.2') to an iron pin marking the northwesterly corner of Lot #35; thence N 23° 20' E four hundred seventy-six feet (476') \pm along the westerly line of lots 35, 34, 33, 32 and 31 to an iron pin marking the northwesterly corner of Lot #31; thence S 66° 40' E one hundred fifty-one and five-tenths feet (151.5') to an iron pin marking the northeasterly corner of Lot #31; thence in a northeasterly direction and in a straight line fifty feet (50') to an iron pin marking the southeasterly corner of Lot #30; thence N 66° 40' W one hundred sixty feet (160') to an iron pin marking the southwesterly corner of Lot #30; thence N 19° 40' E two hundred ninety-eight and eight-tenths feet (298.8') to an iron pin (which pin is in the southerly line of Slate Inc. lands); thence N 66° 40' W thirty-three feet (33') to an iron pin marking the northeasterly corner of Lot #20; thence S 19° 40' W two hundred ninety-eight and eight-tenths feet (298.8') along the easterly line of lots 20, 21 and 22 to an iron pin marking the southeasterly corner of Lot #22; thence N 66° 40' W one hundred sixty-one and six-tenths feet (161.6') to an iron pin marking the southwesterly corner of Lot #22; thence N 19° 40' E two hundred ninety-eight and eight-tenths feet (298.8') along the westerly line of lots 22, 21 and 20 to an iron pin and lands of Slate Inc.; thence N 66° 40' W thirty-three feet (33') to an iron pin marking the northeasterly corner of Lot #16; thence S 19° 40' W two hundred ninety-eight and eight-tenths feet (298.8') along the easterly line of lots 16, 17 and 18 to an iron pin marking the southeasterly corner of Lot #18; thence N 74° 40' W one hundred thirty-five feet (135') to an iron pin; thence S 69° 35' W ninety and seven-tenths feet (90.7') to an iron pin marking the southwesterly corner of Lot #18 (which point also marks the northeasterly corner of Lot #12); thence S 69° 35' W twenty-four and three-tenths feet (24.3') to an iron pin; thence in a southeasterly direction and in a straight line crossing the 50'-road to the point of beginning.

The parcels above described and referred to and herein conveyed are to be used solely for highway purposes.

To which Survey Map, deeds, other title deeds of record, the references therein contained and the records thereof made, or to be made, when made, reference is hereby made and had for a more particular description.

TO HAVE AND TO HOLD said granted premises, with all the privileges and appurtenances thereof, to the said Grantee, the TOWN OF FOULTNEY, its heirs and assigns, to its own use and behoof forever.

and it the said Grantor, NORTHEAST DEVELOPERS, INC., for itself and its heirs, executors and administrators, does covenant with the said Grantee and its heirs and assigns, that until the ensealing of these presents it is the sole owner of the premises, and has good right and title to convey the same in manner aforesaid, that they are FREE FROM EVERY ENCUMBRANCE; this deed is given and accepted on condition that Grantor reserves the right and privilege to maintain the driven well as presently located (depicted on said Survey Map as between the easterly line of Lot #1 and the westerly line of Lot #12) and the pipelines for conveyance of water from said well as presently located underground, together with the right and privilege of extending them, on, in and under the roadways on Parcels One, Two and Three. Together with the right to maintain, repair and/or replace said well and pipelines (including extentions thereof) at its sole risk and expense. Grantor is to have the right to excavate, from time to time, such portions of the three parcels as is reasonably necessary for the maintenance, repair and replacement of said well, pipelines and extentions, provided however, any portion used for such purposes be replaced without cost to said Town and left in as good condition for highway use as prior to any such excavation. Such rights, privileges and provisions shall inure to the benefit of and be binding upon the parties hereto and their respective successors and assigns.

It does hereby engage to WARRANT AND DEFEND the same against all lawful claims whatever.

IN WITNESS WHEREOF, it hereunto sets its hand and seal this 13th day of March, A.D. 1968.

In Presence Of:

NORTHEAST DEVELOPERS, INC.

James W. Leggett
Sheryl Sussman

George B. DeLoach LS

(seal)

CERTIFICATE OF COMPLETION AND OPENING
OF A HIGHWAY FOR PUBLIC TRAVEL

Priscilla B. Hadley, TOWN Clerk of the Town
of Poultney, Vermont

Pursuant to Title 19, V.S.A., Section 15, as amended, this is to certify
that the following described section(s) of highway in the Town
of Poultney, Route Number as specified on Map, was
COMPLETED AND OPEN FOR PUBLIC TRAVEL, on January 8, 1968.

Description of Right-of-Way: Beginning

and as shown on a Highway Map of the _____ of _____
dated January 8, 1968, and filed in Book of Maps on Page 49 of the
Records of the Town of Poultney by the Town
Clerk of said Poultney, incorporated herein by reference
and attested to on said map by said Town Clerk.

Dated at Poultney, County of Rutland, and
State of Vermont, this 20th day of March, A.D. 1968.

Hayward L. Dick
Ernest B. Berry
[Signature]

Board
Selectmen
(Albany)
(Trustees)

Chairman of the Board of Selectmen
and the Mayor of the City of Poultney

Poultney, Vermont
March 20, 1968

The above is a true copy of description of section(s) of highway,
COMPLETED AND OPENED FOR PUBLIC TRAVEL, recorded in Book of Maps on Page 49
of Maps Records of the Town of Poultney
on the 20 day of March, 1968, at 9:00 o'clock A.M.

Attest: Priscilla B. Hadley
Town Clerk of Poultney, Vermont

CERTIFICATE OF HIGHWAY MILEAGE

FOR YEAR ENDING FEBRUARY 10, 1968



Fill out in triplicate and file with your Town Clerk on or before February 10, 1968

(Note sections of Vermont Statutes Annotated on reverse side of this sheet)

We, the Selectmen of the town of Poultney on oath state that we have personally all the traveled highways in this town and find that the total mileage of traveled highways according to Title 10, 1961, Act No. 28, not including pent roads and trails, in this town for the year ending February 10, 1968, is as follows:

	MILEAGE IN TOWN (Outside of villages Incorporated for highways)			MILEAGE IN VILLAGE (Incorporated for highways)			Total All Systems
	POULTNEY						
	Town Highways	State Aid Highways	State Highways	Town Highways	State Aid Highways	State Highways	
PREVIOUS MILEAGE as shown March 15, 1967	45,13	11,134	11,910				68,174
HIGHWAYS ADDED Since March 15, 1967, ac- cording to statute. Explain under paragraph 1 below.							
SUB-TOTAL							
HIGHWAYS SUBTRACTED Since March 15, 1967. Those becoming untraveled, discon- tinued, legal trails or pent roads. Explain under para- graphs 2 and 3 below.							
TOTAL TRAVELED HIGHWAYS Feb. 10, 1968.							

1. We hereby certify that the following new highways, as substantiated by the attached "Selectmen's Certificate of Completion", have been added since March 15, 1967:

.....

2. We hereby certify that the following highways have been discontinued, or changed to trails or pent roads according to statute, since March 15, 1967, as substantiated by the attached copy of the proceedings:

.....

3. We hereby certify that the following roads have become untraveled since March 15, 1967:

.....

SELECTMEN:
Matthew J. Harison
Gaylord L. Fish
S. N. Olson
Erwin B. Berry

At Poultney in the county of Rutland
 the 20th day of March, 1968 personally appeared Matthew J. Harison,
Gaylord L. Fish, S. N. Olson and Erwin B. Berry

Selectmen of Town of Poultney
 and made oath to the truth of the foregoing affidavit by them subscribed.

Before me,
Priscilla B. Hadley
Notary Public
 Notary Public

(Town Clerk should fill out following and mail one white and one yellow copy to the Commissioner of Highways, Montpelier, Vermont, on or before March 15th.)

I, Priscilla B. Hadley, Clerk of the Town of Poultney
 hereby certify that the foregoing is a true copy of record of the certificate of the Selectmen of Town of Poultney
 relating to highway mileage, filed and recorded at this office March 20,

Attest: *Priscilla B. Hadley*
 Town Clerk

CERTIFICATE OF HIGHWAY MILEAGE

FOR YEAR ENDING FEBRUARY 10, 1968

Fill out in triplicate and file with your Town Clerk on or before February 10, 1968

(Note sections of Vermont Statutes Annotated on reverse side of this sheet)

We, the Selectmen of the town of Poultney, on oath state that we have carefully examined all the traveled highways in this town and find that the total mileage of traveled highways according to Title 19, V.S.A., Sec. 15, Chapter 106, Act No. 28, not including pent roads and trails, in this town for the year ending February 10, 1968, is as follows:

	MILEAGE IN TOWN (Outside of villages incorporated for highways)			MILEAGE IN VILLAGE (incorporated for highways)			Total All Systems
	POULTNEY						
	Town Highways	State Aid Highways	State Highways	Town Highways	State Aid Highways	State Highways	
PREVIOUS MILEAGE as shown March 15, 1967	45.13	11.134	11.910				68.174
HIGHWAYS ADDED Since March 15, 1967, ac- cording to statute. Explain under paragraph 1 below.							
SUB-TOTAL							
HIGHWAYS SUBTRACTED Since March 15, 1967. Those becoming untraveled, discon- tinued, legal trails or pent roads. Explain under para- graphs 2 and 3 below.							
TOTAL TRAVELED HIGHWAYS Feb. 10, 1968.							

1. We hereby certify that the following highways have been added since March 15, 1967:

2. We hereby certify that the following highways have been discontinued, or changed to trails or pent roads, according to statute, since March 15, 1967, as substantiated by the attached copy of the proceedings:

3. We hereby certify that the following roads have become untraveled since March 15, 1967:

SELECTMEN:

Matthew J. Harmon
Ervin B. Berry

At Poultney in the county of Rutland
the 20th day of March, 1968 personally appeared Matthew J. Harmon,
Gaylord L. Fish, S. H. Olson and Ervin B. Berry

Selectmen of Town of Poultney
and made oath to the truth of the foregoing affidavit by them subscribed.

Before me,

Francilla B. Hadley
Notary Public

(Town Clerk should fill out following and mail one white and one yellow copy to the Commissioner of Highways, Montpelier, Vermont, on or before March 15th.)

I, Francilla B. Hadley, Clerk of the Town of Poultney
hereby certify that the foregoing is a true copy of record of the certificate of the Selectmen of Town of Poultney
relating to highway mileage, filed and recorded at this office March 20, 1968

Attest

Francilla B. Hadley
Town Clerk

TOWN OF POULTNEY

IN THE HEART OF THE STATE BELT

OFFICE OF THE TOWN MANAGER
POULTNEY, VERMONT

March 20, 1968



Mr. L. S. Larsen
Commissioner of Highways
State of Vermont
Montpelier, Vermont

Dear Sir:

Due to the fact that I am not familiar with the enclosed report I visited your Rutland Office in reference to this addition of new Highways. It was suggested that I send the enclosed Map and description, and your office will make necessary completion.

I am also enclosing the Poultney Office copy, after it is completed please return to our office for filing.

Thankyou very kindly.

Very truly yours,

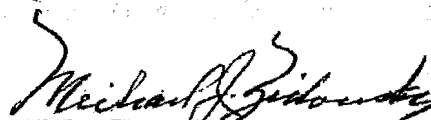
Michael J. Zidovsky
Town Manager

LAKE ST. CATHERINE (SWITZERLAND OF NEW ENGLAND)
MACHINE DESIGN AND MANUFACTURING

IRON FOUNDRY

HOME OF GREEN MOUNTAIN COLLEGE
DRESS MANUFACTURING

OFFICE OF THE
COMMISSIONER

CERTIFICATE OF HIGHWAY MILEAGE

FOR THE YEAR ENDING FEBRUARY 28, 1968



We, the Selectmen of the Town of Poultney, Vermont, do hereby certify that we have accurately determined the mileage of the traveled highways within the town of Poultney, Vermont, for the year ending February 28, 1968, in accordance with the provisions of Act No. 28, Act of 1967, Chapter 107, of the Statutes of the State of Vermont, as amended, and in accordance with the provisions of Act No. 28, Act of 1967, Chapter 107, of the Statutes of the State of Vermont, as amended, and in accordance with the provisions of Act No. 28, Act of 1967, Chapter 107, of the Statutes of the State of Vermont, as amended.

STATE OF VERMONT
DEPARTMENT OF HIGHWAYS
MONTPELIER
Highway Planning Division

MILEAGE IN TOWN

August 15, 1968

Total
All

FOUNTAIN					State
State	State and	State	State	State	Highways
Highways	Highways	Highways	Highways	Highways	Highways

PREVIOUS MILEAGE

Board of Selectmen

11,134

11,170

HIGHWAYS ADDED

Town of Poultney

Poultney, Vermont

Attention of Chairman

Gentlemen:

Due to the late receipt of your Highway Mileage Certificate for 1968, the Town Highway mileage changes which you requested could not be made.

The information which you submitted will be kept on file and will be checked in the coming months. If found correct, your 1969 Highway Mileage Certificate will reflect the additions which you requested for 1968.

Sincerely yours,

R. J. Nicholls
Highway Planning Engineer

By: J. E. Bisson
Administrative Assistant

RJN/JEB/mam

Selectmen of _____
and made oath to the truth of the foregoing affidavit by them subscribed.

Before me.

CERTIFICATE OF HIGHWAY MILEAGE

FOR YEAR ENDING FEBRUARY 10, 1968

Fill out in triplicate and file with your Town Clerk on or before February 10, 1968

(Note sections of Vermont Statutes Annotated on reverse side of this sheet)

We, the Selectmen of the town of **Poultney**, on oath state that we have carefully measured all the traveled highways in this town and find that the total mileage of traveled highways according to Title 19, V.S.A. Sec. 16, amended 1961, Act No. 28, not including pent roads and trails, in this town for the year ending February 10, 1968, is as follows:

	MILEAGE IN TOWN (Outside of villages incorporated for highways)			MILEAGE IN VILLAGE (Incorporated for highways)			Total All Systems
	POULTNEY						
	Town Highways	State Aid Highways	State Highways	Town Highways	State Aid Highways	State Highways	
PREVIOUS MILEAGE as shown March 15, 1967	45.13	11.134	11.910				68.174
HIGHWAYS ADDED Since March 15, 1967, ac- cording to statute. Explain under paragraph 1 below.							
SUB-TOTAL							
HIGHWAYS SUBTRACTED Since March 15, 1967. Those becoming untraveled, discon- tinued, legal trails or pent roads. Explain under para- graphs 2 and 3 below.							
TOTAL TRAVELED HIGHWAYS Feb. 10, 1968.							

1. We hereby certify that the following new highways, as substantiated by the attached "Selectmen's Certificate of Completion", have been added since March 15, 1967:

No Certificate returned 1966-1967 figures

2. We hereby certify that the following highways have been discontinued, or changed to trails or pent roads according to statute, since March 15, 1967, as substantiated by the attached copy of the proceedings:

3. We hereby certify that the following roads have become untraveled since March 15, 1967:

SELECTMEN:

At _____ in the county of _____
the _____ day of _____, 1968 personally appeared _____

Selection of _____
and made oath to the truth of the foregoing affidavit by them subscribed.

Before me,

(By this official title as Notary Public)

(Town Clerk should fill out following and mail one white and one yellow copy to the Commissioner of Highways, Montpelier, Vermont, on or before March 15th.)

I, _____, Clerk of the Town of _____ hereby certify that the foregoing is a true copy of record of the certificate of the Selectmen of _____ relating to highway mileage filed and recorded at this office _____

Attest

CERTIFICATE OF HIGHWAY MILEAGE

FOR YEAR ENDING FEBRUARY 10, 1967

Fill out in triplicate and file with your Town Clerk on or before February 10, 1967

(Note sections of Vermont Statutes Annotated on reverse side of this sheet)

We, the Selectmen of the town of Poultney, on oath state that we have carefully measured all the traveled highways in this town and find that the total mileage of traveled highways according to Title 19, V.S.A. Sec. 15, amended 1961, Act No. 28, not including pent roads and trails, in this town for the year ending February 10, 1967, is as follows:

	MILEAGE IN TOWN (Outside of villages Incorporated for highways)			MILEAGE IN VILLAGE (Incorporated for highways)			Total All Systems
	POULTNEY						
	Town Highways	State Aid Highways	State Highways	Town Highways	State Aid Highways	State Highways	
PREVIOUS MILEAGE as shown March 15, 1966	44.54	11.384	11.910				67.834
HIGHWAYS ADDED Since March 15, 1966, ac- cording to statute. Explain under paragraph 1 below.	+1.58						
SUB-TOTAL							
HIGHWAYS SUBTRACTED Since March 15, 1966. Those becoming untraveled, discon- tinued, legal trails or pent roads. Explain under para- graphs 2 and 3 below.	-0.99	-0.25					
TOTAL TRAVELED HIGHWAYS Feb. 10, 1967	45.13	11.134	11.910				68.174

1. We hereby certify that the following new highways, as substantiated by the attached "Selectmen's Certificate of Completion", have been added since March 15, 1966:

.....

.....

.....

2. We hereby certify that the following highways have been discontinued, or changed to trails or pent roads according to statute since March 15, 1966, as substantiated by the attached copy of the proceedings:

.....

.....

.....

3. We hereby certify that the following roads have become untraveled since March 15, 1966:

.....

.....

.....

SELECTMEN:

Guyford L. Ingh
William Olson
Matthew S. Hadden

At Poultney in the county of Windsor
the 27 day of February, 1967 personally appeared Guyford L. Ingh, William Olson, Matthew S. Hadden
Selectmen of Poultney
and made oath to the truth of the foregoing affidavit by them subscribed.

Before me,

Michelle B. Hadley
Nancy Culbert
(Write official title or office below)

(Town Clerk should fill out following and mail one white and one yellow copy to the Commissioner of Highways, Montpelier, Vermont, on or before March 15th.)

I, Michelle B. Hadley, Clerk of the Town of Poultney
hereby certify that the foregoing is a true copy of record of the certificate of the Selectmen of Poultney
relating to highway mileage, filed and recorded at this office.

Attest

Michelle B. Hadley

REMEASUREMENT 1968
SELECTION OF STATE AID HIGHWAYS

Town of Poultny

County of Rutland

Vt. Hwy. Dist. No. 3

Total State Mileage 11.136

Important town highways as required by Title 19, V.S.A., Sections 1 & 13:

No. 1 0.404 miles.

Beginning at the end of State Highway on the Wells-Poultney State Highway

extending (Give direction) northerly toward Poultny Village (S.A.C.L.)

ending at the Poultny Village Line; it being part of the Wells-Poultney State Highway.

No. 2 4.60 miles.

Beginning at the Poultny east Village line on Main Street

extending (Give direction) northeasterly through East Poultny and southeasterly toward

Wallingford

ending at the Middletown Springs town line; it being all State Aid Numbered Route 140.

No. 3 0.23 miles.

Beginning at the northwest Poultny Village line on York Street

extending (Give direction) northwesterly

ending at the New York State Line in the Poultny River

No. 4 0.26 miles.

Beginning at the New York State Line on Granville Street

extending (Give direction) northeasterly

ending at the Poultny south village line.

No. 5 3.16 miles.

Beginning at York Street on the Fair Haven road near the northwest Poultny Village Line

extending (Give direction) northerly and northwesterly toward Fair Haven

ending at the Fair Haven Town Line.

No. 6 1.57 miles.

Beginning at Route Vt. 30, southeast of Poultny Village on the East Poultny Road

extending (Give direction) northerly along the East Poultny Road

ending at its intersection with State Aid Highway No. 1 to East Poultny

RUSSELL A. HOLDEN
COMMISSIONER OF HIGHWAYS

File copy



YOUR CHANGING ANY OTHER TOWN HIGHWAY MILEAGE PROCESSED IN ACCORDANCE WITH
THE STATUTES OF THE STATE OF VERMONT

DEPARTMENT OF HIGHWAYS
MONTPELIER, VERMONT

1877

Highway Planning Division

R. J. Nicholls
Highway Planning Engineer
December 13, 1966

RRH/LEB/abc

Board of Selectmen
Town of Poultney
Poultney, Vermont

Attention of Chairman

Gentlemen:

In accordance with Title 19, V.S.A., Section 15, as amended, all the traveled highways in your town were measured in 1966 by Mr. Earl P. Hubbard, Town Manager; Mr. Richard Haynes, Selectman; with Mr. Potter of this office.

The resulting changes in highway mileage are indicated on the enclosed map and are explained on the attached breakdown sheets. You will note that the second sheet contains a list of highways for which we will need copies of the Rights-of-Way and Certificate of Completion and Opening before they can be added to your Town Highway Mileage.

Relative to the 0.26 mile of T-14 which you have indicated you wish to discontinue, it will be necessary that you furnish us with a copy of the notice of discontinuance before the mileage can be subtracted from your Town Highway System.

In addition, as per the Selection Certificate which you recently signed, State Aid Mileage in your town will have the following changes:

SA 2 will decrease -0.14 mile due to 1966 remeasurement
SA 3 will decrease -0.11 mile due to 1966 remeasurement

For your convenience, we have entered the changes in Town Highway Mileage on the enclosed Highway Mileage Certificate and would appreciate

*RECEIVED
3/18/67
NOTE: RECEIVED
3/18/67*

STATE OF MICHIGAN
DEPARTMENT OF TRANSPORTATION

your entering any other Town Highway changes processed in accordance with the Statutes this past year.

1957	1957	1957
1958	1958	1958
1959	1959	1959
1960	1960	1960
1961	1961	1961
1962	1962	1962
1963	1963	1963
1964	1964	1964
1965	1965	1965
1966	1966	1966
1967	1967	1967
1968	1968	1968
1969	1969	1969
1970	1970	1970
1971	1971	1971
1972	1972	1972
1973	1973	1973
1974	1974	1974
1975	1975	1975
1976	1976	1976
1977	1977	1977
1978	1978	1978
1979	1979	1979
1980	1980	1980
1981	1981	1981
1982	1982	1982
1983	1983	1983
1984	1984	1984
1985	1985	1985
1986	1986	1986
1987	1987	1987
1988	1988	1988
1989	1989	1989
1990	1990	1990
1991	1991	1991
1992	1992	1992
1993	1993	1993
1994	1994	1994
1995	1995	1995
1996	1996	1996
1997	1997	1997
1998	1998	1998
1999	1999	1999
2000	2000	2000
2001	2001	2001
2002	2002	2002
2003	2003	2003
2004	2004	2004
2005	2005	2005
2006	2006	2006
2007	2007	2007
2008	2008	2008
2009	2009	2009
2010	2010	2010
2011	2011	2011
2012	2012	2012
2013	2013	2013
2014	2014	2014
2015	2015	2015
2016	2016	2016
2017	2017	2017
2018	2018	2018
2019	2019	2019
2020	2020	2020
2021	2021	2021
2022	2022	2022
2023	2023	2023
2024	2024	2024
2025	2025	2025
2026	2026	2026
2027	2027	2027
2028	2028	2028
2029	2029	2029
2030	2030	2030

Very truly yours,

R. J. Nicholls
Highway Planning Engineer

RJN/JEB/dbc

Encl.

1957
1958
1959
1960
1961
1962
1963
1964
1965
1966
1967
1968
1969
1970
1971
1972
1973
1974
1975
1976
1977
1978
1979
1980
1981
1982
1983
1984
1985
1986
1987
1988
1989
1990
1991
1992
1993
1994
1995
1996
1997
1998
1999
2000
2001
2002
2003
2004
2005
2006
2007
2008
2009
2010
2011
2012
2013
2014
2015
2016
2017
2018
2019
2020
2021
2022
2023
2024
2025
2026
2027
2028
2029
2030

Breakdown of 1966
Road Measurement Changes

<u>Map Ident. Letter</u>	<u>Town Hwy. No.</u>	<u>Miles Added</u>	<u>Miles Subtracted</u>	<u>Explanation</u>
A	T-10	+0.18		Remasurement
C	T-27		-0.22	Remasurement
D	T-29	+0.05		Now traveled 0.30 mile from T-9
E	T-29	+0.33		Now traveled 1.40 Miles from Castletown T/L
F	T-31	+0.41		Now traveled entire length
G	T-33	+0.04		Remasurement
H	T-35		-0.29	Pent road beyond 0.52 mile from Wall-Foultney State Highway
I	T-37	+0.06		Remasurement
J	T-40		-0.08	Remasurement
K	T-44	+0.27		Now traveled entire length
L	T-46	+0.08		Remasurement
M	T-48	+0.16		Now traveled SA 2 to SA 2
N	T-50		-0.40	Pent road from T-9 to end
		<u>+1.58</u>	<u>-0.99</u>	

**Breakdown of 1966 Road Measurement on Town Highways
 requiring copy of Right-of-Way and Certificate of Completion
 and Opening of Road to Public Travel**

<u>Map Ident. Letter</u>	<u>Town Highway No.</u>	<u>Mileage</u>	<u>Explanation</u>
O	T-14	+0.25	Addition (between T-13 and SA-7) to T-14
P	T-51	+0.07	Addition to T-51
Q	North Aves. Ext.	<u>+0.08</u> <u>+0.40</u>	New Road

CERTIFICATE OF HIGHWAY MILEAGE

FOR YEAR ENDING FEBRUARY 10, 1966

Fill out in triplicate and file with your Town Clerk on or before February 10, 1966

(Note sections of Vermont Statutes Annotated on a reverse side of this sheet)

We, the Selectmen of the town of Poultney, on oath state that we have carefully measured all the traveled highways in this town and find that the total mileage of traveled highways according to Title 19, V.S.A. Sec. 15, amended 1961, Act No. 28, not including pent roads and trails, in this town for the year ending February 10, 1966, is as follows:

	MILEAGE IN TOWN (Outside of villages incorporated for highways)			MILEAGE IN VILLAGE (Incorporated for highways)			Total All Systems
	POULTNEY						
	Town Highways	State Aid Highways	State Highways	Town Highways	State Aid Highways	State Highways	
PREVIOUS MILEAGE as shown March 15, 1965	44.54	11.384	11.910				67.834
HIGHWAYS ADDED Since March 15, 1965, ac- cording to statute. Explain under paragraph 1 below.							
SUB-TOTAL							
HIGHWAYS SUBTRACTED Since March 15, 1965. Those becoming untraveled, discon- tinued, legal trails or pent roads. Explain under para- graphs 2 and 3 below.							
TOTAL TRAVELED HIGHWAYS Feb. 10, 1966							

1. We hereby certify that the following new highways, as substantiated by the attached "Selectmen's Certificate of Completion", have been added since March 15, 1965:

.....

2. We hereby certify that the following highways have been discontinued, or changed to trails or pent roads according to statute, since March 15, 1965, as substantiated by the attached copy of the proceedings:

.....

3. We hereby certify that the following roads have become untraveled since March 15, 1965:

.....

SELECTMEN: *Raymond F. Burke*
Raymond L. Fish
Richard G. Haynes
S. N. Olson
Matthew J. Hannon

At Poultney
 the 21st day of February, 1966 personally appeared Raymond F. Burke,
Gaylord L. Fish, Richard G. Haynes, S. N. Olson, Matthew J. Hannon

Selectmen of Poultney
 and made oath to the truth of the foregoing affidavit by them subscribed.

Before me,
Priscilla B. Hadley
 Notary Public
 (Write official title, as Notary Public)

(Town Clerk should fill out following and mail one white and one yellow copy to the Commissioner of Highways, Montpelier Vermont, on or before March 15th.)

I, Priscilla B. Hadley, Clerk of the Town of Poultney
 hereby certify that the foregoing is a true copy of record of the certificate of the Selectmen of Poultney
 relating to highway mileage, filed and recorded at this office February 21

Attest *Priscilla B. Hadley*
 Town Clerk

CERTIFICATE OF HIGHWAY MILEAGE

FOR YEAR ENDING FEBRUARY 10, 1965

Fill out in triplicate and file with your Town Clerk on or before February 10, 1965

(Note sections of Vermont Statutes Annotated on reverse side of this sheet)

We, the Selectmen of the town of Poultney, on oath state that we have carefully measured all the traveled highways in this town and find that the total mileage of traveled highways according to Title 19, V.S.A. Sec. 15, amended 1961, Act No. 28, not including pent roads and trails, in this town for the year ending February 10, 1965, is as follows:

	MILEAGE IN TOWN (Outside of villages incorporated for highways)			MILEAGE IN VILLAGE (Incorporated for highways)			Total All Systems
	POULTNEY			Town Highways	State Aid Highways	State Highways	
	Town Highways	State Aid Highways	State Highways				
PREVIOUS MILEAGE as shown March 15, 1964	44.54	11.384	11.910				67.834
HIGHWAYS ADDED Since March 15, 1964, according to statute. Explain under paragraph 1 below.							
SUB-TOTAL							
HIGHWAYS SUBTRACTED Since March 15, 1964. Those becoming untraveled, discontinued, legal trails or pent roads. Explain under paragraphs 2 and 3 below.							
TOTAL TRAVELED HIGHWAYS Feb. 10, 1965							

1. We hereby certify that the following new highways, as substantiated by the attached "Selectmen's Certificate of Completion," have been added since March 15, 1964:

.....

2. We hereby certify that the following highways have been discontinued, or changed to trails or pent roads according to statute, since March 15, 1964, as substantiated by the attached copy of the proceedings:

.....

3. We hereby certify that the following roads have become untraveled since March 15, 1964:

.....

SELECTMEN: *Raymond F. Burke*
Richard G. Haynes
Gaylord L. Fish
Matthew J. Harmon

At Poultney in the county of Rutland
 the 2nd day of March, 1965 personally appeared Raymond F. Burke,
Richard G. Haynes, Gaylord L. Fish, Matthew J. Harmon

Selectmen of The Town of Poultney and made oath to the truth of the foregoing affidavit by them subscribed.

Before me, *Lucille B. Huddy*
Notary Public
 (Write official title, as Notary Public)

(Town Clerk should fill out following and mail one white and one yellow copy to the Commissioner of Highways, Montpelier, Vermont, on or before March 15th.)

I, *Lucille B. Huddy*, Clerk of the Town of Poultney, hereby certify that the foregoing is a true copy of record of the certificate of the Selectmen of Poultney relating to highway mileage, filed and recorded at this office March 5, 1965.

Attest *Lucille B. Huddy*
 Town Clerk

CERTIFICATE OF HIGHWAY MILEAGE

FOR YEAR ENDING FEBRUARY 10, 1964

Fill out in triplicate and file with your Town Clerk on or before February 10, 1964

(Note sections of Vermont Statutes Annotated on reverse side of this sheet)

We, the Selectmen of the town of Poultney, on oath state that we have carefully measured all the traveled highways in this town and find that the total mileage of traveled highways according to Title 19, V.S.A. Sec. 11, amended 1961, Act No. 28, not including pent roads and trails, in this town for the year ending February 10, 1964, is as follows:

	MILEAGE IN TOWN (Outside of villages incorporated for highways)			MILEAGE IN VILLAGE (Incorporated for highways)			Total All Systems
	POULTNEY						
	Town Highways	State Aid Highways	State Highways	Town Highways	State Aid Highways	State Highways	
PREVIOUS MILEAGE as shown March 15, 1963	44.54	11.384	11.910				67.834
HIGHWAYS ADDED Since March 15, 1963, according to statute. Explain under paragraph 1 below.							
SUB-TOTAL							
HIGHWAYS SUBTRACTED Since March 15, 1963. Those becoming untraveled, discontinued, legal trails or pent roads. Explain under paragraphs 2 and 3 below.							
TOTAL TRAVELED HIGHWAYS Feb. 10, 1964	44.54	11.384	11.910				67.834

1. We hereby certify that the following new highways, as substantiated by the attached "Selectmen's Certificate of Completion," have been added since March 15, 1963:

.....

.....

2. We hereby certify that the following highways have been discontinued, or changed to trails or pent roads according to statute, since March 15, 1963, as substantiated by the attached copy of the proceedings:

.....

.....

3. We hereby certify that the following roads have become untraveled since March 15, 1963:

.....

.....

SELECTMEN:

Matthew J. Harmon
Richard G. Haynes
Raymond H. Burke

At Poultney in the county of Rutland
the 10 day of March, 1964 personally appeared Matthew J. Harmon
Richard G. Haynes Raymond Burke

Selectmen of Poultney and made oath to the truth of the foregoing affidavit by them subscribed.

Before me,

Priscilla D. Hadley
Notary Public
(Write official title of Notary Public)

(Town Clerk should fill out following and mail one white and one yellow copy to the Commissioner of Highways, Montpelier, Vermont, on or before March 15th.)

I, Priscilla D. Hadley, Clerk of the Town of Poultney
hereby certify that the foregoing is a true copy of record of the certificate of the Selectmen of Poultney
relating to highway mileage, filed and recorded at this office March 10

Attest:

Priscilla D. Hadley

HIGHWAY DEPARTMENT

OFFICE MEMORANDUM

TOWN

TO: VINCE THERRIEN

MILEAGE ADDITION

FROM: DON HARVEY

POULTNEY

DATE: 8/13/63

SUBJECT: MILEAGE ADDITION IN THE TOWN OF POULTNEY

NERTON AVE. WHICH RUNS FROM THE VILLAGE INTO THE TOWN WAS NOT ADDED LAST YEAR, WE ARE SUPPOSE TO GET CERTIFICATES THIS YEAR?

+0.05 IN VILLAGE + 0.09 IN TOWN A TOTAL +0.14

POULTNEY

HD-296 201-3-63

HIGHWAYS Feb. 10, 1963	11.63	11.384	11.910	2.05	2.766	--	73.340
------------------------	------------------	--------	--------	-----------------	-------	----	-------------------

1. We hereby certify that the following new highways, as substantiated by the attached "Selectmen's Certificate of Completion," have been added since March 15, 1962:

2. We hereby certify that the following highways have been discontinued, or changed to trails or pent roads according to statute, since March 15, 1962, as substantiated by the attached copy of the proceedings:

3. We hereby certify that the following roads have become untraveled since March 15, 1962:

SELECTMEN:

Matthew J. Hannon
Robert T. Marsh
Raymond F. Burke
S.N. Olson

At Poultney in the county of Rutland

the 5th day of March, 1963 personally appeared Matthew J. Hannon,

Robert T. Marsh, Raymond F. Burke and S.N. Olson

Selectmen of Town of Poultney

and made oath to the truth of the foregoing affidavit by them subscribed.

Before me,

1170

CERTIFICATE OF HIGHWAY MILEAGE

FOR YEAR ENDING FEBRUARY 10, 1963

Fill out in triplicate and file with your Town Clerk on or before February 10, 1963

(Note sections of Vermont Statutes Annotated on reverse side of this sheet)

We, the Selectmen of the town of Poultney, on oath state that we have carefully measured all the traveled highways in this town and find that the total mileage of traveled highways according to Title 19 V.S.A. Sec. 15, amended 1961, Act No. 28, not including pent roads and trails, in this town for the year ending February 10, 1963, is as follows:

	MILEAGE IN TOWN <small>(Outside of villages incorporated for highways)</small>			MILEAGE IN VILLAGE <small>(Incorporated for highways)</small>			Total All Systems
	Poultney			Poultney Village			
	Town Highways	State Aid Highways	State Highways	Town Highways	State Aid Highways	State Highways	
PREVIOUS MILEAGE as shown March 15, 1962	44.54	11.384	11.910	2.61	2.766	---	73,210
HIGHWAYS ADDED Since March 15, 1962, according to statute. Explain under paragraph 1 below.	0.00			0.00			
SUB-TOTAL	44.54			2.61			
HIGHWAYS SUBTRACTED Since March 15, 1962. Those becoming untraveled, discontinued, legal trails or pent roads. Explain under paragraphs 2 and 3 below.				<i>Changes not substantiated. Mr. Hubbard the Town Mgr says they will substantiate in time for next year</i>			
TOTAL TRAVELED HIGHWAYS Feb. 10, 1963	44.54 44.54	11.384	11.910	2.61 2.61	2.766	---	73,210 73,210

1. We hereby certify that the following new highways, as substantiated by the attached "Selectmen's Certificate of Completion," have been added since March 15, 1962:

2. We hereby certify that the following highways have been discontinued, or changed to trails or pent roads according to statute, since March 15, 1962, as substantiated by the attached copy of the proceedings:

3. We hereby certify that the following roads have become untraveled since March 15, 1962:

SELECTMEN:

*Matthew J. Hannon
Robert T. Marsh
Raymond F. Furke
S.N. Olson*

At Poultney in the county of Rutland
the 5th day of March, 1963 personally appeared Matthew J. Hannon,
Robert T. Marsh, Raymond F. Furke and S.N. Olson
Selectmen of Town of Poultney
and made oath to the truth of the foregoing affidavit by them subscribed.

Before me,

Matthew J. Hannon
Notary Public
(Write official title, or Notary Public)

(Town Clerk should fill out following and mail one white and one yellow copy to the Commissioner of Highways, Montpelier, Vermont, on or before March 15th.)

I, Charles W. Pickett, Clerk of the Town of Poultney
hereby certify that the foregoing is a true copy of record of the certificate of the Selectmen of Poultney
relating to highway mileage, filed and returned to this office

CERTIFICATE OF ORIGINAL AFFIDAVIT

WILLIAM POETER
COMMISSIONER OF HIGHWAYS

LOW CLASS ENGINEER SUPERVISOR



STATE OF VERMONT

DEPARTMENT OF HIGHWAYS

MONTPELIER

Highway Planning Division

February 28, 1962

Mrs. Dorothy Moore
Town Clerk
Poultney, Vermont

Dear Mrs. Moore:

Enclosed are the papers mentioned in the telephone conversation between you and Mr. Cookson this morning.

We appreciate your interest and cooperation in this matter and if we may be of any further service please feel free to call upon us.

Yours very truly,

H. F. Farrington
Highway Planning Engineer

HFF/VNT/enc
Encs.

2. We hereby certify that the following highways have been discontinued, or changed to trails or pent roads according to statute, since March 15, 1961, as substantiated by the attached copy of the proceedings:

3. We hereby certify that the following roads have become untraveled since March 15, 1961:

SELECTMEN:

Matthew J. Hannon
S. N. Olson
Raymond F. Burke
Robert T. Marsh
Richard Haynes

At Poultney
the 22nd day of March, 1962 personally appeared Matthew J. Hannon,
S. N. Olson, Raymond F. Burke, Robert T. Marsh, Richard Haynes
Selectmen of Town of Poultney
and made oath to the truth of the foregoing affidavit by them subscribed.

Before me,

11761

CERTIFICATE OF HIGHWAY MILEAGE

FOR YEAR ENDING FEBRUARY 10, 1962

Fill out in triplicate and file with your Town Clerk on or before February 10, 1962

(Note sections of Vermont Statutes Annotated on reverse side of this sheet)

We, the Selectmen of the town of Poultney, on oath state that we have carefully measured all the traveled highways in this town and find that the total mileage of traveled highways according to Title 19 V.S.A. Sec 15, amended 1961, Act No. 28, not including pent roads and trails, in this town for the year ending February 10, 1962, is as follows:

	MILEAGE IN TOWN <small>(Outside of villages incorporated for highways)</small>			MILEAGE IN VILLAGE <small>(Incorporated for highways)</small>			Total All Systems
	Poultney						
	Town Highways	State Aid Highways	State Highways	Town Highways	State Aid Highways	State Highways	
PREVIOUS MILEAGE as shown March 15, 1961	44.54	11.384	11.910	2.61	2.778	—	73.222
HIGHWAYS ADDED Since March 15, 1961, according to statute. Explain under paragraph 1 below.							
SUB-TOTAL							
HIGHWAYS SUBTRACTED Since March 15, 1961. Those becoming untraveled, discontinued, legal trails or pent roads. Explain under paragraphs 2 and 3 below.					0.012		<i>Reduction is due to reclassification of 5.00 c.m. by V.T. 1961-62 by St. Mary's</i>
TOTAL TRAVELED HIGHWAYS Feb. 10, 1962	44.54	11.384	11.910	2.61	2.766	—	73.210

1. We hereby certify that the following new highways, as substantiated by the attached "Selectmen's Certificate of Completion," have been added since March 15, 1961:

2. We hereby certify that the following highways have been discontinued, or changed to trails or pent roads according to statute, since March 15, 1961, as substantiated by the attached copy of the proceedings:

3. We hereby certify that the following roads have become untraveled since March 15, 1961:

SELECTMEN:

Matthew J. Bannon
S. M. Olson
Raymond F. Burke
Robert T. Marsh
Richard Haynes

At Poultney
the 22nd day of March, 1962 personally appeared Matthew J. Bannon, S. M. Olson, Raymond F. Burke, Robert T. Marsh, Richard Haynes
Selectmen of Town of Poultney
and made oath to the truth of the foregoing affidavit by them subscribed
Before me,

Charles L. Parker

(Town Clerk should fill out following and mail one white and one yellow copy to the Commissioner of Highways, State of Vermont, on or before March 15th.)

I, Charles L. Parker, Clerk of the Town of Poultney
hereby certify that the foregoing is a true copy of record of the certificate of the Selectmen of Poultney
relating to highway mileage, filed and recorded in the office of the Town Clerk.

19 Year Extension of Highway Law
Title 19, V.S.A., Sections 1 and 13
SELECTION OF STATE AID HIGHWAYS

Town of Poultney

County of Rutland

Vt. Hwy. Dist. No. 3

Total S.A. Mileage 11,384

C O P Y

Important town highways as required by Title 19, V.S.A., Sections 1 & 13:

No. 1 0.404 miles.

Beginning at the end of State Highway on the Wells-Poultney State Highway

extending (Give direction) northerly toward Poultney Village (S.A.C.L.)

ending at the Poultney Village line; it being part of the Wells-Poultney State Highway.

No. 2 4.74 miles.

Beginning at the Poultney east village line on Main Street

extending (Give direction) northeasterly through East Poultney and southeasterly toward Wallingford

ending at the Middletown Springs town line; it being all State Aid Numbered Route 140.

No. 3 0.23 miles.

Beginning at the northwest Poultney Village line on York Street

extending (Give direction) northwesterly

ending at the New York State Line in the Poultney River

No. 4 0.26 miles.

Beginning at the New York State Line on Granville Street

extending (Give direction) northeasterly

ending at the Poultney south village line.

No. 5 3.27 miles.

Beginning at York Street on the Fair Haven road near the northwest Poultney Village line

extending (Give direction) northerly and northwesterly toward Fair Haven

ending at the Fair Haven Town Line

No. 6 1.57 miles.

Beginning at Route Vt. 60, southeast of Poultney Village on the East Poultney Road

extending (Give direction) northerly along the East Poultney Road

ending at the intersection with State Aid Highway No. 140, Poultney Village

Mr. S. A. Seligson

MEMORANDUM *Portland Co.*

WILLIAM ROETER
COMMISSIONER OF HIGHWAYS



STATE OF VERMONT
DEPARTMENT OF HIGHWAYS
MONTPELIER
Highway Planning Division

December 19, 1961

S. N. Olson, Chairman
Board of Selectmen
Town of Poultney
Vermont

Dear Sir:

We are enclosing for your records a copy of the state aid
reselection certificate for the Town of Poultney, as approved by the
Commissioner of Highways on December 15, 1961.

This is in connection with the 10-Year Reselection of State-Aid
Highways. There has been no change in mileage.

Very truly yours,

H. F. Farrington
Highway Planning Engineer

HFF/UNT/sem
Enc.

H. F. Farrington
Highway Planning Engineer

HFF/HL/sem
Enc.

Very truly yours,

H. F. Farrington
Highway Planning Engineer

HFF/HL/sem
Enc.

... as mentioned in a previous letter you still need two copies
... for the mileage shown as added to these highways.

HIGHWAY DEPARTMENT

OFFICE MEMORANDUM

TO: N.D. Emerson
FROM: V.N. Therrien
DATE: 12-1-61
SUBJECT:

Please note that there is a 0.014 mile change necessary on SA-2 in Poultney Village. Would you like to talk to Durkee about permission to change the figures? Our route logs carry the mileage of 0.174 for the S.A.C.L. on the Wells-Poultney St. Highway in the Village of Poultney.

Hest says to change this 12-5-61
WDE

HD-296 20M-2-59

of Highway, ~~unassigned map is for your use.~~

Also enclosed is a copy of the selection certificate for the town's records, signed by the Secretary of State.

For your information, we are enclosing a copy of the letter transmitted to the Town Clerk.

In addition to the letter with Enc. 1, Title 19, P.S., for which routing was made showing the highways which are added under the Highway Planning Engineer in the office of the Secretary of State. In the Highway Planning Engineer's office, when such work is filed, the maintenance of such highways shall be deemed to have taken place.

HFF:HL/ep
Encs.

As soon as the selection certificate is signed, they will be forwarded to you for your records, but in the meantime it is necessary that we accomplish these changes.

HFF:HL/ep
Enc.

changes in our report to the State Auditor.

However, as we mentioned on a previous letter we still need the certificates of completion for the other mileage shown as added to Town Highways.

file - s. a. selections

STATE HIGHWAY BOARD

CLEON A. PERKINS, CHAIRMAN
RUTLAND
PORTER J. MOORE
NEWPORT
FRANK E. HOWE, II
BENNINGTON

STATE OF VERMONT



COMMISSIONER OF HIGHWAYS
WILLIAM FOETER
CHIEF ENGINEER
ARTHUR D. BISHOP
ASSISTANTS TO THE COMMISSIONER
E. BEACH BLY
WINONA D'A. SHERIDAN

DEPARTMENT OF HIGHWAYS
MONTPELIER
Highway Planning Division

May 8, 1961

John A. Deshee
District Highway Engineer
Rutland, Vermont

Dear Sir:

We are enclosing for your records a copy of the selection of state-aid highways in Poultney, and the accompanying map approved by the Commissioner of Highways, indicating the reselection of state-aid highways. The extra unsigned map is for your use.

Also enclosed is a copy of the selection certificate for the town's records.

For your information, we are enclosing a copy of the letter of transmittal to the Town Clerk.

Yours truly,

H. F. Farrington
Highway Planning Engineer

HFF:HL/ew
Encs:

When the map has been filed, could you please fill out and sign both the enclosed forms, and return to this office. We will also file a copy of the Clerk of the town wherein said highways are located to have taken place.

Very truly yours,

H. F. Farrington
Highway Planning Engineer

HFF:HL:ewp

Encs.

WILLIAM POETER
COMMISSIONER OF HIGHWAYS



STATE OF VERMONT
DEPARTMENT OF HIGHWAYS
Highway Planning Division

May 3, 1961

Mr. Charles L. Foster
Town Clerk
Roslindale, Vermont

Dear Sir:

We are enclosing for your records a map signed by the Commissioner, showing the selection of State-Aid Highways in your town. Also enclosed is an extra copy of the revised map for your use.

The map signed by the Commissioner should be filed and recorded in your town records.

This is in accordance with Sec. 13, Title 19, V.S.A., which requires that, "When an addition or deletion is made to State-Aid Highways, the Board shall make maps showing the highways which are added and/or deleted, and file a copy thereof in the office of the Secretary of State. It shall also file a copy of the map of such highways in the office of the Clerk of the town wherein said highways be. When such maps are so filed, the redesignation of such highways shall be deemed to have taken place."

When the map has been filed, would you please fill out and sign both the enclosed forms, and return to this office.

Very truly yours,

H. F. Farrington
Highway Planning Engineer

HFF:HL:enp

Enc.

Form 1000

Rutland
March 27, 1961

OFFICE OF THE
COMMISSIONER

Without these certificates the 0.35 mile cannot be accepted.
May we have this information April 1st?



STATE OF VERMONT
DEPARTMENT OF HIGHWAYS
MONTPELIER
Highway Planning Division

W. F. Harrington
Highway Planning
March 27, 1961

Mr. Charles L. Parker
Town Clerk
Poultney, Vermont

Dear Sir:

This is to inform you that the reselection of State Aid Highways, in the Town of Poultney, has been approved by the Highway Board on March 24, 1961.

As we have already received your mileage certificates we shall make the necessary changes on these copies if you will make the following changes on the yellow copy in your records.

Under State Aid Highways, opposite "Highways Added", please enter 0.35 mile, and opposite "Highways Subtracted", please enter 0.31 mile. This last 0.31 mile is already shown under Town Highways as mileage added.

As soon as the selection certificates and maps can be processed, they will be forwarded to you for your records, but in the meantime it is necessary that we accomplish these changes so we may include the revised mileage in our report to the State Auditor.

However, as we mentioned on a previous letter we still need two certificates of completion for the other mileage shown as added to Town Highways.

March 29, 1951

and without these certificates the other 0.30 mile cannot be accepted.

May we have this information before April 3rd?

Very truly yours,

H. F. Farrington
Highway Planning Engineer

HFF/VNT/sem

The proposed highway schedule to give 14-15 Highway Schedule

There are two additional items that must be substantiated by
certificates of completion and opening to public travel before we can
accept the mileage. Such a certificate should contain a description
of the highway as well as the date of laying-out and recording in last
state records.

To also refer me to the proposed alignment of the proposed highway
and the road connecting old and new state routes. I will be glad
to receive a suggested form of the certificate, or you may wish
to type one up, as you wish.

The certificate, for the mileage to be given the highway,
will be given to you by the state highway and you will be required
to file the same in the records, we would appreciate your

OFFICE OF THE
COMMISSIONER



STATE OF VERMONT
DEPARTMENT OF HIGHWAYS
MONTPELIER
Highway Planning Division

March 24, 1961

Mr. Charles T. Parker
Town Clerk
Poultney, Vermont

Dear Sir:

Thank you for the prompt submission of your 1961 Highway Mileage Certificates.

However, there are two additions that must be substantiated by Certificates of Completion and Opening to Public Travel before we can accept the mileage. Such a certificate should contain a description of the highway as well as the date of laying-out and recording in the Town Records.

We are referring to the proposed addition of Stonehedge Cottage Road and the road connecting old and new State Aid No. 5, and we are enclosing a "suggested" form of the necessary certificate which you may copy or not, as you wish.

The selection certificate, for the change in State Aid Highways, goes before the Highway Board today and you will, of course, be notified of the results. In the meantime, we would appreciate receiving the

State Clerk

March 24, 1961

necessary substantiation, of the highways mentioned above, before April 1st, in order that we may include your revised valuations in our submission to the State Auditor.

STATE OF VERMONT
DEPARTMENT OF TRANSPORTATION
Highway Planning Division
Very truly yours,
Highway Planning Division

H. F. Farrington March 9, 1961
Highway Planning Engineer

W. Carl Roberts
State Engineer
HFF/VNT/SM
Encs.

With regard to the completion of the Highway Valuation Certification forms, we believe that there was no further need for these certifications.

We are intended to submit the charge to State Job No. 1, but were unable to do so as the valuation certification has not been returned at this time. As they have been returned to us our own auditing Highway Department. As soon as this is accomplished we shall contact a copy to you and a change adjustment can be made later. This should be done with the work of March 15th to 1961.

We do understand, however, that the data which is used to check have shown the following two highways:

Route 100	5.30 miles
Route 101	2.40 miles
Total	7.70 miles

Received
March 9, 1961

OFFICE OF THE
COMMISSIONER

In order that these two highways may be added, it is necessary that
be included in the list of highways to be included in State Aid No. 5, and that
have been approved by the Highway Planning Division.



STATE OF VERMONT
DEPARTMENT OF HIGHWAYS
MONTPELIER
Highway Planning Division

March 9, 1961

Mr. Earl Hubbard
Town Manager
Southway, Vermont

H. P. Worthington
Highway Planning Engineer

Dear Mr. Hubbard:

With regard to the completion of the Highway Mileage Certificates
recently sent to the selectmen, we believe that there was no letter sent
with these certificates.

We had intended to mention the change on State Aid No. 5, but were
unable to do so as the selection certificates had not been returned at
that time. Now they have been returned to us and are awaiting Highway
Board approval. As soon as this is accomplished we shall return a copy
to you and a mileage adjustment can be made then. This should be done
tine the week of March 13th to 15th.

We do understand, however, that the town wishes to add to their
town mileage the following two highways:

Stanchings Cottage Road	0.19 mile
Road connecting old and new State Aid No. 5	0.10 mile
Total	0.29 mile

Team Manager

March 9, 1961

In order that these two highways may be added, it is necessary that we receive Certificates of Completion and Opening to Public Travel, and we have enclosed a suggested form of this certificate for your convenience.

Would you please note any other change that may have occurred on Team Highways during the past year.

Very truly yours,

H. F. Farrington
Highway Planning Engineer

HFF/VWT/ab
Enc. 2

The Highway Planning Engineer, Washington, D.C., is pleased to advise you that your request for the addition of the Highway Planning Engineer's services to your project has been approved. We believe that your use of our services will be most beneficial to your project.

The Highway Planning Engineer's services are provided to you on a contract basis. The contract is for a period of one year, beginning on the date of the signing of this letter and ending on the same date next year. The contract is for a fixed fee of \$10,000.00 per year. The contract is subject to the terms and conditions set forth in the attached contract form. The contract is subject to the approval of the Highway Planning Engineer's Board of Directors. The contract is subject to the approval of the Highway Planning Engineer's Board of Directors.

The Highway Planning Engineer's services are provided to you on a contract basis. The contract is for a period of one year, beginning on the date of the signing of this letter and ending on the same date next year. The contract is for a fixed fee of \$10,000.00 per year. The contract is subject to the terms and conditions set forth in the attached contract form. The contract is subject to the approval of the Highway Planning Engineer's Board of Directors. The contract is subject to the approval of the Highway Planning Engineer's Board of Directors.

Rutland
March 9, 1961

OFFICE OF THE
COMMISSIONER

In order that these two highways may be added, it is necessary that
the Highway Certificates of Design and Opening to Public Travel, and we
have enclosed a suggested form of certificate for your consideration.



STATE OF VERMONT
DEPARTMENT OF HIGHWAYS
MONTPELIER
Highway Planning Division

March 9, 1961

Mr. Karl Hubbard
Town Manager
Routley, Vermont

W. F. Newington
Highway Planning Engineer

Dear Mr. Hubbard:

With regard to the completion of the Highway Mileage Certificates
recently sent to the selectmen, we believe that there was no letter sent
with these certificates.

We had intended to mention the change on State Aid No. 5, but were
unable to do so as the selection certificates had not been returned at
that time. Now they have been returned to us and are awaiting Highway
Board approval. As soon as this is accomplished we shall return a copy
to you and a mileage adjustment can be made then. This should be com-
pleted the week of March 13th to 15th.

We do understand, however, that the town wishes to add to their
town mileage the following two highways:

Stanhope Cottage Road	0.19 mile
Road connecting old and new	
State Aid No. 5	0.10 mile
Total	0.29 mile

March 9, 1941

HN

In order that these two highways may be added, it is necessary that we receive Certificates of Completion and Opening to Public Travel, and we have enclosed a suggested form of this certificate for your convenience.

Would you please note any other change that may have occurred on Town Highways during the past year.

Very truly yours,

H. F. Farrington
Highway Planning Engineer

HFF/VMT/ea
Enc. 2

... ..

...

... ..

... ..

...

... ..

... ..

... ..

ending at

the Fair Haven Town Line.

HIGHWAY DEPARTMENT

OFFICE MEMORANDUM

TO: Highway Board
FROM: H. F. Farrington, Highway Planning Engineer
DATE: March 9, 1961
SUBJECT:

H.F. Farrington/vnt

The attached selection certificates, for Rutland City and the Town of Poultney, were inadvertently processed as remeasurement only, but also include reselection of State Aid Highways.

HFF/VNT/jrf

HD-298 20M-12-60

ending at ~~the Middlesex Springs town line; it being all State Aid Numbered Route 140.~~

No. 3 ~~0.23~~ miles.

Beginning at ~~the northwest Railway Village line on York Street~~

extending (Give direction) ~~northwesterly~~

ending at ~~the New York State Line in the Railway River.~~

No. 4 ~~0.26~~ miles.

Beginning at ~~the New York State Line on Granville Street~~

extending (Give direction) ~~northwesterly~~

ending at ~~the Railway south village line.~~

No. 5 ~~3.27~~ miles.

Beginning at ~~York Street on the Fair Haven road near the northwest Railway Village line.~~

extending (Give direction) ~~northwesterly and northwesterly toward Fair Haven~~

ending at ~~the Fair Haven Town Line.~~

file - S. A. Selections
LECTION OF STATE AID HIGHWAY

DESCRIPTION AND RELATIONS (S. A. 9)

Town of Roseton
 County of Putnam
 Vt. Hwy. Dist. No. 2
 Total S. A. Mileage 11.206

Important town highways as required by Title 19, V. S. A., Sections 1 & 13:

No. 1 2.604 miles.

Beginning at the end of State Highway on the Wells-Roseton State Highway
 extending (Give direction) westerly toward Roseton Village

ending at the Roseton Village line is being part of the State Aid Connecting Link for Wells-Roseton State Highway.

No. 2 4.74 miles.

Beginning at the Roseton north village line on Main Street

extending (Give direction) westerly through East Roseton and westerly toward Wallbridge

ending at the Wallbridge Springs road line is being all State Aid Extended Route 248.

No. 3 0.25 miles.

Beginning at the northern Roseton Village line on Main Street

extending (Give direction) westerly

ending at the New York State line in the Roseton River.

No. 4 0.26 miles.

Beginning at the New York State line on Cassville Street

extending (Give direction) westerly

ending at the Roseton north village line.

No. 5 1.37 miles.

Beginning at Main Street on the Fair Haven road near the northern Roseton Village line.

extending (Give direction) westerly and northwesterly toward Fair Haven

ending at the Fair Haven Town line.

No. 6 1.37 miles.

Beginning at Route 78 39 northern of Roseton Village on the East Roseton Road

extending (Give direction) westerly along the East Roseton Road

ending at State Aid Highway No. 2 in East Roseton.

STATE HIGHWAY BOARD

CLEON A. PERKINS, CHAIRMAN
RUTLAND
FRANK E. HOWE, II
BENNINGTON

STATE OF VERMONT



DEPARTMENT OF HIGHWAYS
MONTPELIER

Highway Planning Division

Poultney

COMMISSIONER OF HIGHWAYS
WILLIAM PORTER
CHIEF ENGINEER
HUBERT E. SARGENT
ASSISTANTS TO THE COMMISSIONER
E. BEACH BLY
WINONA D'A. SHERIDAN

February 23, 1960

Board of Selectmen
Poultney, Vermont

Attention of Chairman

Gentlemen:

With regard to the completion of the enclosed Road Mileage Certificates, we wish to call your attention to a change in Town Highway mileage in your town.

On October 20, 1959, Mr. East, Selectman of Wells, Willis Scott, District #3 Patrolman, with Mr. Cookson of this office, investigated a discrepancy in the measurement of Town Highways to the Wells - Poultney Town Line. This investigation was confirmed by Mr. Hubbard, Poultney Town Manager, who had been unable to accompany the others.

As a result of this investigation, the mileage on Town Highway Number 39, in Poultney, would be increased by 0.20 mile.

Would you please enter the addition of 0.20 mile as new highways on the enclosed certificates, as well as noting any other change that may have occurred on your Town Highways during the past year.

Very truly yours,

H. F. Farrington
Highway Planning Engineer

HFF/vmr/jh

Encs.

August 20, 1957

Robert H. Lamb, Chairman
Board of Trustees
Village of Poughkeepsie
Poughkeepsie

Dear Sirs:

We are enclosing for your records a copy of the selection of State Aid Highways in the Village of Poughkeepsie as approved by the Commissioner of Highways on July 8th, 1957.

This is in connection with mileage adjustments only.

Very truly yours,

H. E. Sargent
Chief Engineer

HES:HYF:HL
cc: John A. Durkee

SELECTION OF STATE AID HIGHWAYS

Town of POULTNEY

County of RUTLAND

Written on No. 11-338

Date of Mileage 11-338

... Sections 20, 21, 22, 23, 24, 25, 26, 27, 28, 29, 30, 31, 32, 33, 34, 35, 36, 37, 38, 39, 40, 41, 42, 43, 44, 45, 46, 47, 48, 49, 50, 51, 52, 53, 54, 55, 56, 57, 58, 59, 60, 61, 62, 63, 64, 65, 66, 67, 68, 69, 70, 71, 72, 73, 74, 75, 76, 77, 78, 79, 80, 81, 82, 83, 84, 85, 86, 87, 88, 89, 90, 91, 92, 93, 94, 95, 96, 97, 98, 99, 100

August 20, 1957

Fred H. Graves, Chairman
Board of Selectmen
Town of Poultney
Vermont

Dear Sir:

We are enclosing for your records a copy of the selection of State Aid Highways in the Town of Poultney as approved by the Commissioner of Highways on July 6th, 1957.

Very truly yours,

H. E. Sargent
Chief Engineer

NSC:RFF:hl
cc: John A. Burkse

... approximately ...
... just northwest of Poultney Village
... Highway No. 6 and northwesterly
over ...
Fair Haven town line.

SELECTION OF STATE AID HIGHWAYS

Town of PoultneyCounty of RutlandVt. Hwy. Dist. No. 3Total S. A. Mileage 11.232

Important town highways as required by Sections 4903, 4918 and 4921 of the Vermont Statutes, Revision of 1947:

No. 1 0.23 miles.Beginning at Poultney northwest village lineextending (Give direction) northwesterlyending at Hampton, New York state lineNo. 2 4.74 miles.Beginning at Poultney east village lineextending (Give direction) easterly thru East Poultney, then southeasterly along
Poultney River, being State Aid Numbered Route 140.ending at Middletown Springs town lineNo. 3 0.26 miles.Beginning at Poultney southwest village lineextending (Give direction) southwesterlyending at Hampton, New York state lineNo. 4 1.57 miles.Beginning at State Highway 30, approximately 1.18 miles south of Poultney
village line.extending (Give direction) northerlyending at State Aid Highway No. 2 in East Poultney hamlet.No. 5 3.23 miles.Beginning at State Aid Highway No. 1 just northwest of Poultney villageextending (Give direction) northerly over former Town Highway No. 6 and northwesterly
over former town highway No. 11ending at Fair Haven town line.No. 6 0.24 miles.Beginning at State highway Vt. 30 near the 1956 railroad underpass eliminationextending (Give direction) westerly over former town Highway No. 6ending at State Aid Highway No. 5

E

HIGHWAY DEPARTMENT

AC

OFFICE MEMORANDUM

TO: M. E. Sargeant, Chief Engineer

FROM: H. F. Farrington, Mgr., Highway Planning Survey

DATE: June 13, 1957

SUBJECT:

Attached herewith are letters, certificates and maps for the addition of State Aid Highway #3 in Poultney and State Aid Highway #4 in Wells to the State Highway System. The Act was signed by the Governor on May 23.

Also included is relocation of Poultney Village, necessitated by South Street becoming State Aid Connecting Link on the new Wells-Poultney State Highway.

HFF:kl

H 2-296 25M-0-58

To The Selectmen and Town Clerk
Town of Poultney
Vermont

Gentlemen:

In accordance with Chapter 234, Section 4956 of the Vermont Statutes, Revision of 1947, as amended by No. 193 of the Acts of 1957, the State Highway Board does hereby take over as a state highway the following state aid highway in the Town of Poultney.

State Aid Highway No. 3 in Poultney, from the Wells town line extending northerly and ending at the end of state highway 2,133 feet or 0.404 miles south of the north end of Poultney River Bridge, which is the village line. The total distance taken over being 3.201 miles.

And as provided by Section 4959 of said statutes, a map showing this highway has been filed by the State Highway Board and the attached copy of the map is hereby delivered to the Town of Poultney for filing and recording.

Certified and signed at Montpelier this _____ day of _____
1957.

STATE HIGHWAY BOARD

By: Commissioner of Highways

Received:	Date _____	Time _____
Recorded:	Page No. _____	Volume No. _____
Records of the Town of _____		

41
HV
H
H
H

CERTIFICATE

OF MEMORANDUM

MONTEPELIER DEPARTMENT

W. E. Sargent, Chief Engineer

FROM: W. E. Sargent, Chief Engineer

DATE: March 9, 1957

SUBJECT: Reservation in Poultney & Fair Haven

Attached is a resolution from the town of Poultney as last requested by the selectmen. See attached map.

A resolution for the connecting highway in Fair Haven is also attached.

A second map corresponding is also attached. June 5, 1957. Substantive for the selection of this highway is for the purpose of the State Highway Board. To the Selectmen and Town Clerk of Poultney Vermont. Section 22A so that they do not leave New York State.

Gentlemen

In accordance with Chapter 234, Section 1956 of the Vermont Statutes, Revision of 1947, as amended by No. 193 of the Acts of 1957, the State Highway Board does hereby take over as a state highway the following state aid highway in the Town of Poultney.

State Aid Highway No. 3 in Poultney, from the Wallis town line extending northerly and ending at the end of state highway 2, 231 feet or 0.404 miles south of the north end of Poultney River Bridge, which is the village line. The total distance taken over being 1.201 miles.

And as provided by Section 1959 of said statutes, a map showing this highway has been filed by the State Highway Board and the attached copy of the map is hereby delivered to the Town of Poultney for filing and recording.

Certified and signed at Montpelier this _____ day of _____ 1957.

STATE HIGHWAY BOARD

By: Commissioner of Highways

Received: Date _____ Time _____

Recorded: Page No. _____ Volume No. _____

Records of the Town of

POULTNEY (signed)

Town Clerk

HIGHWAY DEPARTMENT

OFFICE MEMORANDUM

TO: H. E. Sargent, Chief Engineer
 FROM: H. F. Farrington, Mgr., Highway Planning
 DATE: March 9, 1955
 SUBJECT: Reselection in Poultney & Fair Haven

Attached is a reselection from the town of Poultney as last requested by the selectmen. See attached map.

A reselection for the connecting highway in Fair Haven is also attached.

A voluminous correspondence is also attached. The substantiating reason for the selection of this highway is for the purpose of hauling materials on to Route 22A so that they do not have to obtain a license to haul thru New York State.

HFF:pm
 Attachments

HD 208 28M-8-54

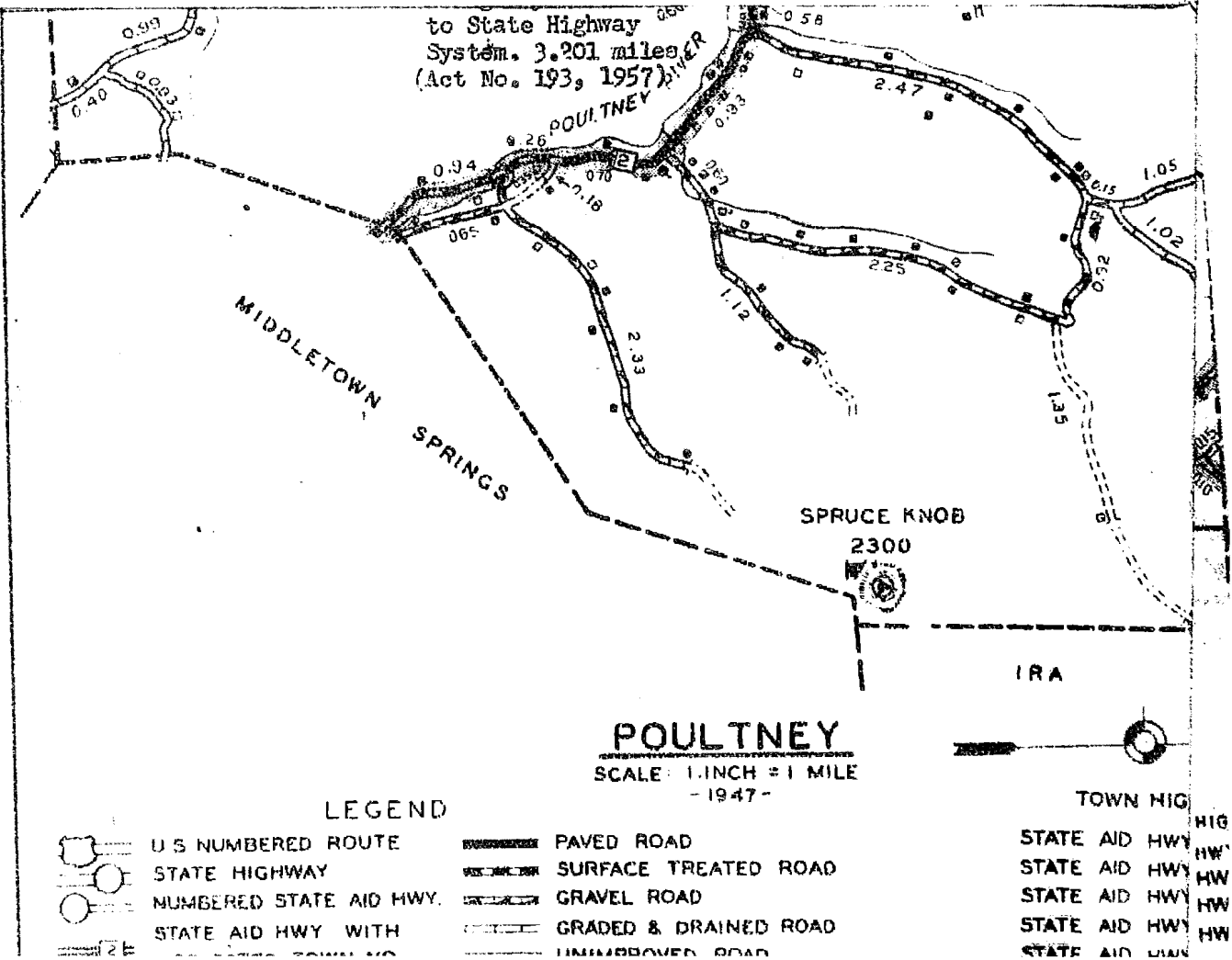

it in triplicate and file with your ~~Town~~ Clerk on or before February 10, 1969

(Note sections of Vermont Statutes Annotated on reverse side of this map)

Trustees Village
the

1000'

and

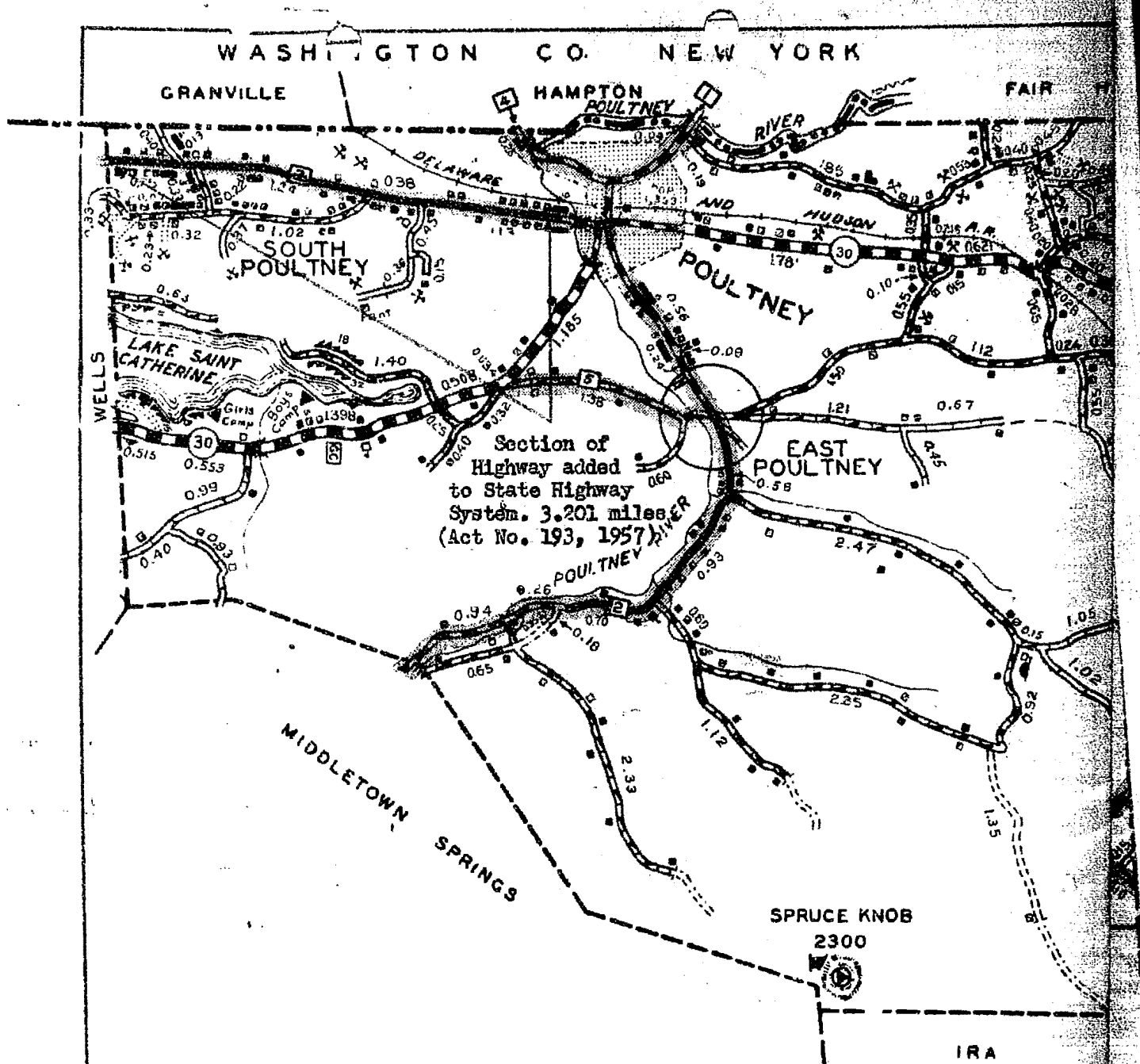

Section of Highway added to State Highway System. 3.201 miles (Act No. 193, 1957)

POULTNEY
SCALE: 1 INCH = 1 MILE
- 1947 -



LEGEND

- | | | | | | | | |
|--|---------------------------------------|--|-----------------------|--|---------------|--|---------|
| | U.S. NUMBERED ROUTE | | PAVED ROAD | | STATE AID HWY | | HIGHWAY |
| | STATE HIGHWAY | | SURFACE TREATED ROAD | | STATE AID HWY | | HWY. |
| | NUMBERED STATE AID HWY. | | GRAVEL ROAD | | STATE AID HWY | | HWY. |
| | STATE AID HWY. WITH SELECTED TOWN NO. | | GRADED & DRAINED ROAD | | STATE AID HWY | | HWY. |
| | FEDERAL AID HIGHWAY | | UNIMPROVED ROAD | | STATE AID HWY | | HWY. |
| | TOWN HIGHWAY | | PRIMITIVE ROAD | | STATE AID HWY | | HWY. |
| | | | UNTRAVELED ROAD | | | | |

TOWN HIGHWAY

- STATE AID HWY
- STATE AID HWY
- STATE AID HWY
- STATE AID HWY
- STATE AID HWY

WASHINGTON CO. NEW YORK

GRANVILLE

HAMPTON POULTNEY

FAIR HAVEN

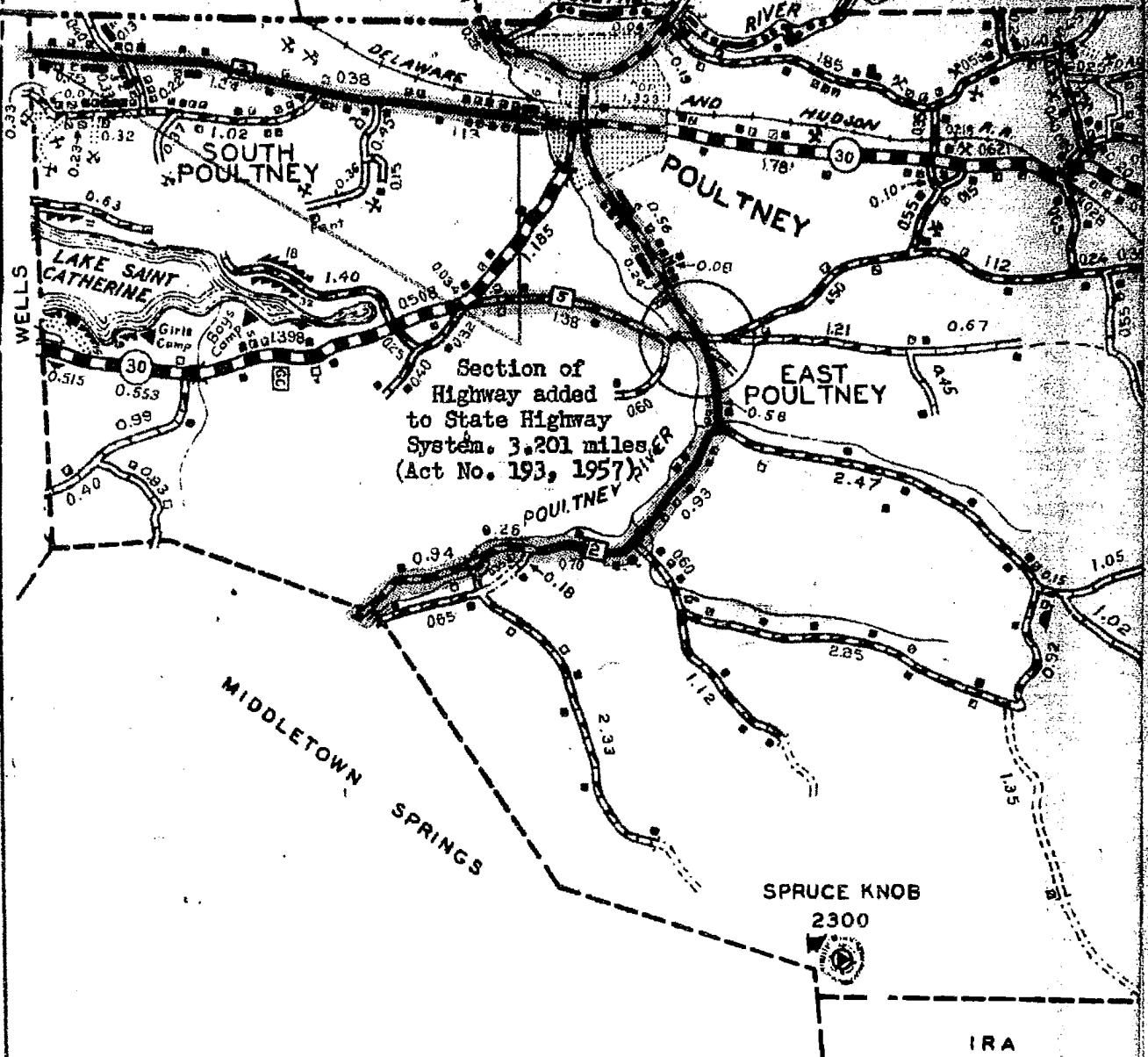

Section of Highway added to State Highway System, 3.201 miles (Act No. 193, 1957)

POULTNEY

SCALE: 1 INCH = 1 MILE
- 1947 -

LEGEND

- | | | | | | |
|--|---|--|-----------------------|--|---------------|
| | U.S. NUMBERED ROUTE | | PAVED ROAD | | STATE AID HWY |
| | STATE HIGHWAY | | SURFACE TREATED ROAD | | STATE AID HWY |
| | NUMBERED STATE AID HWY. | | GRAVEL ROAD | | STATE AID HWY |
| | STATE AID HWY. WITH SELECTED TOWN NO. | | GRADED & DRAINED ROAD | | STATE AID HWY |
| | FEDERAL AID HIGHWAY | | UNIMPROVED ROAD | | STATE AID HWY |
| | TOWN HIGHWAY | | PRIMITIVE ROAD | | TOTAL STA |
| | FARM UNIT | | UNTRAVELED ROAD | | STATE HIGHWAY |
| | DWELLING (OTHER THAN FARM) | | CHURCH | | STATE HIGHWAY |
| | SCHOOL | | CAMP | | STATE HIGHWAY |
| | BUSINESS | | CEMETERY | | TOTAL ST |
| | NOTE: VACANT CULTURAL FEATURES SHOWN IN OUTLINE FORM. | | TRAIL | | TOTAL ALL |
| | | | PRIVATE ROAD | | |
| | | | SUMMER HOME | | |

VERMONT HIGHWAY DISTRICT NO. 3

REVISED:	1947	1948	1949	1950	1951	1952
Rev.						

William J. ...
Chairman ...
(Write official title on Name Public)

on of Highway
to State Highway
m. 1,756 miles.
No. 193, 1957)

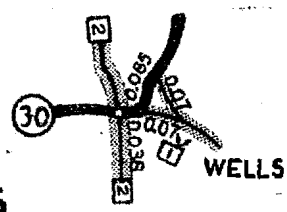
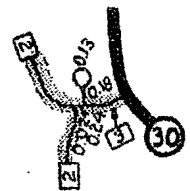
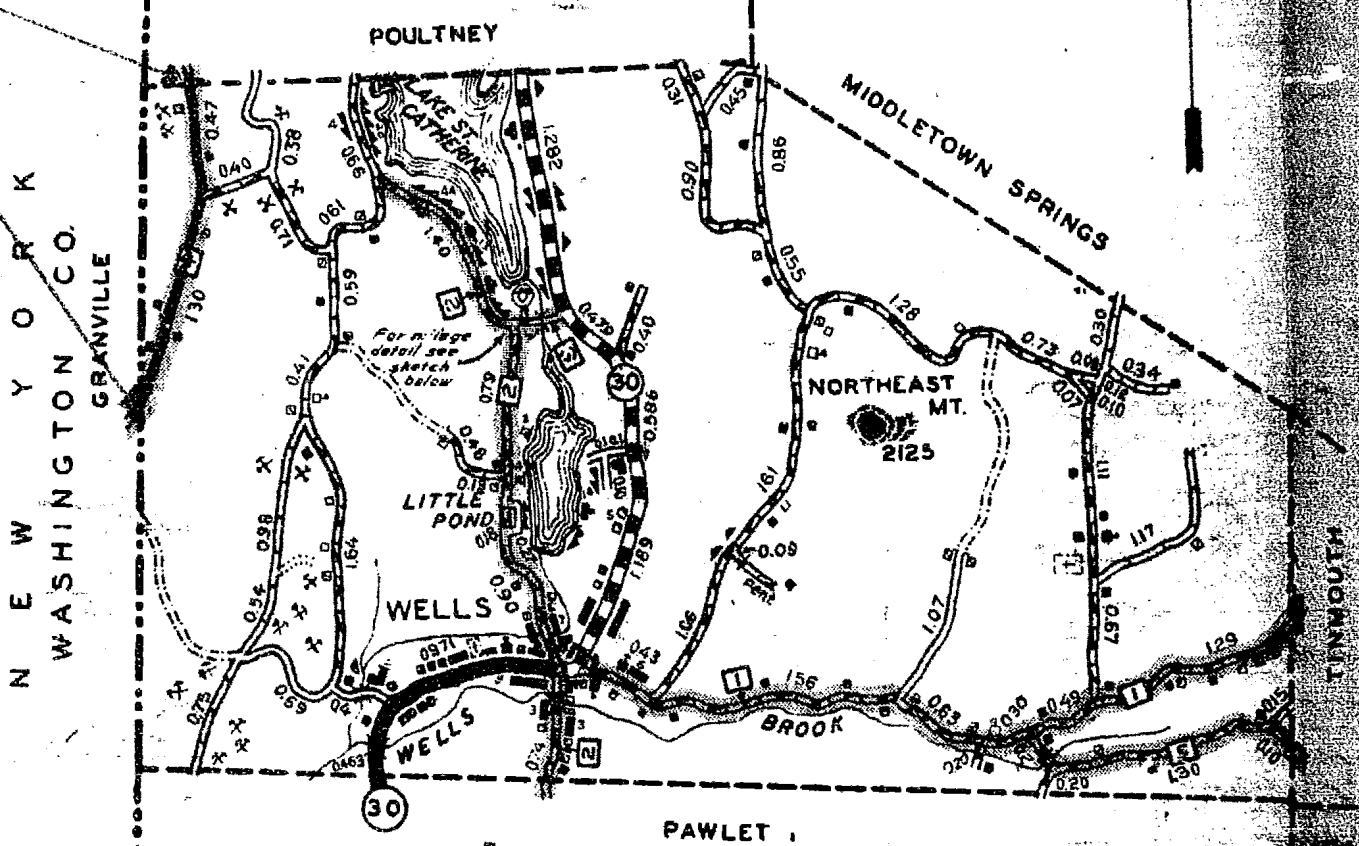

WELLS

SCALE 1 INCH = 1 MILE
-1947-

LEGEND

- | | | | |
|--|--|--|-----------------------|
| | U.S. NUMBERED ROUTE | | PAVED ROAD |
| | STATE HIGHWAY | | SURFACE TREATED ROAD |
| | NUMBERED STATE AID HWY. | | GRAVEL ROAD |
| | STATE AID HWY. WITH
SELECTED TOWN NO. | | GRADED & DRAINED ROAD |
| | FEDERAL AID HIGHWAY | | UNIMPROVED ROAD |
| | TOWN HIGHWAY | | PRIMITIVE ROAD |
| | FARM UNIT | | UNTRAVELED ROAD |
| | DWELLING (OTHER THAN FARM) | | CHURCH |
| | SCHOOL | | CAMP |
| | BUSINESS | | CEMETERY |
| | VACANT CULTURAL FEATURES | | TRAIL |
| | PRIVATE ROAD | | SUMMER HOME |
| | SHOWN IN OUTLINE FORM | | |

TOWN HIGHWAY	1947	1948	1949	1950	1951
STATE AID HWY. NO. 1	4.24	4.24	4.24	4.24	4.24
STATE AID HWY. NO. 2	2.74	2.74	2.74	2.74	2.74
STATE AID HWY. NO. 3	2.06	2.06	2.06	2.06	2.06
STATE AID HWY. NO. 4	1.27	1.27	1.27	1.27	1.27
STATE AID HWY. NO. 5	1.27	1.27	1.27	1.27	1.27
TOTAL STATE AID	11.58	11.58	11.58	11.58	11.58
STATE HIGHWAY NO. 30	2.00	2.00	2.00	2.00	2.00
STATE HIGHWAY NO.					
STATE HIGHWAY NO.					
TOTAL STATE HWY.	13.58	13.58	13.58	13.58	13.58
TOTAL ALL SYSTEMS	13.58	13.58	13.58	13.58	13.58

MEMO TO: Chief Engineer Sargent
FROM: H. F. Farrington, Mgr., Highway Planning Survey
DATE: December 30, 1954

Attached is a reselection in the Town of Poultney received from John Durkee, with a map showing the revised State Aid mileages.

The following comments are offered for what they may be worth:

It will be noted that road #6 from Poultney north which they wish to select, is running parallel to and is in close proximity to Vermont 30. Our latest traffic count on this road is 60 vehicles per day as per 1950. This is the only count we have available at the present time. This road is being selected for the purpose of hauling materials to Route 22A in Fairhaven, and it is suggested that Route 30 might be used as far north as T.R.-33, then via 33 and 6 and 11 to Fairhaven. This would also provide a detour around the underpass, which apparently can be programmed for 1955-1956, and this would thus eliminate the need for a bypass. It will be noted that all their State Aid roads are hard-surfaced, and it appears as though this maneuver is an attempt to get another road on which to spend money for hardsurface. It should also be noted that Mr. Durkee did not include a reselection for the Town of Fairhaven, thus leaving a dead-end State Aid road at the Town Line, a condition which we have been attempting to eliminate for the past ten years. Incidentally, road #6 is a school bus route and also an R.F.D. route.

HFF:bbg

Attach.

Before me,

William B. Hedges
Town Clerk

CERTIFICATE OF HIGHWAY MILEAGE

FOR YEAR ENDING FEBRUARY 10, 1969

Village

Fill out in triplicate and file with your ~~Town~~ Clerk on or before February 10, 1969.

(Note sections of Vermont Statutes Annotated on reverse side of this sheet)

We, the ~~Selectmen~~ Trustees of the Village of Poultney, on oath state that we have carefully measured all the traveled highways in this town and find that the total mileage of traveled highways according to Title 19, V.S.A., Sec. 15, amended 1961, Act No. 28, not including pent roads and trails, in this town for the year ending February 10, 1969, is as follows:

	MILEAGE IN TOWN (Outside of villages incorporated for highways)			MILEAGE IN VILLAGE (Incorporated for highways)			Total All Systems
	POULTNEY						
	Town Highways	State Aid Highways	State Highways	Town Highways	State Aid Highways	State Highways	
PREVIOUS MILEAGE as shown March 15, 1968				2.61	2.766	—	5.376
HIGHWAYS ADDED Since March 15, 1968, ac- cording to statute. Explain under paragraph 1 below.							
SUB-TOTAL							
HIGHWAYS SUBTRACTED Since March 15, 1968. Those becoming untraveled, discon- tinued, legal trails or pent roads. Explain under para- graphs 2 and 3 below.							
TOTAL TRAVELED HIGHWAYS Feb. 10, 1969.							

1. We hereby certify that the following new highways, as substantiated by the attached "Selectmen's Certificate of Completion", have been added since March 15, 1968:

2. We hereby certify that the following highways have been discontinued, or changed to trails or pent roads according to statute, since March 15, 1968, as substantiated by the attached copy of the proceedings:

3. We hereby certify that the following roads have become untraveled since March 15, 1968:

TRUSTEES
SELECTMEN:

Russell Williams Jr.
Ralph E. Currier
Joseph B. Bunn

At Poultney
the 9th day of Jan.

in the county of Windsor
1969 personally appeared above Trustees

Trustees Village of Poultney
and made oath to the truth of the foregoing affidavit by them subscribed.

Before me,

Lucille B. Hodley
Town Clerk, Poultney
(Write official title, as Notary Public)

(Town Clerk should fill out following and mail one white and one yellow copy to the Commissioner of Highways, Montpelier, Vermont, on or before March 15th.)

I, Lucille B. Hodley, Notary Public
hereby certify that the foregoing is a true copy of record of the certificate of the Trustees of Poultney
relating to highway mileage, filed and recorded at this office Jan. 9, 1969, 1969

Attest: Lucille B. Hodley
Notary Public

CERTIFICATE OF HIGHWAY MILEAGE

FOR YEAR ENDING FEBRUARY 10, 1968

Fill out in triplicate and file with your ^{Village} ~~Town~~ Clerk on or before February 10, 1968

(Note sections of Vermont Statutes Annotated on reverse side of this sheet)

We, the ~~Selectmen~~ ^{Trustees} of the ~~Town~~ ^{Village} of Poultney, on oath state that we have carefully measured all the traveled highways in this town and find that the total mileage of traveled highways according to Title 19, V.S.A. Sec. 16, amended 1961, Act No. 28, not including pent roads and trails, in this town for the year ending February 10, 1968, is as follows:

	MILEAGE IN TOWN (Outside of villages Incorporated for highways)			MILEAGE IN VILLAGE (Incorporated for highways)			Total All Systems
	POULTNEY						
	Town Highways	State Aid Highways	State Highways	Town Highways	State Aid Highways	State Highways	
PREVIOUS MILEAGE as shown March 15, 1967				2.61	2.766	---	5.376
HIGHWAYS ADDED Since March 15, 1967, ac- cording to statute. Explain under paragraph 1 below.							
SUB-TOTAL							
HIGHWAYS SUBTRACTED Since March 15, 1967. Those becoming untraveled, (discon- tinued, legal trails or pent roads. Explain under para- graphs 2 and 3 below.							
TOTAL TRAVELED HIGHWAYS Feb. 10, 1968.							

1. We hereby certify that the following new highways, as substantiated by the attached "Selectmen's Certificate of Completion", have been added since March 15, 1967:

2. We hereby certify that the following highways have been discontinued, or changed to trails or pent roads according to statute, since March 15, 1967, as substantiated by the attached copy of the proceedings:

3. We hereby certify that the following roads have become untraveled since March 15, 1967:

**TRUSTEES
SELECTMEN**

Russell J. Williams Jr.
Ralph E. Colson
M. J. Johnson
Nayden A. Hadley

At Poultney in the county of Southwest
the 8th day of February, 1968 personally appeared *Russell J. Williams Jr.*
Ralph E. Colson, *M. J. Johnson*, *Nayden A. Hadley*
Trustees of Poultney
and made oath to the truth of the foregoing affidavit by them subscribed.

Before me,

Russell A. Hadley
Notary Public
(With Seal Here or Notary Public)

(Town Clerk should fill out following and mail one white and one yellow copy to the Commissioner of Highways, Montpelier, Vermont, on or before March 15th.)

Christina B. Hadley, Clerk of the Town of Poultney
herby certify that the foregoing is a true copy of record of the certificate of the selectmen of Poultney
relating to highway mileage, filed and recorded at this office.

CERTIFICATE OF HIGHWAY MILEAGE

FOR YEAR ENDING FEBRUARY 10, 1967

Fill out in triplicate and file with your ^{Village} ~~Town~~ Clerk on or before February 10, 1967

(Note sections of Vermont Statutes Annotated on reverse side of this sheet)

We, the ^{Trustees} ~~Selectmen~~ of the ^{Village} ~~Town~~ of Poultney, on oath state that we have carefully measured all the traveled highways in this town and find that the total mileage of traveled highways according to Title 18, V.S.A. Sec. 15, amended 1961, Act No. 28, not including pent roads and trails, in this town for the year ending February 10, 1967, is as follows:

	MILEAGE IN TOWN (Outside of villages incorporated for highways)			MILEAGE IN VILLAGE (Incorporated for highways)			Total All Villages
	FOULTNEY VILLAGE						
	Town Highways	State Aid Highways	State Highways	Town Highways	State Aid Highways	State Highways	
PREVIOUS MILEAGE as shown March 15, 1966				2.61	2.766	--	5.376
HIGHWAYS ADDED Since March 15, 1966, ac- cording to statute. Explain under paragraph 1 below.							
SUB-TOTAL							
HIGHWAYS SUBTRACTED Since March 15, 1966. Those becoming untraveled, discon- tinued, legal trails or pent roads. Explain under para- graphs 2 and 3 below.							
TOTAL TRAVELED HIGHWAYS Feb. 10, 1967				2.61	2.766	-	5.376

1. We hereby certify that the following new highways, as substantiated by the attached "Selectmen's Certificate of Completion", have been added since March 15, 1966:

2. We hereby certify that the following highways have been discontinued, or changed to trails or pent roads according to statute, since March 15, 1966, as substantiated by the attached copy of the proceedings:

3. We hereby certify that the following roads have become untraveled since March 15, 1966:

TRUSTEES
~~SELECTMEN~~

Russell I. Williams, Jr.
Ralph C. Colvin
Francis LaBata
Clifford A. Burton

At Poultney in the county of Rutland
the 2nd day of February, 1967 personally appeared Russell I. Williams, Jr.,
Ralph C. Colvin, Francis LaBata and Clifford Burton
Trustees
of Village of Poultney
and made oath to the truth of the foregoing affidavit by them subscribed.

Before me,

Priscilla B. Hadley
Town Clerk & Notary Public
(Write official title as Notary Public)

(Town Clerk should fill out following and mail one white and one yellow copy to the Commissioner of Highways, Montpelier, Vermont, on or before March 15th.)

I, Priscilla B. Hadley, Town Clerk of the Town of Poultney,
hereby certify that the foregoing is a true copy of record of the certificate of the Trustees of Village of Poultney
relating to highway mileage, filed and recorded at this office on February 22nd, 1967.

Attest *Priscilla B. Hadley*
Town Clerk

CERTIFICATE OF HIGHWAY MILEAGE

FOR YEAR ENDING FEBRUARY 10, 1966

Fill out in triplicate and file with your ^{Village} ~~Town~~ Clerk on or before February 10, 1966

(Note sections of Vermont Statutes Annotated on reverse side of this sheet)

We, the ^{Trustees} ~~Members~~ of the ^{Village} ~~Town~~ of Poultney, on oath state that we have carefully measured all the traveled highways in this town and find that the total mileage of traveled highways according to Title 19, V.S.A. Sec. 15, amended 1961, Act No. 28, not including pent roads and trails, in this town for the year ending February 10, 1966, is as follows:

	MILEAGE IN TOWN (Outside of villages incorporated for highways)			MILEAGE IN VILLAGE (Incorporated for highways)			Total All Systems
	POULTNEY VILLAGE						
	Town Highways	State Aid Highways	State Highways	Town Highways	State Aid Highways	State Highways	
PREVIOUS MILEAGE as shown March 15, 1965				2.61	2.766	--	5.376
HIGHWAYS ADDED Since March 15, 1965, ac- cording to statute. Explain under paragraph 1 below.							
SUB-TOTAL							
HIGHWAYS SUBTRACTED Since March 15, 1965. Those becoming untraveled, discon- tinued, legal trails or pent roads. Explain under para- graphs 2 and 3 below.							
TOTAL TRAVELED HIGHWAYS Feb. 10, 1966							

1. We hereby certify that the following new highways, as substantiated by the attached "Selectmen's Certificate of Completion", have been added since March 15, 1965:

2. We hereby certify that the following highways have been discontinued, or changed to trails or pent roads according to statute, since March 15, 1965, as substantiated by the attached copy of the proceedings:

3. We hereby certify that the following roads have become untraveled since March 15, 1965:

TRUSTEES
SELECTMEN:

Russell I. Williams, Jr.
Ralph E. Colvin
Francis LaBate
Clifford H. Burton

At Poultney in the county of Rutland
the 2nd day of March, 1966 personally appeared Russell I. Williams, Jr.
Ralph E. Colvin, Francis LaBate, Clifford H. Burton

Trustees
Selectmen of Poultney
and made oath to the truth of the foregoing affidavit by them subscribed.

Before me,
Russella B. Hadley
Notary Public
(Write official title as Notary Public)

(Town Clerk should fill out following and mail one white and one yellow copy to the Commissioner of Highways, Montpelier, Vermont, on or before March 15th.)

I, Francilla E. Hadley, Clerk of the Town of Poultney
hereby certify that the foregoing is a true copy of record of the certificate of the ~~trustees~~ ^{trustees} of Poultney
relating to highway mileage, filed and recorded at this office March 2

Attest: *Russella B. Hadley*
H.D. 301-100-9-65
Rev. 1966

CERTIFICATE OF HIGHWAY MILEAGE

FOR YEAR ENDING FEBRUARY 10, 1965

Fill out in triplicate and file with your ^{Village} ~~Town~~ Clerk on or before February 10, 1965

(Note sections of Vermont Statutes Annotated on reverse side of this sheet)

We, the ^{Trustees} ~~Board~~ of the ^{Village} ~~Town~~ of Poultney, on oath state that we have carefully measured all the traveled highways in this town and find that the total mileage of traveled highways according to Title 19, V.S.A. Sec. 15, amended 1961, Act No. 28, not including pent roads and trails, in this town for the year ending February 10, 1965, is as follows:

	MILEAGE IN TOWN (Outside of villages incorporated for highways)			MILEAGE IN VILLAGE (Incorporated for highways)			Total All Systems
	POULTNEY VILLAGE						
	Town Highways	State Aid Highways	State Highways	Town Highways	State Aid Highways	State Highways	
PREVIOUS MILEAGE as shown March 15, 1964				2.61	2.766	--	5.376
HIGHWAYS ADDED Since March 15, 1964, according to statute. Explain under paragraph 1 below.							
SUB-TOTAL							
HIGHWAYS SUBTRACTED Since March 15, 1964. Those becoming untraveled, discontinued, legal trails or pent roads. Explain under paragraphs 2 and 3 below.							
TOTAL TRAVELED HIGHWAYS Feb. 10, 1965							

1. We hereby certify that the following new highways, as substantiated by the attached "Selectmen's Certificate of Completion," have been added since March 15, 1964:

.....

2. We hereby certify that the following highways have been discontinued, or changed to trails or pent roads according to statute, since March 15, 1964, as substantiated by the attached copy of the proceedings:

.....

3. We hereby certify that the following roads have become untraveled since March 15, 1964:

.....

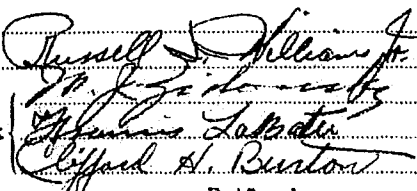
TRUSTEES

At Poultney in the county of Rutland
 the 3rd day of March, 1965 personally appeared Russell I. Williams, Jr., M. J. Zidovsky, Francis LaBate, Clifford H. Burton
 Trustees of Village of Poultney

and made oath to the truth of the foregoing affidavit by them subscribed.

Before me,

 (Write official title, as Notary Public)

(Town Clerk should fill out following and mail one white and one yellow copy to the Commissioner of Highways, Montpelier, Vermont, on or before March 15th.)

I, Lucille B. Hadley, Clerk of the Town of Poultney, hereby certify that the foregoing is a true copy of record of the certificate of the trustees of Village of Poultney relating to highway mileage, filed and recorded at this office.

Attest:

 Town Clerk

H.D. 801-400-12-41
 Rev. 1963

CERTIFICATE OF HIGHWAY MILEAGE

FOR YEAR ENDING FEBRUARY 10, 1964

Fill out in triplicate and file with your Town Clerk on or before February 10, 1964

(Note sections of Vermont Statutes Annotated on reverse side of this sheet)

We, the Trustees of the Village of Poultney, on oath state that we have carefully measured all the traveled highways in this town and find that the total mileage of traveled highways according to Title 19, V.S.A. Sec. 15, amended 1961, Act No. 28, not including pent roads and trails, in this town for the year ending February 10, 1964, is as follows:

	MILEAGE IN TOWN (Outside of villages incorporated for highways)			MILEAGE IN VILLAGE (Incorporated for highways)			Total All Systems
	POULTNEY VILLAGE						
	Town Highways	State Aid Highways	State Highways	Town Highways	State Aid Highways	State Highways	
PREVIOUS MILEAGE as shown March 15, 1963				2.61	2.766	--	5.376
HIGHWAYS ADDED Since March 15, 1963, according to statute. Explain under paragraph 1 below.							
SUB-TOTAL							
HIGHWAYS SUBTRACTED Since March 15, 1963. Those becoming untraveled, discontinued, legal trails or pent roads. Explain under paragraphs 2 and 3 below.							
TOTAL TRAVELED HIGHWAYS Feb. 10, 1964				2.61	2.766	--	5.376

1. We hereby certify that the following new highways, as substantiated by the attached "Selectmen's Certificate of Completion," have been added since March 15, 1963:

2. We hereby certify that the following highways have been discontinued, or changed to trails or pent roads according to statute, since March 15, 1963, as substantiated by the attached copy of the proceeding:

3. We hereby certify that the following roads have become untraveled since March 15, 1963:

TRUSTEES
SUBSCRIBED:

Russell I. Williams Jr.
Ralph E. Colvin
Francis Labate

At Poultney in the county of Rutland
the 10th day of March, 1964 personally appeared

Russell I. Williams Jr. Ralph Colvin Francis Labate

Trustees of Poultney and made oath to the truth of the foregoing affidavit by them subscribed.

Before me,

Priscilla B. Hadley
Notary Public
(Write official title, as Notary Public)

(Town Clerk should fill out following and mail one white and one yellow copy to the Commissioner of Highways, Montpelier, Vermont, on or before March 15th.)

I, Priscilla B. Hadley, Clerk of the Town of Poultney

hereby certify that the foregoing is a true copy of record of the certificate of the Trustees of Poultney relating to highway mileage, filed and recorded at this office March 10 1964

Attest

Priscilla B. Hadley
Town Clerk

WILLIAM PORTER
COMMISSIONER OF HIGHWAYS

Rutland



STATE OF VERMONT
DEPARTMENT OF HIGHWAYS
MONTPELIER

Highway Planning Engineer

February 1, 1962

Russel T. Williams, Jr., Chairman
Board of Trustees
Poultney Village, Vermont

Dear Sirs:

We are enclosing for your records a copy of the state aid reselction certificate for the Village of Poultney.

The reselction is in connection with the 10-Year Reselction of State Aid Highways. The 0.002 mile change is due to re-measurement.

Yours very truly,

M. F. Farrington
Highway Planning Engineer

MFP/VMT/rs
Encs.

ending at _____

No. 6 _____ miles.

Beginning at _____

extending (give direction) _____

ending at _____

WILLIAM FOSTER
COMMISSIONER OF HIGHWAYS

Russell



STATE OF VERMONT
DEPARTMENT OF HIGHWAYS
MONTPELIER

Highway Planning Division
Highway Planning Engineer

February 1, 1962

Russel L. Williams, Jr., Chairman
Board of Trustees
Poultney Village, Vermont

Dear Sir:

We are enclosing for your records a copy of the state aid reselection certificate for the Village of Poultney.

The reselection is in connection with the 10-Year Reselection of State Aid Highways. The 0.002 mile change is due to remeasurement.

Yours very truly,

H. F. Farrington
Highway Planning Engineer

HFF/VKT/am
EJSS.

WILLIAM POETER
COMMISSIONER OF HIGHWAYS

DEPARTMENT OF STATE AID HIGHWAYS



STATE OF VERMONT
DEPARTMENT OF HIGHWAYS
MONTPELIER

Highway Planning Division

February 1, 1962

J. A. Durkee
District Highway Engineer
Rutland, Vermont

Dear Sir:

We are enclosing for your records the state aid reselection certificate for the Village of Poultney.

This is in connection with Title 19, V.S.A., Sections 1 and 13.

There being no major change in mileage, the reselection certificate for the town records has been forwarded directly to the Chairman of the Board of Trustees.

Yours very truly,

H. F. Farrington
Highway Planning Engineer

HFF/VHT/ma
Encs.

SECTION OF STATE AID HIGHWAYS

Town of Poultney Village

County of Rutland

Vt. Hwy. Dist. No. 3

Total S.A. Mileage ~~2,378~~ 2,766

C O P Y

Important town highways as required by Title 19, V.S.A., Sections 1 & 13:

No. 1 0.692 miles.

Beginning at end of State Highway Vt. 30, at the south village line, at the north end of Poultney River Bridge

extending (Give direction) northerly along Bridge Street, westerly along Furnace Street and northerly along Grove and Beaman Streets (S.A.C.L.)

ending at the end of State Highway at the northerly village line.

No. 2 0.174 miles.

Beginning at South Street at the village line, at the north end of the Poultney River Bridge

extending (Give direction) northerly along South Street (S.A.C.L.)

ending at its intersection with State Aid Highway No. 1 (Route 60)

No. 3 1.340 miles.

Beginning at the northwesterly village line

extending (Give direction) southerly along College Street and easterly along Main Street and State Aid Numbered Route 140

ending at the easterly village line.

No. 4 0.560 miles.

Beginning at the southwesterly village line

extending (Give direction) northeasterly along Granville and College Streets

ending at its intersection with State Aid Highway #3, the intersection of College & Main Streets

No. 5 miles.

Beginning at

extending (Give direction)

ending at

No. 6 miles.

Beginning at

extending (Give direction)

SELECTION OF STATE AID HIGHWAYS

Village of
Town of Poultney

County of Rutland

Vt. Hwy. Dist. No. 3

Total S. A. Mileage 2.778

Important town highways as required by Sections 4903, 4918 and 4921 of the Vermont Statutes, Revision of 1947:

No. 1 0.692 miles.

Beginning at end of State Highway Vt. 30, at the south village line, at the north end of Poultney River Bridge
extending (Give direction) northerly along Bridge Street, westerly along Furnace Street and northerly along Grove and Beaman Streets.

ending at the end of state highway at the northerly village line, being the State Aid Connecting Link on Route 30.

No. 2 0.186 miles.

Beginning at South Street at the village line, at the north end of the Poultney River Bridge
extending (Give direction) northerly along South Street

ending at its intersection with State Aid Highway #1 (Route 30).

No. 3 1.34 miles.

Beginning at the northwesterly village line
extending (Give direction) southerly along College Street and easterly along Main Street and State Aid Numbered Route 140.

ending at the easterly village line.

No. 4 0.56 miles.

Beginning at southwesterly village line
extending (Give direction) northeasterly along Granville and College Streets.

ending at its intersection with State Aid Highway #3, the intersection of College and Main Streets.

No. 5 _____ miles.

Beginning at _____
extending (Give direction) _____

ending at _____

No. 6 _____ miles.

Beginning at _____
extending (Give direction) _____

No. 7 miles.

Beginning at

extending (Give direction)

ending at

No. 8 miles.

Beginning at

extending (Give direction)

ending at

No. 9 miles.

Beginning at

extending (Give direction)

ending at

We have this 10th day of July, 1957 made the above selection which is to supercede and replace any and all selections made prior to this time.

Frank Hubbard
Road Commissioner

Raymond Baker
L. Roy H. Hall
Robert Long
Fred Dennis
John B. McShane

Justus
Selectmen
of the
Village
Town of
Poultney

Approved:
July 3, 1957
W. A. Dunklee
District Engineer

July 8, 1957
STATE HIGHWAY BOARD
W.P.
Commissioner of Highway