

CERTIFICATE OF HIGHWAY MILEAGE

FOR YEAR ENDING FEBRUARY 10, 1960

Fill out in triplicate and file with your Town Clerk on or before February 10, 1960

(Date sections of Vermont Statutes Annotated on reverse side of this sheet)

We, the Selectmen of the town of Troy, do hereby state that we have carefully measured all the traveled highways in this town and find that the total mileage of traveled highways according to Title 10, V.S.A. Sec. 10, amended 1957, Act No. 10, not including post roads and trails, in this town for the year ending February 10, 1960, is as follows:

	MILEAGE IN TOWN (Outside of village incorporated for highways)			MILEAGE IN VILLAGE (Incorporated for highways)			TOTAL Mileage
	TROY						
	Town Highways	State Aid Highways	State Highways	Town Highways	State Aid Highways	State Highways	
PREVIOUS MILEAGE as shown March 15, 1959	40.65	0.320	12.529				53.499
HIGHWAYS ADDED Since March 15, 1959, ac- cording to certain Explan under paragraph 1 below							
SUB-TOTAL							
HIGHWAYS SUBTRACTED Since March 15, 1959. Those becoming untraveled, discon- tinued, legal trails or post roads. Explain under para- graphs 2 and 3 below							
TOTAL TRAVELED HIGHWAYS Feb 10, 1960							

1 We hereby certify that the following new highways, as substantiated by the attached "Selectmen's Certificate of Completion", have been added since March 15, 1959:

2 We hereby certify that the following highways have been discontinued, or changed to trails or post roads according to statute, since March 15, 1959, as substantiated by the attached copy of the proceedings:

3 We hereby certify that the following roads have become untraveled since March 15, 1959:

SELECTMEN

W.A. Starr
O.C. Armstrong
 in the county of Chittenden
 and personally appeared
O.C. Armstrong

Selectmen of Troy
 and made oath to the truth of the foregoing affidavits by them subscribed.

Subscribed and sworn to before me this _____ day of _____, 1960.

Marion K. Titus
Henry Parker
 (Notary Public for Vermont)

Town Clerk should file one following and send one white and one yellow copy to the Commissioner of Highways, Montpelier, Vermont, on or before March 15, 1960.

Marion K. Titus
 Town Clerk of the town of Troy
 hereby certifies that the foregoing is a true and correct copy of the original of the Selectmen of Troy
 relating to highway mileage. She is subscribed to this date February 10, 1960
Marion K. Titus

CERTIFICATE OF HIGHWAY MILEAGE

FOR YEAR ENDING FEBRUARY 10, 1968

Fill out in triplicate and file with your Town Clerk on or before February 10, 1968

(Note sections of Vermont Statutes Annotated on reverse side of this sheet)

We, the boardmen of the town of **TEOY**, do hereby certify that we have carefully examined all the traveled highways in this town and find that the total mileage of traveled highways according to Title 19, V.S.A. Sec. 15, subsection 1961, Art. No. 26 and including post roads and trails, in this town for the year ending February 10, 1968, is as follows:

	MILEAGE IN TOWNS (Outside of villages incorporated for highways)			MILEAGE IN VILLAGES (Incorporated for highways)			Total AS System
	TEOY						
	Town Highways	State Aid Highways	State Highways	Town Highways	State Aid Highways	State Highways	
PREVIOUS MILEAGE as shown March 15, 1967	40.65	0.120	12,529				53,499
HIGHWAYS ADDED since March 15, 1967, ac- cording to statute. Explain under paragraph 1 below							
SUB-TOTAL							
HIGHWAYS SUBTRACTED since March 15, 1967. Those becoming untraveled, discon- tinued, legal trails or post roads. Explain under para- graphs 2 and 3 below							
TOTAL TRAVELED HIGHWAYS Feb. 10, 1968							

1. We hereby certify that the following new highways, as substantiated by the attached "Selection's Certificate of Completion", have been added since March 15, 1967:

2. We hereby certify that the following highways have been discontinued, or changed to trails or post roads according to statute, since March 15, 1967, as substantiated by the attached copy of the proceedings:

3. We hereby certify that the following roads have become untraveled since March 15, 1967:

RECEIVED

John Paul Bonniwell
Treasurer
in the presence of *William*

Attest:
I, *John Paul Bonniwell*, Treasurer of the Town of Teoy, do hereby certify that the foregoing is a true and correct copy of the original as shown to me by the boardmen of the town of Teoy.

William
in the presence of *William*

This document shall be valid only if and so long as the original is filed with the Town Clerk on or before February 10, 1968.

William
Town Clerk

OFFICE OF THE
COMMISSIONER



STATE OF VERMONT
DEPARTMENT OF HIGHWAYS
MONTPELIER

Highway Planning Division

January 2, 1968

Board of Selectmen
Town of Troy
Troy, Vermont 05868

Attention of Chairman

Gentlemen:

In 1967 you indicated a desire to add to your Town Highway mileage two sections of new road totaling 0.31 mile. At that time we advised that before this could be accomplished it would be necessary for you to furnish this Agency a copy of the right-of-way for each section.

If you still desire to make these changes, please submit the necessary copies of the rights-of-way and make an entry on the enclosed 1968 Highway Mileage Certificate. We will appreciate your entering any other Town Highway changes processed in accordance with the Statutes during the past year.

We will appreciate receipt of the signed Certificates prior to March 15, 1968.

Sincerely yours,

R. J. Nichols
Highway Planning Engineer

RJN/JEB/ala
Enc.

FILED
2/14/68

RUSSELL A. HOLDEN
COMMISSIONER OF HIGHWAYS

CERTIFICATE OF HIGHWAY MILEAGE

File

FOR YEAR ENDING FEBRUARY 10, 1967



This Certificate and Fee will expire February 10, 1967

Note portions of Vermont Statute 240-101 are printed on reverse side of this sheet

STATE OF VERMONT DEPARTMENT OF HIGHWAYS

MONTPELIER 05400

Highway Planning Division

TOWN

State of Vermont
1967
April 10, 1967

Total
Mileage

19.120 12.539

31.659

Board of Selectmen
Town of Troy
Troy, Vermont

Attention of Chairman

Gentlemen:

Relative to the Highway Mileage Certificates which you recently submitted, please be advised that the two (2) additions to Town Highway Mileage which you indicated could not be made at this time.

Statute requires that before a section of road can be added to your Town Highway System, a copy of the right-of-way for the section be furnished the Planning Division as well as a completed Certificate of Completion and opening. The Certificate was included with your Mileage Certificate, but since the copies of the rights of way were not, we could not make these additions to your Town Mileage System. We have, therefore, reported your Town Highway Mileage to the State Treasurer as 40.65 miles.

We have changed our records to agree with the above figure and request you do the same.

Very truly yours,

R. J. Nicholls
Highway Planning Engineer

By: James E. Stearns
Administrative Assistant

RJN/jib/cwd

CERTIFICATE OF HIGHWAY MILEAGE

FOR YEAR ENDING FEBRUARY 15, 1947

Fill out in triplicate and file with your Town Clerk on or before February 15, 1947

(State sections of Vermont Statutes Annotated on reverse side of this sheet)

We, the Selectmen of the town of TROY, on each state that we have carefully measured all the traveled highways in this town and find that the total mileage of traveled highways according to Title 10, V.S.A. Sec. 25 amended 1931, Act No. 22, not including post roads and trails, in this town for the year ending February 15, 1947, is as follows:

	MILEAGE IN TOWN (Outside of villages incorporated for highways)			MILEAGE IN VILLAGE (Incorporated for highways)			Total All Highways
	TROY						
	Town Highways	State Aid Highways	State Highways	Town Highways	State Aid Highways	State Highways	
PREVIOUS MILEAGE as shown March 15, 1946	39.72	0.320	12.529				52.569
HIGHWAYS ADDED Since March 15, 1946, ac- cording to statute. Explain under paragraph 1 below.	+1.13						
SUB-TOTAL							
HIGHWAYS SUBTRACTED Since March 15, 1946. Those becoming untraveled, discon- tinued, legal trails or post roads. Explain under para- graphs 2 and 3 below.	-0.20						
TOTAL TRAVELED HIGHWAYS Feb. 15, 1947	40.65	0.320	12.529				53.499

1. We hereby certify that the following new highways, as substantiated by the attached "Selectmen's Certificate of Construction", have been added since March 15, 1946:

off Route 105 - 29/100 y mile to property of Lynn Boston
off Route 24 - 4/100 y mile to property of Citizens Telephone Co

2. We hereby certify that the following highways have been discontinued, or changed to trails or post roads according to statute, since March 15, 1946, as substantiated by the attached copy of the proceedings:

3. We hereby certify that the following roads have become untraveled since March 15, 1946:

SELECTMEN: *J.P. Bernier*
O.C. Armistead
E.R. Alston

In the county of Arkham

at 15 Troy on the 15th day of March 1947

Subscribed and sworn to before me at Troy Vermont, on the 15th day of March 1947.

My commission expires _____

(Town Clerk should fill out following and mail one copy to the State Highway Department, on or before March 15, 1947.)

My commission expires _____

Notary Public for the State of Vermont, my commission expires _____

Notary Public for the State of Vermont, my commission expires _____

Form and Selection's Certificate of Completion
for New Highways built or added

**CERTIFICATE OF COMPLETING AND OPENING
HIGHWAY FOR PUBLIC TRAVEL**

MAURICE L. TITUS

TROY, Town (City) Clerk
Town (City) of TROY
NORTH TROY, Vermont

Pursuant to Title 19, V.S.A. Section 15, this is to certify that the following described section (sections) of highway in the Town (City) of TROY, on Feb. 10, 1967 Route Number 105 & 24 is completed and OPEN FOR PUBLIC TRAVEL.

Section 1. (If only one section, omit words "Section 1")

section II Beginning at ^{Route} 105 2 1/100 mile (description) continuing 3 roads north to Boston by
" at Route of 2/100 mile - 3 roads north to City of Troy

and as shown on a Highway Map of the Town (City) of Troy, dated March 15, 19 66, and filed in General Bulk 6 of the General Records of the Town (City) of TROY by the Town (City) Clerk of said Town (City), incorporated herein by reference, and attested to on said map by said Town (City) Clerk.

Dated at Troy, County of Orleans, and State of Vermont, this 1st day of March A. D., 19 67.

J.P. Bonneau Board
P.C. Fumet
RA Starr Selectman
(Alderman)

(and the Mayor of the City of _____)

Troy, Vermont
March 1, 19 67

The above is a true copy of description of a section (s) of highway, completed and OPENED FOR PUBLIC TRAVEL, recorded in Book 8 on Page 99 of General Records of the Town (City) of Troy on the 1st day of March, 19 67, at 9:30 o'clock A M.

Attest: Maurice L. Titus
Town (City) Clerk of Troy, Vt.

MAR 24 8 29 PM '67
VERMONT HIGHWAY DEPT

RECEIVED
MAR 21 1967
VT. HIGHWAY
PLANNING
DIVISION



STATE OF VERMONT
DEPARTMENT OF HIGHWAYS
MONTPELIER, VERMONT
05602

Highway Planning Division

December 15, 1966

Board of Selectmen
Town of Troy
Troy, Vermont 05868

Attention of Chairman

Gentlemen:

In accordance with Title 19, V.S.A., Section 15, as amended, all the traveled highways in your town were measured in 1966 by Reginald O. Hanson, Town Manager; Robert A. Starr, Selectman; and Mr. Harvey of this office.

The resulting changes in highway mileage are indicated on the enclosed map and are explained on the attached breakdown sheet.

You will note that Town Highways 18A and 24A, indicated by the letters "J" and "K" on the map, are not included in your Town Highway additions. Before this can be done it is necessary that you furnish us a copy of the Rights-of-Way, and Certificate of Completion and Opening. A sample format for this Certificate is attached.

For your convenience, we have entered the changes in Town Highway Mileage on the enclosed Highway Mileage Certificate and would appreciate your entering any other Town Highway changes processed in accordance with the Statutes this past year.

Very truly yours,

R. J. Nicholls
Highway Planning Engineer

RJW/RE/ala
Enc.

CERTIFICATE OF HIGHWAY MILEAGE

FOR YEAR ENDING FEBRUARY 10, 1966

Fill out in triplicate and file with your Town Clerk on or before February 10, 1966

(State sections of Vermont Statutes Annotated on reverse side of this sheet)

We, the Selectmen of the town of **Troy**, do hereby state that we have carefully examined all the traveled Highways in this town and find that the total mileage of traveled Highways according to Title 13 V.S.A. Sec. 12, amended 1961, Act No. 26 but excluding post roads and trails, in this town for the year ending February 10, 1966 is as follows:

	MILEAGE IN TOWN (Outside of villages incorporated for highways)			MILEAGE IN VILLAGES (Incorporated for highways)			Total All Systems
	TROY			Town Highways	State Aid Highways	State Highways	
	Town Highways	State Aid Highways	State Highways				
REPORT MADE on or about March 15, 1965	39.72	0.320	12.529				52.569
HIGHWAYS ADDED Since March 15, 1965, ac- cording to statute. Explain under paragraph 1 below							
SUB-TOTAL							
HIGHWAYS DEDUCTED Since March 15, 1965 Those becoming untraveled, discon- tinued, legal trails or post roads. Explain under para- graphs 2 and 3 below.							
TOTAL TRAVELED HIGHWAYS Feb. 10, 1966							

1. We hereby certify that the following new highways, as substantiated by the attached "Selectmen's Certificate of Completion", have been added since March 15, 1965:

2. We hereby certify that the following highways have been discontinued, or changed to trails or post roads according to statute, since March 15, 1965, as substantiated by the attached copy of the proceedings:

3. We hereby certify that the following roads have become untraveled since March 15, 1965:

SELECTMEN:

J.P. Starr
J.C. Bonneau
in the county of *Orleans*
1966 personally appeared
R.A. Storti & J.C. Bonneau

At *Troy*
the *21st* day of *January*
R.A. Storti & J.C. Bonneau

Selectmen of
and under oath to the truth of the foregoing affidavits by them subscribed.

Before me,

Manuel R. Gitter
Notary Public
(State of Vermont)

Town Clerk should file one following and send one with one other copy to the Commissioner of Public Safety, Vermont, on or before March 10th.

Manuel R. Gitter Clerk of the Town of *Troy*

Notary certify that the foregoing is a true copy as sworn of the selectmen of the town of *Troy* regarding its highway mileage, filed and certified as this date.

CERTIFICATE OF HIGHWAY MILEAGE

FOR YEAR ENDING FEBRUARY 10, 1965

Fill out in triplicate and file with your Town Clerk on or before February 10, 1965

(Note sections of Vermont Statutes Annotated on reverse side of this sheet)

We, the Selectmen of the town of Troy, do hereby certify that we have carefully measured all the traveled highways in this town and find that the total mileage of traveled highways according to Title 19, V.S.A. Sec. 24, amended 1961, Act No. 26, not including post roads and trails, in this town for the year ending February 10, 1965, is as follows:

	MILEAGE IN TOWN (Outside of villages incorporated for highways)			MILEAGE IN VILLAGES (Incorporated for highways)			Total All Systems
	TROY						
	Town Highways	State Aid Highways	State Highways	Town Highways	State Aid Highways	State Highways	
PREVIOUS MILEAGE as shown March 15, 1964	39.72	0.330	12.529				52.569
HIGHWAYS ADDED Since March 15, 1964, according to statute. Explain under paragraph 1 below.							
SUB-TOTAL							
HIGHWAYS SUBTRACTED Since March 15, 1964. Those becoming untraveled, discontinued, legal trails or post roads. Explain under paragraphs 2 and 3 below.							
TOTAL TRAVELLED HIGHWAYS Feb. 10, 1965							52.569

1. We hereby certify that the following new highways, as substantiated by the attached "Selectmen's Certificate of Completion," have been added since March 15, 1964:

2. We hereby certify that the following highways have been discontinued, or changed to trails or post roads according to statute, since March 15, 1964, as substantiated by the attached copy of the proceedings:

3. We hereby certify that the following roads have become untraveled since March 15, 1964:

Jan Paul Bonneau
 SELECTMEN *C. C. Armstrong*
R. A. Starr
 in the county of Orleans

the 20th day of January, 1965 personally appeared
Jan Paul Bonneau, *C. C. Armstrong*, *R. A. Starr*

Subscribed at
 and made oath to the truth of the foregoing affidavit by those subscribed.
 Before me,
Maurice S. Tuttle
 Notary Public
 (White Seal with an Expiration Date)

(Town Clerk should fill out following and mail one white and one yellow copy to the Commissioner of Transportation Vermont on or before March 31st.)
 I, *Maurice S. Tuttle*, Clerk of the Town of Troy, do hereby certify that the foregoing is a true copy of record of the proceedings of the Selectmen of the Town of Troy relating to highway mileage filed and recorded at this office.
Maurice S. Tuttle

CERTIFICATE OF HIGHWAY MILEAGE

FOR YEAR ENDING FEBRUARY 10, 1964

Fill out in triplicate and file with your Town Clerk on or before February 10, 1964

(Note sections of Vermont Statutes Annotated on reverse side of this sheet)

We, the Selectmen of the town of **Troy**, on each state that we have carefully measured all the traveled highways in this town and find that the total mileage of traveled highways according to Title 19, V.S.A. Sec. 15, amended 1961, Act No. 70, not including post roads and trails, in this town for the year ending February 10, 1964, is as follows:

	MILEAGE IN TOWN <small>(Change of village incorporated for highways)</small>			MILEAGE IN VILLAGES <small>(Incorporated for highways)</small>			Total All Systems
	TROY						
	Town Highways	State Aid Highways	State Highways	Town Highways	State Aid Highways	State Highways	
PREVIOUS MILEAGE as shown March 15, 1963	39.72	0.320	12.529				52.569
HIGHWAYS ADDED since March 15, 1963, ac- cording to statute. Explain under paragraph 1 below							
SUB-TOTAL							
HIGHWAYS DEDUCTED since March 15, 1963. Those becoming untraveled, discon- tinued, legal trails or post roads. Explain under para- graphs 2 and 3 below.							
TOTAL TRAVELED HIGHWAYS Feb. 10, 1964	39.72	0.320	12.529				52.569

1 We hereby certify that the following new highways, as substantiated by the attached "Selectmen's Certificate of Completion," have been added since March 15, 1963:

2 We hereby certify that the following highways have been discontinued, or changed to trails or post roads according to statute, since March 15, 1963, as substantiated by the attached copy of the proceedings:

3 We hereby certify that the following roads have become untraveled since March 15, 1963:

SELECTMEN:

R.A. Starr
J.P. Rousseau
P.C. Armstrong
 in the name of *Troy*

At _____ day of _____ 1964 personally appeared _____
J.P. Rousseau & P.C. Armstrong

Selectmen of _____ who made oath to the truth of the foregoing affidavits by them subscribed.

Before me,
Margaret A. Galtier
Mary J. Galtier
(Notary Public for the State of Vermont)

Town Clerk should fill out following and mail one white and one yellow copy to the Commissioner of Highways, Department of Transportation, 100 State Street, Montpelier, Vermont.

Notary certifies that the foregoing is a true copy of record of the proceedings of the Selectmen of _____ in relation to Highway mileage, filed and recorded as above stated.

CERTIFICATE OF HIGHWAY MILEAGE

FOR YEAR ENDING FEBRUARY 10, 1963

Fill out in triplicate and file with your Town Clerk on or before February 10, 1963

(Note sections of Vermont Statutes Annotated on reverse side of this sheet)

We, the Selectmen of the town of **Troy**, do hereby certify that we have carefully measured all the traveled highways in this town and find that the total mileage of traveled highways according to Title 19 V.S.A. Sec. 15, amended 1961, Act No. 28, not including post roads and trails, in this town for the year ending February 10, 1963, is as follows:

	MILEAGE IN TOWN <small>(Mileage of village incorporated for highways)</small>			MILEAGE IN VILLAGE <small>(Incorporated for highways)</small>			Total all systems
	Troy			North Troy			
	Town Highways	State Aid Highways	State Highways	Town Highways	State Aid Highways	State Highways	
PREVIOUS MILEAGE as shown March 15, 1962	39.72	0.320	12.529	3.27	1.974	1.312	59.125
HIGHWAYS ADDED since March 15, 1962, ac- cording to statute. Explain added paragraph 1 below.							
SUB-TOTAL							
HIGHWAYS SUBTRACTED since March 15, 1962. Those becoming untraveled, discon- tinued, legal trails or post roads. Explain under para- graphs 2 and 3 below.							
TOTAL TRAVELED HIGHWAYS Feb. 10, 1963	39.72	0.320	12.529	3.27	1.974	1.312	59.125

1. We hereby certify that the following new highways, as substantiated by the attached "Selectmen's Certificate of Completion," have been added since March 15, 1962:

2. We hereby certify that the following highways have been discontinued, or changed to trails or post roads according to statute, since March 15, 1962, as substantiated by the attached copy of the proceedings:

3. We hereby certify that the following roads have become untraveled since March 15, 1962:

SELECTMEN:

R. A. Starn
J. P. Bonnell
O. C. Armstrong
 in the county of **ORHEANS**
 1963 personally appeared **R. A. Starn**

At **TROY** on the **18th** day of **MARCH**, 1963
 I, **R. BONNELL** and **O. C. ARMSTRONG**
 Selectmen of **TROY**
 and their seal to the truth of the foregoing affidavits by them subscribed.

Before me,

Ethel Gullett
Ethel Gullett
 Notary Public
(Write official title in heavy ink)

Town Clerk should fill out following and mail one white and one yellow copy to the Commissioner of Highways, Vermont, on or before March 15th.

Ethel Gullett
Ethel Gullett
 Notary Public
 hereby certify that the foregoing is a true copy of record of the certificate of the Selectmen of
 showing no highway mileage, filed and recorded as this date
MARCH 12 1963
Ethel Gullett
Ethel Gullett
 Notary Public

WILLIAM POETER
COMMISSIONER OF HIGHWAYS

STATE OF VERMONT
DEPARTMENT OF HIGHWAYS
MONTPELIER



STATE OF VERMONT
DEPARTMENT OF HIGHWAYS
MONTPELIER
Highway Planning Division

January 15, 1962

R. A. Starr, Chairman
Board of Selectmen
Troy, Vermont

Dear Sir:

We are enclosing for your records a copy of the state-aid reselection certificate for the Town of Troy, as approved by the Commissioner of Highways on December 29, 1961.

This is in connection with the 10-Year Reselection of State-Aid Highways. There has been no change in mileage.

Very truly yours,

H. F. Farrington
Highway Planning Engineer

HFF/VMT/mn

ending at

No. 4 miles

beginning at

extending (Give description)

ending at

No. 5 miles

beginning at

extending (Give description)

SECTION OF STATE AID HIGHWAY

file

Town of Iroy
County of Orleans
Vt. Hwy. Dist. No. 12
Total S.A. Mileage 0.37

COPY

Important town highways as required by Title 18, V.T.A., Sections 1 & 12.

No. 1 0.32 miles
Beginning at Junction S.A. #1 and State Route 101
extending (Give direction) westerly 0.32 miles
ending at Iroy-Westfield town line

No. 2 _____ miles
Beginning at _____
extending (Give direction) _____
ending at _____

No. 3 _____ miles
Beginning at _____
extending (Give direction) _____
ending at _____

No. 4 _____ miles
Beginning at _____
extending (Give direction) _____
ending at _____

No. 5 _____ miles
Beginning at _____
extending (Give direction) _____
ending at _____

No. 6 _____ miles
Beginning at _____
extending (Give direction) _____
ending at _____

No. 7 miles.

Beginning at

extending (Give direction)

ending at

No. 8 miles.

Beginning at

extending (Give direction)

ending at

No. 9 miles.

Beginning at

extending (Give direction)

ending at

No. 10 miles.

Beginning at

extending (Give direction)

ending at

No. 11 miles.

Beginning at

extending (Give direction)

ending at

We have this *7th* day of *November* *1911*

subject which is to supersede and replace any and all returns made prior to this time.

At *San Francisco*

[Signature]

Approved

[Signature]

STATE HIGHWAY BOARD

STATE OF VERMONT

CLEOPH A. FERRIS, CHAIRMAN
MONTPELIER
FRANK J. BROWN
MONTPELIER
FRANK S. STONE, JR.
DANVER



DEPARTMENT OF HIGHWAYS
MONTPELIER

COMMISSIONER OF HIGHWAYS
WILLIAM W. FERRIS
CHIEF ENGINEER
ALBERT S. BROWN
ASSISTANT TO THE COMMISSIONER
& CHIEF CLERK
MONTPELIER

Highway Planning Division

February 18, 1960

Board of Selectmen
Troy, Vermont

Attention of Chairman

Gentlemen:

With regard to the completion of the enclosed Road Mileage Certificates, we wish to call your attention to changes in State and Town Highway Mileage in your town.

Due to 1959 construction and relocation, the mileage for Rt. 105-A, in Troy, has changed from 2.826 to 2.764 miles, a reduction of 0.062 mile.

Also due to the 1959 construction and relocation of Rt. 105-A, the mileage for Rt. 101, because of the addition of a portion of former Rt. 105-A, and re-measurement, has changed from 4.372 to 4.491 miles, an increase of 0.099 mile, also in the town of Troy.

It is our understanding that the town has considered discontinuing or making a trail, the portion of former Rt. 105-A that was relinquished to the town. It is necessary that we receive notification if such action has taken place. However, it will not be necessary to deduct its mileage on the mileage certificates, since it has not, as yet, been added to your Town Highways.

- 2 -

We have noted the change in State Highway mileage on the enclosed certificate, for your convenience and would appreciate your noting of any change that may have occurred on your Town Highways during the past year.

Very truly yours,

H. F. Farrington
Highway Planning Engineer

HFF/VWT/jh

Encs.

STATE HIGHWAY BOARD

CLARENCE FERRINGHAM, Chairman

WILLIAM WOODS, Member

WALTER W. WOODS, Member

WALTER W. WOODS, Member

WALTER W. WOODS, Member

WALTER W. WOODS, Member



COMMISSIONER OF HIGHWAYS
WILLIAM WOODS

WALTER W. WOODS
WALTER W. WOODS

ASSISTANT TO THE COMMISSIONER
WALTER W. WOODS

STATE OF VERMONT
DEPARTMENT OF HIGHWAYS
MONTPELIER

March 31, 1939

Chairman, Board of Selectmen
Town of Troy
Vermont

Dear Sir:

We are enclosing for your records a copy of the selection of State ~~High~~ highways in the town of Troy as approved by the Commissioner of Highways on March 26, 1939.

Very truly yours,

H. F. Farrington, Mgr.
Highway Planning Division

HFF:am

Enc.

DEPARTMENT OF STATE AID HIGHWAYS

Troy, Vermont

March 4 1959

State Highway Board
State of Vermont
Montpelier, Vermont

We, the undersigned Selectman of the Town of Troy, in the County of Orleans and State of Vermont hereby certify to the State Highway Board of the State of Vermont that the following described highway, to be taken over as a State Highway, has been laid out three (3) rods wide, as described below:

1. That Town Road beginning at its junction with State Highway Route Vermont 101 at a point 1.25 miles, more or less, southerly of the junction of said Vermont Route 101 with Vermont Route 105A, and extending westerly 0.166 mile, more or less, to its meeting with Jay Town Highway Number 21 at the Troy-Jay Town Line.

Options have been obtained by the Town of Troy, to relocate and widen the above described road from the following persons:

George E. and Hazel M. Starr, Option, dated October 31, 1957 and recorded in Book 34, Page 396.

Alphonse and Julliene Faucher, Option, dated October 31, 1957 and recorded in Book 34, Page 396.

Respectfully submitted,

G. J. Pouch

R. A. Starr

D. J. Douglas

Selectman of the Town of Troy,
Vermont

11-1959
11-1959
11-1959

SELECTION OF STATE AID HIGHWAYS

Town of Troy
 County of Orleans
 Vt. Hwy. Dist. No. 12
 Total S. A. Mileage 0.32

Important town highways as requested by Sections 4903, 4910 and 4911 of the Vermont Statutes, Revision of 1947

No. 1 0.32 miles
 Beginning at Westfield town line
 extending (Give direction) easterly
 ending at Route 101 in South Troy hamlet.

No. 2 miles
 Beginning at
 extending (Give direction)
 ending at

No. 3 miles
 Beginning at
 extending (Give direction)
 ending at

No. 4 miles
 Beginning at
 extending (Give direction)
 ending at

No. 5 miles
 Beginning at
 extending (Give direction)
 ending at

No. 6 miles
 Beginning at
 extending (Give direction)

No. 7 miles

Beginning at

extending (Give direction)

ending at

No. 8 miles

Beginning at

extending (Give direction)

ending at

No. 9 miles

Beginning at

extending (Give direction)

ending at

We have this 17th day of March, 1959, made the above

selection which is to supersede and replace any and all selections made prior to this time.

E. T. Westenberg
Road Commissioner

A. J. Poulton
R. A. Starr
D. N. Dougan

Selectmen
of the
Town of
Droy

Approved:

3/23, 1959

[Signature]
Assistant Highway Engineer

MAR 26 1959

STATE HIGHWAY BOARD

[Signature]
Commissioner of Highways

STATE HIGHWAY BOARD

STATE OF VERMONT

WALTER A. PERKINS, Chairman
MONTPELIER
CLARENCE J. BROWN
NASHVILLE
HENRY W. ALWOOD
BRANDENBURGH



DEPARTMENT OF HIGHWAYS
MONTPELIER
CHIEF ENGINEER
ROBERT W. HARRISON
100 STATE ST. 2ND FLOOR
MONTPELIER, VT.
MONTPELIER, VERMONT

DEPARTMENT OF HIGHWAYS
MONTPELIER
Highway Planning Division

March 12, 1957

Mr. Maurice L. Titus
Town Clerk
Troy, Vermont

Dear Sir:

For your convenience, we are enclosing a revised, unmarked map, reflecting the recent addition to the State Highway System.

Very truly yours,

H. F. Farrington, Mgr.
Highway Planning Division

HFF: jbh

Enc.

10/11/57

STATE HIGHWAY BOARD

LEON A. PERKINS, Chairman

W. H. ANDERSON

WALTER A. BISHOP

W. H. BROWN

W. H. C. GIBSON

W. H. HARRIS

STATE OF VERMONT



COMMISSIONER OF HIGHWAYS

WILLIAM S. BROWN

W. H. BROWN

W. H. BROWN

ASSISTANT COMMISSIONER

W. H. BROWN

W. H. BROWN

DEPARTMENT OF HIGHWAYS
MONTPELIER

Highway Planning Division

January 13, 1950

A. A. Don
District Engineer
Newport, Vermont

Dear Sir:

We are enclosing for your records a copy of the selection of State-aid Highways in the Town of Troy as approved by the Commissioner of Highways on December 17, 1949.

Also attached is the letter of transmittal to the Chairman of the Board of Selectmen.

Very truly yours,

H. F. Farrington, Mgr.
Highway Planning Division

HFF:K
Enc.

STATE HIGHWAY BOARD

STATE OF VERMONT

CLYDE A. FERRINGTON, Chairman
RICHARD J. BROWN, Member
BENNETT H. AFRAND, Member



COMMISSIONER OF HIGHWAYS
WILLIAM FOSTER
CHIEF ENGINEER
HERBERT E. BROWN
ASSISTANT TO THE COMMISSIONER
E. BRUCE BEE
MINOR A. A. BROWN

DEPARTMENT OF HIGHWAYS
MONTPELIER

Highway Planning Division

January 13, 1959

R. A. Starr, Chairman
Board of Selectmen
Troy, Vermont

Dear Sir:

We are enclosing for your records a copy of the selection of State-aid Highways in the Town of Troy, as approved by the Commissioner of Highways on December 17, 1958.

Very truly yours,

H. F. Ferrington, Mgr.
Highway Planning Division

HFF:ju

Enc.

RVD:cm

TO: H. P. Radigan, Right-of-Way Engineer

FROM: *Harold V. Geval* Harold V. Geval, Technician, Right-of-Way Division

DATE: January 5, 1959

SUBJECT: Certification of Right-of-Way on Jay-Troy State Highway
Town of Troy

The Town Road in Troy from its junction with Vermont Route 101 westerly to the easterly line of the Town of Jay is described in a Survey Bill of Road in Troy as follows:

Began at a point in the west line of the West Road in Troy one and one-half rods north of the south line of the Town Farm in said Troy and ran north 75° west $39\frac{1}{2}$ rods to the west line of the Town of Troy, intersecting with the new road recently laid out by the selectmen of the Town of Jay and one and one-half rods north of the south line of the said Town Farm. Troy, Vermont February 14, 1903. H. D. Chamberlin, Surveyor.

The above description is recorded in Book 5, Page 301 of Troy General Records.

Options have been obtained by the Town of Troy, to relocate and widen the above described road from the following persons:

George E. and Hazel M. Starr, Option, dated October 31, 1957 and recorded in Book 34, Page 396.

Alphonse and Julliene Faucher, Option, dated October 31, 1957 and recorded in Book 34, Page 396.

Both of the above options are recorded in the Troy Land Records.

The above described road has been paved its entire length.

HIGHWAY DEPARTMENT

OFFICE MEMORANDUM

TO: H. E. Sargent, Chief Engineer

FROM: H. F. Farrington, Mgr., Highway Planning Division

DATE: December 12, 1958

SUBJECT: Selection of Ski Access Road in Troy

Preparatory to taking over the ski access road in Troy and Jay as a State Highway, the short section in Troy 0.46 miles in length must be made a State Aid Road first.

Attached is a map and a reselection for this purpose.

HFF/jh

RD-280 NOV 5 1958

Attach

ending at Troy-Jay Town Line

0.46 miles

Beginning at

ending (Give direction)

ending at

0.46 miles

Beginning at

ending (Give direction)

ending at

0.46 miles

Beginning at

ending (Give direction)

HIGHWAY DEPARTMENT

*INVENTING
State Aid Permitted*

OFFICE MEMORANDUM

TO: **Risk**
FROM: **Salas**
DATE: **11/26/58**
SUBJECT:

Selection certificates have come in from Jay, Troy and Worcester, requesting addition of town highways (etc.) to the State-aid System.

Jay - had been approved April 25, 1958, to be effective April 1, 1959.

Troy - Roy has supplied traffic figure. Now in Mr. Farrington's letter basket.

Worcester - On Roy's desk for traffic figures.

RL/an

NO 120 50M 2 58

ending at **Troy-Jay Town Line**

No. 3 miles.

Beginning at

extending (State direction)

ending at

No. 4 miles.

Beginning at

extending (State direction)

ending at

No. 5 miles.

Beginning at

extending (State direction)

*for one
file*

Year of 1900

County of Orleans

Vt. Hwy. Dist. No. 12

Total S. A. Mileage

Important town highways as required by Sections 4903, 4918 and 4921 of the Vermont Statutes, Revision of 1907:

No. 1 0.32 miles

Beginning at Junction S.A. #1 and State Route 101

extending (Give direction) westerly 0.32 miles

ending at Troy-Westfield Town Line

No. 2 0.46 miles (SK-4)

Beginning at Junction State Route 101

extending (Give direction) westerly 0.46 miles

ending at Troy-Jay Town Line

No. 3 miles

Beginning at

extending (Give direction)

ending at

No. 4 miles

Beginning at

extending (Give direction)

ending at

No. 5 miles

Beginning at

extending (Give direction)

ending at

No. 6 miles

Beginning at

extending (Give direction)

ending at

No. 7 miles

Beginning at

ending (Give direction)

ending at

No. 8 miles

Beginning at

ending (Give direction)

ending at

No. 9 miles

Beginning at

ending (Give direction)

ending at

We have this 10th day of October 1958, made the following

selection which is to supersede and replace any and all selections made prior to this time.

Road Commissioner

R.A. Starr

A.J. Poulin

D.G. Douglas

Chairman

of the

Board of

Highways

Approved:

10/22, 1958

A. A. Doe
District Highway Engineer

STATE HIGHWAY ENGINEER

Commissioner of Highways

Year of 1947
County of Orleans
V. Hwy. Dist. No. 12
Town S. A. Milroy

Important town highways as required by Sections 4903, 4918 and 4921 of the Vermont Statutes, Revision of 1947:

No. 1 0.32 miles

Beginning at Junction S.A. #1 and State Route 101
extending (Give direction) westerly 0.32 miles

ending at Troy-Westfield Town Line

No. 2 0.46 miles (SR-4)

Beginning at Junction State Route 101
extending (Give direction) westerly 0.46

ending at Troy-Jay Town Line

No. 3 miles

Beginning at
extending (Give direction)

ending at

No. 4 miles

Beginning at
extending (Give direction)

ending at

No. 5 miles

Beginning at
extending (Give direction)

ending at

No. 6 miles

Beginning at
extending (Give direction)

ending at

No. 7 miles

Beginning at
ending (Give direction)

ending at

No. 8 miles

Beginning at
ending (Give direction)

ending at

No. 9 miles

Beginning at
ending (Give direction)

ending at

We have this 10th day of October 1958, with the above

selection which is to supersede and replace any and all selections made prior to this time.

Road Commission:

R.A. Starr

A.J. Poulin

D.G. Douglas

Members

of the

Board of

Highways

Approved:

10/22, 1958

A. A. Doe
District Highway Engineer

STATE HIGHWAY BOARD

Commissioner of Highways

HIGHWAY DEPARTMENT

OFFICE MEMORANDUM

TO: H. E. Sargent, Chief Engineer
FROM: M. C. Farrington, Major, Planning Survey
DATE: March 23, 1954

SUBJECT: Re-evaluation of State Aid Highways in Troy.

The following reflects the change in selection of State Aid Highways in the Town of Troy, resulting from the addition of Route 101 to the State System. 1.57 miles of State Aid Highway No. 1 and 0.43 miles of State Aid Highway No. 2, a total of 6.20 miles was transferred from the State Aid System to the State Highway System, leaving a total of 0.32 miles on the State Aid System. The State Highway System increased from 5.822 miles to 12.022 miles, an increase of 6.20 miles.

NO 200 10-53

I will get this new re-selection of highways signed and returned to you very shortly. Personally I am not in favor of taking over any town highways on to the State Aid system in the Town of Troy for the present.

Very truly yours

A. A. Doe
District Engineer

AAD:S
Enc



HIGHWAY DEPARTMENT

OFFICE MEMORANDUM

TO: E. S. Sargent, Chief Engineer

FROM: H. F. Farrington, Mgr., Planning Survey

DATE: March 10, 1954

SUBJECT:

Attached are the re-selection forms, signed by the selectmen and district engineer and map showing the remaining State Aid Road in Troy. This is due to the addition of new State Highway, Vt. 101 and the short section of Richford-Troy State Highway to the State Highway System.

HFF:SHT:gi

I will get this new re-selection of highways signed and returned to you very shortly. Personally I am not in favor of taking over any town highways on to the State Aid system in the Town of Troy for the present.

Very truly yours

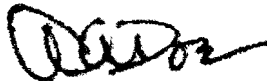

A. A. Doe
District Engineer

AAD:8
Enc

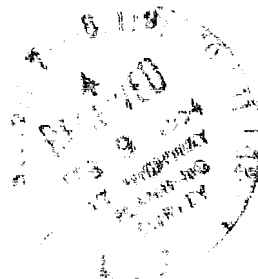



STATE OF VERMONT
DEPARTMENT OF HIGHWAYS
ALTON A. DOE
DISTRICT HIGHWAY COMMISSIONER
NEWPORT

February 8, 1954

H. F. Farrington, Manager
Highway Planning Survey
Montpelier, Vt.

Dear Sir:

In regard to taking over State Aid highways No. 1 and No. 2 in the Town of Troy, I kept a copy of each along with the map for my files, and I am returning the copy on State Aid No. 2 that you sent to me, as I presume they will need one copy at the Montpelier office.

I will get this new re-selection of highways signed and returned to you very shortly. Personally I am not in favor of taking over any town highways on to the State Aid system in the Town of Troy for the present.

Very truly yours

A handwritten signature in dark ink, appearing to read "Alton A. Doe".

A. A. Doe
District Engineer

AAD:8
Enc

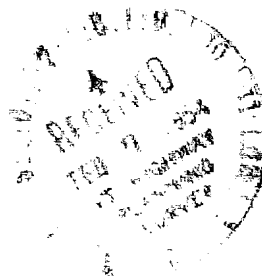

TO: A. A. Doe, District Engineer, H. P. Farrington, Manager, Highway Planning Survey

FROM: A. W. Coleman, Traffic Engineer

DATE: February 8, 1954

SUBJECT:

For your information, last Friday the State Highway Board approved the Route Number 101 for state aid highway Number 1 in the town of Troy.

This route will be marked sometime before May 1, 1954.



AWC

NO 200 12 33

flecting the change in the Troy State Highway mileage
 for your files. SECTION OF THE TOWN OF TROY

The next step would seem to be to reselect the State Aid roads. We have made up three forms for the 0.12 mile of State Aid highway remaining. Whether you wish to make any other changes in the town I do not know. When you return the reselection blanks we can then revise our town map accordingly.

In addition the following measures are advanced:

Yours very truly,

H. P. Farrington, Mgr.
 Highway Planning Survey

HFF:gi

PETITION OF THE VILLAGE OF

HOPE LICK, VERMONT.

Petition is here made to the State Highway Board for the State of Vermont, that part of the West West so-called bounded on the south by the limits of said village, and northerly to the intersection of Pleasant Street with said road, with the approval of the Governor of this State, be taken over by the State of Vermont as a part of its state highway system, and in support of said petition the

February 5, 1954

of persons are advanced:
A. A. Doe
District Engineer
Newport, Vermont

Dear Sir:

We are returning to you one letter and one map reflecting the change in the Troy State Highway mileage for your files.

The next step would seem to be to reselect the State Aid roads. We have made up three forms for the 0.32 mile of State Aid highway remaining. Whether you wish to make any other changes in the town I do not know. When you return the reselection blanks we can then revise our town map accordingly.

Yours very truly,

H. P. Farrington, Mgr.
Highway Planning Survey

HPP:gi

PETITION OF THE VILLAGE OF

NORTH TROY, VERMONT.

Petition is here made to the State Highway Board for the State of Vermont, that part of the West Road as-called bounded on the south by the limits of said Village, and northerly to the intersection of Pleasant Street with said road, with the approval of the Governor of this State, be taken over by the State of Vermont as a part of its state highway system, and in support of said petition the following reasons are advanced:

PETITION OF THE TOWN OF TROY

Petition is here made to the State Highway Board for the State of Vermont that the West Road leading from North Troy Village to South Troy, Vermont, with the approval of the Governor of this State, be taken over by the State of Vermont as a part of its state Highway system, and in support of said petition the following reasons are advanced:

POTTON CANADA

TOWN HIGHWAY	100
STATE AND HWY NO 1	100
STATE AND HWY NO 2	100
STATE AND HWY NO 3	100
STATE AND HWY NO 4	100
TOTAL STATE HWY	400
STATE HIGHWAY NO 100	100
STATE HIGHWAY NO 101	100
STATE HIGHWAY NO	
TOTAL STATE HWY	200
TOTAL ALL SYSTEMS	600

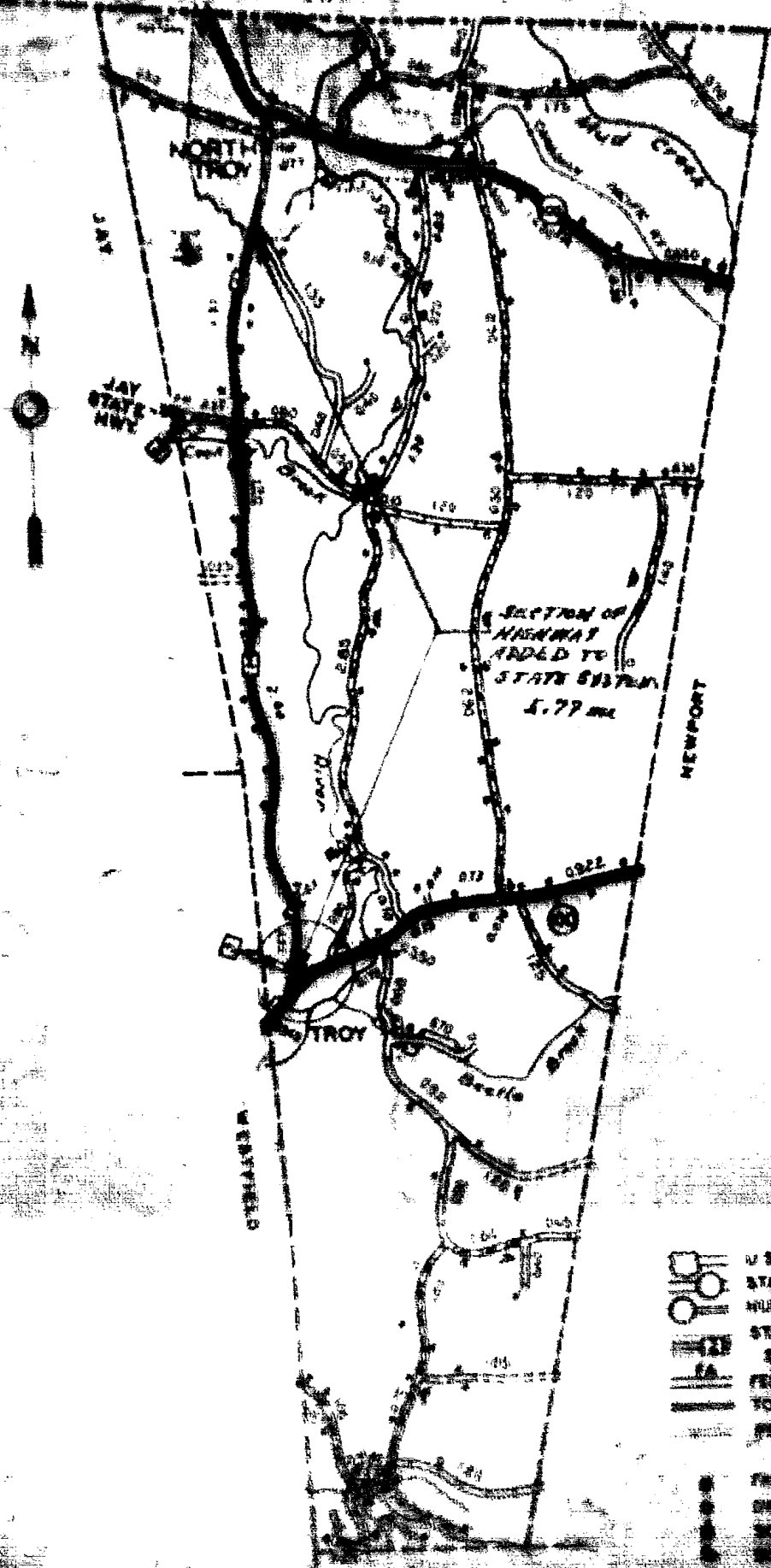

TROY
SCALE 1:25,000
-1944-

LEGEND

- | | | | |
|--|-------------------------------------|--|------------------------|
| | U.S. NUMBERED ROUTE | | PAVED ROAD |
| | STATE HIGHWAY | | SURFACE TREATED ROAD |
| | NUMBERED STATE AND HWY | | GRAVEL ROAD |
| | STATE AND HWY WITH SELECTED TOWN NO | | GRADED & IMPROVED ROAD |
| | FEDERAL AIR HIGHWAY | | UNIMPROVED ROAD |
| | TOWN HIGHWAY | | PRIVATE ROAD |
| | PRIVATE ROAD | | |

- | | | | |
|--|--------------------------|--|----------|
| | FARM UNIT | | CHURCH |
| | DWELLING OTHER THAN FARM | | MILL |
| | WELL | | CEMETERY |
| | WATER TOWER | | SCHOOL |

STATE HIGHWAY BOARD

CLEON A. PERKINS, Chairman

Bylaws

ROBERT J. MOORE

Member

KENNETH H. ATWOOD

Member-at-Large



STATE OF VERMONT
DEPARTMENT OF HIGHWAYS
MONTPELIER

COMMISSIONER OF HIGHWAYS

PAUL H. GAYNE

CHIEF ENGINEER

WALTER E. GIBNEY

ASSISTANT TO THE COMMISSIONER

WINONA G. B. BROWN

January 22, 1954

To the Selectmen & Town Clerk
Town of Troy, Vermont

In accordance with Chapter 234, Section 4954, of the Vermont Statutes, the State Highway Board does hereby take over as State Highway,

State Aid Highway #2, in the Town of Troy, beginning at the Jay Town Line, extending easterly to the intersection of State Aid Highway #1, a distance of 0.43 miles.

and as provided by Section 4959 of said statutes, file the attached map showing the said highway in the Town of Troy.

Very truly yours,

STATE HIGHWAY BOARD

BY: _____
Commissioner

Received _____, 1954

Time _____

Town Clerk

Town of Troy

STATE HIGHWAY BOARD

ELSON A. PERKINS Chairman
WILSON
MORTON J. MOORE
NEEDHAM
DEANATH H. ALWOOD
WILSON



STATE OF VERMONT
DEPARTMENT OF HIGHWAYS
MONTPELIER

COMMISSIONER OF HIGHWAYS
PAUL H. GATES
CHIEF ENGINEER
HUBERT E. BARRETT
ASSISTANT TO THE COMMISSIONER
WILSON

January 22, 1954

COPY

COPY

To the Selectmen & Town Clerk
Town of Troy, Vermont

In accordance with Chapter 234, Section 4955 of the Vermont Statutes, the Selectmen of the Town of Troy, having Petitioned on October 14, 1953, that the highway described below be taken into the State Highway System, and said highway being improved with better than gravel surface, and the approval of the Governor on January 21, 1953, the State Highway Board does hereby take over as State Highway,

State Aid Highway #1, in Troy, beginning at the intersection of Vermont route 100, extending northerly to the south village limit of North Troy Village a distance of 5.77 miles.

and, as provided by Section 4959 of said statutes, file the attached map showing the said highway in the town of Troy.

Very truly yours,

STATE HIGHWAY BOARD

BY: /s/ Paul H. Gates /s/
Commissioner of Highways

Received Feb. 3, 1954 Time 10:20 a.m.

Recorded in General Records Book 7 Page 474

_____, Town of Troy.
Town Clerk

January 18, 1954

Honorable Lee E. Emerson
Governor, State of Vermont
Montpelier, Vermont

Dear Governor Emerson:

In accordance with Chapter 234, Section 4955 of the Vermont Statutes, the selectmen of the Town of Troy have petitioned the State Highway Board that the following state aid highway be taken into the State Highway System:

All of State Aid Highway #1 in the Town of Troy leading from Vermont Route 100 to the south village limit of North Troy Village.

This highway has been improved with a better than gravel surface.

The State Highway Board has approved the taking of this highway into the state system and hereby respectfully requests your approval of the same.

Yours very truly,

Paul H. Gates
Commissioner of Highways

100-1000-1

November 14, 1953

1. A. 01 New Village to South Village Line of North Hwy
2. A. 02 South Village Line of North Hwy to a point 0.41 miles
South of intersection of A 11 & 12 of Highway 11.

	1951	1952	1953
<u>Average Daily Traffic</u>	200 (Avg.)	300	200
<u>Highway Miles</u>	1.77	0.58	6.29
<u>State Funds - 1951 A</u>			
V. S. 1916 State Aid	\$ 749.00	\$ 59.00 A	\$ 100.00
Special State Aid	1000.00	—	1000.00
Gas Tax	2103.00	69.00 A	2103.00
Resurfacing	71.00	—	71.00
Surface Retreatment (No. Tray provided)	2000.00	1000.00	2000.00
St. Aid Federal Maintenance (200.50 per mile)	1104.20	—	1104.20
Winter Maintenance (provided)	207.05	25.00	207.05
Total State Funds	\$10,114.25	\$1215.20	\$11,497.25
<u>Town Funds - 1951 A</u>			
Special State Aid	\$2000.00	—	\$2000.00
Resurfacing	35.75	—	35.75
Surface Retreatment (No. Tray - provided)	100.00	\$ 20.00	210.00
State Aid Federal Maintenance (75.00 per mile)	435.00	—	435.00
Winter Maintenance (provided)	60.00	17.00	60.00
Total Town Funds	\$2770.75	\$37.00	\$2807.75
Grand Total State & Town Funds	\$12,885.00	\$1,252.20	\$14,137.25

Estimated Annual Costs to Maintain as a State Highway

State Highway Assessments (Town)

Rate per mile	\$ 177.00	\$ 177.00	\$ —
Assessment	1000.00	92.00	111.00

Maintenance as a State Highway (State)

Summer Maintenance @ \$1176.17 per mile	\$2074.00	\$ 81.00	\$2155.00
Winter Maintenance @ \$ 706.00 per mile	1070.00	107.00	1177.00
			\$ 2332.00

A Funds actually spent unless otherwise noted
 (provided; construction funds not spent 1953)

Richford

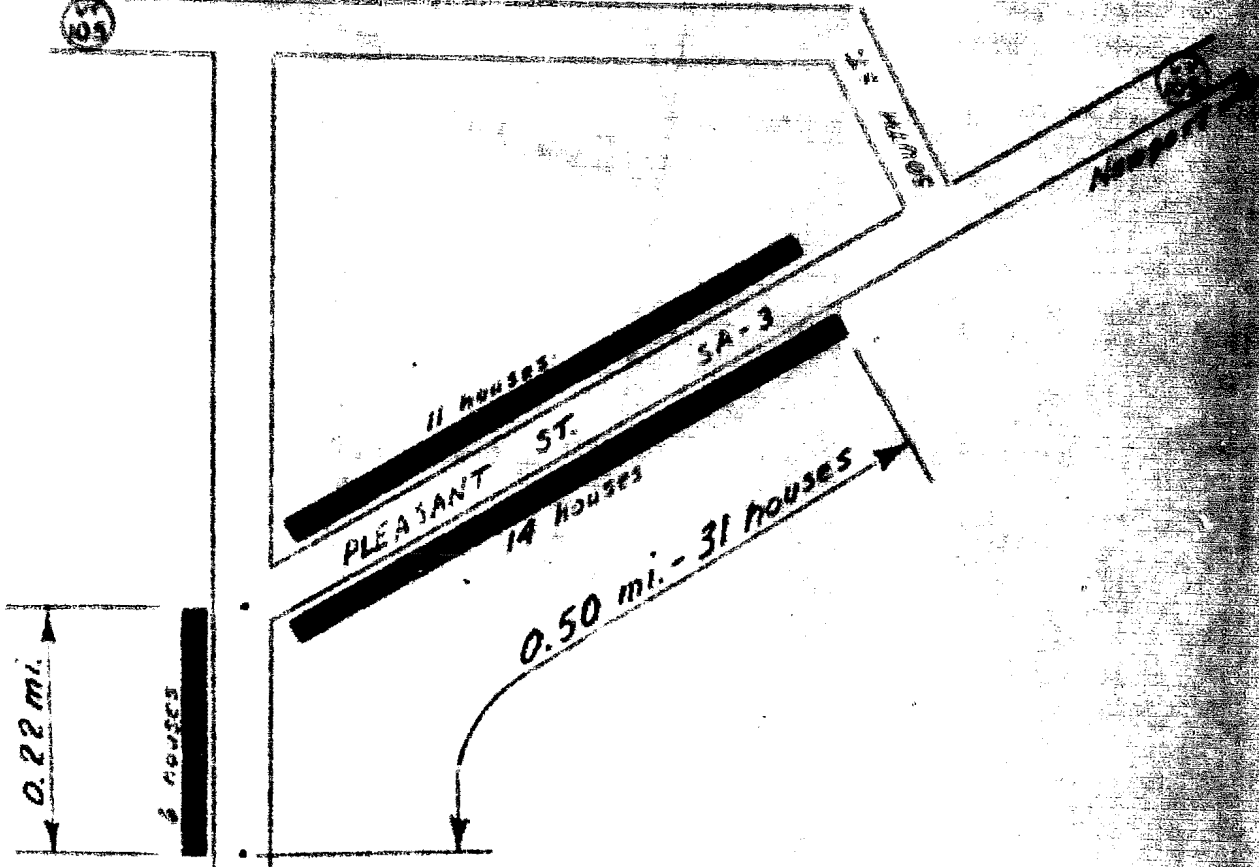

0.22 mi.
6 houses

SA-4
MIDLAND AVE.

North Troy

NORTH TROY VILLAGE

House distribution
on
Highland Ave.
and
Pleasant St.

Nov. 6, 1953 HFD

BOTTON

STATE AID HWY NO. 1	2.7
STATE AID HWY. NO. 2	0.2
STATE AID HWY. NO. 3	0.7
STATE AID HWY. NO.	
TOTAL STATE AID	3.6
STATE HIGHWAY NO. 100	2.1
STATE HIGHWAY NO. 100	2.7
STATE HIGHWAY NO.	
TOTAL STATE HWY	
TOTAL ALL SYSTEMS	13.3

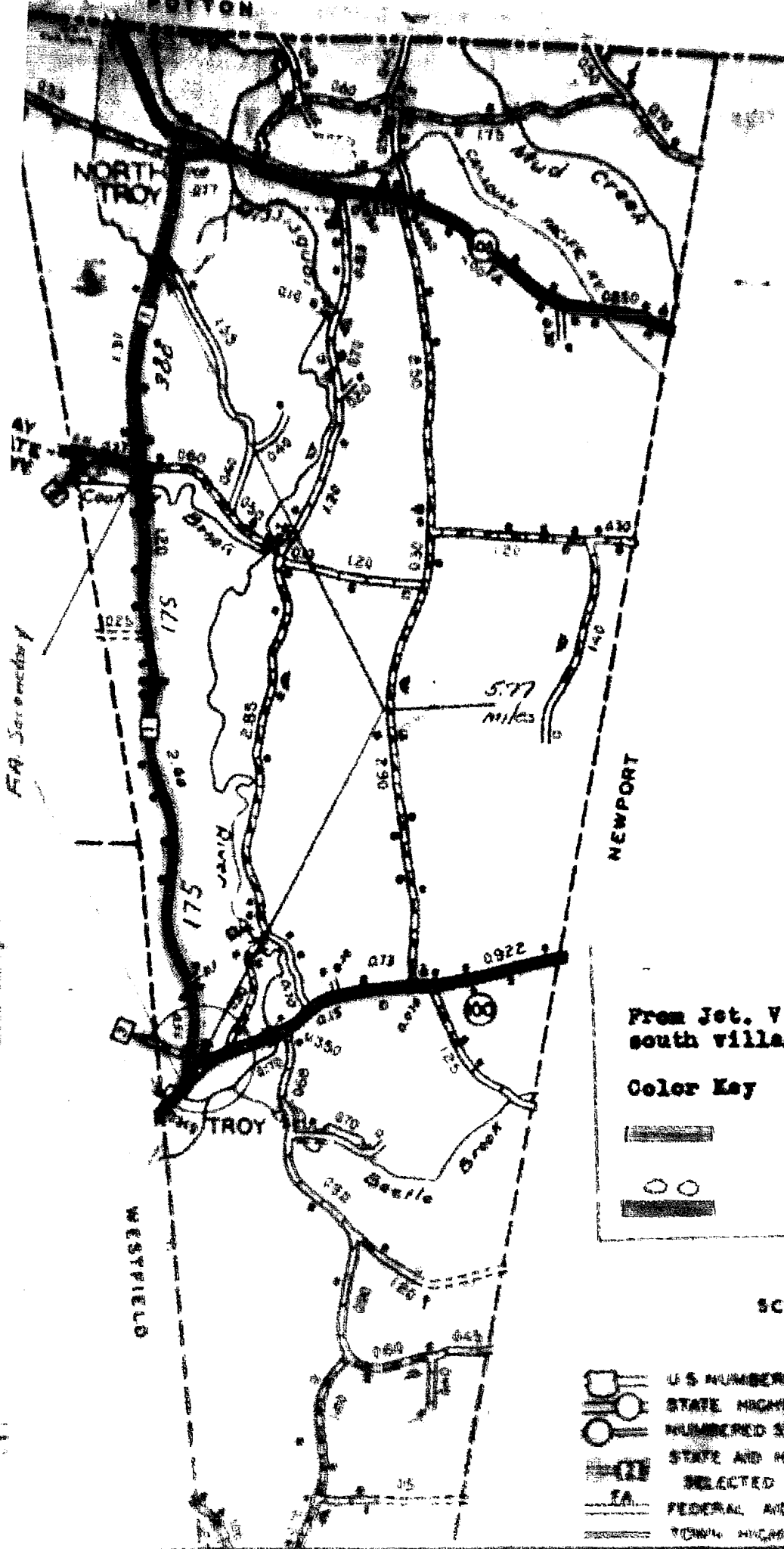

FA Secondary

NEWPORT

WESTFIELD

From Jct. Vt. 100 (Troy Village) north
south village limit of North Troy Vill.

Color Key	Surface Type	Miles
	320	5.
	24 Hour Annual Average Traf	
	V. A. Primary	

TROY

SCALE 1 INCH = 1 MILE
-1944-

LEGEND

	U.S. NUMBERED ROUTE		PAVED ROAD
	STATE HIGHWAY		SURFACE TYPED
	NUMBERED STATE AID HWY		GRAVEL ROAD
	STATE AID HWY WITH SELECTED TOWN AID		GRADED 3-ON
	FEDERAL AID HIGHWAY		UNIMPROVED
	TOWN HIGHWAY		PRIMITIVE IN
	UNTRAVELLED		UNTRAVELLED

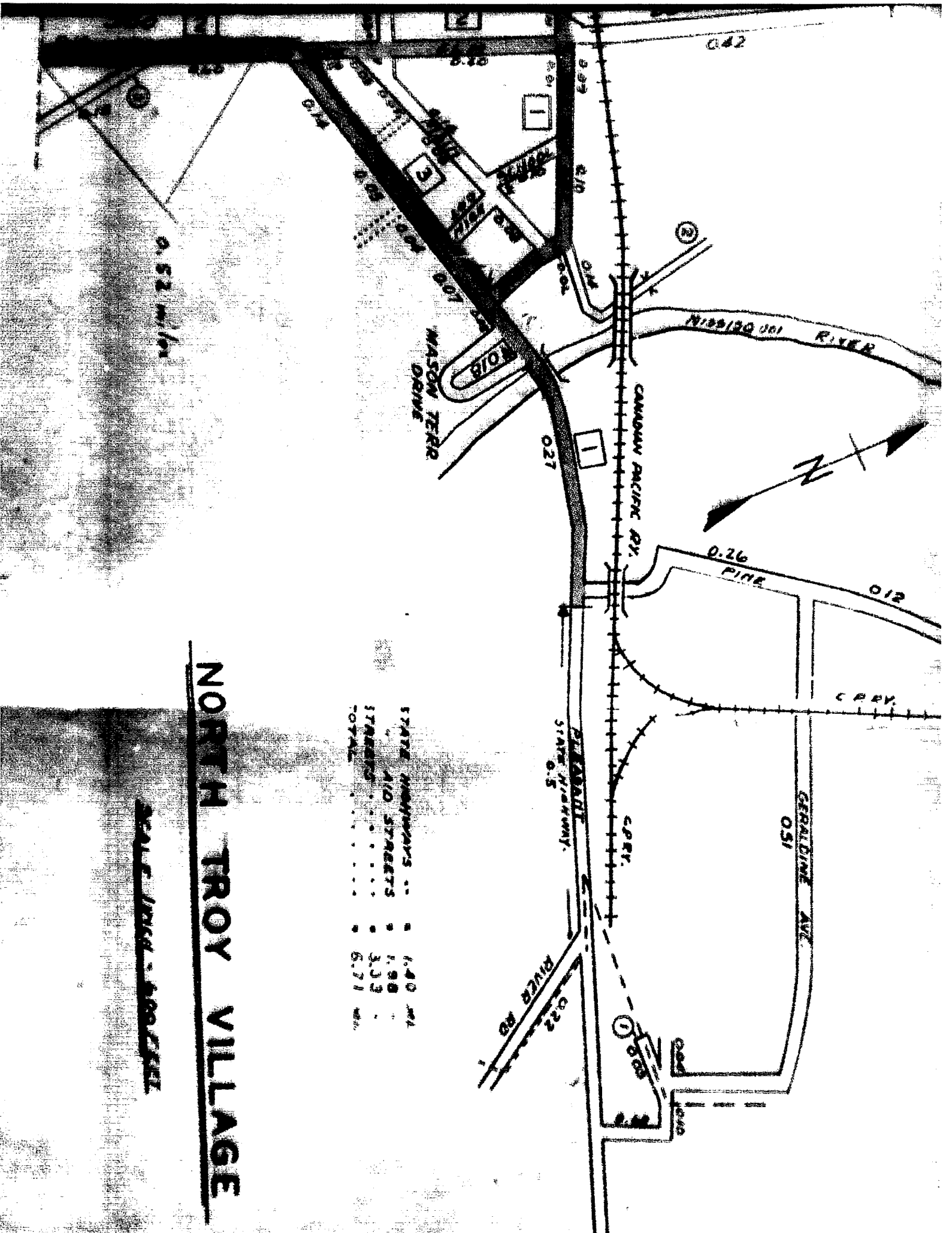

0.52 miles

NORTH TROY VILLAGE

SCALE: 1" = 400 FEET

STATE HIGHWAYS ..	2	1.40	MI.
AND STREETS ..	2	1.90	
STREETS ..	2	3.33	
TOTAL ..	2	6.71	MI.

NORTH TROY VILLAGE

SCALE 1/8" = 100'

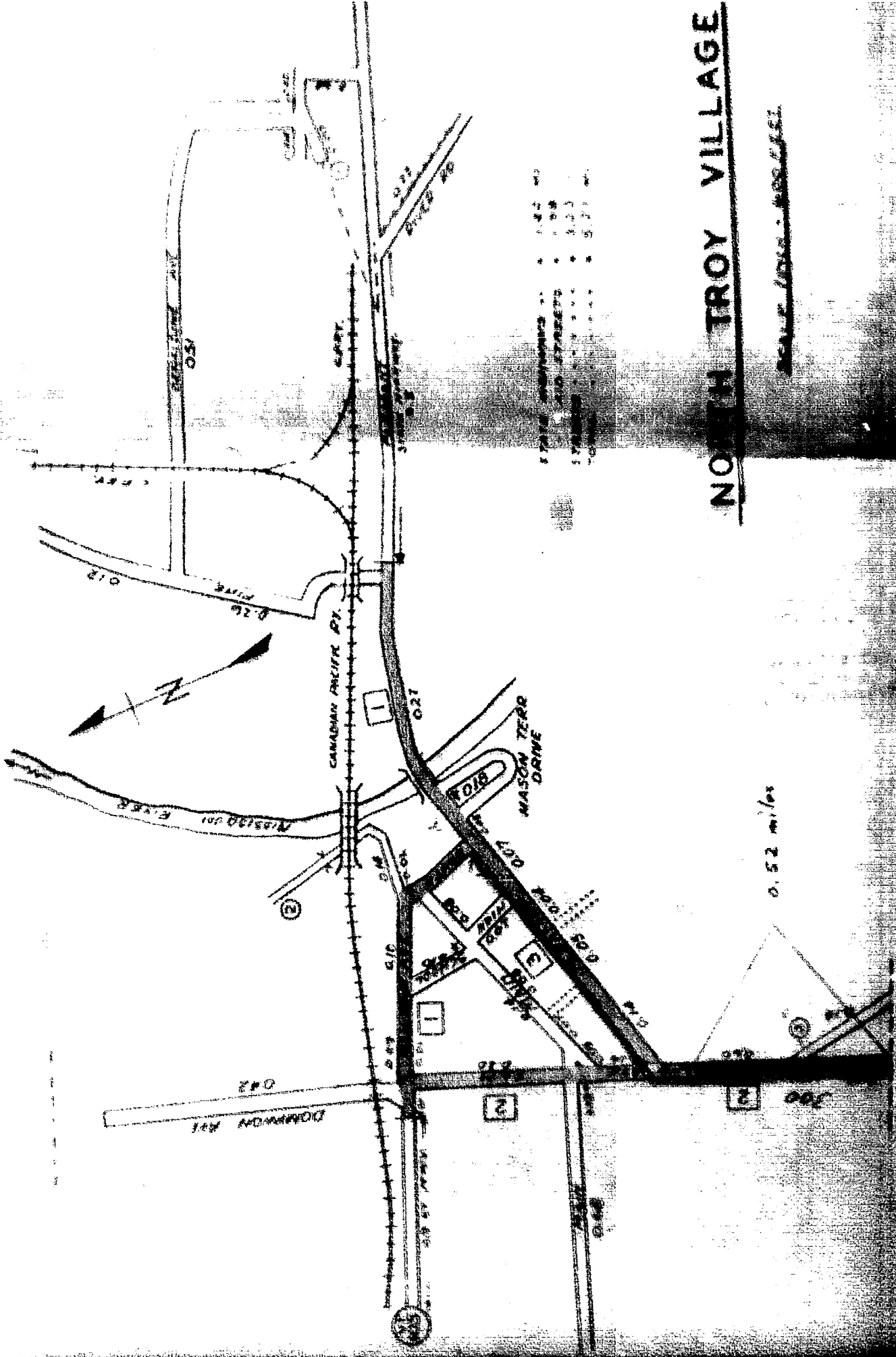

STATE HIGHWAYS	1-42	40
RAILROADS	1-98	40
STREETS	1-23	40
UNIMPROVED	1-77	40

0.52 miles

North Troy Village

VERMONT
DEPARTMENT OF HIGHWAYS
MEMORANDUM

To **W. B. McAllister**

Date **Nov. 10 1953**

The attached financial sheet for the
Town of Troy and Village of North Troy has
been prepared at the request of the Chief
Engineer.

Would you please look it over and make
any suggestions or changes that you may
think are necessary.

*copy to Troy
Highway
standing
order
taken
file*

From **R. J. Nicholls for
H. P. Farrington, Mgr.
Highway Planning Survey**

HPF:RJM:gi

VERMONT
DEPARTMENT OF HIGHWAYS
MEMORANDUM

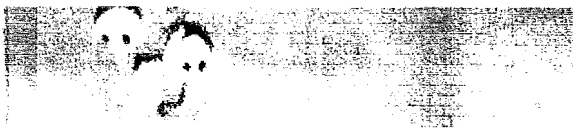

TO Mr. H. F. Farrington,
Manager, Highway Planning Survey.

Date October 30, 1953.

The Town of Troy and the Village of ^{North} Troy have petitioned that the Highway Board take over as a State Highway the State Aid road from Troy to North Troy.

Will you please make up a chart showing the same information we made up last winter during Legislature when bills were made up to put similar roads onto the State Highway System, the chart showing what the town pays in now and gets from the State and what it will cost the town if this road becomes a State Highway; also will you please give me a map of the village showing the street or streets that the petition requests we take over as a State Highway.

map of Troy
distance taken
miles

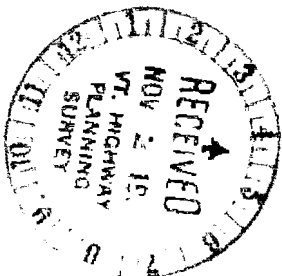

From

Chief Engineer.

HES/vl

TROY

S.A. # 2 in the town of Troy,
beg. at the Jay St., extending
easterly and ending at
St. Vt. 101, the distance taken
over being 0.466 miles.

found
v. h.

CERTIFICATE OF HIGHWAY MILEAGE

FOR YEAR ENDING FEBRUARY 15, 1968

Village

Fill out in triplicate and file with your Town Clerk on or before February 15, 1968

State sections of Vermont Statutes Annotated on reverse side of this sheet

Trustees Village

North Troy

We, the Trustees of the Town of North Troy, on each side that we have carefully measured all the traveled highways in this town and find that the total mileage of traveled highways according to Title 10, V.S.A. Sec. 14, amended 1961, Act No. 24, not including post roads and trails, in this town for the year ending February 15, 1968, is as follows:

	MILEAGE IN TOWN (Outside of village incorporated for highways)			MILEAGE IN VILLAGE (Incorporated for highways)			Total All Highways
	NORTH TROY						
	Town Highways	State Aid Highways	State Highways	Town Highways	State Aid Highways	State Highways	
PREVIOUS MILEAGE as shown March 15, 1968				3,41	1,974	1,312	6,696
HIGHWAYS ADDED Since March 15, 1968, ac- cording to statute. Explain under paragraph 1 below.							
SUBTOTAL							
HIGHWAYS SUBTRACTED Since March 15, 1968. Those becoming untraveled, discon- tinued, legal trails or post roads. Explain under para- graphs 2 and 3 below.							
TOTAL TRAVELED HIGHWAYS Feb. 15, 1968							

1. We hereby certify that the following new highways, as substantiated by the attached "Inspector's Certificate of Completion", have been added since March 15, 1968:

2. We hereby certify that the following highways have been discontinued, or changed to trails or post roads according to statute, since March 15, 1968, as substantiated by the attached copy of the proceedings:

3. We hereby certify that the following roads have become untraveled since March 15, 1968:

TRUSTEES
INCORPORATED

Fredrick Weston
H. L. Bouchard

In the county of *Orleans*

1968 personally appeared
H. L. Bouchard

At *North Troy*
on the *24th* day of *February*
Graduigle Westcott
Trustee of
North Troy

and made oath to the truth of the foregoing before me.

Before me,

Maurice J. Titus

(Write address with or without village)

(Town Clerk should fill out following and mail one white and one yellow copy to the Commissioner of Highways, Montpelier, Vermont, on or before March 15th.)

Maurice J. Titus Clerk of the Town of *North Troy*

I hereby certify that the foregoing is a true copy of record of the proceedings of the Trustees of
February 24, 1968

Maurice J. Titus

CERTIFICATE OF HIGHWAY MILEAGE

FOR YEAR ENDING FEBRUARY 15, 1968

Village

Fill out in triplicate and file with your ~~State~~ Clerk on or before February 15, 1968

(Note sections of Vermont Statutes Annotated on reverse side of this sheet)

Trustees Village

North Troy

We, the ~~Trustees~~ of the ~~State~~ of Vermont, do hereby certify that we have carefully examined all the traveled highways in this town and find that the total mileage of traveled highways according to Title 15, V.S.A. Sec. 15, amended 1961, Act No. 12, not including post roads and trails, as the same for the year ending February 15, 1968, is as follows:

	MILEAGE IN TOWN (Excludes all mileage incorporated for highways)			MILEAGE IN VILLAGE (Incorporated for highways)			Total All Mileage
	NORTH TROY						
	Town Highways	State Aid Highways	State Highways	Town Highways	State Aid Highways	State Highways	
PREVIOUS MILEAGE to close March 15, 1967				3,41	1,974	1,312	6,696
ROADWAYS ADDED Since March 15, 1967 according to statute, Chapter under paragraph 1 below.							
SUBTOTAL							
ROADWAYS DEDUCTED Since March 15, 1967. Those becoming untraveled, closed, legal trails or post roads. Exclude under paragraphs 2 and 3 below.							
TOTAL TRAVELED ROADWAYS Feb 15, 1968							

1. We hereby certify that the following new highways, as substantiated by the attached "Selectmen's Certificate of Completion", have been added since March 15, 1967:

2. We hereby certify that the following highways have been discontinued, or changed to trails or post roads according to statute, since March 15, 1967, as substantiated by the attached copy of the proceedings:

3. We hereby certify that the following roads have become untraveled since March 15, 1967:

**TRUSTEES
EXAMINER**

R. H. Bouchard
Austin Amie

At the
the 5th day of February
1968
Trustees
of the Village of North Troy

to the county of Orleans
and personally appeared
Austin Amie

Before us

Madison J. Lister
Notary Public

(These Check should all not delinquent and must be filed and are subject to the Commission of Highways, Burlington, Vermont, on or before March 15th.)

I, *Madison J. Lister*, Clerk of the Town of *North Troy*, do hereby certify that the foregoing is a true copy of record of the certificate of the *Trustees* of *North Troy* showing the highway mileage. This was recorded at this office
February 9, 1968
Madison J. Lister
Clerk

CERTIFICATE OF HIGHWAY MILEAGE

FOR YEAR ENDING FEBRUARY 15, 1937

Fill out in triplicate and file with your State Clerk on or before February 15, 1937

State officials of Vermont Statutes Assessed on reverse side of this sheet

We, the Township of North Troy and the Village of North Troy do hereby certify that we have carefully examined all the recorded highways in this town and find that the total mileage of recorded highways according to Title 25, V.S.A. Sec. 25, amended 1931, Act No. 22, not including post roads and trails, in this town for the year ending February 15, 1937, is as follows:

	MILEAGE IN TOWN (Outside of village incorporated for highways)			MILEAGE IN VILLAGE (Incorporated for highways)			Total Mileage
	Town Highways	State Aid Highways	State Highways	Town Highways	State Aid Highways	State Highways	
PREVIOUS MILEAGE as shown March 15, 1936				3.27	1.974	1.312	6.556
HIGHWAYS ADDED Since March 15, 1936, according to statute English under paragraph 1 below.				0.14			0.14
SUB-TOTAL							
HIGHWAYS DEDUCTED Since March 15, 1936. Those becoming unimproved, abandoned, legal trails or post roads. English under paragraphs 2 and 3 below.							
TOTAL TRAVELED HIGHWAYS FEB. 15, 1937				3.41	1.974	1.312	6.696

1. We hereby certify that the following new highways, as authorized by the attached "Statement's Certificate of Incorporation", have been added since March 15, 1936:

2. We hereby certify that the following highways have been discontinued, or changed to trails or post roads according to statute, since March 15, 1936, as substantiated by the attached copy of the proceedings:

3. We hereby certify that the following roads have become unimproved since March 15, 1936:

**TOWNSHIP
MEMBER**

*Prof. Raymond
Charles Jones
Ludwick Weasner*
in the county of Orleans

At North Troy Vermont
this 14th day of February, 1937 personally appeared
R. D. Bouchard, Abner, Annie, Albert, Herbert, Harold,
Joseph, Fred, Roy, Village
and each with to the truth of the foregoing attested by their signatures.

Before me,

Mauro J. Lister
Notary Public
Notary Public for the State of Vermont

(These Clerks should fill out following and mail one white and one yellow copy to the Commissioner of Highways, Montpelier, Vermont, on or before March 15th.)

I, Mauro J. Lister do hereby certify that the foregoing is a true copy of record of the records of the Township of North Troy relating to highway mileage, that are recorded at this office.

Mauro J. Lister
Notary Public



STATE OF VERMONT
DEPARTMENT OF HIGHWAYS
1000 Main Street
MONTPELIER
VERMONT

Highway Planning Division

December 15, 1966

Board of Trustees
Village of North Troy
North Troy, Vermont 05859

Attention of Chairman

Gentlemen:

In accordance with Title 19, V.S.A., Section 15, as amended, all the traveled highways in your village were measured in 1966 by Mr. W. E. Smith, Trustee; Mr. R. O. Hansen, Town Manager; and Mr. Harvey of this office.

The resulting changes in highway mileage are indicated on the enclosed map and are explained on the attached breakdown sheet.

However, before the sections of highway designated as P 1 and P 2, and identified by the letters "C" and "D" on the map can be added, it will be necessary that you furnish us copies of the Rights-of-Way and Certificate of Completion and Opening. A sample format for this Certificate is attached.

For your convenience, we have entered the changes in Village Highway Mileage on the enclosed Highway Mileage Certificate and would appreciate your entering any other Village Highway changes processed in accordance with the Statutes this past year.

Very truly yours,

R. J. Nicholls
Highway Planning Engineer

RJB/JLB/sls
Enc.

2/16/67

MADE PUBLIC BY RESOLUTION JANUARY 10, 1964

**Breakdown of 1964
Road Measurement Changes**

<u>Map Ident. Letter</u>	<u>Village Street</u>	<u>Miles Added</u>	<u>Miles Subtracted</u>	<u>Explanation</u>
A	Geraldine Avenue	+0.11		Remeasurement
B	Main Street	+0.03		Remeasurement

		+0.14		

Maurice J. Lefebvre

CERTIFICATE OF HIGHWAY MILEAGE

FOR YEAR ENDING FEBRUARY 10, 1966

VILLAGE

Fill out in triplicate and file with your Assessing Clerk on or before February 10, 1966

(Place sections of Vermont Statutes Annotated on reverse side of this sheet)

We, the Trustees of the Village of North Troy, do hereby certify that we have carefully measured all the traveled highways in this town and find that the total mileage of traveled highways according to Title 28 V.S.A. Sec. 28, amended 1961, Act No. 28, not including pent roads and trails, in this town for the year ending February 10, 1966, is as follows:

	MILEAGE IN TOWN (Outside of villages incorporated for highways)			MILEAGE IN VILLAGES (Incorporated for highways)			Total All Highways
	NORTH TROY VILLAGE						
	Town Highways	State Aid Highways	State Highways	Town Highways	State Aid Highways	State Highways	
Previous mileage as shown March 15, 1965				3.27	1.974	1.312	6.556
Highways added since March 15, 1965, ac- cording to statute. Explain under paragraph 1 below.							
SUB-TOTAL							
Highways subtracted since March 15, 1965. Those becoming untraveled, discon- tinued, legal trails or pent roads. Explain under para- graphs 2 and 3 below.							
TOTAL TRAVELLED HIGHWAYS Feb. 10, 1966							

1 We hereby certify that the following new highways, as substantiated by the attached "Selectmen's Certificate of Completion", have been added since March 15, 1965:

2 We hereby certify that the following highways have been discontinued, or changed to trails or pent roads according to statute, since March 15, 1965, as substantiated by the attached copy of the proceedings:

3 We hereby certify that the following roads have become untraveled since March 15, 1965.

TRUSTEES

Frederick Weston
R. P. Boudreau

As of North Troy in the county of Arkane
the 31st day of December 1965 personally appeared
Frederick Weston, R. P. Boudreau
Trustees of the Village of North Troy
and made oath to the truth of the foregoing affidavit by them subscribed.

Before me,

Murray R. Linton
Nancy Fuller
(Write official title, & County below)

Town Clerk should fill out following and send one white and one yellow copy to the Commissioner of Highways, Montpelier, Vermont, in or before March 15th.
I, Murray R. Linton, Clerk of the Village of North Troy, do hereby certify that the foregoing is a true copy of record of the certificate of the Trustees of the Village of North Troy according to highway statute, filed and recorded in this office.

Murray R. Linton
Town Clerk

CERTIFICATE OF HIGHWAY MILEAGE

FOR YEAR ENDING FEBRUARY 10, 1968

Village

Fill out in triplicate and file with your Town Clerk on or before February 10, 1968

State sections of Vermont Statutes Annotated on reverse side of this sheet

Trustees Village

North Troy

We, the Selectmen of the town of _____, do hereby certify that we have carefully examined all the traveled highways in this town and find that the total mileage of traveled highways according to Title 24, V.S.A. Sec. 24, amended 1961, Act No. 28, not including post roads and trails, in this town for the year ending February 10, 1968, is as follows:

	MILEAGE IN TOWN (Outside of village incorporated for highways)			MILEAGE IN VILLAGE (Incorporated for highways)			Total All Systems
	NORTH TROY VILLAGE						
	Town Highways	State Aid Highways	State Highways	Town Highways	State Aid Highways	State Highways	
PREVIOUS MILEAGE as shown March 15, 1964				3.27	1.974	1.312	6.556
HIGHWAYS ADDED Since March 15, 1964, ac- cording to statute. Explain under paragraph 1 below.							
SUB-TOTAL							
HIGHWAYS DEDUCTED Since March 15, 1964. Those becoming untraveled, discon- tinued, legal trails or post roads. Explain under para- graphs 2 and 3 below.							
TOTAL TRAVELED HIGHWAYS Feb. 10, 1968							6.556

1. We hereby certify that the following new highways, as substantiated by the attached "Selectmen's Certificate of Completion," have been added since March 15, 1964:

2. We hereby certify that the following highways have been discontinued, or changed to trails or post roads according to statute, since March 15, 1964, as substantiated by the attached copy of the proceedings:

3. We hereby certify that the following roads have become untraveled since March 15, 1964:

TRUSTEES

*By: S. Baughard
T. C. Homelin*

At *North Troy*
on *22* day of *January*
R. L. Baughard & T. C. Homelin
Trustees of *North Troy*
and shall forth to the trail of the foregoing subject by them authorized.

in the county of *Orleans*
1968 personally appeared

Before me,

*Maurice D. Titus
Notary Public*
(Write address on reverse page)

(Town Clerk should fill out following and mail one white and one yellow copy to the Commissioner of Highways, Department of Transportation, 100 North Main Street, Montpelier, Vermont.)

Maurice D. Titus

Notary Public
Clerk of the *North Troy*

Witness my hand and the foregoing is a true copy as shown of the records of the Selectmen of _____

January 22
Maurice D. Titus

CERTIFICATE OF HIGHWAY MILEAGE

FOR YEAR ENDING FEBRUARY 15, 1964

Fill out in triplicate and file with your Town Clerk on or before February 15, 1964

(Note sections of Vermont Statutes Annotated on reverse side of this sheet)

We, the Trustees of the Village of North Troy, do hereby certify that we have carefully measured all the traveled highways in this town and find that the total mileage of traveled highways according to Title 17, V.S.A. Sec. 15, amended 1961, Act No. 18, not including post roads and trails, in this town for the year ending February 15, 1964, is as follows:

	MILEAGE IN TOWN <small>(Counts of village incorporated for highways)</small>			MILEAGE IN VILLAGE <small>(Incorporated for highways)</small>			Total All Systems
	Town Highways	State Aid Highways	State Highways	NORTH TROY VILLAGE			
				Town Highways	State Aid Highways	State Highways	
PREVIOUS MILEAGE as shown March 15, 1963				3.27	1.97 1/2	1.312	6.556
HIGHWAYS ADDED Since March 15, 1963, according to statute. Explain under paragraph 1 below.							
SUB-TOTAL							
HIGHWAYS DUSTED Since March 15, 1963, becoming untraveled, discontinued, legal trails or post roads. Explain under paragraphs 2 and 3 below.							
TOTAL TRAVELED HIGHWAYS Feb. 15, 1964				3.27	1.974	1.312	6.556

1. We hereby certify that the following new highways, as substantiated by the attached "Selectmen's Certificate of Completion," have been added since March 15, 1963:

2. We hereby certify that the following highways have been discontinued, or changed to trails or post roads according to statute, since March 15, 1963, as substantiated by the attached copy of the proceedings:

3. We hereby certify that the following roads have become untraveled since March 15, 1963:

TRUSTEES
INCORPORATED

R. L. Daughard
Eva A. Sargent

At the town of North Troy
the day of February
1964, R. L. Daughard and Eva A. Sargent
Selectmen of

do the county of Franklin
1964 previously approved

and each seal to the north of the foregoing signature by those subscribed.

Before me,
Marion A. Little
Notary Public
(Notary official title to Vermont Statutes)

(Town Clerk should fill out following and send two copies and one yellow copy to the Commissioner of Highways, Montpelier, Vermont, on or before March 15th.)

I, Marion A. Little, Clerk of the Town of North Troy, hereby certify that the foregoing is a true copy as entered in the records of the Selectmen of this town of highways mileage. Filed and recorded in this office March 15, 1964

Marion A. Little
Town Clerk

WILLIAM POEYER
COMMISSIONER OF HIGHWAYS



STATE OF VERMONT
DEPARTMENT OF HIGHWAYS
MONTPELIER
Highway Planning Division

January 15, 1962

R. A. Starr, Chairman
Board of Trustees
North Troy Village, Vermont

Dear Sir:

We are enclosing for your records a copy of the state-aid reselection certificate for the Village of North Troy, as approved by the Commissioner of Highways on December 29, 1961.

This is in connection with the 10-Year Reselection of State-Aid Highways. There has been no change in mileage.

Very truly yours,

H. P. Farrington
Highway Planning Engineer

HFP/VMT/um

ending at SA 2 at jct. of Pleasant st.

No 4 miles

beginning at

extending East direction

ending at

No 5 miles

beginning at

extending West direction

COLLECTION OF STATE AID HIGHWAYS

Village of North Troy

County of Orleans

Vt. Hwy Dist. No. 12

Total S.A. mileage 1.974 miles

Important town highways as required by Title 10, V.S.A. Sections 1 & 12.

No. 1 0.651 miles

Beginning at Railroad Ave., 0.026 miles west of Jct with Elm St.

extending (Give direction) Easterly over Railroad Ave., South St., and Pleasant St. (S.A.C.L.)

ending at 0.031 mi. west of jct. with Pine st.

No. 2 1.033 miles

Beginning at Southerly village limits on Highland ave.

extending (Give direction) Northerly along Highland ave. and easterly along Pleasant st.

ending at SA #1 at the jct. of Pleasant and South streets. (S.A.C.L.)

No. 3 0.290 miles

Beginning at Jct. with SA#1 on Railroad ave.

extending (Give direction) Southerly along Elm st. and Highland ave.

ending at SA#2 at jct. of Pleasant st.

No. 4 miles

Beginning at

extending (Give direction)

ending at

No. 5 miles

Beginning at

extending (Give direction)

ending at

No. 6 miles

Beginning at

extending (Give direction)

ending at

No. 7

miles

beginning at

extending (Give direction)

ending at

No. 8

miles

beginning at

extending (Give direction)

ending at

No. 9

miles

beginning at

extending (Give direction)

ending at

No. 10

miles

beginning at

extending (Give direction)

ending at

No. 11

miles

beginning at

extending (Give direction)

ending at

We have this

7th

day of

November

1941

made this plan

selection which is to supersede and replace any and all selections made prior to this time.

S/ E. A. STETT

S/ D. G. DUNN

Signature

of the

Board of

Approved:

7 Nov

1941

Submitted by

State Engineer

CERTIFICATE OF HIGHWAY MILEAGE

FOR YEAR ENDING FEBRUARY 10, 1962

Fill out in triplicate and file with your Town Clerk on or before February 10, 1962

(Note sections of Vermont Statutes Annotated on reverse side of this sheet)

We, the Selectmen of the town of Troy, on oath state that we have carefully measured all the traveled highways in this town and find that the total mileage of traveled highways according to Title 19 V.S.A. Sec. 15, amended 1961, Act No. 28, not including pent roads and trails, in this town for the year ending February 10, 1962, is as follows:

	MILEAGE IN TOWN <small>(Outside of villages incorporated for highways)</small>			MILEAGE IN VILLAGE <small>(Incorporated for highways)</small>			Total All Systems
	Troy			North Troy			
	Town Highways	State Aid Highways	State Highways	Town Highways	State Aid Highways	State Highways	
PREVIOUS MILEAGE as shown March 15, 1961	39.72	0.320	12,542	3.27	1,974	1,312	59,138
HIGHWAYS ADDED Since March 15, 1961, according to statute. Explain under paragraph 1 below.							
SUB-TOTAL							
HIGHWAYS SUBTRACTED Since March 15, 1961. Those becoming untraveled, discontinued, legal trails or pent roads. Explain under paragraphs 2 and 3 below.			0.013	St. Hwy change is due to construction on vt. 105			
TOTAL TRAVELED HIGHWAYS Feb. 10, 1962	39.72	0.320	12,529	3.27	1,974	1,312	59,125

1. We hereby certify that the following new highways, as substantiated by the attached "Selectmen's Certificate of Completion," have been added since March 15, 1961:

2. We hereby certify that the following highways have been discontinued, or changed to trails or pent roads according to statute, since March 15, 1961, as substantiated by the attached copy of the proceedings:

3. We hereby certify that the following roads have become untraveled since March 15, 1961:

SELECTMEN:

R.A. Starr
O.C. Armstrong

in the county of Orleans
1962 personally appeared

the 14th day of March
Troy
Selectmen of Troy
and made oath to the truth of the foregoing affidavit by them subscribed.

Before me,

Maurice L. Dittus
Notary Public
(Write official title, as Notary Public)

Town Clerk should fill out following and mail one white and one yellow copy to the Commissioner of Highways, Montpelier, Vermont, on or before March 15th.

I, Maurice L. Dittus, Clerk of the Town of Troy, hereby certify that the foregoing is a true copy of record of the certificate of the Selectmen of Troy relating to highway mileage, filed and recorded at this office March 15, 1962.

Attest: Maurice L. Dittus
Town Clerk

STATE HIGHWAY BOARD

COMMISSIONER OF HIGHWAYS

PAUL H. GAYES

CLEON A. PERKINS, CHAIRMAN

RUTLAND

CHIEF ENGINEER

PORTER J. MOORE

NEWPORT

HUBERT E. BARDENY

KENNETH H. ATWOOD

BRIDGEWATER CORNERS

ASSISTANT TO THE COMMISSIONER

WINONA D.A. SHERIDAN



STATE OF VERMONT
DEPARTMENT OF HIGHWAYS
MONTPELIER

May 17, 1955

To the Selectmen and Town Clerk
Town of Newport, Vermont

In accordance with Chapter 234, Section 4956 of the Vermont Statutes, Revision of 1947, as amended by No. 146 of the Acts of 1955, the State Highway Board does hereby take over as a state highway the following state aid highway in the Town of Newport:

State Aid Highway #1, from the intersection of this route with Vt. 100, including both approaches, extend easterly, ending at the Coventry Town Line, a distance of 0.933 mile.

And as provided by Section 4959 of said statutes, a map showing this highway has been filed by the State Highway Board and the attached copy of the map is hereby delivered to the town of Newport for filing and recording.

Certified and signed at Montpelier, this _____ day of May, 1955.

STATE HIGHWAY BOARD

By: _____
Commissioner of Highways

Received: Date _____ Time _____

Recorded: Page No. _____ Volume No. _____

Records of the Town of _____

(Signed) _____
Town Clerk

C A N A D A
P O T T O N

TOWN HIGHWAY	4000	MILE
STATE AID HWY. NO. 1	1-00	"
STATE AID HWY. NO. 2	3-96	"
STATE AID HWY. NO. 3	4-00	"
STATE AID HWY. NO.		"
TOTAL STATE AID	4-96	"
STATE HIGHWAY NO. 105	5-000	"
STATE HIGHWAY NO. 100	4-000	"
STATE HIGHWAY NO.		"
TOTAL STATE HWY.	9-000	"
TOTAL ALL SYSTEMS	13-960	MILE

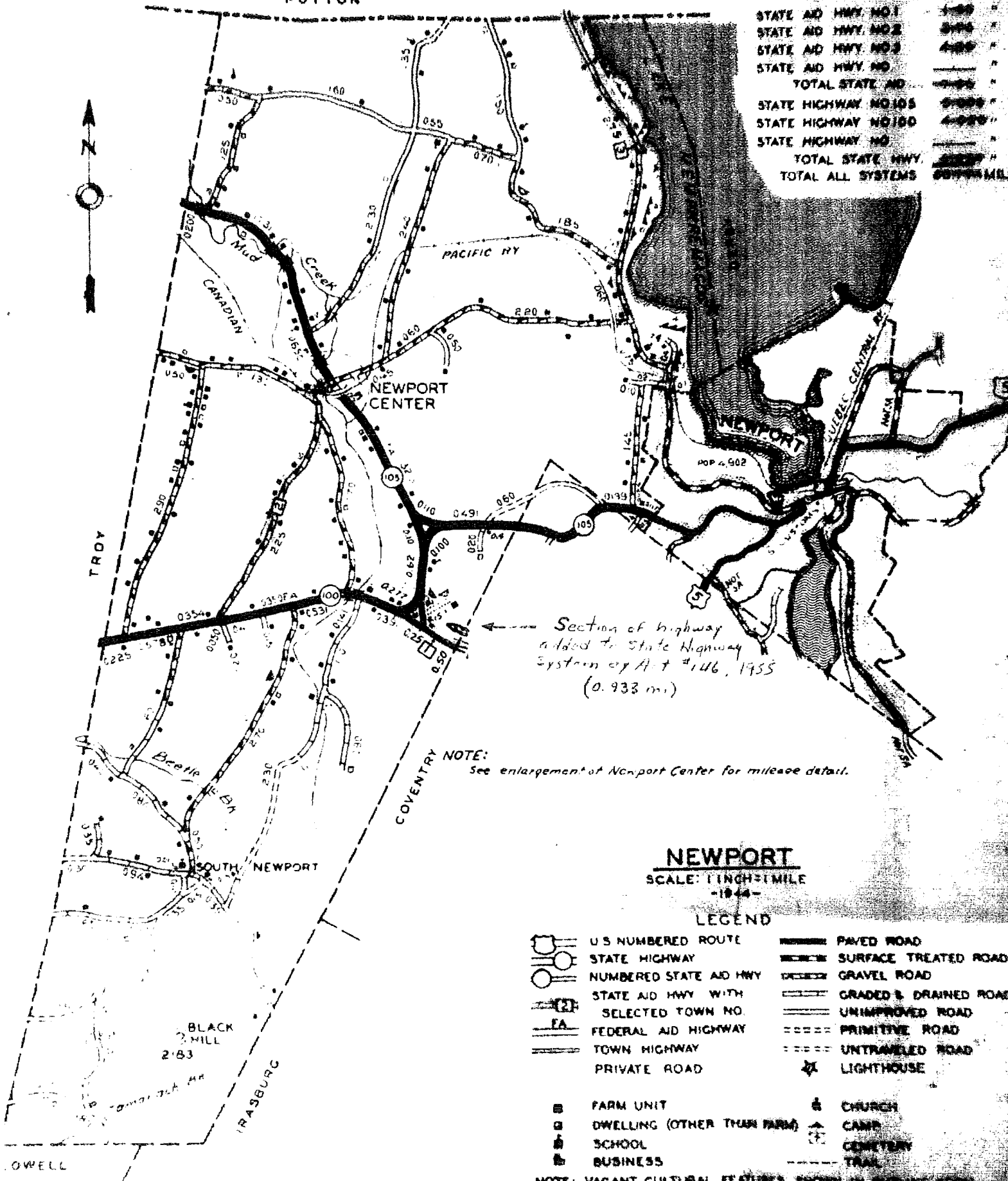

NOTE: See enlargement of Newport Center for mileage detail.

NEWPORT
SCALE: 1 INCH = 1 MILE
-1944-

LEGEND

- | | | | |
|--|--------------------------------------|--|-----------------------|
| | U.S. NUMBERED ROUTE | | PAVED ROAD |
| | STATE HIGHWAY | | SURFACE TREATED ROAD |
| | NUMBERED STATE AID HWY | | GRAVEL ROAD |
| | STATE AID HWY WITH SELECTED TOWN NO. | | GRADED & DRAINED ROAD |
| | FEDERAL AID HIGHWAY | | UNIMPROVED ROAD |
| | TOWN HIGHWAY | | PRIMITIVE ROAD |
| | PRIVATE ROAD | | UNTRAVELED ROAD |
| | FARM UNIT | | LIGHTHOUSE |
| | DWELLING (OTHER THAN FARM) | | CHURCH |
| | SCHOOL | | CAMP |
| | BUSINESS | | CEMETERY |
| | | | TRAIL |

NOTE: VACANT CULTURAL FEATURES SHOWN IN OUTLINE FORM

TOWN HIGHWAY	22,222.22
STATE AID HWY. NO. 1	2,222.22
STATE AID HWY. NO. 2	2,222.22
STATE AID HWY. NO. 3	2,222.22
STATE AID HWY. NO.	2,222.22
TOTAL STATE AID	22,222.22
STATE HIGHWAY NO. 105	2,222.22
STATE HIGHWAY NO. 100	2,222.22
STATE HIGHWAY NO.	2,222.22
TOTAL STATE HWY.	22,222.22
TOTAL ALL SYSTEMS	22,222.22

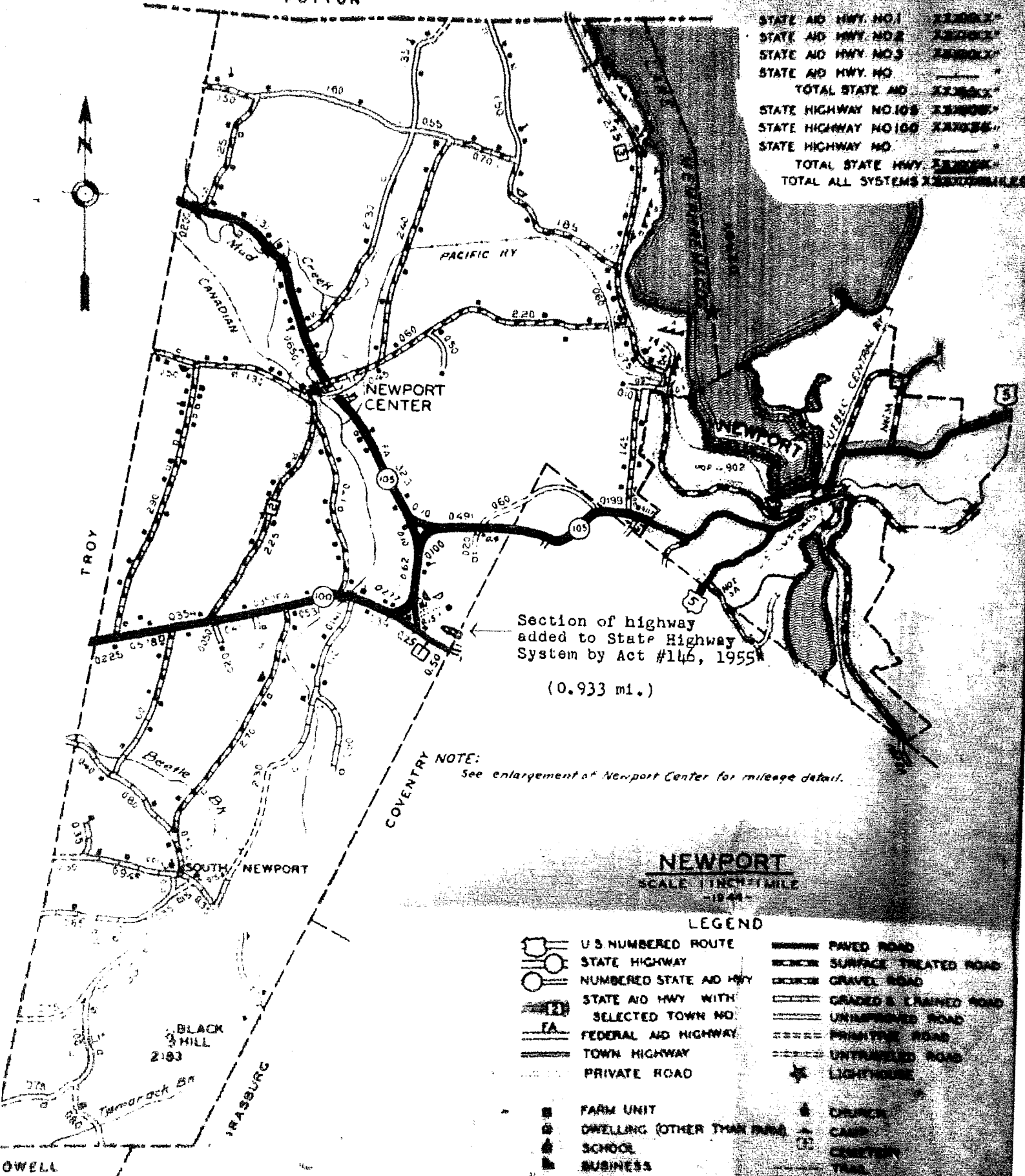

Section of highway added to State Highway System by Act #146, 1955
(0.933 mi.)

NOTE: See enlargement of Newport Center for mileage detail.

NEWPORT
SCALE 1 INCH = 1 MILE
-1941-

LEGEND

	U.S. NUMBERED ROUTE		PAVED ROAD
	STATE HIGHWAY		SURFACE TREATED ROAD
	NUMBERED STATE AID HWY		GRAVEL ROAD
	STATE AID HWY WITH SELECTED TOWN NO.		GRADED & DRAINED ROAD
	FEDERAL AID HIGHWAY		UNIMPROVED ROAD
	TOWN HIGHWAY		PRIMITIVE ROAD
	PRIVATE ROAD		UNTRAVELED ROAD
	FARM UNIT		LIGHTHOUSE
	DWELLING (OTHER THAN FARM)		CHURCH
	SCHOOL		CAMP
	BUSINESS		CEMETERY
			TRAIL

NOTE: VACANT CULTURAL FEATURES SHOWN IN DOTTED LINES

HIGHWAY DEPARTMENT

OFFICE MEMORANDUM

TO: H. E. Sargent, Chief Engineer
 FROM: H. F. Farrington, Mgr., Highway Planning Survey
 DATE: January 31, 1955
 SUBJECT: Reselection in North Troy Village

Attached is a reselection in North Troy Village which is a remeasurement only, with a change in state aid numbers to more properly reflect the present routing. The slight change in mileage is due to measuring these highways when Vt. 101 was made a state highway.

	<u>Old</u>	<u>New</u>
SA-1	0.65	0.651
SA-2	1.03	1.033
SA-3	0.30	0.290

In swapping SA-3 for part of SA-2 the difference in mileage was only 0.01 mile.

HFF:ar
 Attach.

NO 296 25M-5-54

~~0.11 miles in length would have been selected as a State Aid~~
 Highway but as we received no reselection on this from the district engineer and as it appeared that this would be made a state highway in the future it was decided to let this situation stand rather than make a reselection of 0.11 at that time. The old state aid highway SA-2 was listed as 0.42 miles in length, and Mr. Gates' calculation was correct on the basis of the figures he used.

This left a total of State Aid mileage in the town of 0.32 which is being reselected. The attached map shows the status of the mileage at the present time.

HFF:gi
 Attach.

HIGHWAY DEPARTMENT

OFFICE MEMORANDUM

TO: H. E. Sargent, Chief Engineer
FROM: H. P. Farrington, Manager, H.P.S.
DATE: March 25, 1954
SUBJECT: Reselection of State Aid Highway in North Troy

This reselection is the result of adding 5.77 miles of State Aid Highway on SA-1 and 0.43 miles of State Aid Highway on SA-2, or a total of 6.20 miles to the State System. This left a total of State Aid mileage in the town of 0.32 miles which is being reselected.

The attached map shows the status of the mileage at the present time.

HFF:gi
Attach.

~~Some 0.11 miles in length would have been selected as a State Aid Highway but as we received no reselection on this from the district engineer and as it appeared that this would be made a state highway in the future it was decided to let this situation stand rather than make a reselection of 0.11 at that time. The old state aid highway SA-2 was listed as 0.42 miles in length, and Mr. Gates' calculation was correct on the basis of the figures he used.~~

This left a total of State Aid mileage in the town of 0.32 which is being reselected. The attached map shows the status of the mileage at the present time.

HFF:gi
Attach.

MEMO TO: H. E. Sargent, Chief Engineer
FROM: H. F. Farrington, Manager, H.F.S.
DATE: March 31, 1954
SUBJECT: Reselection of State Aid Highway in North Troy

This reselection is a result of adding 5.77 miles of State Aid Highway on SA-1, 0.32 miles of SA-2, and 0.11 miles of Town Highway between where old SA-2 west southerly into Jay and the Jay Town Line. The section of old SA-2, 0.10 miles in length, had been relocated so that this turned off in the town of Jay rather than in the town of North Troy. The short section of town road 0.11 miles in length would have been selected as a State Aid Highway but as we received no reselection on this from the district engineer and as it appeared that this would be made a state highway in the future it was decided to let this situation stand rather than make a reselection of 0.11 at that time. The old state aid highway SA-2 was listed as 0.42 miles in length, and Mr. Gates' calculation was correct on the basis of the figures he used.

This left a total of State Aid mileage in the town of 0.32 which is being reselected. The attached map shows the status of the mileage at the present time.

HFF:gi
Attach.